

4 International Clinical Engineering & Health Technology Management Congress

October 24-26, 2021 - Virtual Edition

Hospital renovation, Failures in Project coordination and management (the case of CSSD Project in Yaounde – Cameroon

DJANKOU TCHOUTAT LIONEL

Administrator Applied Technologies 4Ever Limited / Local representative of CISA Production

Event Website: <https://www.globalcea.org/icehtm>



Parties involved in the CSSD project

Cameroon Ministry of Public Health

Alliances Constructions Cameroon

CISA Production

Applied Technologies 4Ever Limited

Description

- ❑ Our role in the project has been to equip the CSSDs with equipment like; washer disinfectors, steam sterilizers, plasma sterilizer, endoscope reprocessing machine, thermowelder.
- ❑ As a result of the poor communication between the project manager, the building contractor and us (supplier of equipment), the renovation work kicked off without our knowledge. By the time we were asked to go for site visits the renovation of the sterilization unit (infrastructure) had been made and commissioned. But nonetheless, as soon as we received the architectural drawing, it was updated based on equipment size, requirements, a separation of the dirty, clean and sterile zones. Owing to the poor interpretation of our layout, a spread sheet was provided on which there was a summary of various requirements for each machine for implementation by the plumber, electrician and builder.

Proposed layout not following standards

Proposed layout with the implementation of

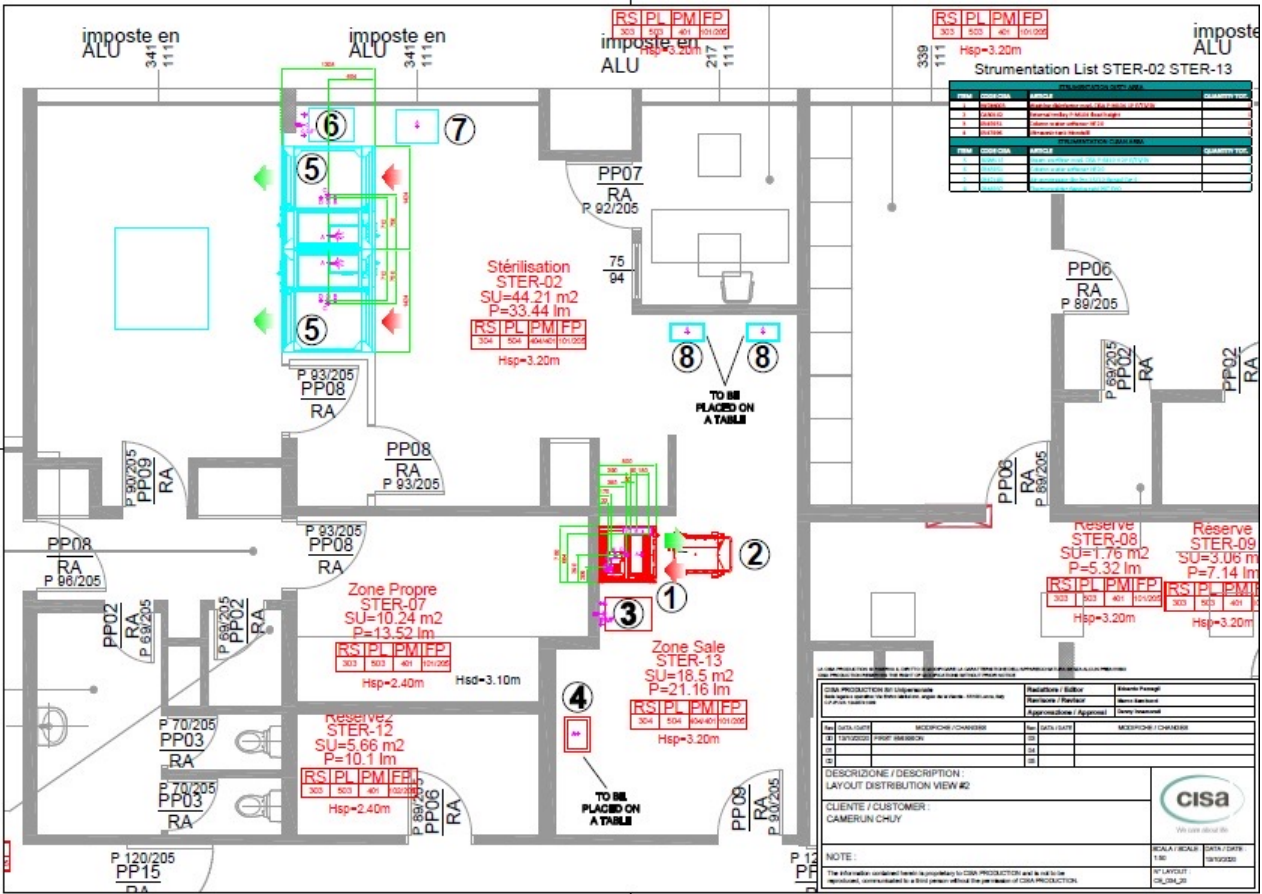
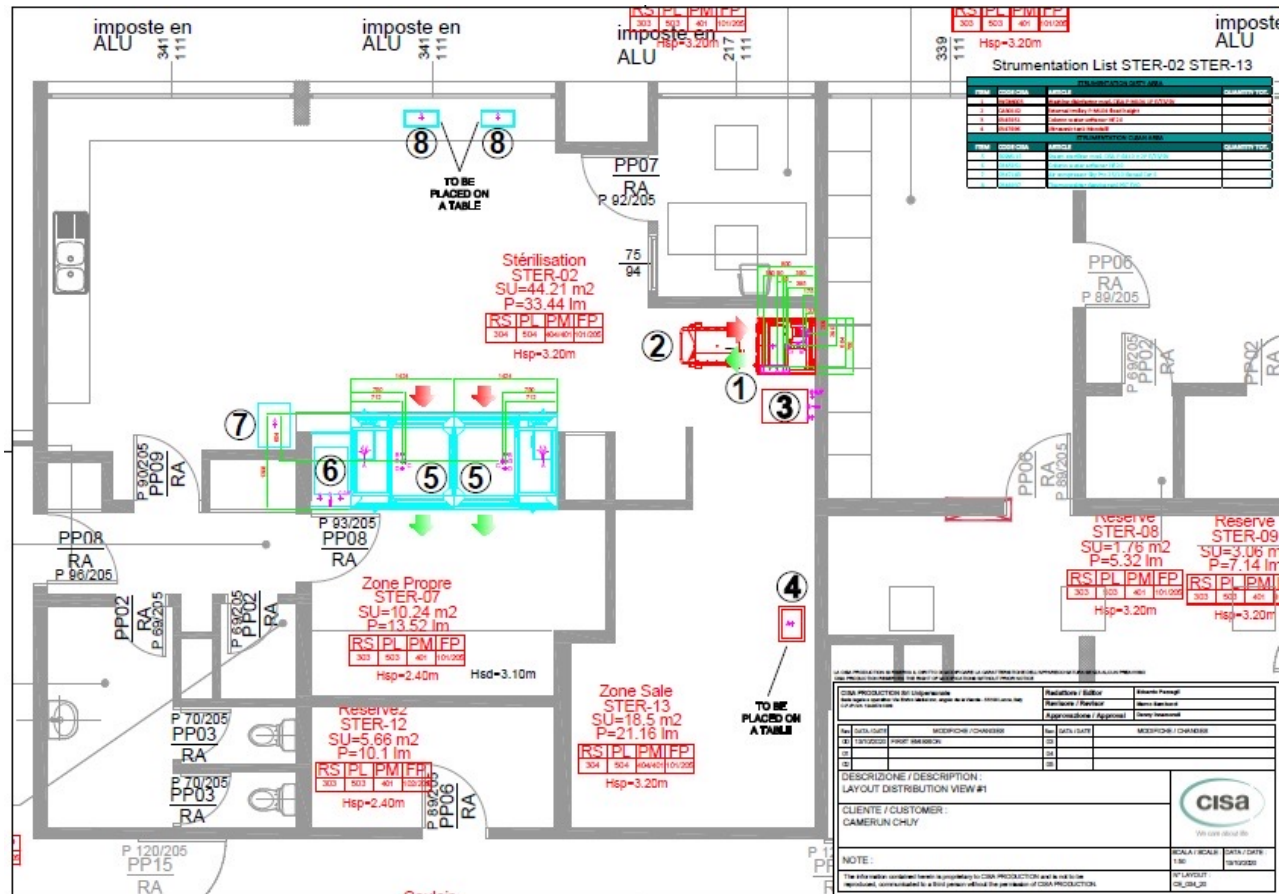

Failures to the proper execution of the project

- Poor communication between the contractor, hospital technical coordinator and the equipment manufacturer.
- Poor observance of deadline by builders, leading to an accrued storage cost of equipment before installation.
- Regular change of site manager.
- Non transmission of technical drawing to plumbers and electricians.

Results



- After one year of follow up, no work was carried out in the CSSD until the arrival of machines on site.
- Poorly executed drains.
- No electrical wiring to various machines installed.
- No water supplies to various machines installed.
- Poor accessibility to the zone with various machines. In order for the machines to enter the building, it necessitated the demolition or enlargement of doors.
- Poor synchronisation of activities lead to the hiring of watch men to guard the machine which were packed out of the building.

DJANKOU TCHOUTAT Lionel

djankoulee@gmail.com

Applied Technologies 4Ever Limited, Cameroon