

bold

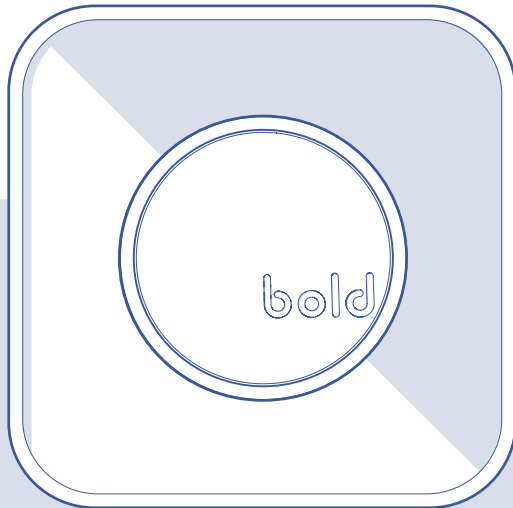

Connect Controller

BOLD Security Technology B.V.
Proostwetering 41
3543 AC Utrecht
The Netherlands

www.boldsmartlock.com

V 01

WARNING



Read and understand the operating manual before using this device

WARNING



Read and understand the operating manual of the product you wish to control with the BOLD Connect Controller function

What's in the box

- 1 Quick installation guide
- 1 CE leaflet
- 1 BOLD Connect
- 1 Poweradapter with 4 different socket adapters
- 1 USB-C Cord
- 2 screws + plugs

Specifications

Dimensions:	68 x 68 x 23mm
Weight:	200 gr
Operating temperature:	10–40°C
maximum humidity:	80%, non-condensing
BLE Frequency Range:	2400MHz-2483,5MHz,

Controller specific*:

Relay switching:	app configurable presets
Relay output type:	potential free, 'dry contacts'
Max switching:	230V AC / 48V DC @ 3A
Wire specifications:	0,14mm ² – 1,5mm ²

The relay is not a safety contact.

* Please make sure the interface on the product you wish to control complies with the above control wiring interface specification.

Intended use

The BOLD Connect can be used to provide remote access to your BOLD Smart Cylinder. One BOLD Connect can control up to 25 BOLD Smart Cylinders as long as they are within Bluetooth range of the BOLD Connect.

The BOLD Connect should be placed indoors, protected from the elements.

The additional Controller functionality should only be used with electronic access control systems which have an option for a hard-wired switch, making a dry contact. The maximum switching current should never be exceeded to prevent risk of personal injury. Please make sure the interface on that product complies with our control wiring interface specification.

Bold Security Technology B.V. cannot not be held liable for any damages to the property and/or electronic access control system due to improper use or ignoring the operating instructions.

Installation instructions

Connect

Mount your bold connect within range of your WiFi network and close to your Bold Smart Cylinder. Make sure you have a wall socket close to your desired mounting location.

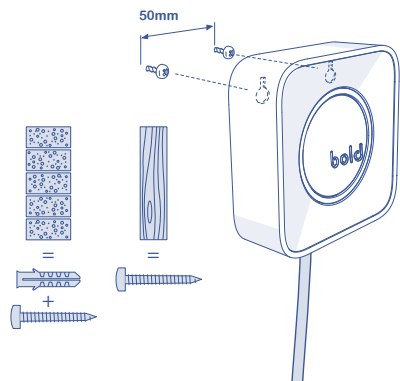

Choose the right adapter for the powersupply.
Insert the USB-C cable into the powersupply and into the Bold Connect.
Insert the power adapter into the wall socket.

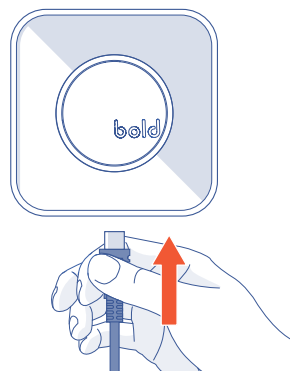

The LED ring should flash red once and you should hear a beep.

Press and hold the button for 5 seconds until the LED ring turns red.

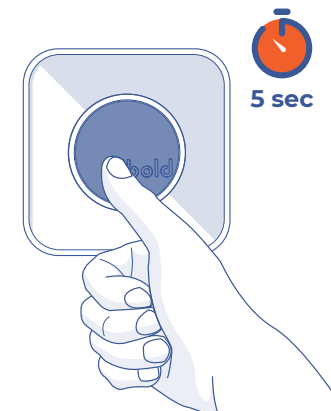

Open the Bold app on your mobile device.
You should see the red indicator dot in your menu.
Go to 'install connect' and follow the on screen instructions.

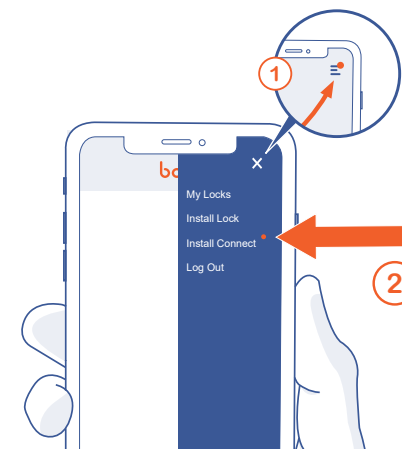

Installation instructions

Controller functionality (optional)

Go to: www.boldsmartlock.com for more information

Remove and dispose of the plastic tab from the connect by bending it outward.

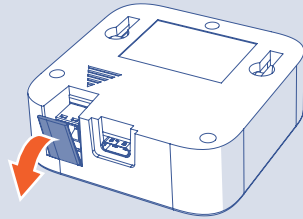

Remove the green plug from the connect

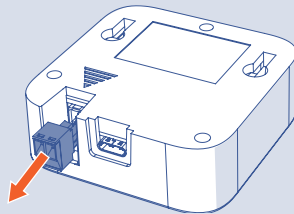

Strip 5mm of the end of the wires, Loosen the small flat head screws, insert wires, fasten the small flat-head screws.

Reinsert green plug in the housing (note the screws are facing the front of the Bold Connect housing)

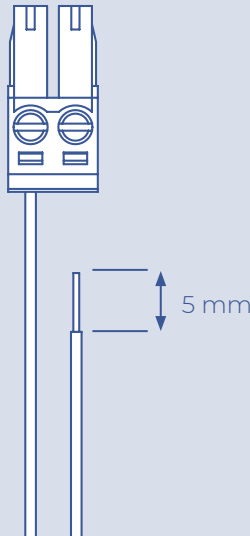

Max. switching:

240 V AC / 48 V DC @ 3A
not a safety contact

Safety instructions

The following safety and hazard instructions not only serve to protect the device, but they also prevent personal injury. Please read through these instructions carefully.

- The Bold Connect may only be used as intended and described in this manual.
- Do not place the Bold Connect outside.
- Do not expose the Bold Connect to extreme heat or cold. Do not place it in direct sunlight or any heat source.
- Only use provided power supply. The USB-C cable may not exceed a length of 1.2m
- The Bold Connect might malfunction due to technical faults. Always make sure there is an alternative method to enter you property in case of malfunction.
- Always consult the operation manual of the system you wish to control with the Bold Connect to see if the specifications match.

Service/Disposal

This device is not serviceable, in case of a malfunction it needs to be replaced entirely.

If you want to dispose of your Bold Connect at the end of its functional life, treat it as electronic waste and dispose of it according to local regulations.

Declaration of Conformity

Hereby, BOLD Security Technology B.V. declares that the radio equipment type Connect is in compliance with Directive 2014/53/EU.

The full text of the EU declaration of conformity is available at the following internet address: www.boldsmartlock.com