

2020-21



# COMPANY PROFILE



📍 Adlib House, Kitling Road, Knowsley Business Park, Prescot, England, L34 9JS 📞 +44 (0)151 486 2214 📠 +44 (0)151 448 1454 🌐 [www.adlib.co.uk](http://www.adlib.co.uk)  
Adlib Audio Limited is a limited company registered in England and Wales. Registered number, 03555097 VAT number 477222243.

# CONTENTS

05

WELCOME TO ADLIB

08

THE ADLIB TIMELINE

10

ADLIB HOUSE

12

IN-HOUSE CAPABILITIES

16

MEET OUR TEAM

20

AWARDS & HONOURS

22

FINANCIAL HIGHLIGHTS

24

RENTAL

46

SALES

50

INSTALLATIONS

70

MECHANICAL ENGINEERING

72

SERVICE & REPAIR

74

SUPPORT & TRAINING

76

MANUFACTURING

78

CSR

82

HEALTH & SAFETY

84

LET'S KEEP IN TOUCH





Adlib's Andy Dockerty, Roger Kirby and George Puttock worked swiftly, and the installation was completed within a tight window in our major refurbishment programme. With continuing good service and attention to detail from the Adlib team, we are learning the many advantages of the new system."

- Gail Wroth, Liverpool Philharmonic



## WELCOME TO ADLIB

Since 1984, Adlib has supported the live events industry, theatres, performance spaces, venues and schools to educate and entertain audiences all over the world. Over 35 years of experience has enabled Adlib to establish itself as **one of the most well-known and respected names in the technical services industry**. Our **Rental, Sales and Installation departments** provide professional sound, lighting, video, and mechanical engineering systems to a wide range of clients.

**We're experienced, approachable and have an internal team that can look after all aspects of your project from design, procurement, logistics, installation and follow on service.**

We take time to explain why we are making certain recommendations and how to get the best result from your systems. We also have a support network so if you run into trouble we're just a phone call or visit away.

When you choose Adlib as your preferred installation company, we'll be an extension of your team that provides you with a tailored service and maintenance that will enhance your investment and give you **complete peace of mind**.

We've achieved ISO certification for Quality, Safety, and Environmental Management. We're members of professional organisations such as PLASA and PSA.

But what's most important is that we share our years of experience with our clients on projects of any size, from a sound & lighting system in a local school or theatre to complete installations in major live event venues across the UK & Europe.

Adlib are a team of over 160 members of staff who are all **approachable and ready to help**. Every one of us has the support of the rest of the team, the backup of our manufacturer relationships and access to our extensive stock.

We're here to offer you **good advice, remarkable support and value for money**.



# ADLIB COMBINES THE DISCIPLINES OF



AUDIO



LIGHTING



VIDEO



RIGGING



MANUFACTURING



SALES



INSTALLATION



SERVICE & REPAIR



## Pre-production

Our proposals are tailor-made to our clients' needs. We can quote a specific equipment list for dry hire, or provide an individual proposal incorporating eye-catching visuals, floor plans and technical project management.

Our Heads of Department work closely with our operations team to put everything into place for the seamless delivery of your event. This includes the management of staff, transport, health and safety, ISO Standards Management and the preparation and delivery of equipment.



## THE ADLIB WAY

### Approach

Each department is staffed by specialists in their respective fields and each service can be provided individually, however our true strength is in combining those elements to provide a total package solution.



### Delivery

On site, a dedicated Project Manager, backed by a team of specialist technicians, ensures that each element of the production meets our exacting standards. We can work as an integral part of your event team, taking away any concerns about the technical delivery.

Naturally, we welcome a full post-event debrief to ensure the continued development and improvement of your customers' experience.



# THE ADLIB TIMELINE

Time has flown by since Andy Dockerty established the company in 1984, below you can find some of the first steps as well as other milestones that played an important part in building a brand that has grown steadily and diversified to provide technical and production solutions in the UK and across the globe.

## 1980



### 1984

#### ANDY DOCKERTY STARTS ADLIB PA HIRE

'One-man-and-a-van' PA hire company starts supplying audio systems to local bands and gigs.



### 1992

#### ADLIB AUDIO LOUDSPEAKERS

The development of the DF range of touring loudspeakers and installation products enabled Adlib to reach new markets. Adlib speakers can now be found at major concerts and festivals and on the riders of international touring artists.

### 1993

#### EXPANDING PORTFOLIO

Adlib launches sales and installations divisions.

## 1990



### 1998

#### ADLIB AUDIO LTD IS BORN

After 13 years of successful operation, Adlib PA Hire changes its name to Adlib Audio Ltd as the company acquires Limited Company status to facilitate its continuous growth.



### 1999

#### ADLITE LTD

Investment into lighting systems enabled Adlib to provide packages for the touring market.



### 2004

#### VILLA MARINA

Adlib awarded first government installation contract at the Villa Marina, Isle of Man.



### 2003

#### DAVID BOWIE - A REALITY TOUR WORLDWIDE

A key moment in the development of Adlib, providing audio in Arenas for the European leg of this iconic legend.

## 2000



### 2007

#### ADLIB JOINS THE L-ACOUSTICS NETWORK

Joining the worldwide rental network took Adlib's audio production in large scale events to a new level.



### 2015

#### ADLIB ACQUIRES EFX AUDIO

The purchase of EFX reinforced connections with Adlib's strong Scottish client base.



### 2018

#### ADLIB INVESTS IN THE FUTURE WITH THE NEW FACILITY

A world class facility has enabled Adlib to develop and cater for larger projects across all disciplines

## 2010



### 2005

#### FULL SERVICE COMPANY

Adlib invest in video technology to facilitate the growing conference market, alongside the lighting and rigging departments, Adlib could now offer a full production package for any event.



WEMBLEY

### 2011

#### FIRST WEMBLEY SHOW

Capital Radio's Summertime Ball was the first of many Stadium shows that Adlib have supported.



### 2016

#### NEW SCOTTISH WAREHOUSE

The new base near to Glasgow airport enabled Adlib to offer local support to installation, sales and rental customers.



Made in Liverpool England



# ADLIB HOUSE

In November 2018 Adlib moved into a first-class facility with over 83,600 sq ft of space that includes a large pre-production space, training suite, showroom, dedicated service facilities and a huge open plan office. This move reflected our continous growth over the recent years and facilitated ever expanding portfolio of services that we can offer.

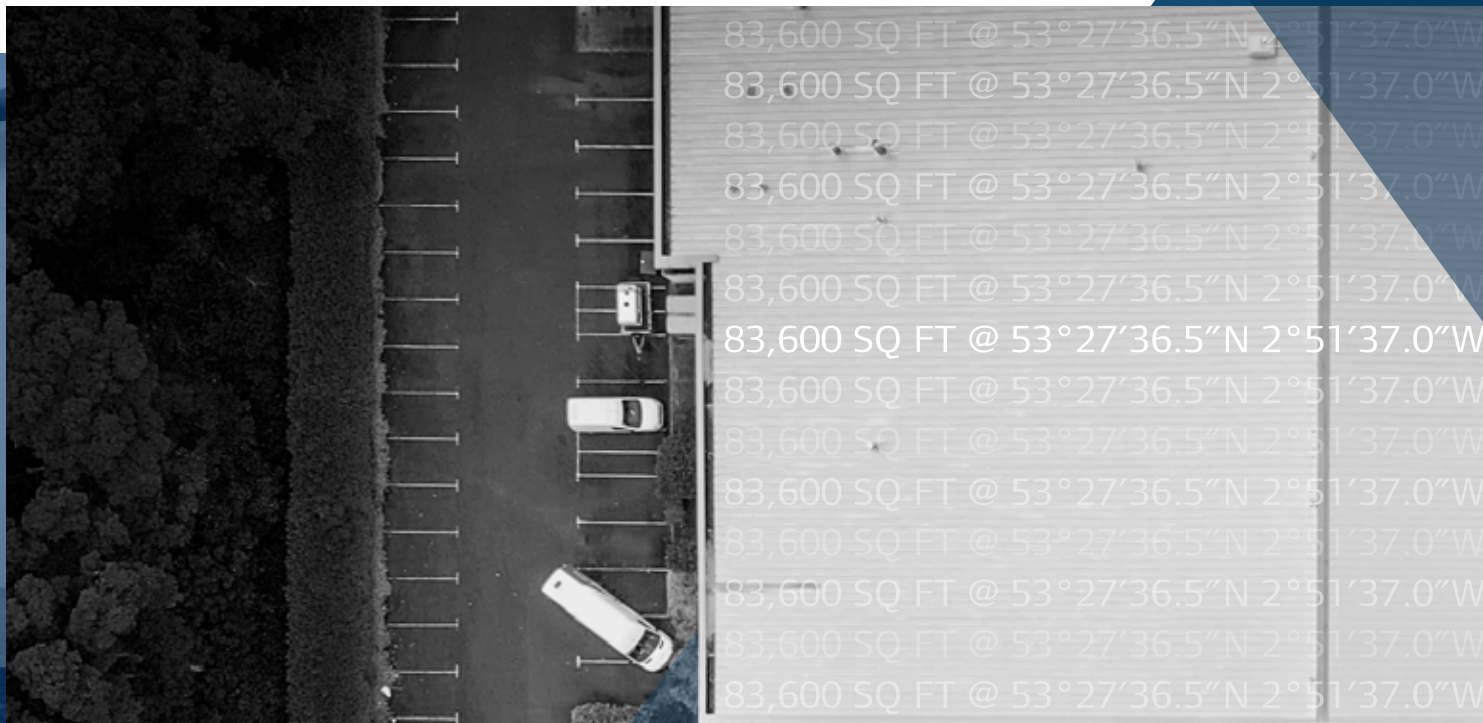

83,600 SQ FT @ 53°27'36.5"N 2°51'37.0"W  
83,600 SQ FT @ 53°27'36.5"N 2°51'37.0"W  
83,600 SQ FT @ 53°27'36.5"N 2°51'37.0"W  
83,600 SQ FT @ 53°27'36.5"N 2°51'37.0"W  
83,600 SQ FT @ 53°27'36.5"N 2°51'37.0"W  
83,600 SQ FT @ 53°27'36.5"N 2°51'37.0"W  
83,600 SQ FT @ 53°27'36.5"N 2°51'37.0"W  
83,600 SQ FT @ 53°27'36.5"N 2°51'37.0"W  
83,600 SQ FT @ 53°27'36.5"N 2°51'37.0"W  
83,600 SQ FT @ 53°27'36.5"N 2°51'37.0"W  
83,600 SQ FT @ 53°27'36.5"N 2°51'37.0"W  
83,600 SQ FT @ 53°27'36.5"N 2°51'37.0"W

## PRE-PRODUCTION SPACE



## DEDICATED SHOWROOM



## VISUALISATION STUDIO



## TRAINING SUITE





## IN-HOUSE CAPABILITIES

Technical ability is what sets us apart. At Adlib we pride ourselves on our **In-House Technical Team**, who along with the rest of the Technical Staff, make sure we **exceed** your expectations.



Thorough design work (including renders) are very important to us. The Adlib team are professional, great in front of the client and have always responded to new challenges.”

– Ian Greenway, LarMac (LIVE) Limited



## SOUND SYSTEM DESIGN

Adlib’s design team ensure your sound system will provide clarity and even coverage throughout the venue by using the latest modelling software to test the design in a virtual space before stepping foot in the venue.

## 3D RENDERING

To allow for many of Adlib’s creative clients to fully visualise their designs, our design team are fully trained in ‘WYSIWYG’, a design package which allows for in-depth and 360-degree viewing of lighting simulations.



## PROJECTION MAPPING

Adlib’s design team can produce eye-catching content based on real 3D geometry which can then be projected with staggering results.

## CAD DRAWINGS

Working with our clients and their technical representatives, Adlib’s design team produce standard AutoCAD drawings that can be overlaid onto a main architect’s layout. In addition, our team can produce Adobe Photoshop or Illustrator drawings.





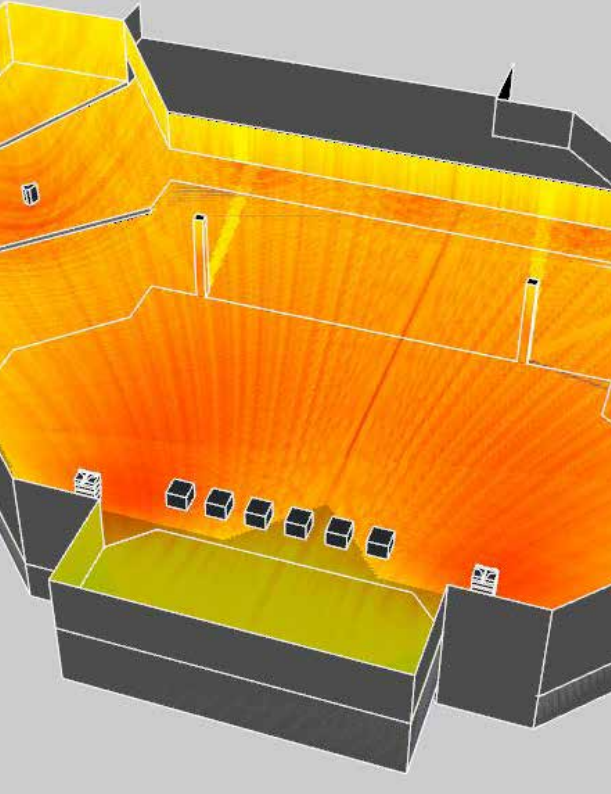

## SOUND SYSTEM DESIGN

### Concept

We design temporary and permanently installed sound systems drawing on over 25 years of experience designing sound systems for some of the most challenging acoustic environments.

Our sound design team have access to the latest modelling and prediction software from the manufacturers that we represent.

Using this software and a combination of real world measurements and CAD files, we are able to predict the performance of different brands, models and configurations of loudspeakers within almost any environment.

Our 3D visualisation can take into account the required SPLs whilst ensuring sightlines are considered and the experience is optimised for every seat in the venue.

### Development

When working on designs for rental projects and tours, we have first hand experience working in many of the most popular event venues in the UK and Europe - from Theatres to Stadiums and we draw this experience when working on new system designs.

### Installation

Because we're able to model how the system will perform, the installation time is dramatically reduced for both rental and installation projects. For installation projects, you can be confident that the system will work as intended first time preventing the need for any costly changes on site and ensuring that the audio installation doesn't cause unnecessary delays or complications for your other teams. For rental projects, this level of careful planning reduces the load in time and helps ensure an equally good experience for every member of the audience.

## 3D RENDERING

### Concept

It's important to us that our clients and creative partners share the same wavelength as us during the planning stages of a project - giving all of us the confidence that your vision will come to life when equipment arrives on site. Our best tool to achieve this is 3D rendering - using various industry-standard software, such as 'WYSIWYG', to create accurate images of how your event will look. If you would rather we used our own creative flair to enliven your event - we'll also present these renders to you.

### Development

large library of pre-made items, coupled with the ability to receive, source or even create specific elements, allows unparalleled insight in to the way your system will be delivered on site. The ability to simulate corporate branding on any virtual screens can push home the identity of your event. Working in 3D, this process also allows insight to the practicalities of a system - such as ensuring every audience member can see and hear the experience.

### Installation

Our 3D rendering software integrates closely with our CAD software - meaning our technical drawings and important installation data remain consistent throughout the process. Once you are comfortable with the results shown on 3D renders, we automatically ensure our drawings, calculations, equipment and engineers are primed to deliver the same result on site.

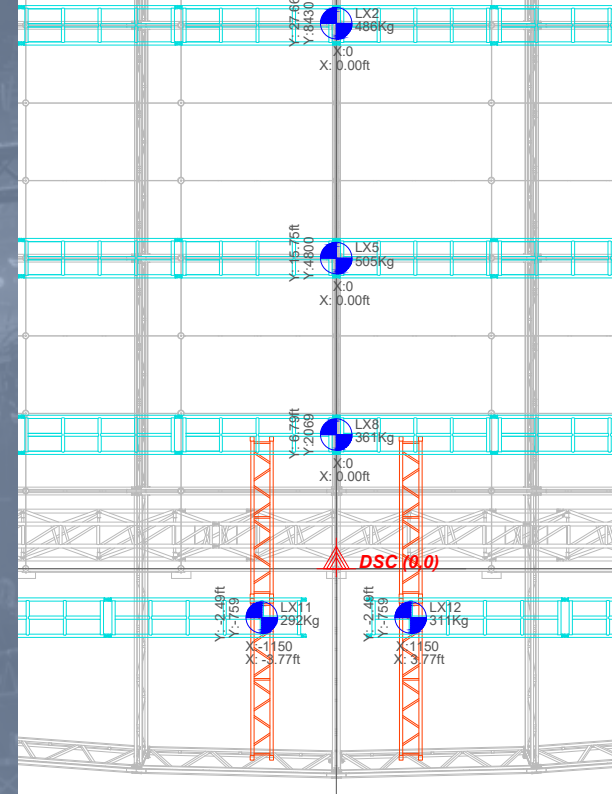

## CAD DRAWINGS

### Concept

Given our wealth of in-house knowledge of the latest CAD software, from industry-standard Autodesk AutoCAD to newer platforms such as Autodesk Fusion 360, we are able to implement the most efficient, accurate workflow of drawing our client's ideas and translating the result in to a practical, compliant, calculated system.

### Development

With a dedicated Drawing Office and the latest CAD software, our diligent approach to technical drawings means tight control over revisions and traceability. Integration with other technical stakeholders is key - helped by our flexibility to exchange, overlay and collaborate on third-party drawings and models to help a project flow. Our ability to export loading data for our systems enables integration with Structural suppliers ahead of time for approval, speeding up installation on site.

### Installation

When our drawings reach a project on site, their clear and accurate data allows our teams to make the right decisions quickly. Standardised drawing conventions increase clarity amongst our engineers on site, coupled with our ability to plot up to A0.

## PROJECTION MAPPING

### Concept

Drawing on over 30 years of experience in live production, our creative and technical experts can help you create a concept personal to your requirements. With a focus on technology enhancing the user experience, rather than getting in the way, we allow the content brief to shine through. We love developing ideas through this stage. When it comes to content, our team love pushing boundaries. With experience in interactivity, augmented and virtual reality, we encourage you to think differently.

### Development

With advance pre-visualisation systems, we work closely with clients to ensure all aspects of the concept are covered. With in house skills in sound design, lighting design, 3D art, systems integration and much more, we will cover all bases for you. At this stage, we integrate with venues, other suppliers, local authorities, artists and other event contractors to ensure the end result is as polished as can be.

### Installation

When arriving on site, most of the hard work is done and we can focus on what really matters - the user experience. Our technical engineers, project managers and creative staff integrate seamlessly to bring your concept to life. Whether working on permanent, semi-permanent or temporary installations, quality of installation is paramount here. Our professional staff work with great attention to detail producing results that constantly exceed expectations.





# MEET OUR TEAM

Adlib are pleased to introduce its Directors and Senior Management Team who are further supported by a plethora of technical and administrative staff. Each experienced Director heads up a section of the company with complete interdepartmental co-operation.



MANAGING DIRECTOR  
**ANDY DOCKERTY**

The time has flashed by since Andy Dockerty established the company in 1984, taking the first steps in building a brand that would grow steadily and diversify to become one of the successful and respected technical production solutions providers in the UK and internationally.

DIRECTOR  
**DAVE KAY**

Dave started at Adlib way back in 1994 after studying Electronics and Communications at Liverpool University. After cutting his teeth as a monitor, system and FOH engineer, Dave joined the team of directors to develop internal systems, ISO accreditation and the technical aspects of the company.



DIRECTOR  
**JOHN HUGHES**

Since joining Adlib in 2006, John’s strategic approach and business acumen led him to join the team of directors aged 29. He continues to oversee the rapid growth of the Sales & Installation departments, develop Adlib’s business across the board, as well as overseeing operations in HR and Finance.



It’s not just about owning the kit, but really it’s the infrastructure and the people and the personalities that surround you. They make Adlib. I just happen to be the person who brought them all together.”

– Andy Dockerty, Managing Director, Adlib



DIRECTOR  
**DAVE JONES**

Dave has worked at Adlib for over 23 years and has the perfect grounding for his current role, having previously worked as an audio engineer on site, Audio Warehouse Manager internally prepping equipment or as a company Rental Manager working directly with Adlib’s many clients.

DIRECTOR  
**PHIL STOKER**

Phil has spent over 19 years at Adlib and his positive attitude to business as well as managing, motivating and training a successful and productive team, in what can, at times, be a challenging working environment, has enabled Adlib to grow to its current level.



DIRECTOR  
**ROGER KIRBY**

Roger has been at Adlib for over 30 years and specialises in installations. His keen eye for detail and high level of technical ability has allowed Adlib to take on major projects around the UK for a variety of clients.







HEAD OF FINANCE  
**CHRIS BIRD**



HEAD OF SPECIAL PROJECTS  
**TONY GRIFFITHS**



INSTALLATIONS MANAGER  
**RICHARD MURPHY**



GENERAL MANAGER LX & VI  
**RICH ROWLEY**



HEAD OF LIGHTING & VIDEO  
**TOM EDWARDS**



SENIOR ACCOUNT MANAGER  
**RICHY NICHOLSON**



SENIOR ACCOUNT MANAGER  
**DAVE ELDRIDGE**



HEAD OF OPERATIONS AUDIO  
**CARL BILLINGTON**



HEAD OF OPERATIONS LX & VI  
**DAVE PLATT**



SERVICE DEPT. MANAGER  
**PETE SEDDON**



Whoever said “the impossible takes longer” obviously didn’t work on the Liverpool Guild of Students. Well done and congratulations on a great project and I very much look forward to working with you again in the future.”

- Andy Murphy, University of Liverpool

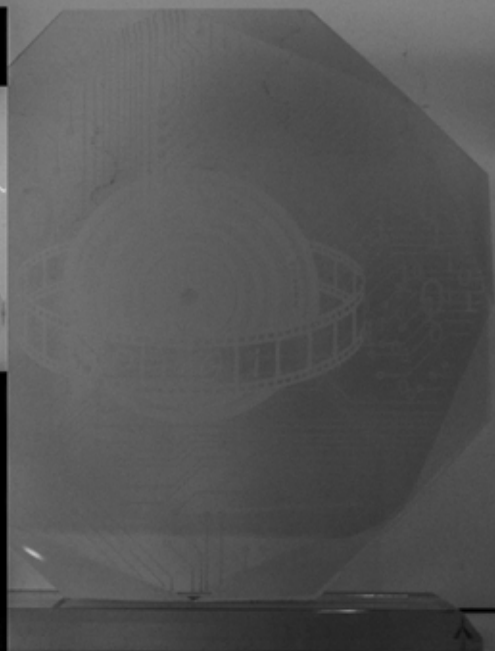



# ADLIB AWARDS & HONOURS

At Adlib, we are always striving for improvement and are constantly searching for opportunities that will aid our growth. This positive attitude has been recognised in several awards provided by our peers and industry partners. Such recognition was only made possible by ensuring that we adhere to the highest of standards, as set out by key professional organisations of which we are members at every step of the way. Having achieved **ISO certifications for Quality (9001), Safety (18001) and Environmental (14001) Management**, we are very proud to show our continuous commitment to best practice methodology and our environmental responsibility.

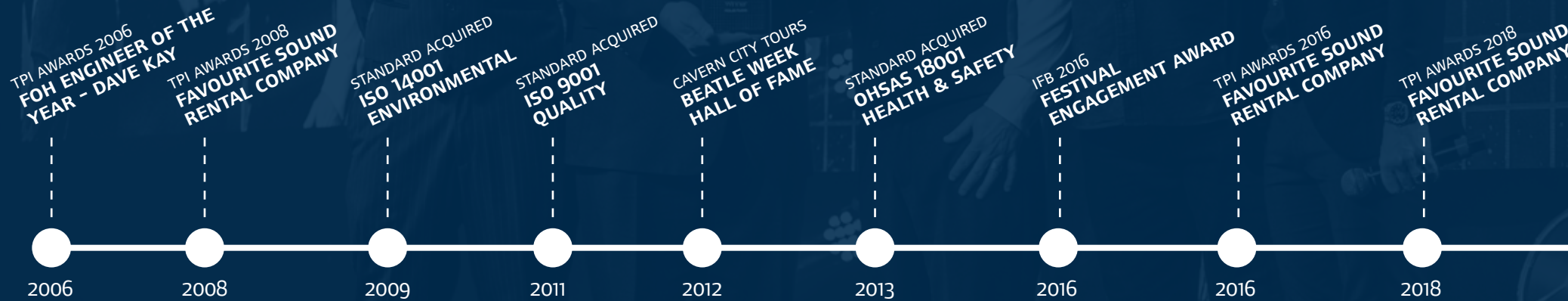

## PROFESSIONAL QUALIFICATIONS

Having staff with the correct experience is the key for any company's growth and ability to produce work at the highest standard. At Adlib we are proud of our **hands-on experience** gleaned from many years of touring and installation of equipment. However, this is only half of the story; many of our staff hold academic qualifciation, which gives us a great mix of theoretical and practical experience. These include:

- Ph.D Electrophysiology
- MSc Management
- MSc International Business
- Fellow of the Chartered Association of Certified Accountants (FCCA)
- BEng Hons Electronic Engineering and Communications
- BSc Biological Sciences
- BSc Hons Film Production Technology
- BA Hons Management
- BA Hons Sound Technology
- BA Hons Textile Design
- BA Hons Stage Management
- BA Hons Music, Theatre and Entertainment Management
- BA Hons Sociology
- BA Hons Performing Arts
- BA Hons Business Management and Information Technology
- BA Hons Theatre and Performance Technology
- BA Hons Commercial Music Production
- BA Hons Business Studies
- BA Hons Marketing
- Dip Audio Engineering

## ACCREDITATIONS



Certificate Number 15973-QMS-001



Certificate Number 15973-EMS-001



Certificate Number 15973-HAS-001





## FINANCIAL HIGHLIGHTS

We are pleased to provide evidence of our company's growth and strong financial position over the last 14 years. This has been based on an effective frugal management structure. If required, we can provide full audited accounts and credit ratings.

EBITDA GROWTH IN £000's

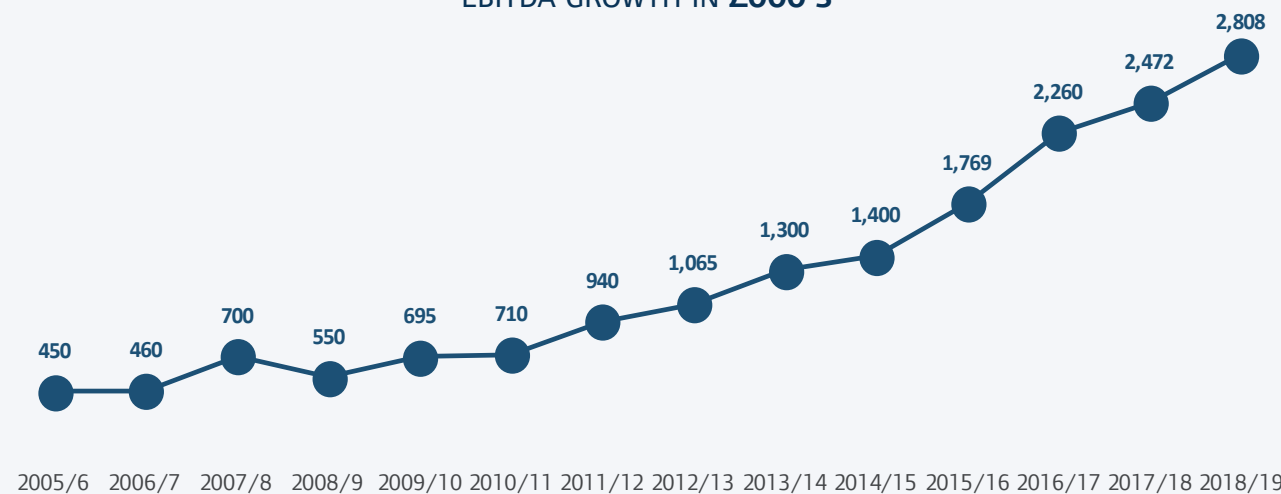

TURNOVER IN £000's

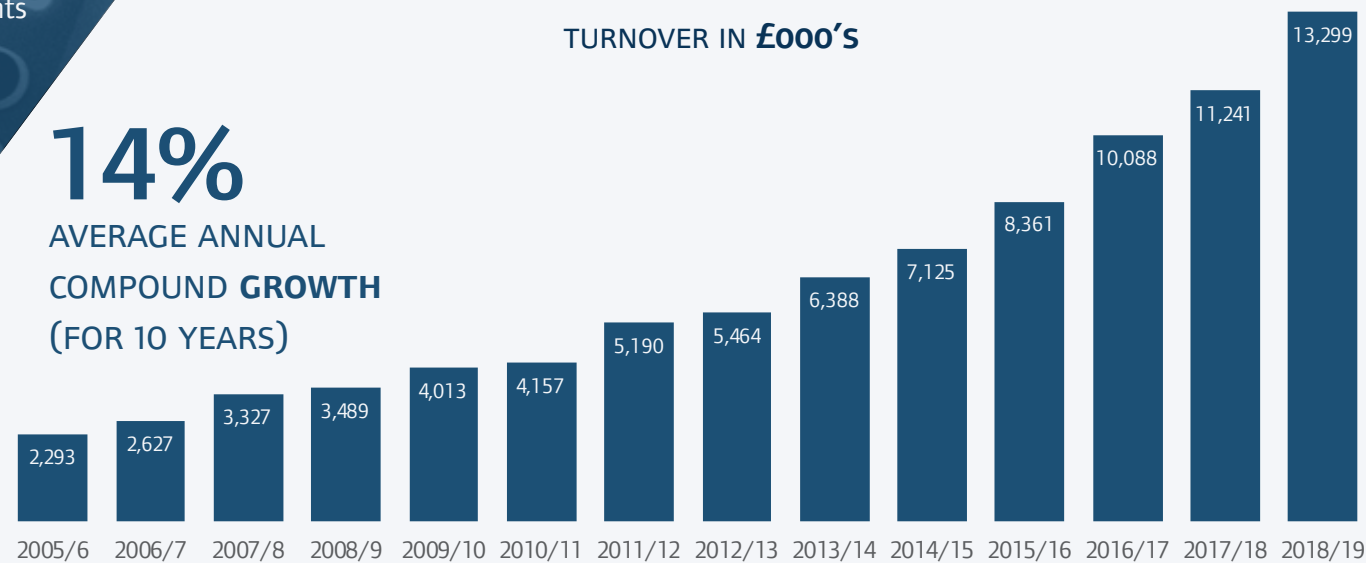

**14%**  
AVERAGE ANNUAL  
COMPOUND GROWTH  
(FOR 10 YEARS)

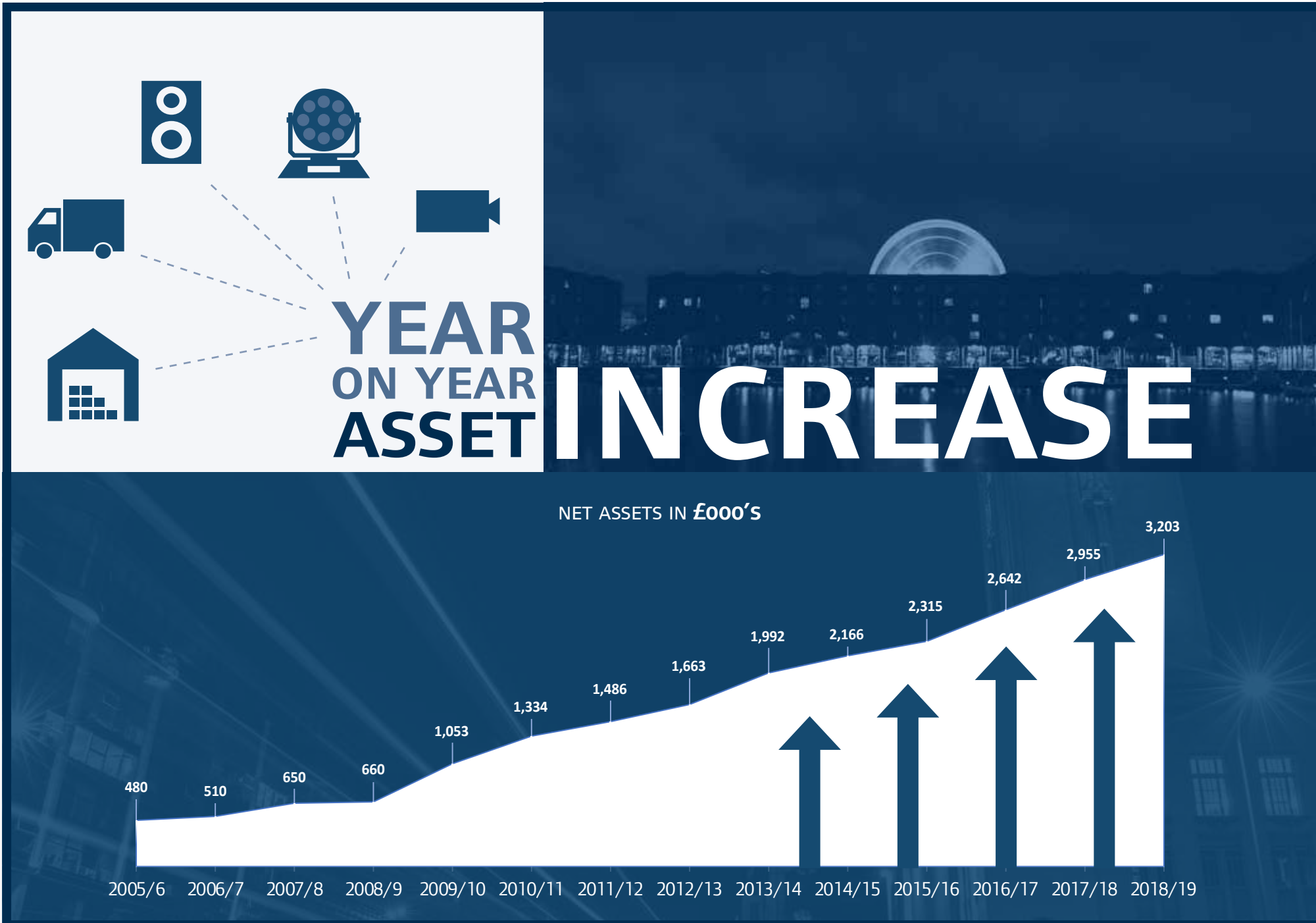



# ADLIB RENTAL

Our Rental Department supplies and operates **sound, lighting, video, and rigging equipment** for events in the UK and around the world. Our own fleet of vehicles means that we are able to **pass on transport savings** to our clients.

We share **35 years of production experience** openly through the projects we deliver, advice we offer, and through free training seminars that we organise.

Our large inventory caters for **all event sizes**, from hotels to theatres, academies and arenas. A great deal of pride goes into the presentation and maintenance of our stock.

## KEY AUDIO BRANDS



## KEY LIGHTING BRANDS



## KEY VIDEO BRANDS



## KEY RIGGING BRANDS



COMEDY

CORPORATE

MUSIC CONCERTS, TOURING, & FESTIVALS

SPECIAL PROJECTS

TV & BROADCAST

Adlib



COMEDY  
ELF: A CHRISTMAS SPECTACULAR  
**ARENA TOUR**



COMEDY  
MRS. BROWN'S BOYS  
**ARENA TOUR**





COMEDY  
JACK WHITEHALL  
**ARENA TOUR**



COMEDY  
RUSSELL HOWARD  
**ARENA TOUR**





CORPORATE

LIVERPOOL CHAMBER OF COMMERCE ANNUAL DINNER

**LIVERPOOL ANGLICAN CATHEDRAL**



The event was absolutely amazing and we've received such brilliant feedback, I think 'The best ever annual dinner' has been mentioned a few times! Thank you SO much for all of your hard work and please pass my thanks over to all of your team who were involved as well. It's always an absolute pleasure to work with you guys and you do such a brilliant job."

- Sarah Walker, Chamber of Commerce

Adlib

CORPORATE

INTERNATIONAL BUSINESS FESTIVAL

**LIVERPOOL**



Adlib

31





## NORTHERN TECH AWARDS EDINBURGH



Thanks again to Joe and the team for your help and support in making the NTA a great success. Everyone thought it was an amazing set and a real tech triumph."

– Bev Boettcher, GP Bullhound



## M7 REAL ESTATE GLASGOW



Our request was completely bespoke and involved lighting a listed structure in Glasgow which we think had only ever been lit once or twice before. Chris Neary was our contact throughout and he really was great from start to finish. I would not hesitate to use Adlib again should such a job come up."

– Graeme Stewart, Asset Manager, M7 Real Estate

## NEWSQUEST SCOTLAND EVENTS SCOTLAND





MUSIC CONCERTS, TOURING, & FESTIVALS

DARYL HALL & JOHN OATES

**ARENA TOUR**



MUSIC CONCERTS, TOURING, & FESTIVALS

SNOW PATROL

**ARENA TOUR**













SPECIAL PROJECTS

WORLD GYMNASTICS CHAMPIONSHIPS

**GLASGOW**

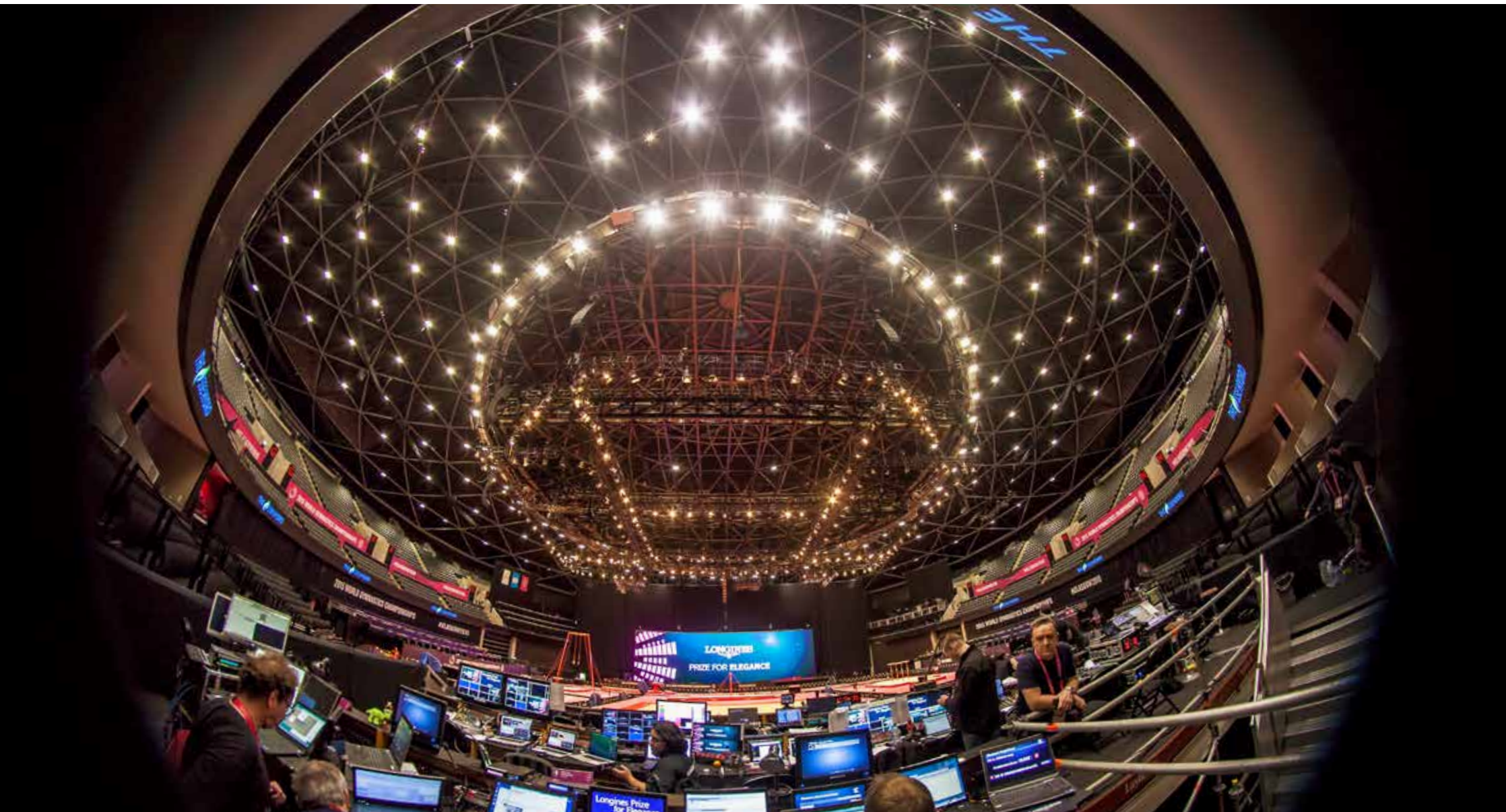

Adlib



SPECIAL PROJECTS

RAY LAMONTAGNE

**UK TOUR**



I was really impressed – the gear was immaculate and Kevin was a total pro. Everything was smooth for the whole run of shows and I’d definitely like to work with Adlib again in the future!”

- Jeremy Roth, Lighting Designer, Ray LaMontagne



Adlib



# RADIO 1 PRESENTS: THE LEWIS CAPALDI SYMPHONY LIVERPOOL



# NETBALL WORLD CUP LIVERPOOL









# ADLIB SALES

We can help you buy professional sound, lighting, video and staging equipment, **from a single sheet of lighting filter to arena sound systems.**

Most major brands are available and 35 years of industry experience mean that we can offer **honest, helpful advice.**

It's not about making a one-off sale. It's about beginning a long-term relationship with you, helping you get the most from your investment.

**When you grow, we grow; it's a two way thing.**



## BUY NEW

We are distributors or dealers for the most popular and reliable brands of professional sound, lighting, video, rigging and staging equipment. We offer helpful advice, competitive pricing and after-sales support to help you make the most of your new equipment.

## BUY EX-HIRE

Because all of our ex-hire equipment has been professionally maintained, serviced and looked after by dedicated engineers throughout its life, our clients can be confident that they are choosing a product that will last for years to come.

### AUDIO BRANDS



### LIGHTING BRANDS



### VIDEO BRANDS



### RIGGING & STAGING BRANDS







## NUB SOUND PLYMOUTH



Having just returned from our trip up to Adlib's amazing new facility to collect our new DiGiCo SD12. I could not be happier with both the product and the service from Adlib and their team. In particular, Harry who was my point of contact throughout the process, he really did go above and beyond. We are looking forward to working with Adlib again in the very near future. For me it's about people and relationships and Adlib have great people and share this ethos too. 10 out of 10 for Adlib."

- Rob Simpson, Managing Director, Nub Sound Ltd



## STS TOURING MANCHESTER



Working with Adlib was an absolute pleasure as always. At every step of the way, from us reaching out to delivery of the console, guys over at Adlib made sure that the process was as quick as possible, so that we didn't miss a beat on the Anthrax tour."

- Paul Collis, Director, STS Touring Productions Ltd

Adlib

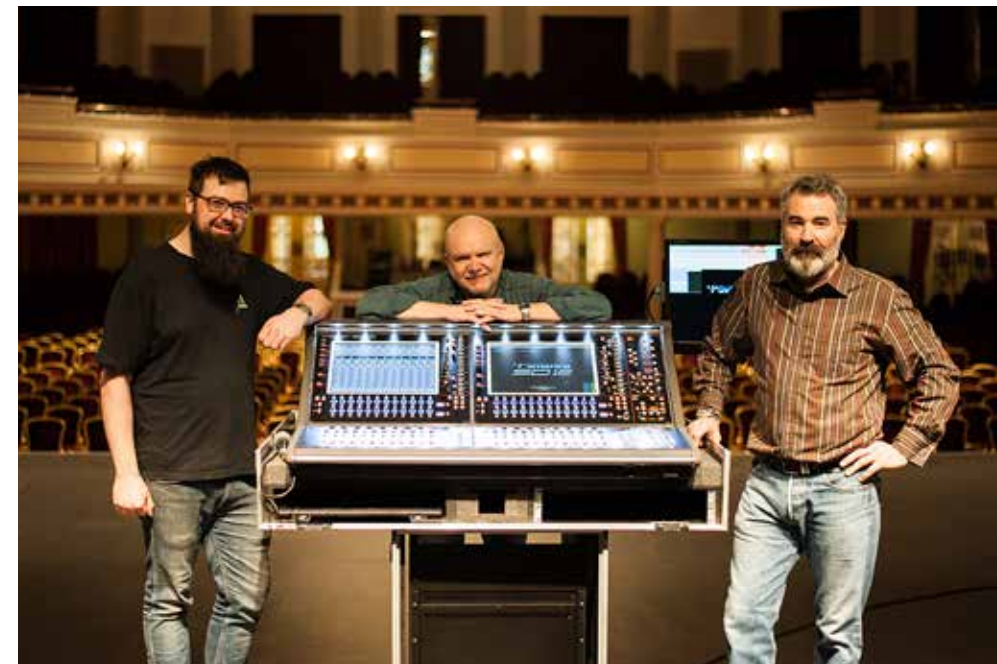

## VILLA MARINA & GAIETY THEATRE ISLE OF MAN

With the relationship spanning over 15 years, Adlib most recently supplied DiGiCo SD12 and a range of Chauvet lighting fixtures to Isle of Man's flagship multi-purpose venue - the Villa Marina.



## AUDIOCP GLASGOW



There are many 'great sounding systems' out there, but what gave Adlib / L-Acoustics the edge in this case was a combination of three things: the sound quality and flexibility; the potential for cross-rental business and the service and support from Adlib, which was really outstanding right from the start."

- Scott Young, Managing Director, AudioCP

Adlib



# ADLIB INSTALLATIONS

Adlib's installation department designs, supplies and installs reliable, cost-sensitive audio, lighting, video, and mechanical engineering systems.

Whether you're an architect, consultant, venue manager, technician, church pastor, teacher or the procurement manager of a construction company **we understand your unique situation** because of our 35+ years' experience working with others like you.

**We're experienced, approachable and have an internal team that can look after all aspects of your enquiry from design, procurement, logistics, installation and follow on service.**

We take time to explain why we are making certain recommendations and how to get the best result from your systems. We also have a support network so if you run into trouble we're just a phone call or visit away.

When you choose Adlib as your preferred installation company, you will also have the opportunity to choose a tailored service and maintenance contract to enhance your investment and give you **complete peace of mind**.

## SERVICES

- Sound Systems
- Lighting Installation
- Video Equipment (AV)
- Projection Screens
- Motorised Power Flying
- Variable Acoustics
- Smoke Curtains
- Festoons
- Stage Lifts
- Counterweight Systems
- Portable Staging
- Track & Drape Installations
- AV projection equipment
- Speaker Arrays
- Lighting Bars
- Electrical Chain Hoists & Controllers
- Ground Support & Flown Truss Units
- Power & Control Cable Reelers & Cable Collector Trays

## SECTORS

SCHOOLS,  
COLLEGES,  
& UNIVERSITIES

LEISURE,  
BARS,  
& RESTAURANTS

CHURCHES  
& PLACES  
OF WORSHIP

SPECIAL  
PROJECTS  
& CONSTRUCTION

THEATRES  
& LIVE  
EVENT VENUES

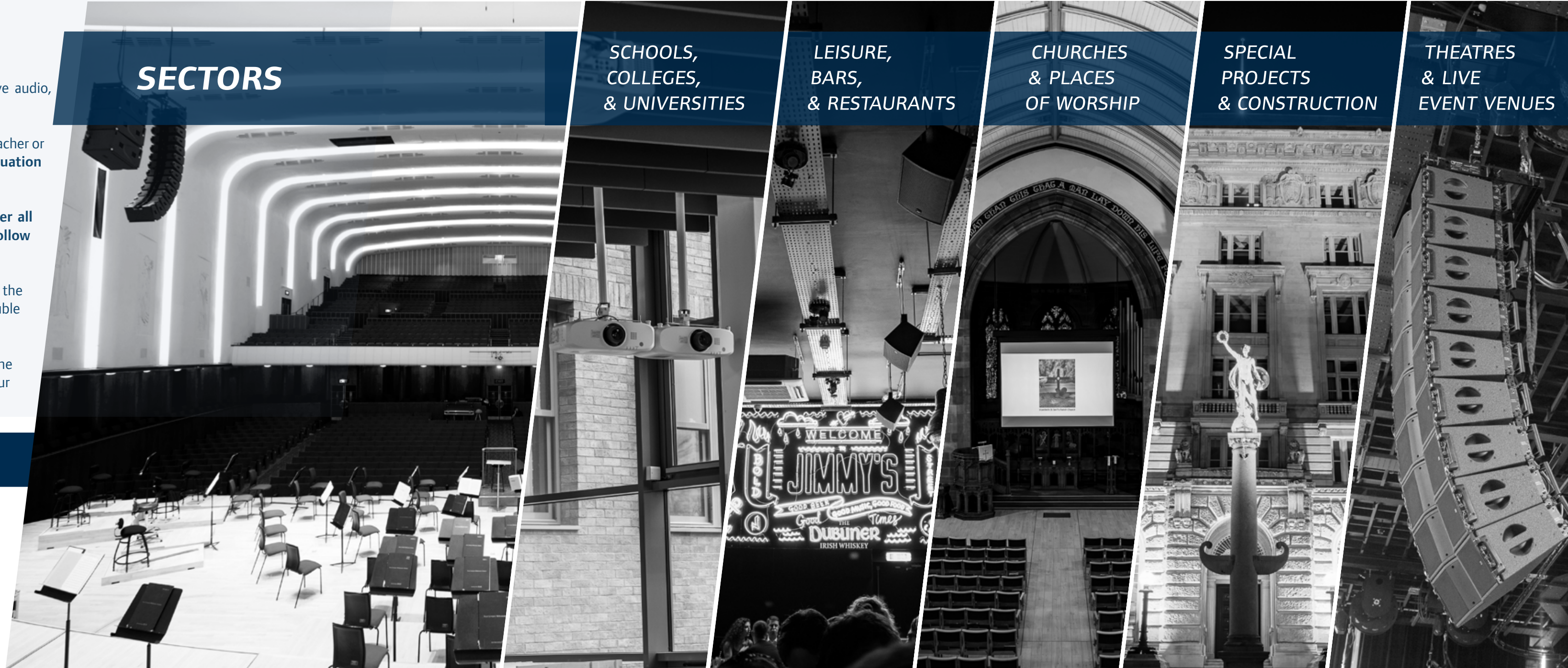





## DEAN TRUST ARDWICK MANCHESTER



It's about the facilities and opportunities this hall provides and when we showcase events or do assemblies it helps us in demonstrating our high standards. It endorses our high standards, because for us high standards are not just academic, they are about every aspect of school life – including our facilities."

- Suzanne Finlay, Headteacher, Dean Trust Ardwick

## LIVERPOOL COLLEGE LIVERPOOL



The pupils will get a lot out of using this. We've had so many requests from people who we didn't even realise would be involved in theatre or the arts, coming to run the shows and to learn how that particular side of theatre arts works."

- Dan Bishop, Director of Music, Liverpool College



## LIVERPOOL GUILD OF STUDENTS LIVERPOOL



The new technical install at LGoS not only offers Mountford Hall better quality production for student groups, but also provides a high spec and appealing in-house systems for touring shows. Adlib has provided high quality service on both accounts, from concept to construction, and their after sale support has been second to none."

- Matt Gadbsy, Technical Supervisor,  
University of Liverpool





SCHOOLS, COLLEGES, & UNIVERSITIES  
ST JULIE'S CATHOLIC HIGH SCHOOL  
**LIVERPOOL**



SCHOOLS, COLLEGES, & UNIVERSITIES  
LIPA SIXTH FORM COLLEGE  
**LIVERPOOL**



THE ALCHEMIST  
UNITED KINGDOM



MANCHESTER



LONDON



LIVERPOOL

AETHER  
LIVERPOOL





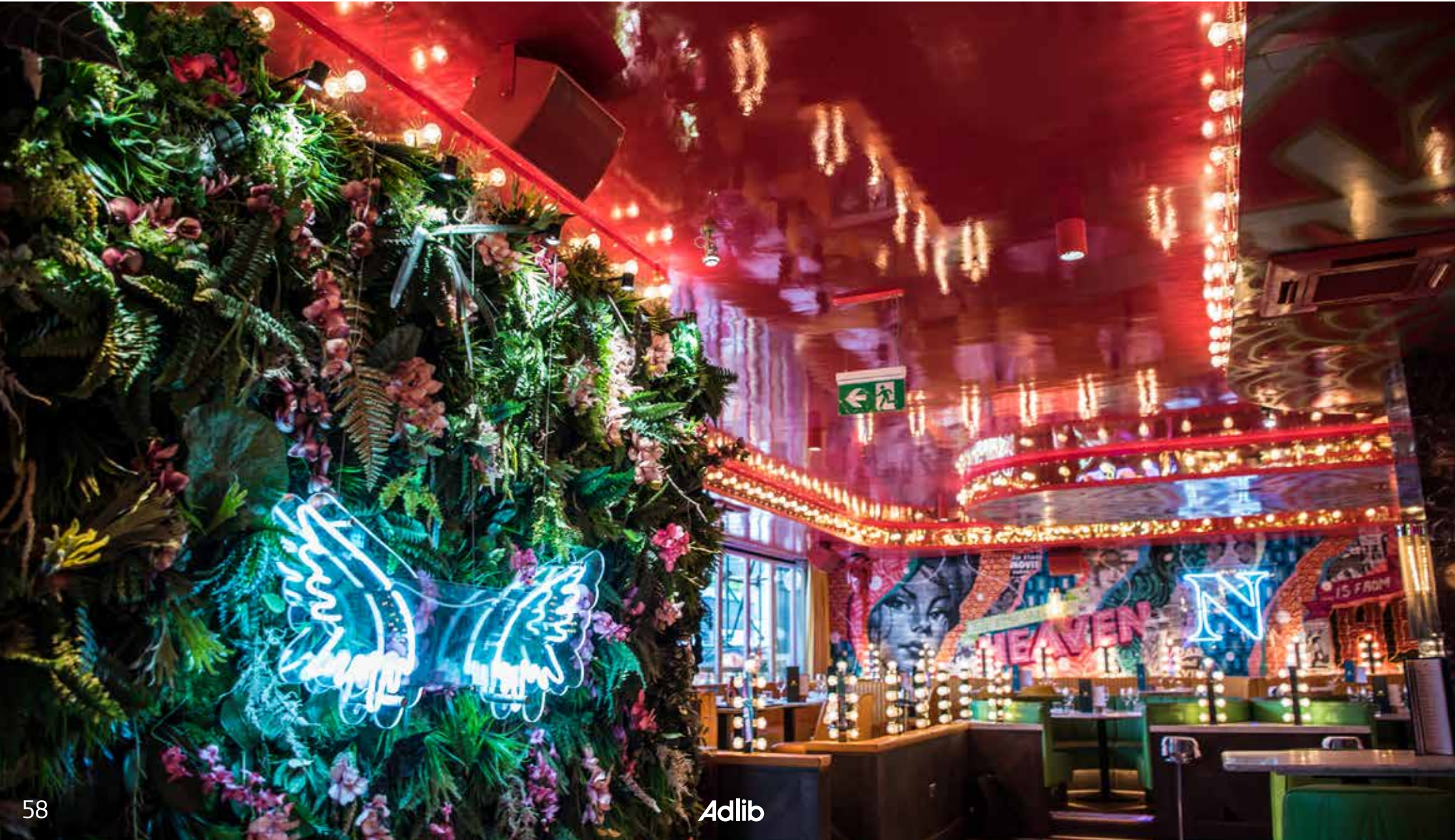



CHURCHES & PLACES OF WORSHIP

INVERLEITH ST SERF'S CHURCH

EDINBURGH



CHURCHES & PLACES OF WORSHIP

BETHEL CHURCH

LIVERPOOL



The guys are an absolute delight to work with; knowledgeable, polite, understanding and willing to explain the technical detail in layman's terms. The final installation has greatly enhanced the usability of our new home."

- Brian Williams, Deacon, Bethel Church



SPECIAL PROJECTS & CONSTRUCTION

CHINA'S FIRST EMPEROR AND THE TERRACOTTA WARRIORS

**WORLD MUSEUM**



Adlib

SPECIAL PROJECTS & CONSTRUCTION

BLOODY TOWER

**TOWER OF LONDON**



Adlib



## BASE COURT &amp; HENRY VIII'S KITCHENS

## HAMPTON COURT PALACE



## CUNARD BUILDING

## LIVERPOOL

When the building's current owners recently decided upon bolstering its evening appearance on the waterfront, they turned to local install specialists Adlib for an architectural lighting concept, who specified 24 Colorist Panel 36Qa and 14 Colorist Panel 8Qa ILUMINARC fixtures to accentuate the building's Italian Renaissance-inspired architectural aesthetic.

"As a result, the whole package gives the Cunard Building the best combination for the long-term installation, and ensures this piece of Liverpool's maritime history is visible for all to see."

- Richard Murphy, Installations Manager, Adlib

## LIVERPOOL PLAYHOUSE

## LIVERPOOL



The complex challenge of refurbishing the safety curtains and the stage lantern in the Grade II\* listed Playhouse was managed by Adlib with tenacity and humour. Working collaboratively we now have systems that will give many years of reliable service, be easier to maintain and present a much improved look for audiences."

- Robert Longthorne, Technical and Building Director, Liverpool Playhouse







“

Adlib have not just provided us with an excellent solution, but did so in a slender window of opportunity, enabling us to be up and ready to go for the start of another very busy season.”

- Chris Norton,  
Cambridge Corn Exchange



Adlib



Adlib



THEATRES & LIVE EVENT VENUES

O2 FORUM KENTISH TOWN

**LONDON**



We've enjoyed a great synergy and track record with Adlib over the last decade, with well-respected audio systems at our venues in Bournemouth, Birmingham, Leeds, Sheffield and Leicester, so it made perfect sense for us to work together again on this bespoke solution in one of our major London venues."

- Helen McGee, Divisional Manager, AMG

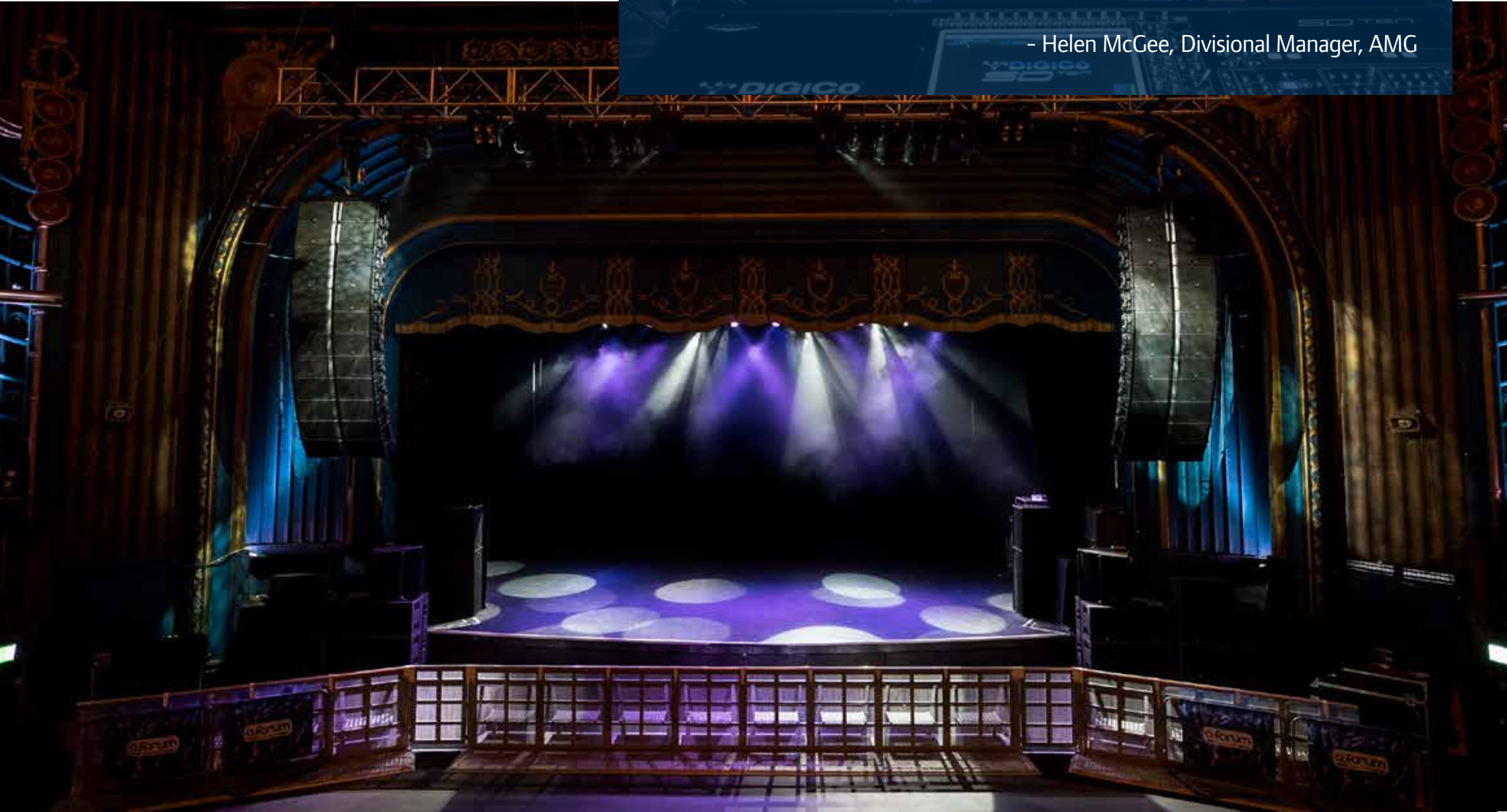

Working with Adlib was a pleasure. Everything was organised and efficient on site and the resulting sound system design is fantastic and is being enjoyed by all using it and listening to it."

- Nick Milnes, Glasgow Life

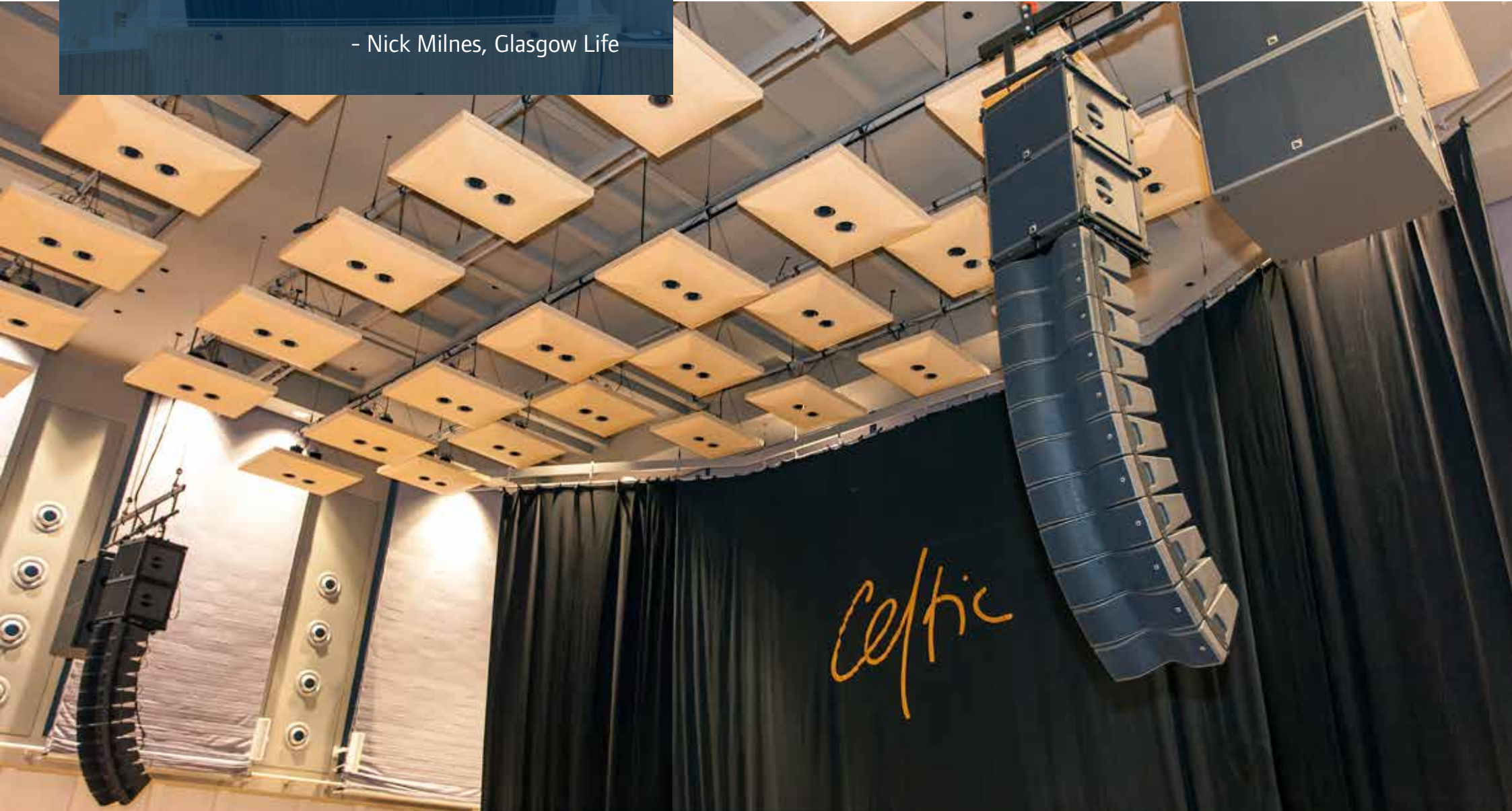

THEATRES & LIVE EVENT VENUES

GLASGOW ROYAL CONCERT HALL

**GLASGOW**



# ADLIB MECHANICAL ENGINEERING

Whether you're an architect, consultant, venue manger, technician, teacher or procurement manager, we understand your unique situation by drawing on over 35 years' experience working with others like you.

Our management as well as creative and technical staff, will help you create a concept that is truly personal to your venue.

With a focus on technology enhancing the user experience, rather than obstructing it, we encourage the client to take ownership of the idea and with them we create a workable concept.

Regardless of the size of project, it's important that we recommend the most appropriate equipment configuration for your space.

Whether your venue is a theatre, live event venue, house of worship, educational institution or historical building, we'll develop your concept into a formal written proposal with associated Risk Assessments, Method Statements and a Schedule of Works – all of which we'll go through in a phone call or in-person over a cup of coffee.

As each building presents its own challenges, the installation team will be led by a project manager with previous experience working in your type of building.

Once the installation is complete your systems will be commissioned and ensure that it meets or exceeds the specification.

We're interested in the long-term development of your venue or project rather than our short-term gain. Consider us part of your team. **We're here to help.**

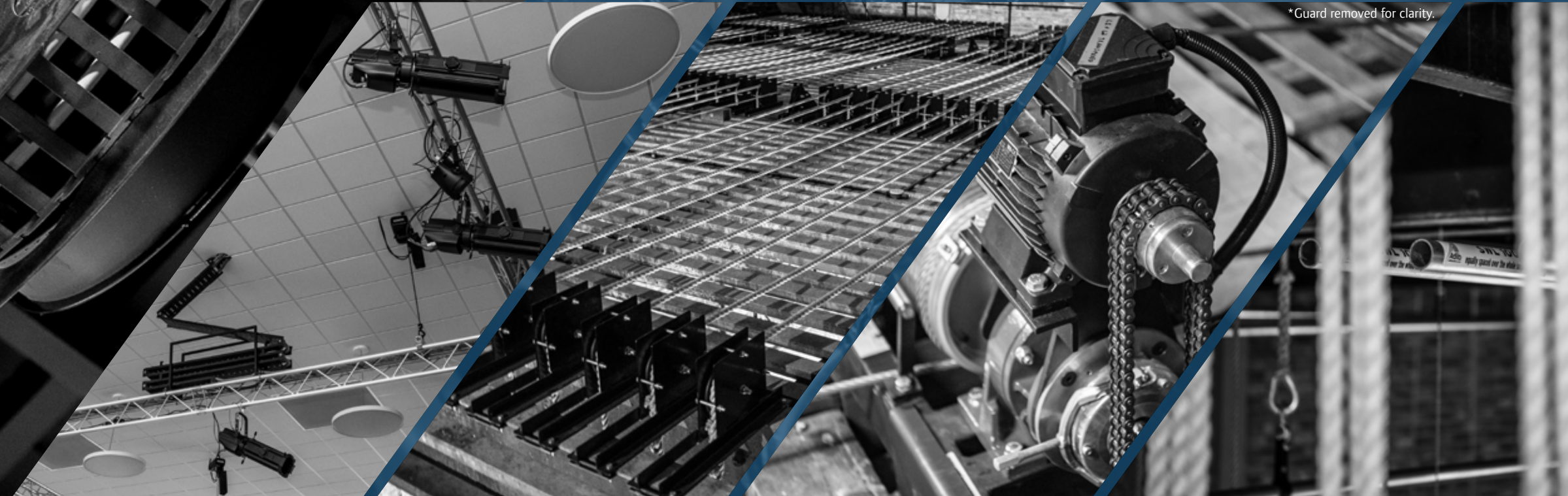



# ADLIB SERVICE & REPAIR

Experienced engineers backed up by long-standing relationships with manufacturers ensure **no surprise, huge repair bills**.

Our service department offers repair and maintenance for venues, theatres, schools, places of worship and individuals who own **sound, lighting and video equipment** either on-site or at our fully equipped service centre.

We offer competitively-priced, **manufacturer-certified repair** for any sound, lighting or video equipment.

We offer **on-site PAT Testing, maintenance and repair** either on an ad-hoc basis or as part of a **scheduled maintenance regime**.

**Preventative maintenance** is an important part of extending the working life and resale value of your equipment. Our console service is particularly popular with large analogue and digital boards from hard-working venues, all being kept at their prime internally as well as on the front panel.







## ADLIB SUPPORT & TRAINING

We understand the importance of education, particularly in an industry where technical demands are ever-increasing.

We are strong believers in taking theory and applying it practically in a real-world environment, helping you to bridge the gap between knowledge and experience.

We offer training and education services for people at all levels, whether you're a sound or lighting engineer needing to get a handle on the newest equipment, a school leaver looking to get into the industry or a teacher trying to make sure their pupils get the best start, we would love to help.



## OPEN DEMO TRAINING

# DAYS

We run open days where we demonstrate our **state-of-the-art** audio-visual equipment and offer impartial advice on specifying and installing systems.

We have strong partnerships with leading manufacturers in sound, lighting and multimedia technology. We host regular training at Adlib with the support of these manufacturers to provide hands-on experience and updates to our staff, clients, industry partners and freelance engineers.



I thought the training day was exceptionally good! I felt that Tom ran through all the essentials and was very accommodating of any questions that were asked. Personally, I appreciated the hands-on approach to learning with teams of 3-4 on each desk. That element of working together was helpful when troubleshooting the desk and its features."

- Brian Meehan, Audio Technician, DiGiCo Training Session





## ADLIB MANUFACTURING

Having an on-site manufacturing team who can bring unconventional designs to life is an **invaluable** asset, especially when so many projects call for bespoke solutions. At Adlib, we have a fully operational carpenters' workshop and spray booth that manufactures all of our loudspeakers, flight cases and custom made elements that your project demands. Adlib's design ethos and manufacturing processes are grounded on a wealth of touring experience.

Bringing your ideas to life is what we do, so you can rest assured that we will meet and then **exceed your expectations** and, by keeping design, manufacturing and installation processes in-house, any savings made in time and money are passed straight onto you.



Our manufacturing team has experience in producing a wide variety of items, ranging from loudspeakers, flight casing to lecterns and bespoke manufacturing for theatrical performance.

Of course, not everything can be manufactured in-house and as an **ISO 9001** company we are careful in outsourcing and only use established, vetted, companies that operate to the same standards as we do. This way we can be confident of **putting our name and brand** to any manufactured product that leaves our building.



**Made in Liverpool England**





# ADLIB CORPORATE SOCIAL RESPONSIBILITY

Whilst running a successful business that prioritises customer experience is something that Adlib continuously strives for, we understand that it's not enough and recognise the impact we have on our **stakeholders, customers, suppliers, employees and the wider community and environment in which we operate in.**

Adlib believes that by placing **respect** at the core of what we do, we are able to address this impact, that's why we work responsibly, prioritise safety, and protect environment and communities around us, thus forming our **Sustainable Business Strategy.**



- **By respecting a responsible way of working**, we ensure that staff of all levels take pride in their work, whilst instilling company culture that raises awareness of social and environmental risks we face.
- **By respecting safety standards**, we create safe work environment for our people, our partners and our clients. Safety is what we do, that's why we are continually seeking ways to improve and innovate our, already high, health and safety standards.
- **By respecting the environment**, we do our best to grow our business sustainably, in a way that creates value not only for ourselves but also for our local surroundings. That's why we build and invest locally, renovate whenever we can and adhere to environmental management standards as set out by ISO 14000.
- **By respecting our neighbours**, we always look to give back to the local economy. Whether its usage of local suppliers, backing community causes, or providing industry awareness days and masterclasses in local educational establishments. **We believe we're only as good as the community around us.**



## BILLY BRYSON AUDIO SYSTEM TECHNICIAN

Billy, after working his way through the ranks of the company's apprenticeship scheme, has gone from warehouse tech to a fully-fledged audio system technician.

**"It's the mentorship scheme that really cemented my passion for this career."**

**- Billy Bryson**

## DEVELOPING TALENT

The long-term development philosophy that we apply in the commercial environments stems from our belief in investment in people. Adlib's reputation for developing young talent is unrivalled and many of our staff start their professional journey with us.

Adlib's participation in apprenticeship programmes contributes to the growth of talent available locally, whilst Adlib Open Days that we organise, present students, tutors, and educational institutions with possible work opportunities and career pathways within our industry.





## ADLIB IN EDUCATION

Adlib's continuous dedication to providing Production Day experiences to the secondary education sector is recognised throughout the industry. We believe that the hands-on experience that such days provide, give invaluable insight into the live events production industry and its corresponding career paths. Easy access to the real-world production facilities and seasoned technicians encourages pupils at schools, and students at universities, to reach out and seize work experience opportunities that Adlib has to offer.

The progression that students make, from one of our Production Days, to a work experience period, before finally joining the company on an Adlib apprenticeship, is something that fills us with immense pride. Further strengthening Adlib's mission of running its own, unfunded, apprenticeship schemes as part of our commitment to young people and the local community.



World's Biggest Coffee Morning at Adlib in support of Macmillan Cancer Support



The School Tutorial Events are part of our real commitment to providing a realistic look into the 'live' production industry. Too often further education courses tend to be glamourised somewhat and we intend to squash that myth and enable young people to have a better understanding of the potential career paths."

- Andy Dockerty, Managing Director, Adlib



## COMMUNITY CAUSES

In addition to grassroots educational work that Adlib carries out, we also support local causes and charities such as Hillsborough Foundation and Alder Hey Children's Hospital.

Whether its a donation or supply of equipment for events, we believe its our responsibility that communities around us benefit from our work.

Additionally, Adlib aims to encourage and inspire employees to raise funds for various charities that include MIND, Macmillan Cancer Support, Save the Children and Mare Curie.

**WE ARE  
MACMILLAN.  
CANCER SUPPORT**

**mind**  
for better mental health

**DigiBete**

**Save the Children**

**leeds children's  
hospital**  
caring about children

**Marie Curie  
Cancer Care**

Children and young People's  
**National Diabetes Network**





# ADLIB HEALTH & SAFETY

Adlib takes immense professional pride in our high standard of health and safety. Compliant with Construction Design Management Regulations (CDM 2015) and all other main UK legislation, we are continually seeking ways to improve and innovate our safety. Understandably the world of event delivery, AV installation or venue facility support is not hazard free. Therefore the Adlib approach to safety is one of pragmatic risk management ensuring we are talking to the right people at the right time. Adlib believe in strong partnerships and collaboration which is why an independent H&S consultant is employed to provide safety support. Finally, Adlib is ISO 9001, 14001 and OHSAS 180001 proving that we have strong internal systems of safety quality assurance. Safety of our people, your staff and clients, and other site contractors will never be compromised. Safety is what we do.



These are without doubt the most perfect set of RAMS I have reviewed. I pride myself in finding fault and have boasted that in the last 20 of practicing Health and Safety as a Consultant and as a Principal Designer (formally Planning Supervisor and CDM Co-ordinator) I have never had any H&S or CDM documentation submitted to me that came close to being compliant to H&S."

- Brian Nelson, Briley Consultancy Group Ltd



Certificate Number 15973-QMS-001



Certificate Number 15973-EMS-001



Certificate Number 15973-HAS-001





## LET'S KEEP IN TOUCH

We hope that through this brochure you've had a chance to get a taste of what Adlib is about. However, it is just a taste and that's why we'd like to invite you to visit us at either of our offices in Liverpool or Glasgow, or to connect with us on social media where we regularly update our pages with snapshots from our latest projects, case studies and life on the road.

### The Adlib Team

#### HEAD OFFICE

Adlib House  
Kitling Road  
Knowsley Business Park  
Prescot, L34 9JS

0151 486 2214

#### SCOTLAND OFFICE

Unit 15  
Airlink Industrial Estate  
Inchinnan Road  
Paisley, PA3 2RS

0141 301 2214

 [www.adlib.co.uk](http://www.adlib.co.uk)



# #ADLIBATWORK



# Adlib