



Fall Protection

8mm Permanent Horizontal Lifeline Fall Arrest/Fall Restraint System

Technical Data Sheets

Technical Data Sheet	Description	Page
1421	0.8kN / 5kN System (Wall / Floor Mount)	3
1423	5kN Overhead System	4
1424	Structural Post Mounting System (0.8kN Tension)	5
7241422	11kN Peak Force, 0.8kN System Tension Energy Absorber	6
7241424	19kN Peak Force, 0.8kN System Tension Energy Absorber	7
7241425	19kN Peak Force, 5kN System Tension Energy Absorber	8
7241428	Dampener, 5kN	9
7241429	Dampener, Small, 0.8kN	10
7241420	Detachable Traveler - No Wheels	11
7241421	Overhead Traveler	12
7240212	8mm 1x19 Stainless Steel Cable	13
7240211	8mm 7x7 SS Cable	14
7241417	Anchor Plate Standard	15
7240122	Straight Eye	16
7241412	Intermediate Bracket	17
7241413	Variable Intermediate Bracket	18
7241414	Variable Mount Angle Intermediate Bracket	19
7241415	45 Degree Intermediate Bracket	20
7241406	90 Degree Internal Corner	21
7241526	90 Degree Internal Corner, Wall Mount	23
7241407	90 Degree External Corner	25
7241408	90 Degree Post Mount Corner	27
7241525	90 degree External Corner, Wall Mount	28
7241570	45 Degree Internal / External Corner, Wall Mount	30
7241409	45 Degree Internal Corner	32
7241410	45 Degree External Corner	34
7241411	45 Degree Post Mount Corner	36
7234011	Hex Swage Toggle	37
7234246	Hex Swage Toggle, Ball Stop Shoulder	38
7234012	Hex Joiner	39
7241430	Hex Swage Stud, Pass Through	40
7241432	End Stopper	41
7241435	System Tag Kit, 8mm Horizontal Lifeline	42
7241434	System Tag Kit, 8mm Horizontal Lifeline	43

TECHNICAL DATA SHEET: 1421

0.8kN / 5kN System (Wall / Floor Mount)



APPLICATION:

For applications mounted above the reach of the user, refer to data sheet 1423.

HLL Energy Absorbers may be required at both ends of the system based on layout configuration. (Number of brackets, span length, number of users, etc.)

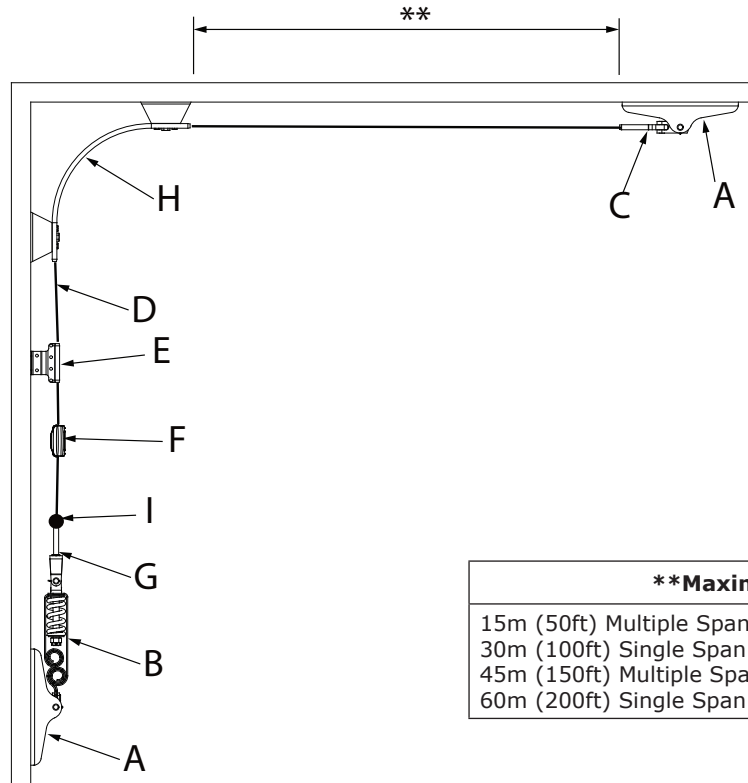

**Maximum Span
15m (50ft) Multiple Span - Multiple Users
30m (100ft) Single Span - Multiple Users
45m (150ft) Multiple Span - Single User
60m (200ft) Single Span - Single User

	Component	Part Number
A	Anchor Plate Standard Straight Eye	7241417 7240122
B	19kN Peak Force, 5kN System Tension Energy Absorber 11kN Peak Force, 0.8kN System Tension Energy Absorber 19kN Peak Force, 0.8kN System Tension Energy Absorber	7241425 7241422* 7241424*
C	Hex Swage Toggle Hex Swage Toggle, Ball Stop Shoulder	7234011* 7234246
D	8mm 7x7 SS Cable 8mm 1x19 Stainless Steel Cable	7240211 7240212
E	Variable Mount Angle Intermediate Bracket 45 Degree Intermediate Bracket Intermediate Bracket Variable Intermediate Bracket	7241414 7241415* 7241412* 7241413*
F	Detachable Traveler - No Wheels	7241420
G	Hex Swage Stud, Pass Through	7241430
H	90 Degree Internal Corner, Wall Mount 90 degree External Corner, Wall Mount 45 Degree Internal / External Corner, Wall Mount 90 Degree Internal Corner 90 Degree External Corner 45 Degree Internal Corner 45 Degree External Corner	7241526 7241525* 7241570* 7241406* 7241407* 7241409* 7241410*
I	End Stopper	7241432

*This item is different from the one illustrated

TECHNICAL DATA SHEET: 1423

5kN Overhead System



Fall Protection

APPLICATION:

HLL Energy Absorbers may be required at both ends of the system based on layout configuration. (Number of brackets, span length, number of users, etc.)

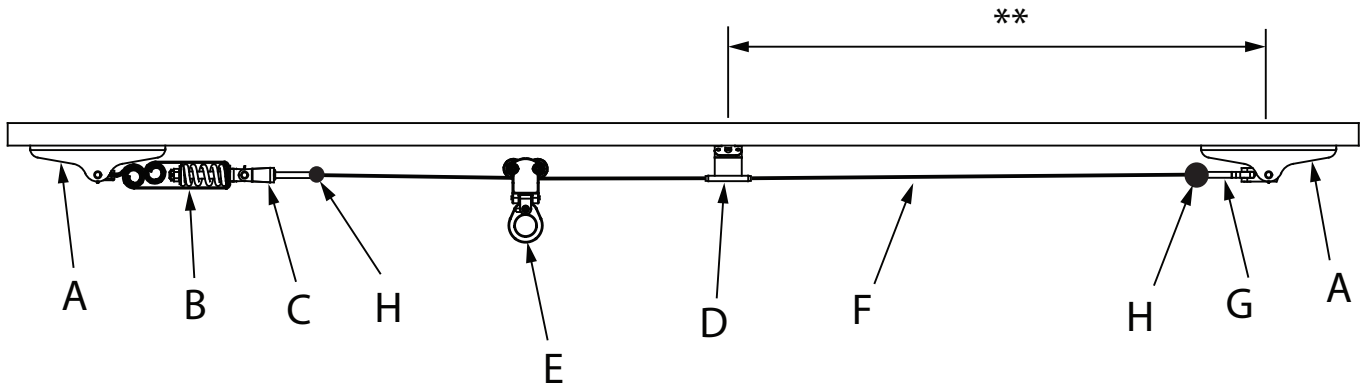

**Maximum Span
15m (50ft) Multiple Span - Multiple Users
30m (100ft) Single Span - Multiple Users
45m (150ft) Multiple Span - Single User
60m (200ft) Single Span - Single User

	Component	Part Number
A	Anchor Plate Standard Straight Eye	7241417 7240122*
B	19kN Peak Force, 5kN System Tension Energy Absorber Dampener, 5kN	7241425 7241428*
C	Hex Swage Stud, Pass Through	7241430
D	Variable Mount Angle Intermediate Bracket 45 Degree External Corner 45 Degree Internal Corner 90 Degree External Corner 90 Degree Internal Corner	7241414 7241410* 7241409* 7241407* 7241406*
E	Overhead Traveler	7241421
F	8mm 1x19 Stainless Steel Cable 8mm 7x7 SS Cable	7240212 7240211*
G	Hex Swage Toggle Hex Swage Toggle, Ball Stop Shoulder	7234011* 7234246
H	End Stopper	7241432

*This item is different from the one illustrated

TECHNICAL DATA SHEET: 1424

Structural Post Mounting System (0.8kN Tension)



APPLICATION:

0.8kN pretension is recommended due to the typical post fixing strength.

19kN energy absorbers are NOT recommended due to the typical post fixing strength.

HLL Energy Absorbers may be required at both ends of the system based on layout configuration. (Number of brackets, span length, number of users, etc.)

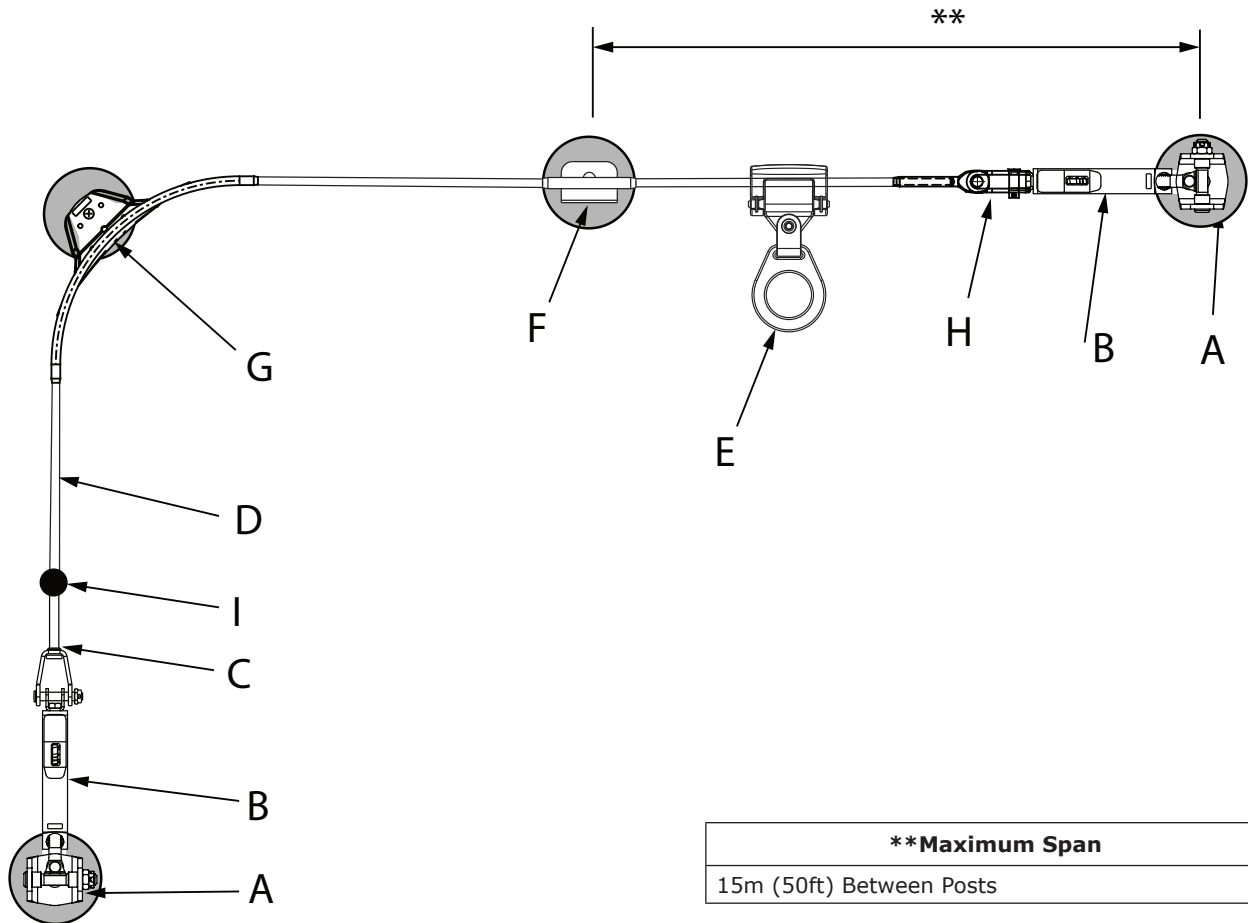

**Maximum Span
15m (50ft) Between Posts

	Component	Part Number
A	Straight Eye	7240122
B	11kN Peak Force, 0.8kN System Tension Energy Absorber	7241422
C	Hex Swage Stud, Pass Through	7241430
D	8mm 7x7 SS Cable 8mm 1x19 Stainless Steel Cable	7240211 7240212*
E	Detachable Traveler - No Wheels	7241420
F	Intermediate Bracket Variable Intermediate Bracket 45 Degree Intermediate Bracket	7241412 7241413* 7241415*
G	90 Degree Post Mount Corner 45 Degree Post Mount Corner	7241408 7241411*
H	Hex Swage Toggle Hex Swage Toggle, Ball Stop Shoulder	7234011* 7234246
I	End Stopper	7241432

*This item is different from the one illustrated

TECHNICAL DATA SHEET: 7241422

11kN Peak Force, 0.8kN System Tension Energy Absorber

Part No: 7241422



Fall Protection

APPLICATION:

Inline energy absorber with an 11kN (2500 lbf) peak arrest force for use with 22.2 kN (5000 lbf) end anchor strength. Includes 0.8kN (180 lbf) system tension indicating spring. Total elongation 1.2m (48").

Maximum 4 users capacity, 6kN (1350lbf) or 8kN (1800lbf) peak force connecting device, dependent on system layout.

Cable Tensioning: 0.8kN

Operating Temperature Range: 120°C (248°F) to -50°C (-58°F)

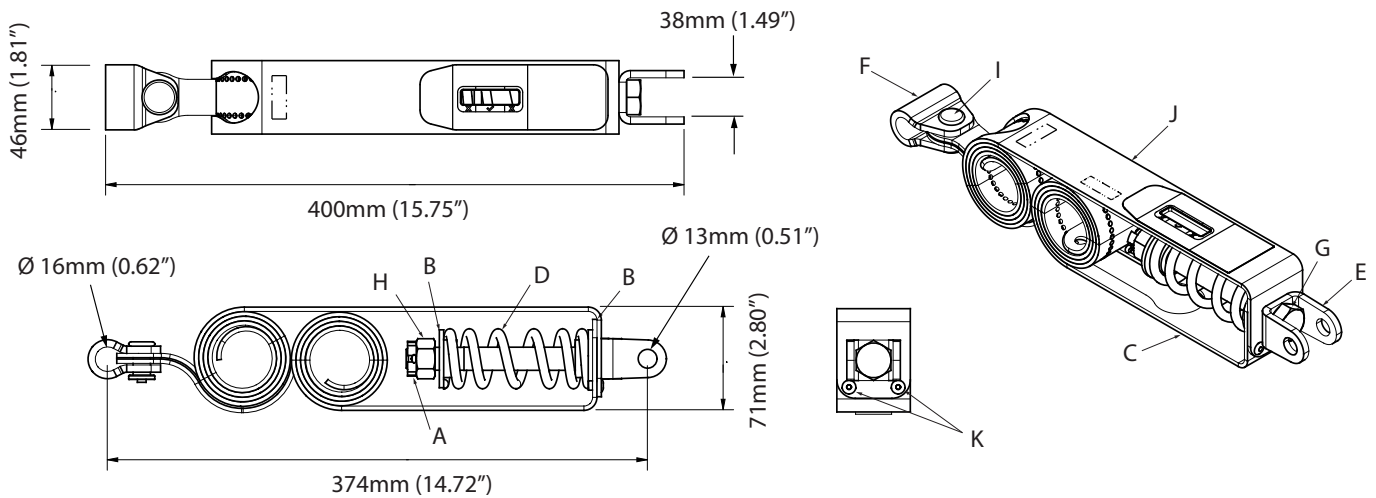

PART SPECIFICATION:

Net Weight kg (lb)	Minimum Breaking Strength kN (lb)	Peak Deployment Force kN (lbf)	Average Deployment Force kN (lbf)	Total Elongation m (ft)
2.9 (6.4)	38 (8540)	11 (2500)	9 (2020)	1.2 (4)

COMPONENT SPECIFICATION:

	Qty.	Component	Material	Finish
A	1	Cotter Pin	316 Stainless Steel	Natural
B	2	M16 Shoulder Washer	316 Stainless Steel	Natural
C	1	Energy Absorber Forming	316 Stainless Steel	Electropolished
D	1	Spring	316 Stainless Steel	Black Power Coat
E	1	System Clevis	316 Stainless Steel	Electropolished
F	1	Anchoring Clevis	316 Stainless Steel	Electropolished
G	1	M16 Bolt	316 Stainless Steel	Natural
H	1	M16 Castle Nut	316 Stainless Steel	Natural
I	1	Rivet, Energy Absorber	316 Stainless Steel	Natural
J	1	Energy Absorber Forming	316 Stainless Steel	Electropolished
K	1	Rivet	A4 (316) Stainless Steel	Natural

TECHNICAL DATA SHEET: 7241424

19kN Peak Force, 0.8kN System Tension Energy Absorber

Part No: 7241424



Fall Protection

APPLICATION:

Inline energy absorber with an 19kN (4270 lbf) peak arrest force for use with 38 kN (8550 lbf) end anchor strength. Includes 0.8kN (180 lbf) system tension indicating spring. Total elongation 0.61m (24").

Maximum 4 users capacity, 6kN (1350lbf) or 8kN (1800lbf) peak force connecting device, dependent on system layout.

Cable Tensioning: 0.8kN

Operating Temperature Range: 120°C (248°F) to -50°C (-58°F)

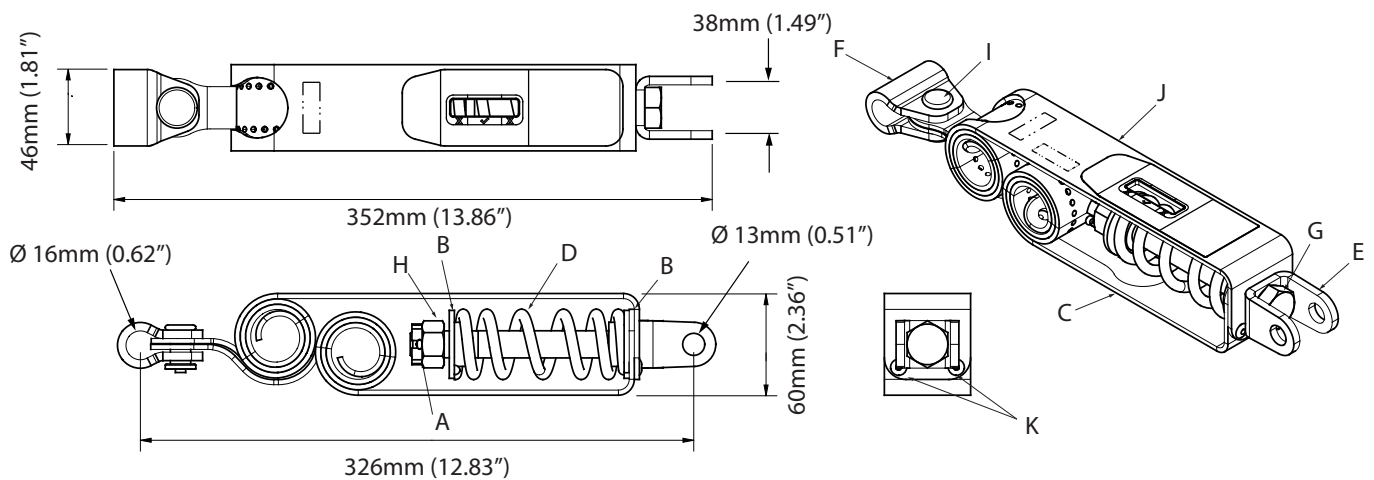

PART SPECIFICATION:

Net Weight kg (lb)	Minimum Breaking Strength kN (lb)	Peak Deployment Force kN (lbf)	Average Deployment Force kN (lbf)	Total Elongation m (ft)
2.2 (4.9)	38 (8540)	19 (4270)	16 (3600)	0.6 (2)

COMPONENT SPECIFICATION:

	Qty.	Component	Material	Finish
A	1	Cotter Pin	316 Stainless Steel	Natural
B	2	M16 Shoulder Washer	316 Stainless Steel	Natural
C	1	Energy Absorber Forming	316 Stainless Steel	Electropolished
D	1	Spring	316 Stainless Steel	Red Power Coat
E	1	System Clevis	316 Stainless Steel	Electropolished
F	1	Anchoring Clevis	316 Stainless Steel	Electropolished
G	1	M16 Bolt	316 Stainless Steel	Natural
H	1	M16 Castle Nut	316 Stainless Steel	Natural
I	1	Rivet, Energy Absorber	316 Stainless Steel	Natural
J	1	Energy Absorber Forming	316 Stainless Steel	Electropolished
K	1	Rivet	A4 (316) Stainless Steel	Natural

TECHNICAL DATA SHEET: 7241425

19kN Peak Force, 5kN System Tension Energy Absorber

Part No: 7241425



Fall Protection

APPLICATION:

Inline energy absorber with an 19kN (4270 lbf) peak arrest force for use with 38 kN (8550 lbf) end anchor strength. Includes 5kN (1125 lbf) system tension indicating spring. Total elongation 0.61m (24").

Maximum 4 users capacity, 6kN (1350lbf) or 8kN (1800lbf) peak force connecting device, dependent on system layout.

Cable Tensioning: 5kN

Operating Temperature Range: 120°C (248°F) to -50°C (-58°F)

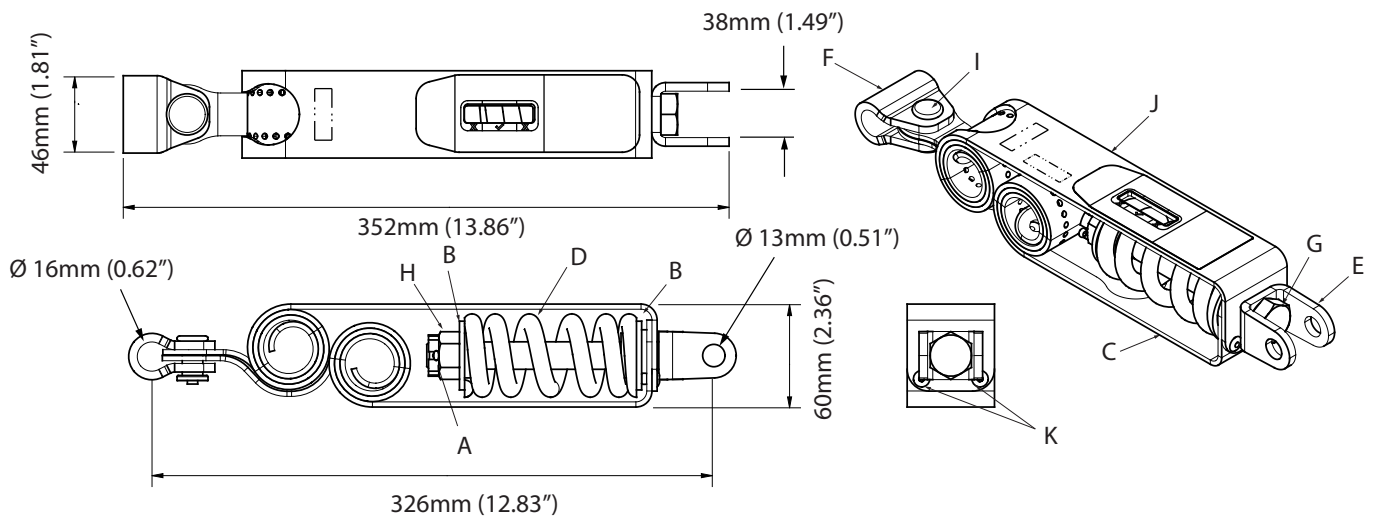

PART SPECIFICATION:

Net Weight kg (lb)	Minimum Breaking Strength kN (lb)	Peak Deployment Force kN (lbf)	Average Deployment Force kN (lbf)	Total Elongation m (ft)
2.5 (5.5)	38 (8540)	19 (4270)	16 (3600)	0.6 (2)

COMPONENT SPECIFICATION:

Qty.	Component	Material	Finish	
A	1	Cotter Pin	316 Stainless Steel	Natural
B	2	M16 Shoulder Washer	316 Stainless Steel	Natural
C	1	Energy Absorber Forming	316 Stainless Steel	Electropolished
D	1	Spring	316 Stainless Steel	Red Power Coat
E	1	System Clevis	316 Stainless Steel	Electropolished
F	1	Anchoring Clevis	316 Stainless Steel	Electropolished
G	1	M16 Bolt	316 Stainless Steel	Natural
H	1	M16 Castle Nut	316 Stainless Steel	Natural
I	1	Rivet, Energy Absorber	316 Stainless Steel	Natural
J	1	Energy Absorber Forming	316 Stainless Steel	Electropolished
K	1	Rivet	A4 (316) Stainless Steel	Natural

TECHNICAL DATA SHEET: 7241428

Dampener, 5kN

Part No: 7241428



Fall Protection

APPLICATION:

For use in systems where horizontal lifeline energy absorption is not required but tension indication is. Also can be used in systems where mechanical and thermal cyclic loading are likely as a means to reduce the effects these external loads have on the system components through changes in tension.

Cable Tensioning: 5kN

Operating Temperature Range: 120°C (248°F) to -50°C (-58°F)

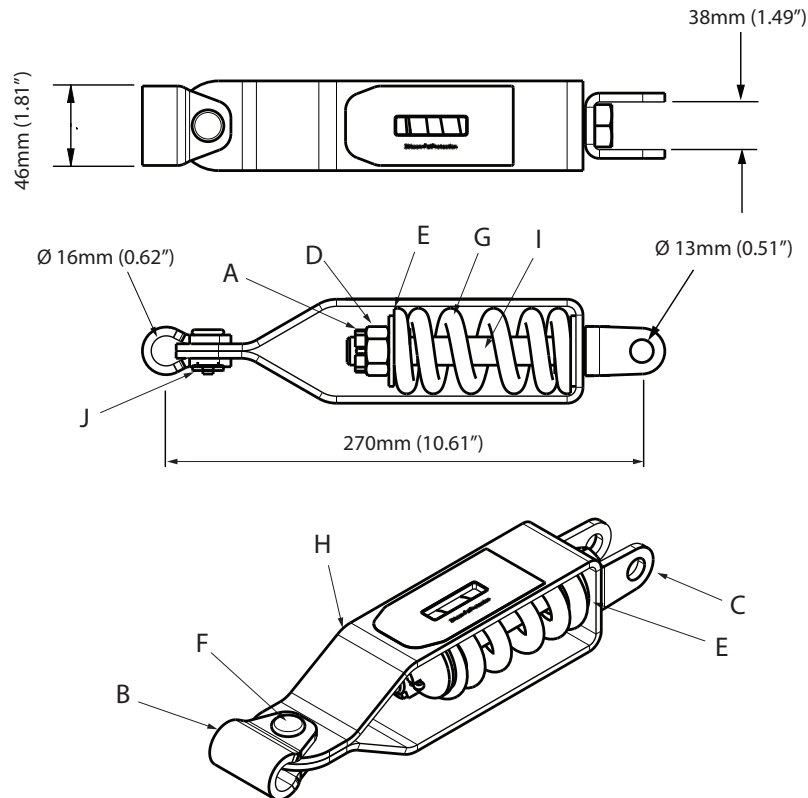

PART SPECIFICATION:

Net Weight kg (lb)	Minimum Breaking Strength kN (lb)
1.8 (4)	38 (8540)

COMPONENT SPECIFICATION:

	Qty.	Component	Material	Finish
A	1	Cotter Pin	316 Stainless Steel	Natural
B	1	Anchoring Clevis	316 Stainless Steel	Electropolished
C	1	System Clevis	316 Stainless Steel	Electropolished
D	1	M16 Castle Nut	316 Stainless Steel	Natural
E	2	M16 Shoulder Washer	316 Stainless Steel	Natural
F	1	Rivet	316 Stainless Steel	Natural
G	1	Spring	316 Stainless Steel	Red Powder Coat
H	1	Forming Dampener	316 Stainless Steel	Electropolished
I	1	M16 Bolt	316 Stainless Steel	Natural
J	1	Rivet Cup	316 Stainless Steel	Natural

TECHNICAL DATA SHEET: 7241429

Dampener, Small, 0.8kN

Part No: 7241429



Fall Protection

APPLICATION:

For use in systems where horizontal lifeline energy absorption is not required but tension indication is. Also can be used in systems where mechanical and thermal cyclic loading are likely as a means to reduce the effects these external loads have on the system components through changes in tension.

Cable Tensioning: 0.8kN

Operating Temperature Range: 120°C (248°F) to -50°C (-58°F)

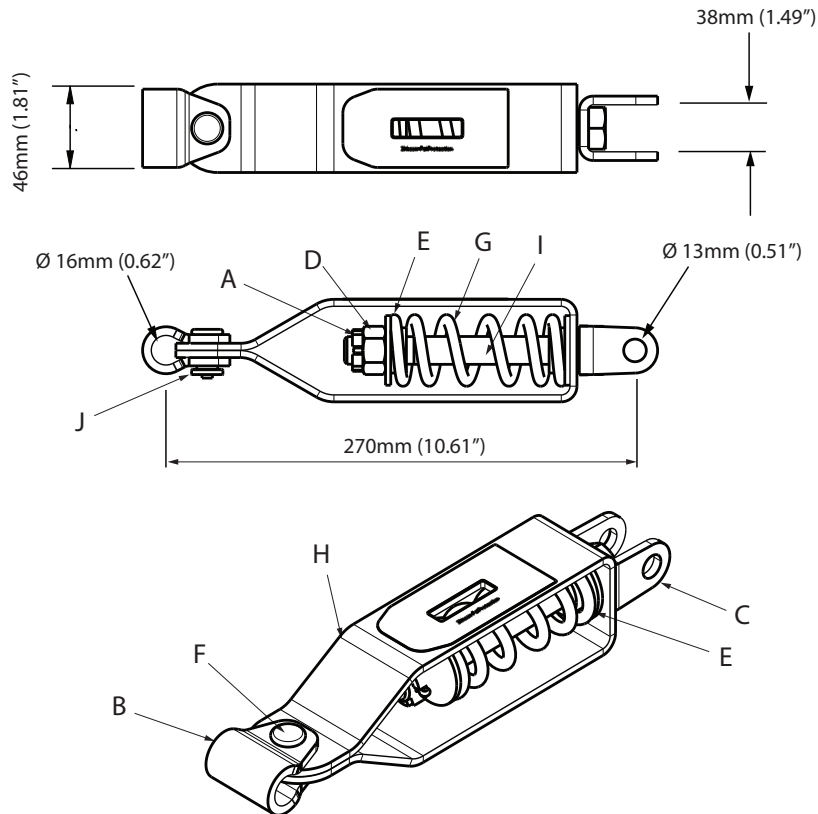

PART SPECIFICATION:

Net Weight kg (lb)	Minimum Breaking Strength kN (lb)
1.8 (4)	38 (8540)

COMPONENT SPECIFICATION:

	Qty.	Component	Material	Finish
A	1	Cotter Pin	316 Stainless Steel	Electropolished
B	1	Anchoring Clevis	316 Stainless Steel	Electropolished
C	1	System Clevis	316 Stainless Steel	Natural
D	1	M16 Castle Nut	316 Stainless Steel	Natural
E	2	M16 Shoulder Washer	316 Stainless Steel	Natural
F	1	Rivet	316 Stainless Steel	Natural
G	1	Spring	316 Stainless Steel	Black Powder Coat
H	1	Forming Dampener	316 Stainless Steel	Electropolished
I	1	M16 Bolt	316 Stainless Steel	Natural
J	1	Rivet Cup	316 Stainless Steel	Natural

TECHNICAL DATA SHEET: 7241420

Detachable Traveler - No Wheels

Part No: 7241420



Fall Protection

APPLICATION:

For use as an attachment device for a single user in conjunction with DBI-SALA 8mm Horizontal Lifeline Systems.

To prolong the life of the product, do not leave on the system when not in use.

Operating Temperature Range: 120°C (248°F) to -50°C (-58°F)

Capacity: 1 user, 140 kg (310lbs) maximum including clothing and tools.

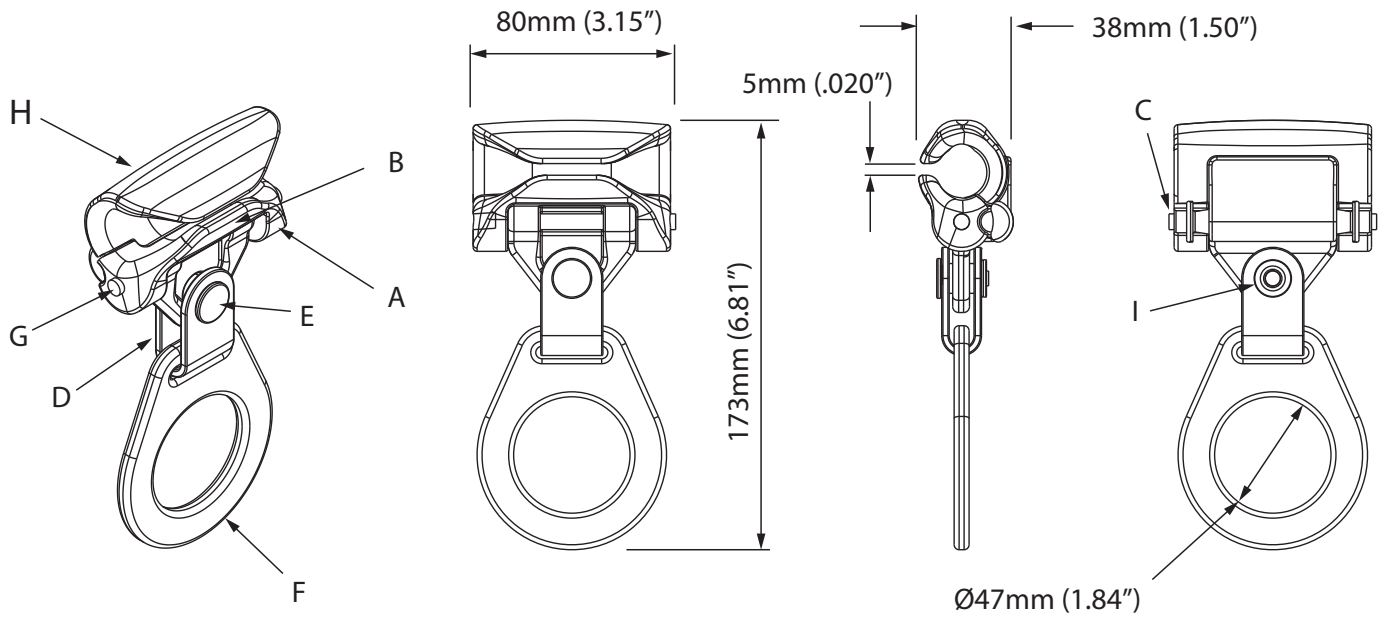

PART SPECIFICATION:

Net Weight kg (lb)	Minimum Breaking Strength kN (lb)
0.78 (1.7)	22.2 (5000)

COMPONENT SPECIFICATION:

	Qty.	Component	Material	Finish
A	1	Detachable Lower Body	17-4 Stainless Steel	Nickel
B	2	Spring (Internal)	316 Stainless Steel	Natural
C	2	Detachable Locking Pin	15-5 Stainless Steel	Electropolished
D	1	Traveler Clevis	316 Stainless Steel	Electropolished
E	1	Traveler Rivet	316 Stainless Steel	Natural
F	1	D-Ring	316 Stainless Steel	Electropolished
G	1	Pin	316 Stainless Steel	Natural
H	1	Upper Body	17-4 Stainless Steel	Nickel
I	1	Rivet Cup	316 Stainless Steel	Natural

TECHNICAL DATA SHEET: 7241421

Overhead Traveler

Part No: 7241421



Fall Protection

APPLICATION:

For use as an attachment device for a single user in conjunction with DBI-SALA 8mm Horizontal Lifeline Systems. This traveler is permanently installed during system installation.

Operating Temperature Range: 120°C (248°F) to -50°C (-58°F)

Capacity: 1 user, 140 kg (310lbs) maximum including clothing and tools.

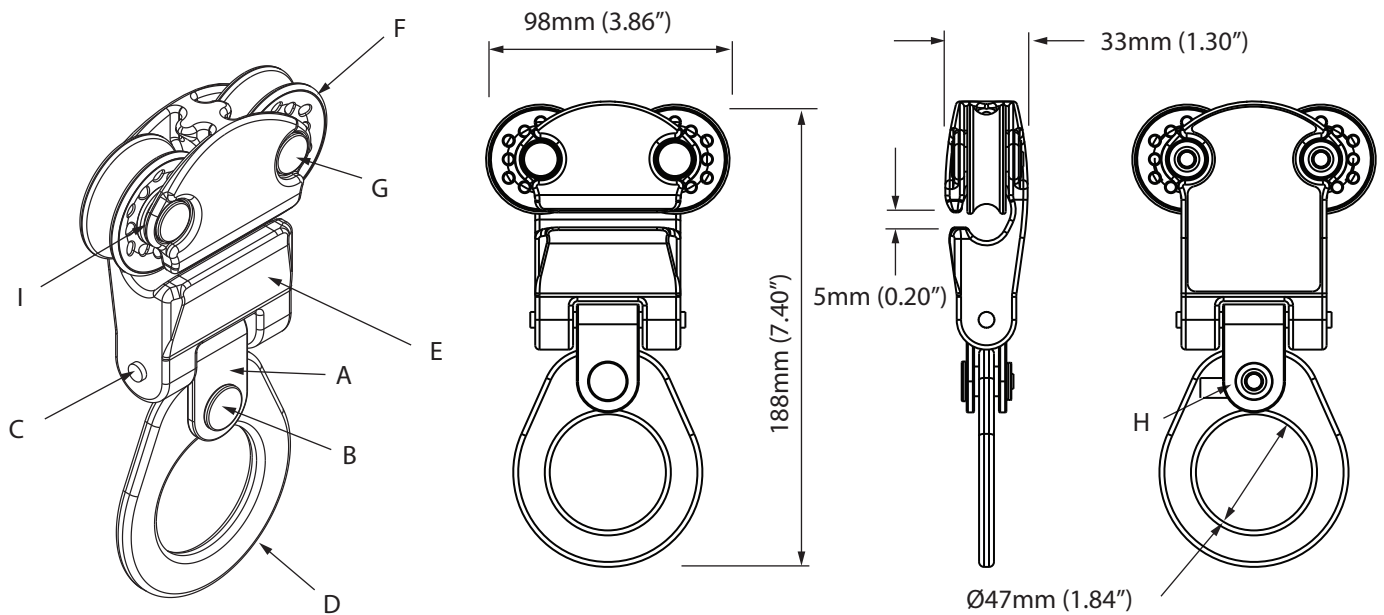

PART SPECIFICATION:

Net Weight kg (lb)	Minimum Breaking Strength kN (lb)
1.2 (2.6)	22.2 (5000)

COMPONENT SPECIFICATION:

	Qty.	Component	Material	Finish
A	1	Clevis Traveler	316 Stainless Steel	Electropolished
B	1	Traveler Rivet	316 Stainless Steel	Natural
C	1	Pin	316 Stainless Steel	Natural
D	1	D-Ring	316 Stainless Steel	Electropolished
E	1	Traveler Body	17-4 Stainless Steel	Nickel
F	2	Traveler Wheel	316 Stainless Steel	Natural
G	2	OH Rivet	316 Stainless Steel	Natural
H	3	Rivet Cup	316 Stainless Steel	Natural
I	4	Bearing	300 & 400 Stainless Steel	Nickel & Mineral Oil

TECHNICAL DATA SHEET: 7240211

8mm 7x7 SS Cable

Part No: 7240211



Fall Protection

APPLICATION:

Used for 8m Permanent Horizontal Lifeline applications.

Operating Temperature Range: 120°C (248°F) to -50°C (-58°F)

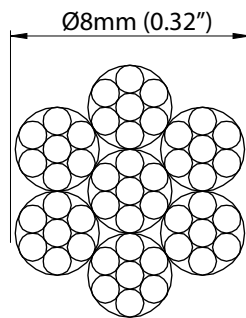

PART SPECIFICATION:

Net Weight kg (lb)	Minimum Breaking Strength kN (lb)
0.242 / m (0.162 / ft)	38.7 (8700)

COMPONENT SPECIFICATION:

	Qty.	Component	Material	Finish
A	1	8mm 7 x 7 Stainless Steel Cable	316 Stainless Steel	Natural

TECHNICAL DATA SHEET: 7240212

8mm 1x19 Stainless Steel Cable

Part No: 7240212



Fall Protection

APPLICATION:

Used for 8m Permanent Horizontal Lifeline applications.

Operating Temperature Range: 120°C (248°F) to -50°C (-58°F)

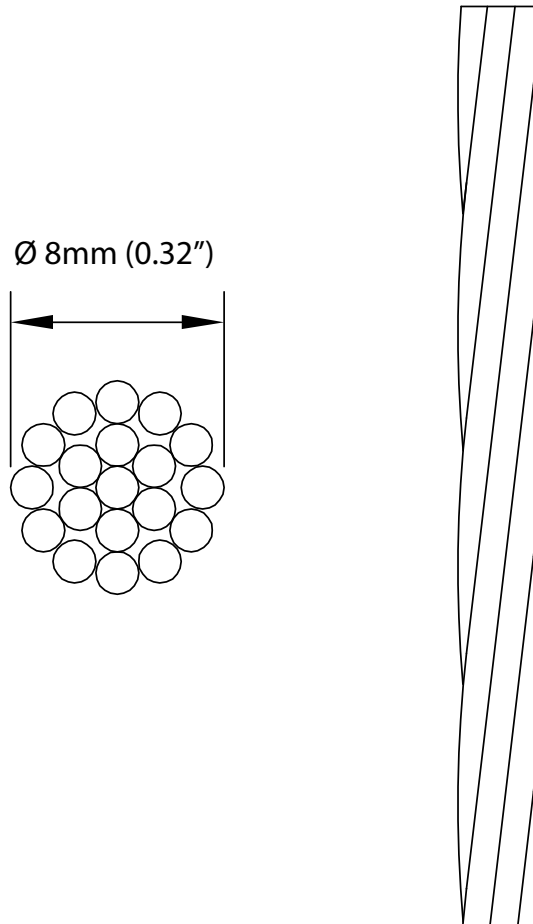

PART SPECIFICATION:

Net Weight kg (lb)	Minimum Breaking Strength kN (lb)
0.31 / m (0.21 / ft)	47 (10600)

COMPONENT SPECIFICATION:

	Qty.	Component	Material	Finish
A	1	8mm 1x19 Stainless Steel Cable	316 Stainless Steel	Natural

TECHNICAL DATA SHEET: 7241417

Anchor Plate Standard

Part No: 7241417



Fall Protection

APPLICATION:

The Standard Anchor Plate is designed as a multipurpose end anchor for wall and overhead horizontal systems where the mounting application requires more than a single fixing in order to achieve the required anchor strength.

Minimum grade A4-70 M12 (or 316 Stainless Steel, 70,000psi, 1/2 -13 inch) fasteners should be used to fix bracket to structure at a recommended torque of 50Nm (37 ft-lbf). Fixing shall support at least twice the load values stated in the technical report from the 3M DBI-SALA Installed Systems Calculation Software for the system layout, components, number of users, and SRL or Lanyard connecting device.

Cable Tensioning: 0.8 or 5.0 kN

Operating Temperature Range: 120°C (248°F) to -50°C (-58°F)

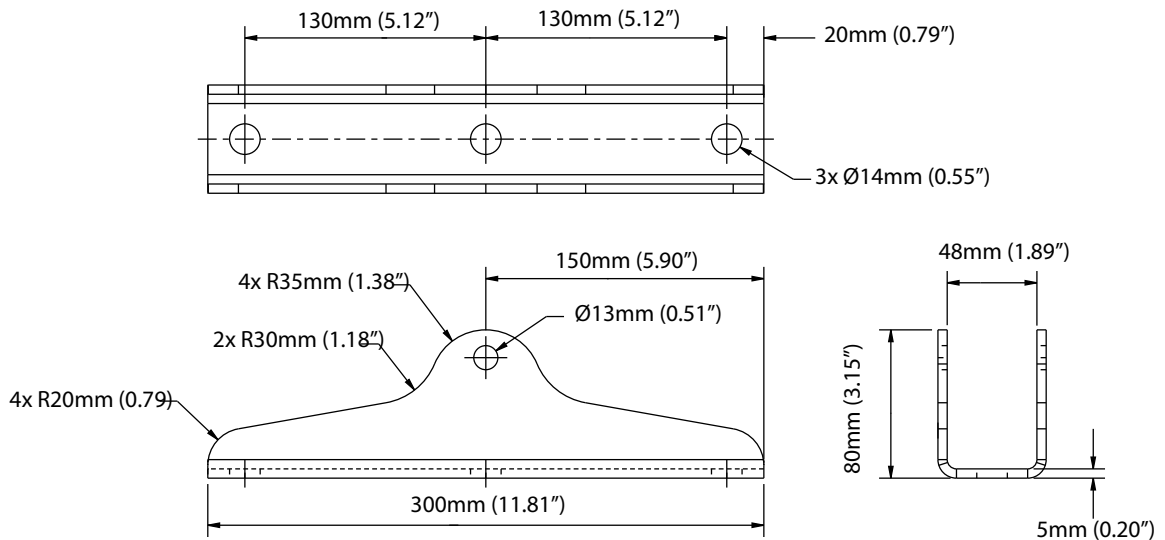
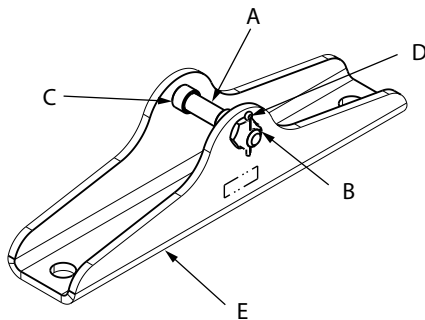

PART SPECIFICATION:

Net Weight kg (lb)	Minimum Breaking Strength kN (lb)
1.5 (3.3)	45 (10000)

COMPONENT SPECIFICATION:

	Qty.	Component	Material	Finish
A	1	Pin	316 Stainless Steel	Natural
B	1	M12 Castle Nut	316 Stainless Steel	Natural
C	2	Spacer	Nylon	Natural
D	1	Split Pin	316 Stainless Steel	Natural
E	1	Anchor Bracket	316 Stainless Steel	Electropolished

TECHNICAL DATA SHEET: 7240122

Straight Eye

Part No: 7240122



Fall Protection

APPLICATION:

The Straight Eye is designed as a multipurpose end anchor for wall and overhead horizontal systems.

Minimum grade A4-70 M16 (or 316 Stainless Steel, 70,000psi, 5/8-11 inch) fastener should be used to fix bracket to structure at a recommended torque of 50Nm (37 ft-lbf). Fixing shall support at least twice the load values stated in the technical report from the 3M DBI-SALA Installed Systems Calculation Software for the system layout, components, number of users, and SRL or Lanyard connecting device.

Operating Temperature Range: 120°C (248°F) to -50°C (-58°F)

Safe to load in direction AA & BB. DO NOT LOAD IN DIRECTION CC

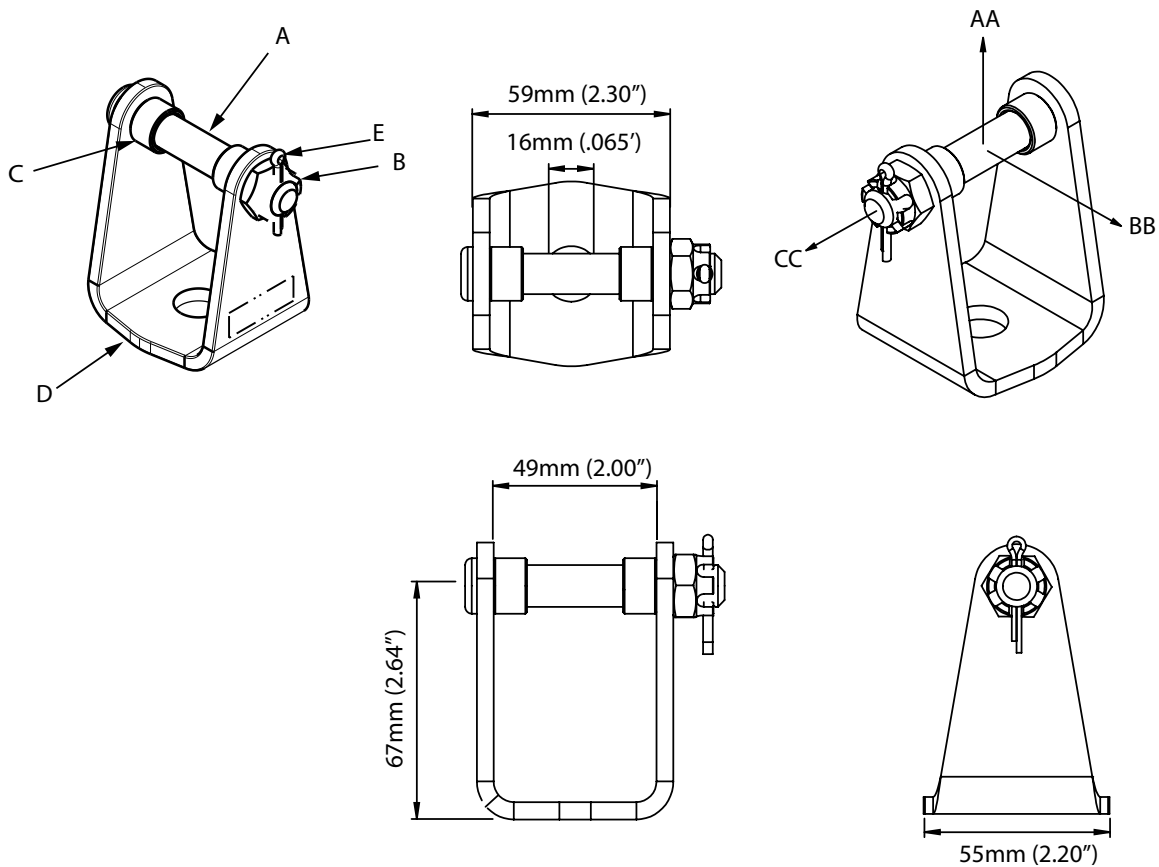

PART SPECIFICATION:

Net Weight kg (lb)	Minimum Breaking Strength kN (lb)
0.35 (0.8)	45 (10000)

COMPONENT SPECIFICATION:

	Qty.	Component	Material	Finish
A	1	Pin	316 Stainless Steel	Natural
B	1	M12 Castle Nut	316 Stainless Steel	Natural
C	1	Spacer	Nylon	Natural
D	1	Forming	316 Stainless Steel	Electropolished
E	1	Split Pin	316 Stainless Steel	Natural

TECHNICAL DATA SHEET: 7241412

Intermediate Bracket

Part No: 7241412



Fall Protection

APPLICATION:

Standard intermediate bracket for post, floor, or wall mount.

Minimum grade A4-70 M12 (or 316 Stainless Steel, 70,000psi, 1/2 -13 inch) fasteners should be used to fix bracket to structure at a recommended torque of 50Nm (37 ft-lbf) [30Nm (22 ft-lbf) for fitting to a Roofsafe Anchor].

Fixing shall support at least twice the load values stated in the technical report from the 3M DBI-SALA Installed Systems Calculation Software for the system layout, components, number of users, and SRL or Lanyard connecting device.

Tip over post mounted applications are not currently supported by the calculation software and should be designed for 22.2 kN (5000 lbf) in all directions of loading.

Cable Tensioning: 0.8 kN or 5.0 kN

Operating Temperature Range: 120°C (248°F) to -50°C (-58°F)

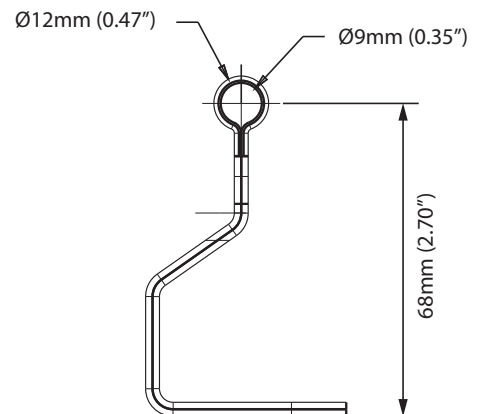
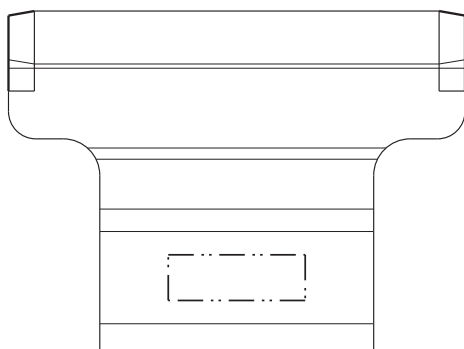
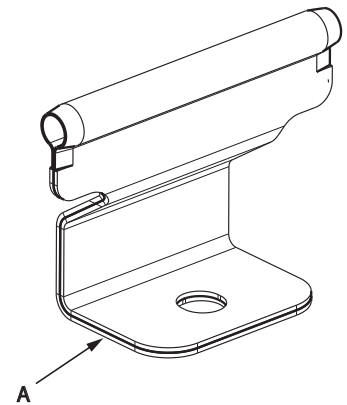
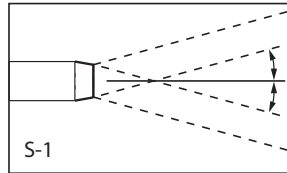
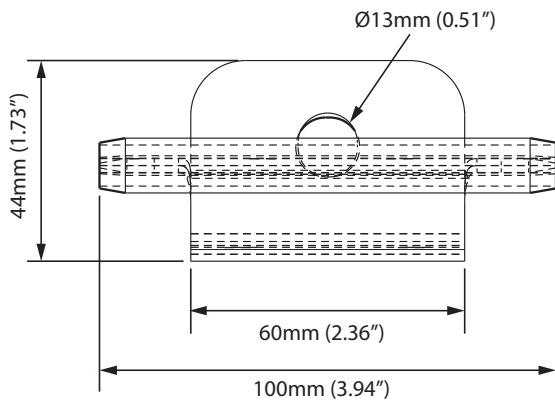
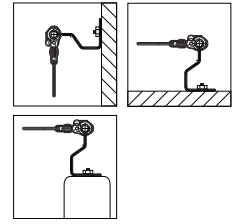

PART SPECIFICATION:

Net Weight kg (lb)	Minimum Breaking Strength kN (lb)	(S-1) Cable Exit Angle
0.2 (0.4)	38 (8540)	15° Maximum (0° for 5kN Tension)

COMPONENT SPECIFICATION:

Qty.	Component	Material	Finish
A 1	Intermediate Bracket	316 Stainless Steel	Electropolished

TECHNICAL DATA SHEET: 7241413

Variable Intermediate Bracket

Part No: 7241413



Fall Protection

APPLICATION:

Used to accommodate system cable redirection at small angles. Field formable at time of installation. Post, floor or wall mounting.

Minimum grade A4-70 M12 (or 316 Stainless Steel, 70,000psi, ½ -13 inch) fasteners should be used to fix bracket to structure at a recommended torque of 50Nm (37 ft-lbf) [30Nm (22 ft-lbf) for fitting to a Roofsafe Anchor].

Fixing shall support at least twice the load values stated in the technical report from the 3M DBI-SALA Installed Systems Calculation Software for the system layout, components, number of users, and SRL or Lanyard connecting device.

Tip over post mounted applications are not currently supported by the calculation software and should be designed for 22.2 kN (5000 lbf) in all directions of loading.

Cable Tensioning: 0.8 kN

Operating Temperature Range: 120°C (248°F) to -50°C (-58°F)

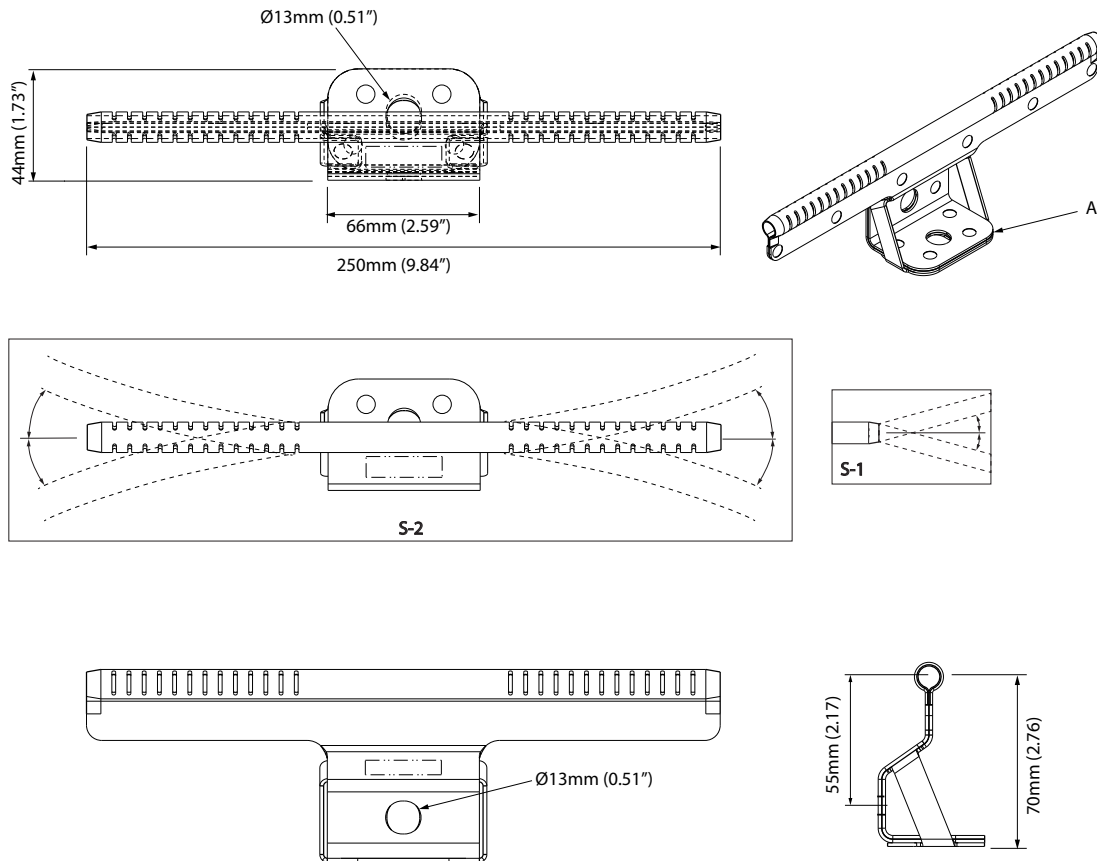
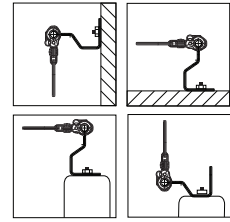

PART SPECIFICATION:

Net Weight kg (lb)	Breaking Strength kN (lb)	(S-1) Cable Exit Angle	(S-2) Formation Angle
0.3 (0.7)	30 (6750)	15° Maximum	15° Maximum

COMPONENT SPECIFICATION:

Qty.	Component	Material	Finish
A 1	Variable Intermediate Bracket	316 Stainless Steel	Electropolished

TECHNICAL DATA SHEET: 7241414

Variable Mount Angle Intermediate Bracket

Part No:7241414



Fall Protection

APPLICATION:

Intermediate bracket with adjustability in mounting angle for installation onto underside of pitched roof while maintaining optimum traveler engagement angle.

Cable Tensioning: 0.8 kN or 5.0 kN

Minimum grade A4-70 M12 (or 316 Stainless Steel, 70,000psi, ½ -13 inch) fastener should be used to fix the bracket to the structure at a recommended torque of 50 Nm (37 ft-lbf). Fixing shall support at least twice the load values stated in the technical report from the 3M DBI-SALA Installed Systems Calculation Software for the system layout, components, number of users, and SRL or Lanyard connecting device.

Operating Temperature Range: 120°C (248°F) to -50°C (-58°F)

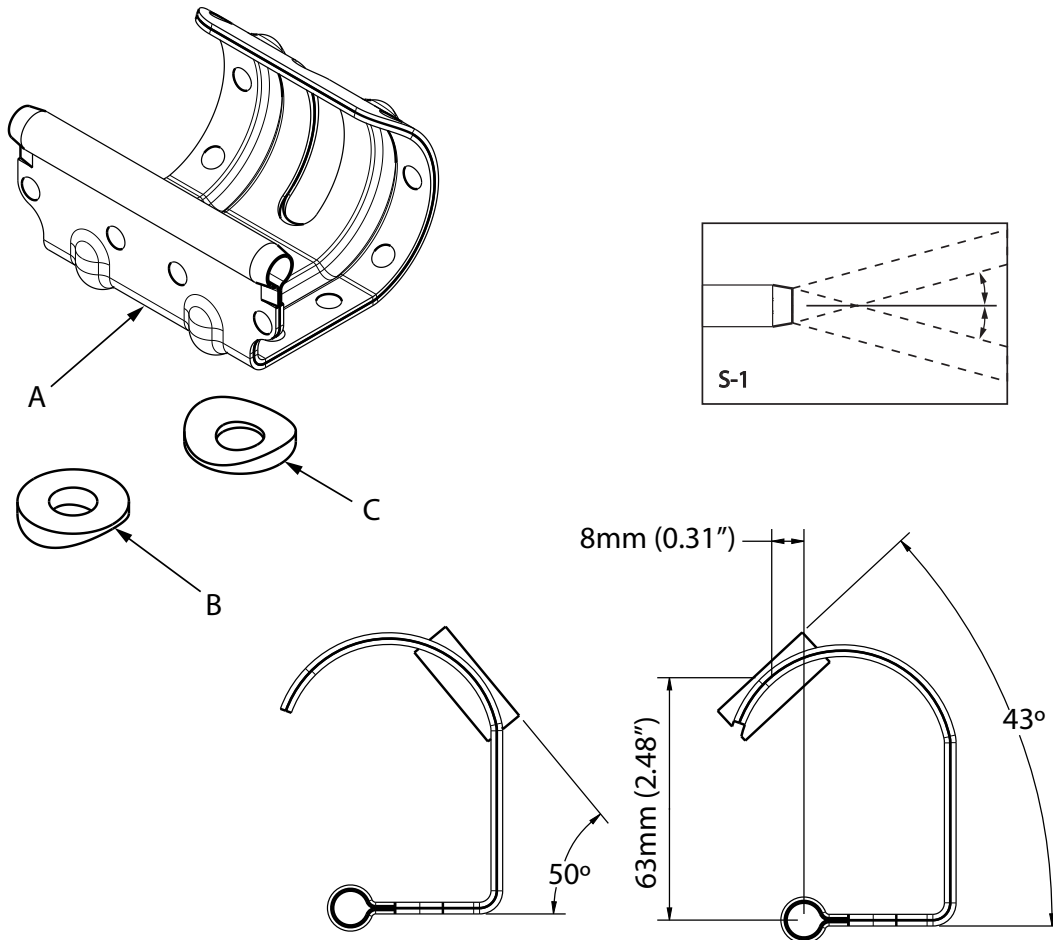
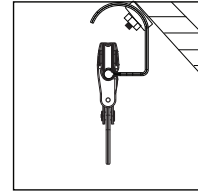

PART SPECIFICATION:

Net Weight kg (lb)	Minimum Breaking Strength kN (lb)	(S-1) Cable Exit Angle
0.28 (0.6)	24 (5400)	15° Maximum (0° for 5kN Tension)

COMPONENT SPECIFICATION:

	Qty.	Component	Material	Finish
A	1	Formed Bracket	316 Stainless Steel	Electropolished
B	1	Saddle Washer, Upper	316 Stainless Steel	Natural
C	1	Saddle Washer, Lower	316 Stainless Steel	Natural

TECHNICAL DATA SHEET: 7241415

45 Degree Intermediate Bracket

Part No: 7241415



Fall Protection

APPLICATION:

Intermediate bracket for post, floor, or wall mount when a 45 degree interfacing angle is desired over the standard vertical bracket. Post, floor or wall mounting.

Minimum grade A4-70 M12 (or 316 Stainless Steel, 70,000psi, 1/2 -13 inch) fasteners should be used to fix bracket to structure at a recommended torque of 50Nm (37 ft-lbf). Fixing shall support at least twice the load values stated in the technical report from the 3M DBI-SALA Installed Systems Calculation Software for the system layout, components, number of users, and SRL or Lanyard connecting device.

Cable Tensioning: 0.8 kN or 5.0 kN

Operating Temperature Range: 120°C (248°F) to -50°C (-58°F)

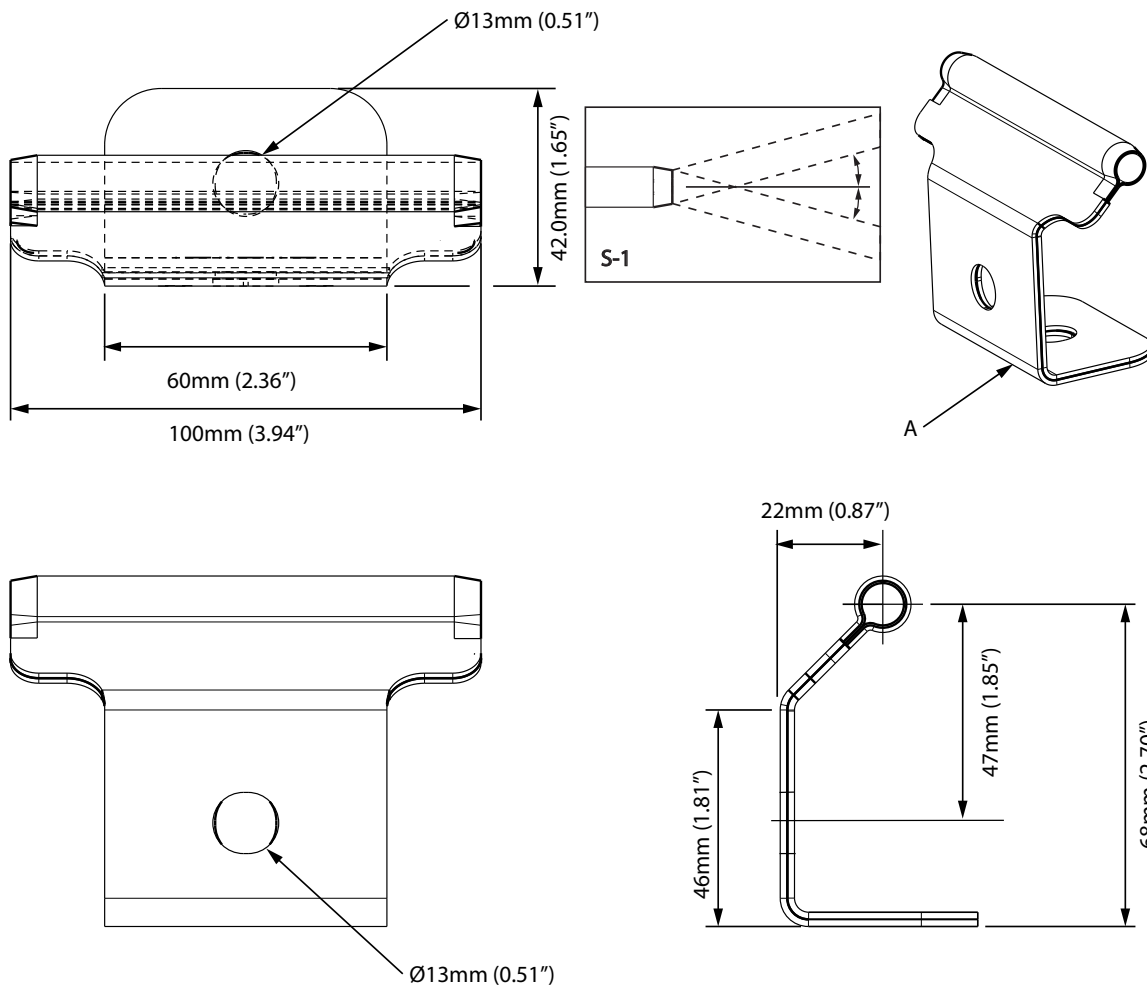
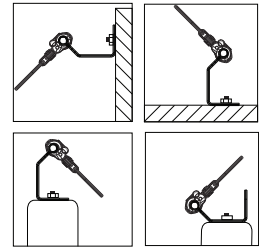

PART SPECIFICATION:

Net Weight kg (lb)	Minimum Breaking Strength kN (lb)	(S-1) Cable Exit Angle
0.19 (0.4)	24 (5400)	15° Maximum (0° for 5kN Tension)

COMPONENT SPECIFICATION:

	Qty.	Component	Material	Finish
A	1	45 Degree Intermediate Bracket	316 Stainless Steel	Electropolished

TECHNICAL DATA SHEET: 7241406

90 Degree Internal Corner

Part No:7241406



Fall Protection

APPLICATION:

Used to allow 90 degree internal direction change in the system.

Minimum grade A4-70 M12 (or 316 Stainless Steel, 70,000psi, 1/2 -13 inch) fasteners should be used to fix bracket to structure at a recommended torque of 50Nm (37 ft-lbf). Fixings shall support bracket load of 38kN (8550lbf) in the plane of the lifeline and a load of 24kN (5400lbf) perpendicular to the lifeline.

Cable Tensioning: 0.8 kN or 5kN

Operating Temperature Range: 120°C (248°F) to -50°C (-58°F)

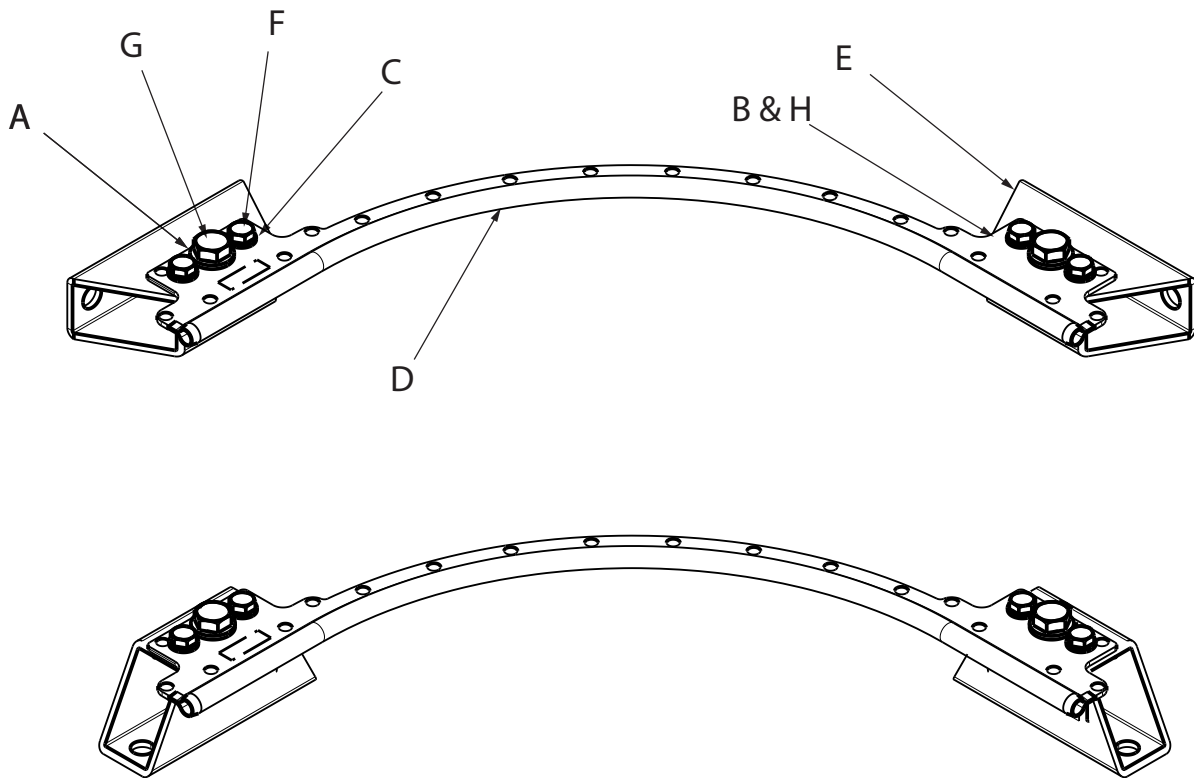
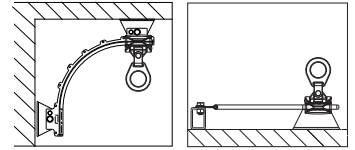

PART SPECIFICATION:

Net Weight kg (lb)	Minimum Breaking Strength kN (lb)
1.8 (4)	38 (8540)

COMPONENT SPECIFICATION:

	Qty.	Component	Material	Finish
A	2	M12 Washer	316 Stainless Steel	Natural
B	2	M12 Nut	316 Stainless Steel	Natural
C	4	M8 Washer	316 Stainless Steel	Natural
D	1	Corner Bracket	316 Stainless Steel	Electropolished
E	2	Corner Bracket Mount	316 Stainless Steel	Electropolished
F	4	M8 x 1.25 x 15mm Bolt	316 Stainless Steel	Natural
G	2	M12 x 1.75 x 25mm Bolt	316 Stainless Steel	Natural
H	2	M12 Lock Washer	316 Stainless Steel	Natural

TECHNICAL DATA SHEET: 7241406

90 Degree Internal Corner

Part No 7241406



Fall Protection

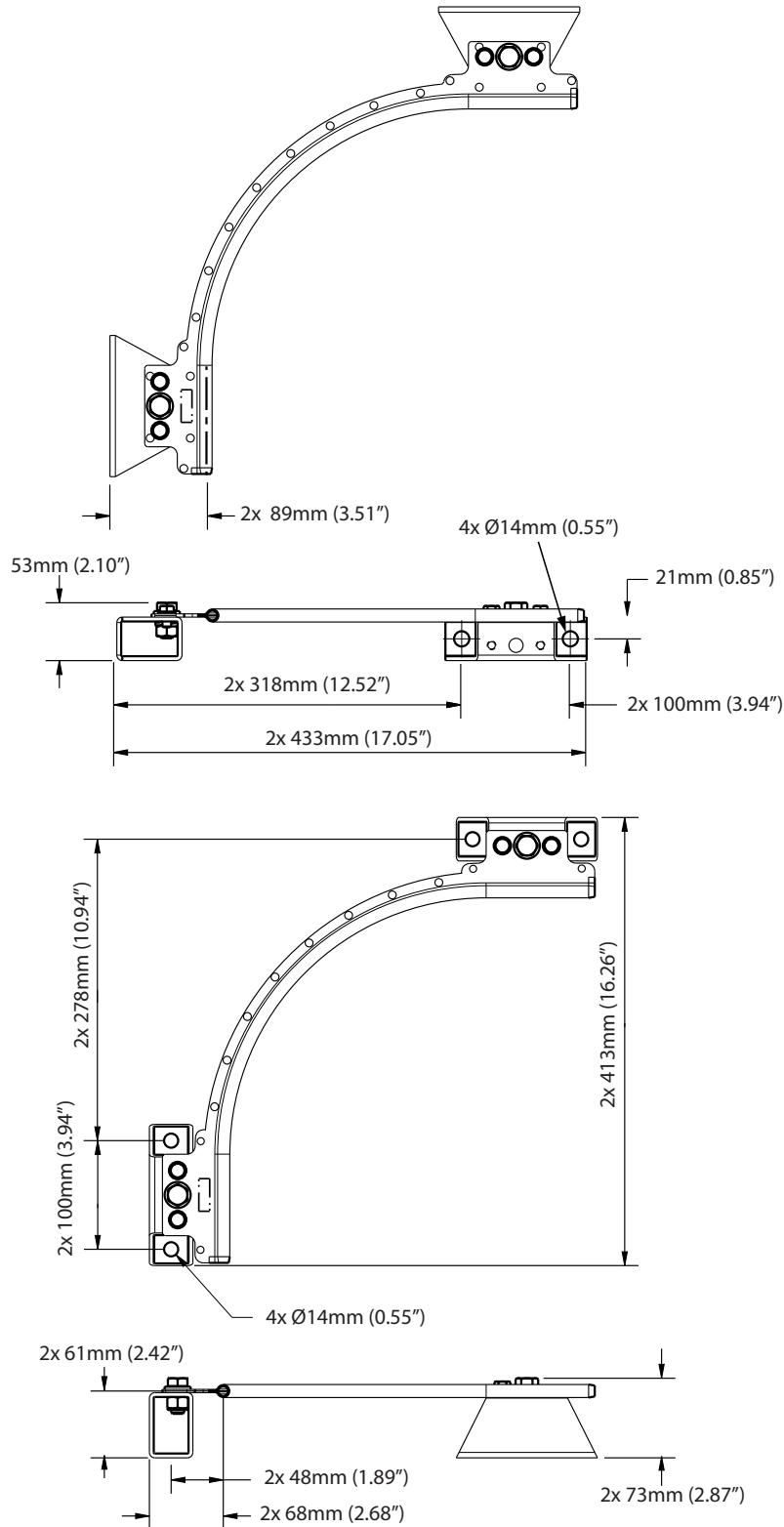

TECHNICAL DATA SHEET: 7241526

90 Degree Internal Corner, Wall Mount

Part No 7241526



Fall Protection

APPLICATION:

This corner is recommended for wall mount applications from knee to d-ring height.

Minimum grade A4-70 M12 (or 316 Stainless Steel, 70,000psi, ½ -13 inch) fastener should be used to fix bracket to structure at a recommended torque of 50Nm (37 ft-lbf). Fixings shall support bracket load of 38kN (8550lbf) in the plane of the lifeline and a load of 24kN (5400lbf) perpendicular to the lifeline.

Cable Tensioning: 0.8 kN or 5kN

Operating Temperature Range: 120°C (248°F) to -50°C (-58°F)

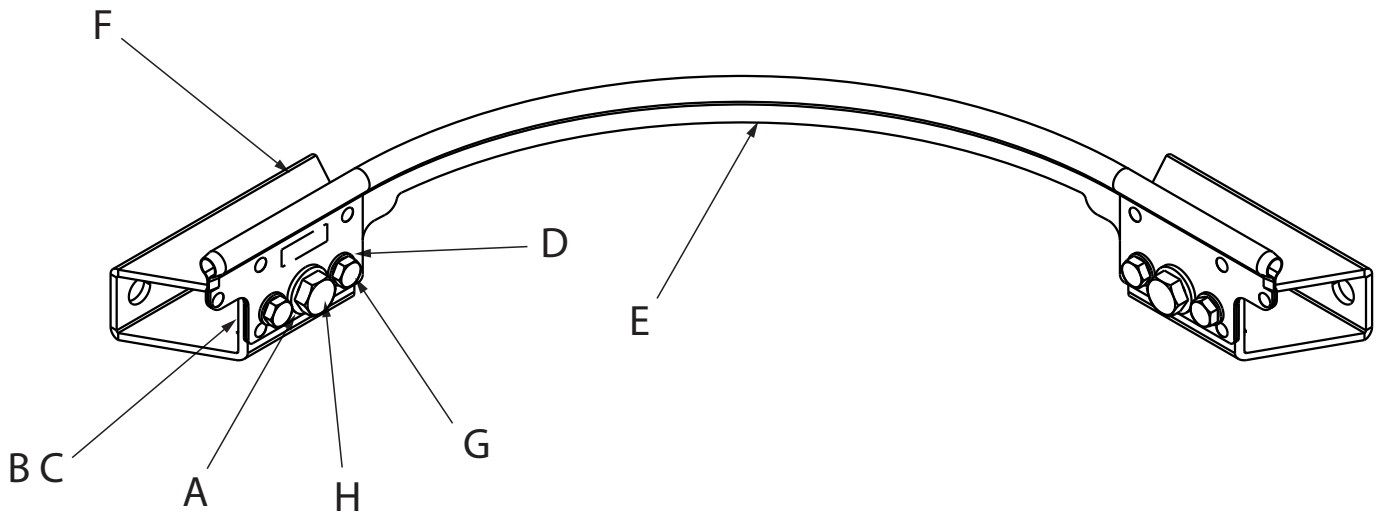
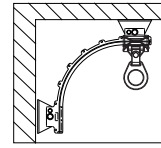

PART SPECIFICATION:

Net Weight kg (lb)	Minimum Breaking Strength kN (lb)
1.8 (4)	38 (8540)

COMPONENT SPECIFICATION:

	Qty.	Component	Material	Finish
A	2	M12 Washer	316 Stainless Steel	Natural
B	2	M12 Nut	316 Stainless Steel	Natural
C	2	M12 Lock Washer	316 Stainless Steel	Natural
D	4	M8 Washer	316 Stainless Steel	Electropolished
E	1	Corner Bracket	316 Stainless Steel	Electropolished
F	2	Corner Bracket Mount	316 Stainless Steel	Natural
G	4	M8 x 1.25 x 15mm Bolt	316 Stainless Steel	Natural
H	2	M12 x 1.75 x 25mm Bolt	316 Stainless Steel	Natural

TECHNICAL DATA SHEET: 7241526

90 Degree Internal Corner, Wall Mount

Part No 7241526



Fall Protection

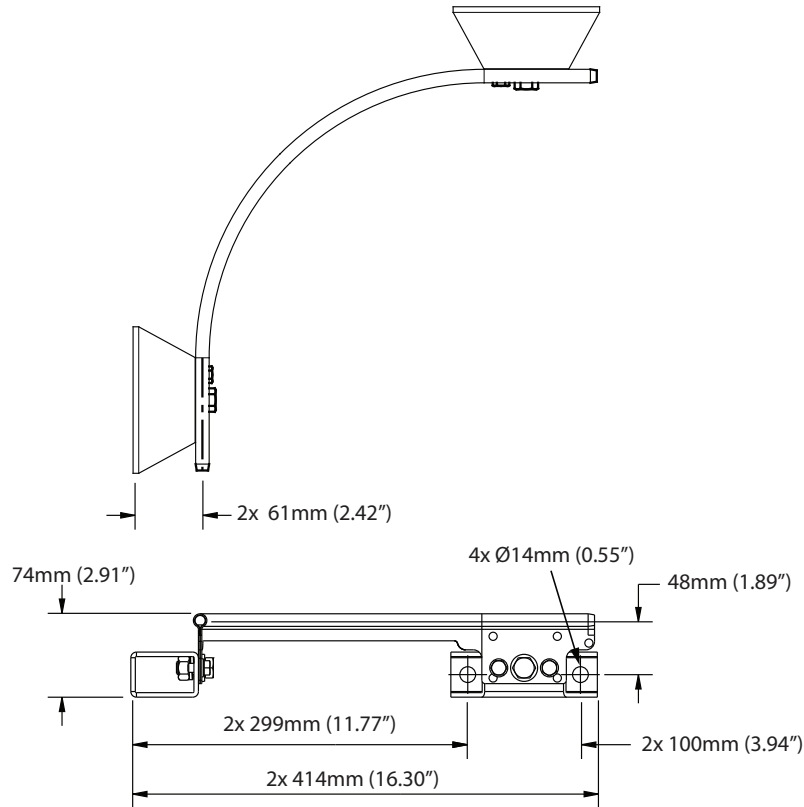

TECHNICAL DATA SHEET: 7241407

90 Degree External Corner

Part No: 7241407



Fall Protection

APPLICATION:

Used to allow 90 degree internal direction change in the system.

Minimum grade A4-70 M12 (or 316 Stainless Steel, 70,000psi, 1/2 -13 inch) fastener should be used to fix bracket to structure at a recommended torque of 50Nm (37 ft-lbf). Fixings shall support bracket load of 38kN (8550lbf) in the plane of the lifeline and a load of 24kN (5400lbf) perpendicular to the lifeline

Cable Tensioning: 0.8 kN or 5kN

Operating Temperature Range: 120°C (248°F) to -50°C (-58°F)

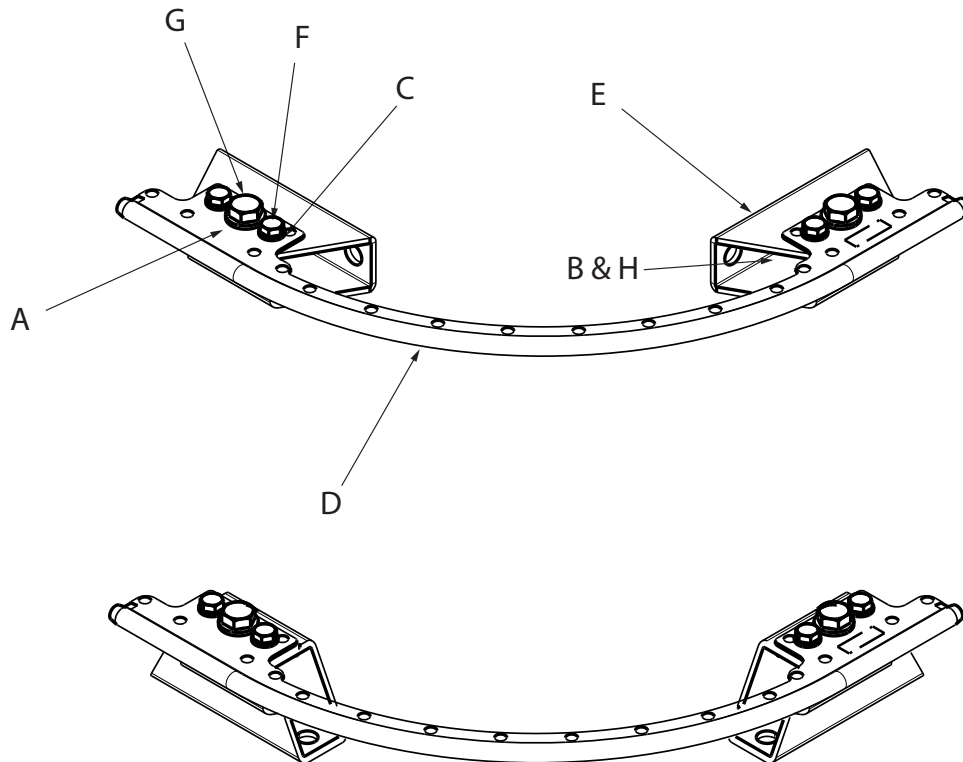
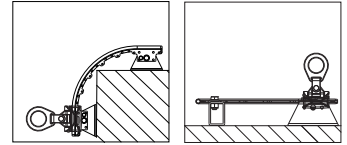

PART SPECIFICATION:

Net Weight kg (lb)	Minimum Breaking Strength kN (lb)
1.9 (4.2)	38 (8540)

COMPONENT SPECIFICATION:

	Qty.	Component	Material	Finish
A	2	M12 Washer	316 Stainless Steel	Natural
B	2	M12 Nut	316 Stainless Steel	Natural
C	4	M8 Washer	316 Stainless Steel	Natural
D	1	Corner Bracket	316 Stainless Steel	Electropolished
E	2	Corner Bracket Mount	316 Stainless Steel	Electropolished
F	4	M8 x 1.25 x 15mm Bolt	316 Stainless Steel	Natural
G	2	M12 x 1.75 x 25mm Bolt	316 Stainless Steel	Natural
H	2	M12 Lock Washer	316 Stainless Steel	Natural

TECHNICAL DATA SHEET: 7241407

90 Degree External Corner

Part No 7241407



Fall Protection

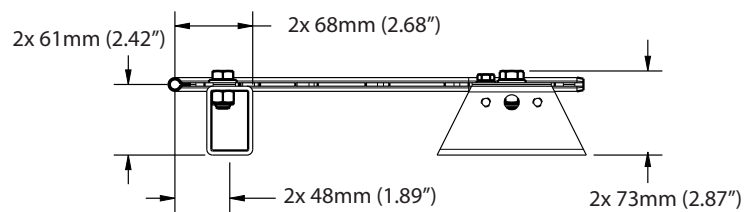
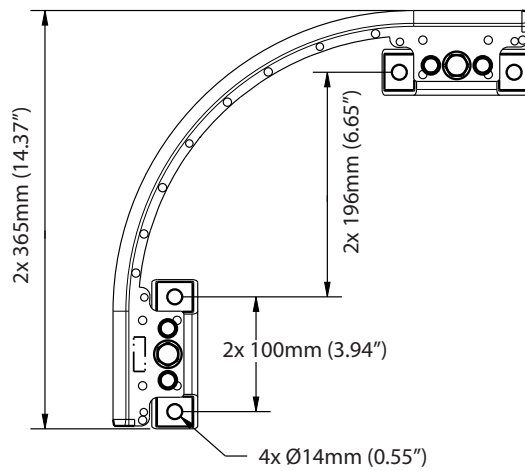
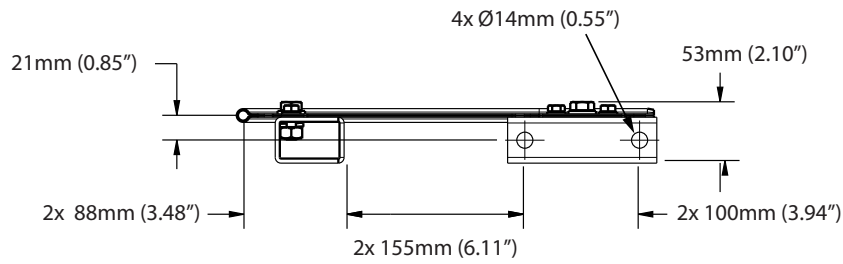
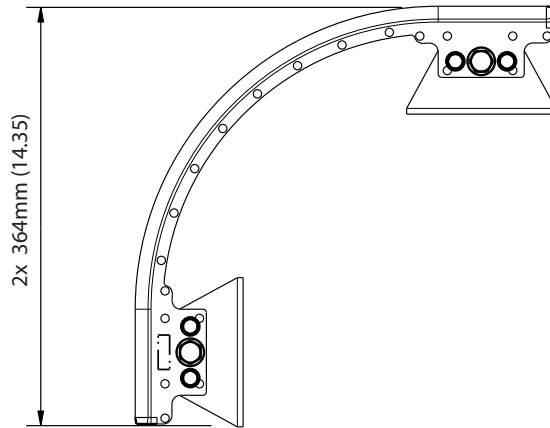

TECHNICAL DATA SHEET: 7241408

90 Degree Post Mount Corner

Part No: 7241408



Fall Protection

APPLICATION:

90 degree corner bracket for post or floor mount.

Used to accommodate system cable redirection at 90 degree angles. Only to be used with 7241422 11kN energy absorber or on a Roofsafe End/Corner Module.

Minimum grade A4-70 M12 (or 316 Stainless Steel, 70,000psi, 1/2 -13 inch) fasteners should be used to fix bracket to structure at a recommended torque of 50Nm (37 ft-lbf) [30Nm (22 ft-lbf) for fitting to a Roofsafe Anchor].

Fixing shall support at least twice the load values stated in the technical report from the 3M DBI-SALA Installed Systems Calculation Software for the system layout, components, number of users, and SRL or Lanyard connecting device.

Tip over post mounted applications are not currently supported by the calculation software and should be designed for 22.2 kN (5000 lbf) in all directions of loading.

Operating Temperature Range: 120°C (248°F) to -50°C (-58°F)

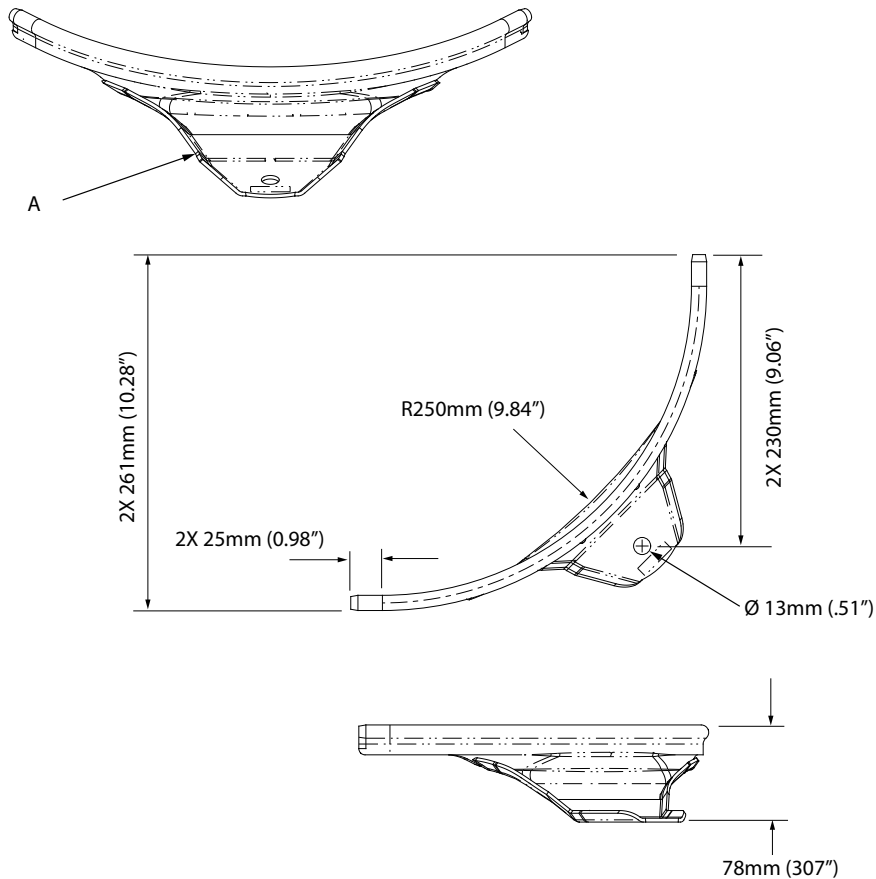

PART SPECIFICATION:

Net Weight kg (lb)	Minimum Breaking Strength kN (lb)
0.6 (1.32)	22.2 (5000)

COMPONENT SPECIFICATION:

Qty.	Component	Material	Finish
A 1	90 Degree Post Mount Corner	316 Stainless Steel	Electropolished

TECHNICAL DATA SHEET: 7241525

90 degree External Corner, Wall Mount

Part No: 7241525



Fall Protection

APPLICATION:

This corner is recommended for wall mount applications from knee to d-ring height.

Minimum grade A4-70 M12 (or 316 Stainless Steel, 70,000psi, 1/2 -13 inch) fastener should be used to fix bracket to structure at a recommended torque of 50Nm (37 ft-lbf). Fixings shall support bracket load of 38kN (8550lbf) in the plane of the lifeline and a load of 24kN (5400lbf) perpendicular to the lifeline

Cable Tensioning: 0.8 kN or 5kN

Operating Temperature Range: 120°C (248°F) to -50°C (-58°F)

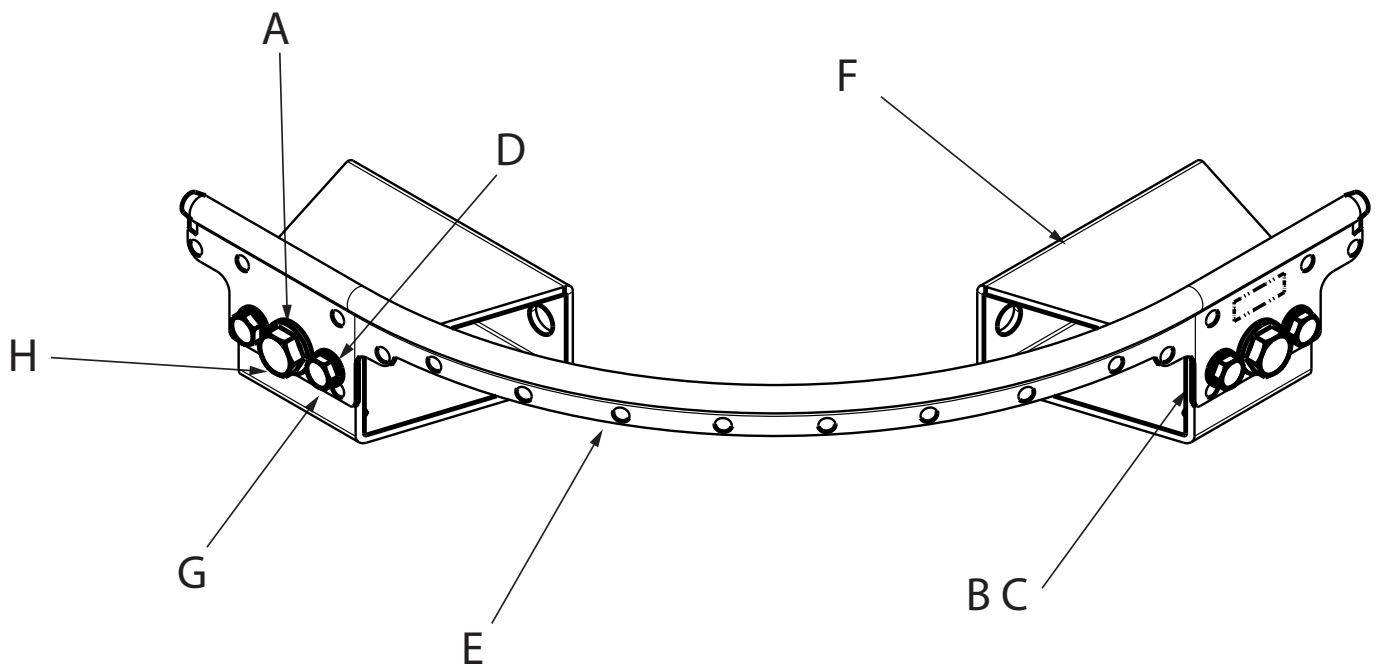
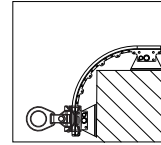

PART SPECIFICATION:

Net Weight kg (lb)	Minimum Breaking Strength kN (lb)
1.9 (4.2)	38 (8540)

COMPONENT SPECIFICATION:

	Qty.	Component	Material	Finish
A	2	M12 Washer	316 Stainless Steel	Natural
B	2	M12 Nut	316 Stainless Steel	Natural
C	2	M12 Lock Washer	316 Stainless Steel	Natural
D	4	M8 Washer	316 Stainless Steel	Natural
E	1	Corner Bracket	316 Stainless Steel	Electropolished
F	2	Corner Bracket Mount	316 Stainless Steel	Electropolished
G	2	M8 x 1.25 x 15mm Bolt	316 Stainless Steel	Natural
H	4	M12 x 1.75 x 25mm Bolt	316 Stainless Steel	Natural

TECHNICAL DATA SHEET: 7241525

90 degree External Corner, Wall Mount

Part No 7241525



Fall Protection

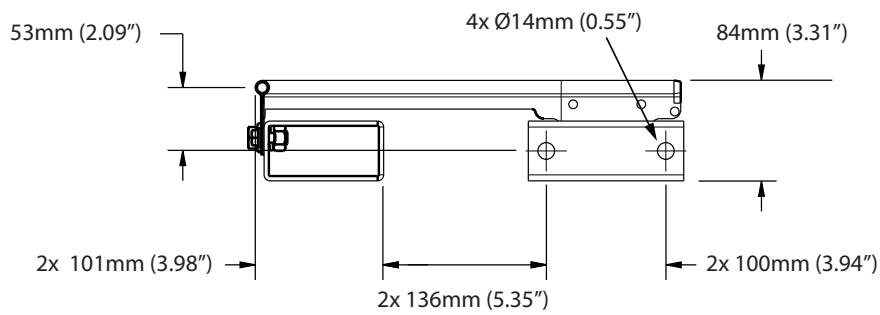
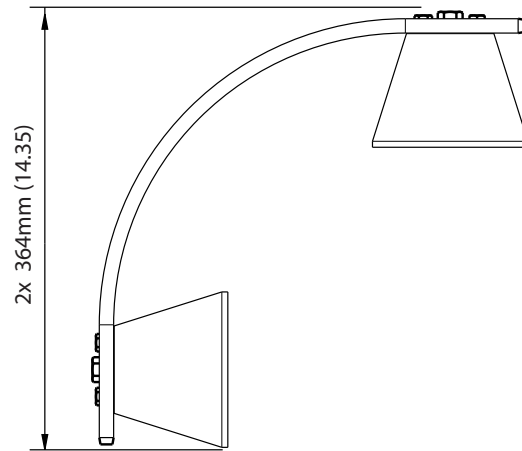

TECHNICAL DATA SHEET: 7241570

45 Degree Internal / External Corner, Wall Mount

Part No 7241570



Fall Protection

APPLICATION:

This corner is recommended for wall mount applications from knee to d-ring height.

Minimum grade A4-70 M12 (or 316 Stainless Steel, 70,000psi, 1/2 -13 inch) fastener should be used to fix bracket to structure at a recommended torque of 50Nm (37 ft-lbf). Fixings shall support bracket load of 38kN (8550lbf) in the plane of the lifeline and a load of 24kN (5400lbf) perpendicular to the lifeline.

Cable Tensioning: 0.8 kN or 5kN

Operating Temperature Range: 120°C (248°F) to -50°C (-58°F)

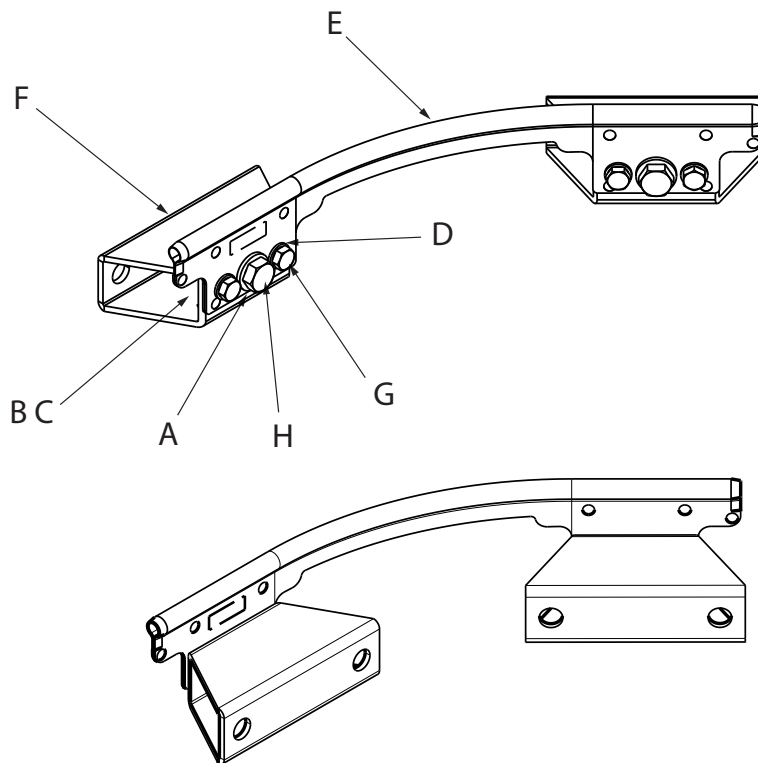
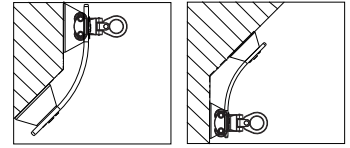

PART SPECIFICATION:

Net Weight kg (lb)	Minimum Breaking Strength kN (lb)
1.8 (4)	38 (8540)

COMPONENT SPECIFICATION:

	Qty.	Component	Material	Finish
A	2	M12 Washer	316 Stainless Steel	Natural
B	2	M12 Nut	316 Stainless Steel	Natural
C	2	M12 Lock Washer	316 Stainless Steel	Natural
D	4	M8 Washer	316 Stainless Steel	Natural
E	1	Corner Bracket	316 Stainless Steel	Electropolished
F	2	Corner Bracket Mount	316 Stainless Steel	Electropolished
G	4	M8 x 1.25 x 15mm Bolt	316 Stainless Steel	Natural
H	2	M12 x 1.75 x 25mm Bolt	316 Stainless Steel	Natural

TECHNICAL DATA SHEET: 7241570

45 Degree Internal / External Corner, Wall Mount

Part No 7241570



Fall Protection

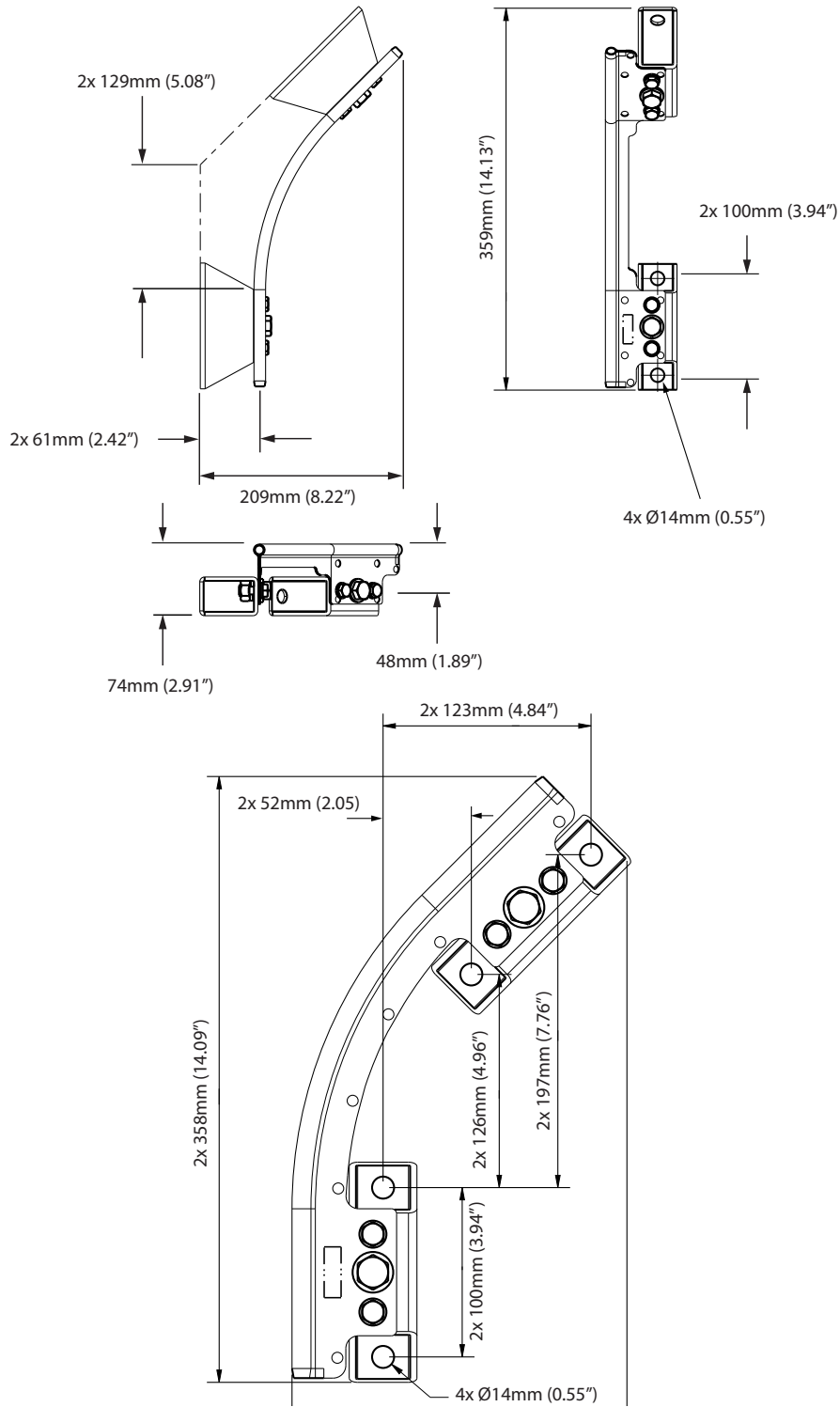

TECHNICAL DATA SHEET: 7241409

45 Degree Internal Corner

Part No: 7241409



Fall Protection

APPLICATION:

Used to allow 45 degree internal direction change in the system. .

Minimum grade A4-70 M12 (or 316 Stainless Steel, 70,000psi, 1/2 -13 inch) fastener should be used to fix bracket to structure at a recommended torque of 50Nm (37 ft-lbf). Fixings shall support bracket load of 38kN (8550lbf) in the plane of the lifeline and a load of 24kN (5400lbf) perpendicular to the lifeline

Cable Tensioning: 0.8 kN or 5kN

Operating Temperature Range: 120°C (248°F) to -50°C (-58°F)

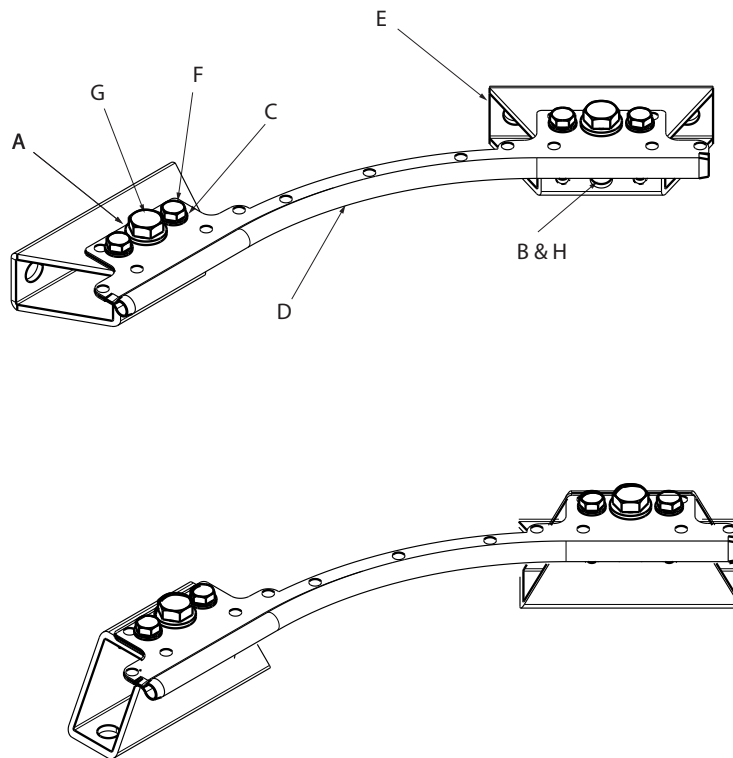
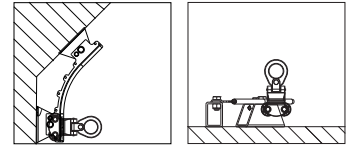

PART SPECIFICATION:

Net Weight kg (lb)	Minimum Breaking Strength kN (lb)
1.6 (3.5)	38 (8540)

COMPONENT SPECIFICATION:

	Qty.	Component	Material	Finish
A	2	M12 Washer	316 Stainless Steel	Natural
B	2	M12 Nut	316 Stainless Steel	Natural
C	4	M8 Washer	316 Stainless Steel	Natural
D	1	Corner Bracket	316 Stainless Steel	Electropolished
E	2	Corner Bracket Mount	316 Stainless Steel	Electropolished
F	4	M8 x 1.25 x 15mm Bolt	316 Stainless Steel	Natural
G	2	M12 x 1.75 x 25mm Bolt	316 Stainless Steel	Natural
H	2	M12 Lock Washer	316 Stainless Steel	Natural

TECHNICAL DATA SHEET: 7241409

45 Degree Internal Corner

Part No 7241409



Fall Protection

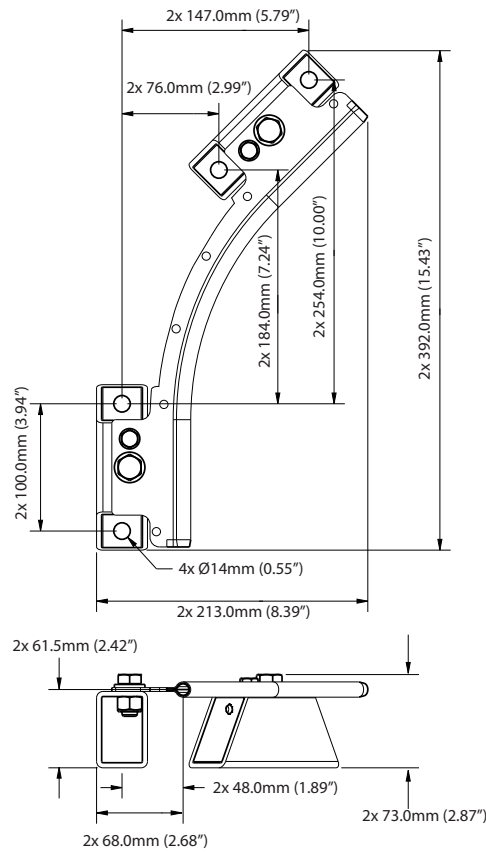
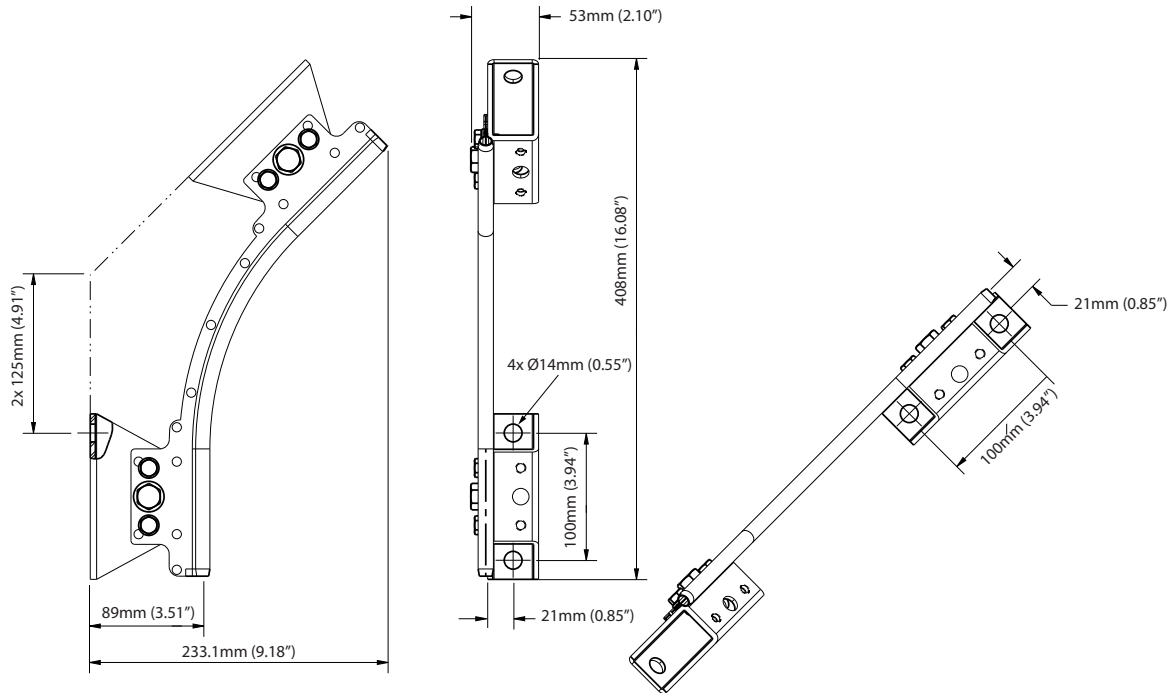

TECHNICAL DATA SHEET: 7241410

45 Degree External Corner

Part No: 7241410



Fall Protection

APPLICATION:

Used to allow 45 degree internal direction change in the system. .

Minimum grade A4-70 M12 (or 316 Stainless Steel, 70,000psi, ½ -13 inch) fastener should be used to fix bracket to structure at a recommended torque of 50Nm (37 ft-lbf). Fixings shall support bracket load of 38kN (8550lbf) in the plane of the lifeline and a load of 24kN (5400lbf) perpendicular to the lifeline

Cable Tensioning: 0.8 kN or 5kN

Operating Temperature Range: 120°C (248°F) to -50°C (-58°F)

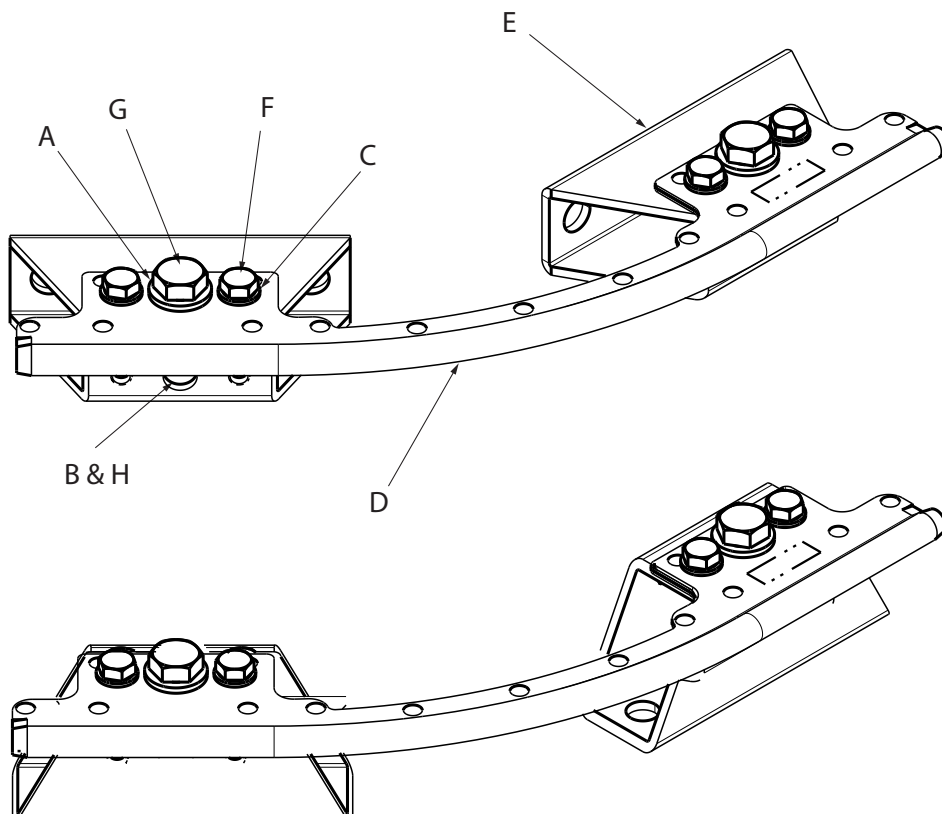
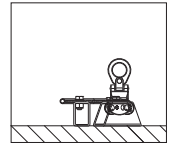
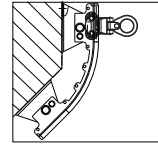

PART SPECIFICATION:

Net Weight kg (lb)	Minimum Breaking Strength kN (lb)
1.6 (3.5)	38 (8540)

COMPONENT SPECIFICATION:

	Qty.	Component	Material	Finish
A	2	M12 Washer	316 Stainless Steel	Natural
B	2	M12 Nut	316 Stainless Steel	Natural
C	4	M8 Washer	316 Stainless Steel	Natural
D	1	Corner Bracket	316 Stainless Steel	Electropolished
E	2	Corner Bracket Mount	316 Stainless Steel	Electropolished
F	4	M8 x 1.25 x 15mm Bolt	316 Stainless Steel	Natural
G	2	M12 x 1.75 x 25mm Bolt	316 Stainless Steel	Natural
H	2	M12 Lock Washer	316 Stainless Steel	Natural

TECHNICAL DATA SHEET: 7241410

45 Degree External Corner

Part No 7241410



Fall Protection

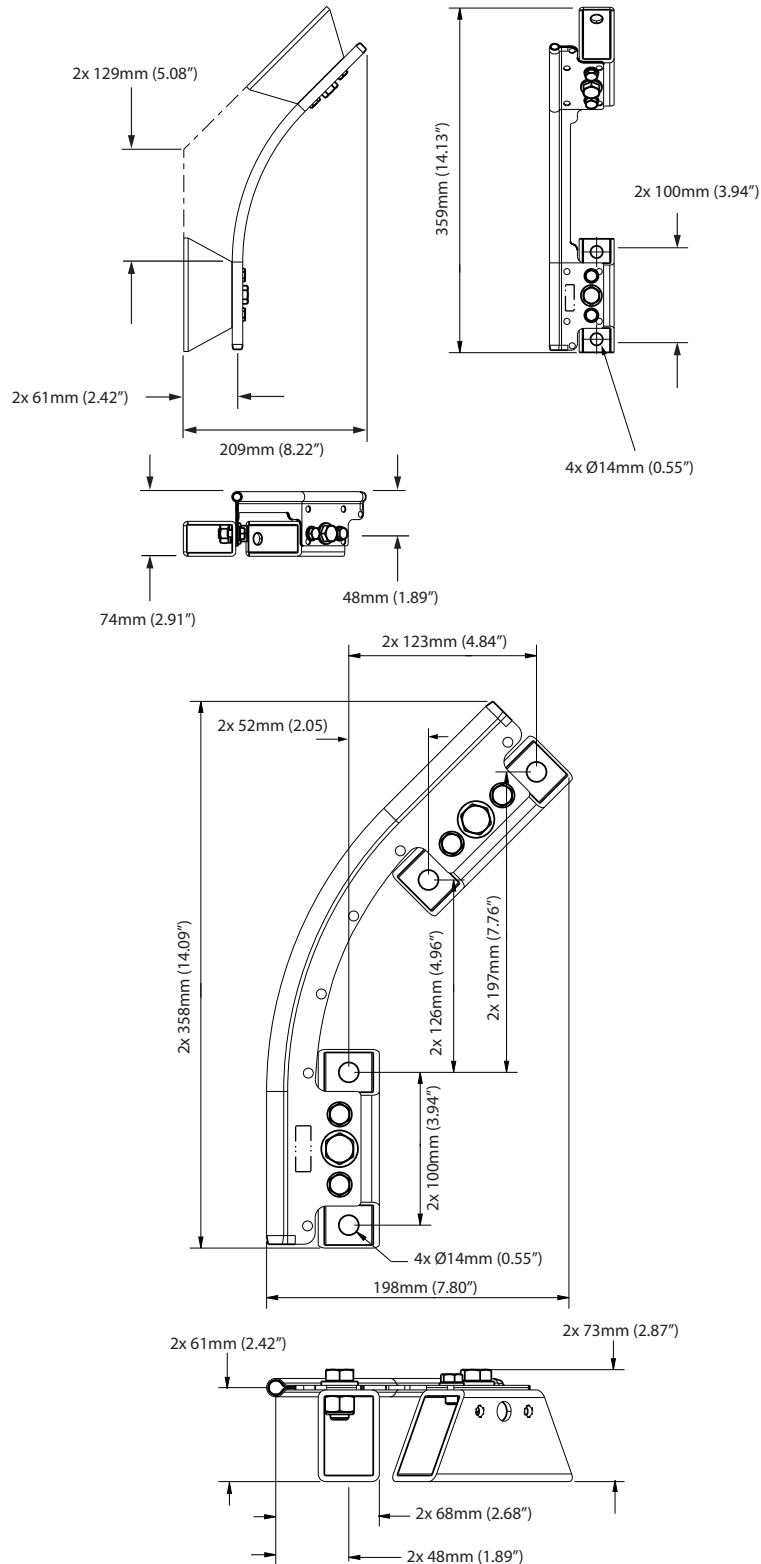

TECHNICAL DATA SHEET: 7241411

45 Degree Post Mount Corner

Part No: 7241411



Fall Protection

APPLICATION:

45 degree corner bracket for post or floor mount.

Used to accommodate system cable redirection at 45 degree angles. Only to be used with 7241422 11kN energy absorber or on a Roofsafe End/Corner Module.

Minimum grade A4-70 M12 (or 316 Stainless Steel, 70,000psi, 1/2 -13 inch) fasteners should be used to fix bracket to structure at a recommended torque of 50Nm (37 ft-lbf) [30Nm (22 ft-lbf) for fitting to a Roofsafe Anchor].

Fixing shall support at least twice the load values stated in the technical report from the 3M DBI-SALA Installed Systems Calculation Software for the system layout, components, number of users, and SRL or Lanyard connecting device.

Tip over post mounted applications are not currently supported by the calculation software and should be designed for 22.2 kN (5000 lbf) in all directions of loading.

Cable Tensioning: 0.8 kN

Operating Temperature Range: 120°C (248°F) to -50°C (-58°F)

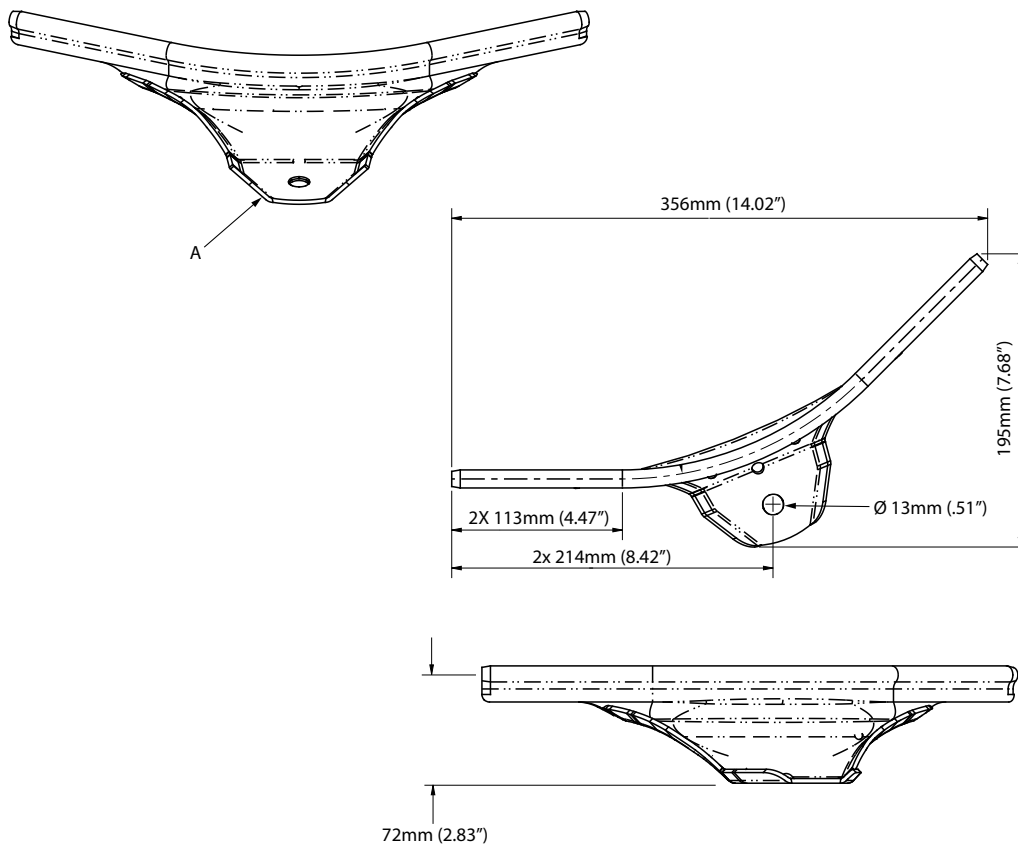

PART SPECIFICATION:

Net Weight kg (lb)	Minimum Breaking Strength kN (lb)
0.5 (1.1)	22.2 (5000)

COMPONENT SPECIFICATION:

Qty.	Component	Material	Finish
A 1	45 Degree Post Mount Corner	316 Stainless Steel	Electropolished

TECHNICAL DATA SHEET: 7234011

Hex Swage Toggle

Part No: 7234011



Fall Protection

APPLICATION:

Used to terminate cable at one end of system. For use with 8mm 7x7 or 1x19 cable only.

Refer to installation instructions for information on assembly and installation.

Operating Temperature Range: 120°C (248°F) to -50°C (-58°F)

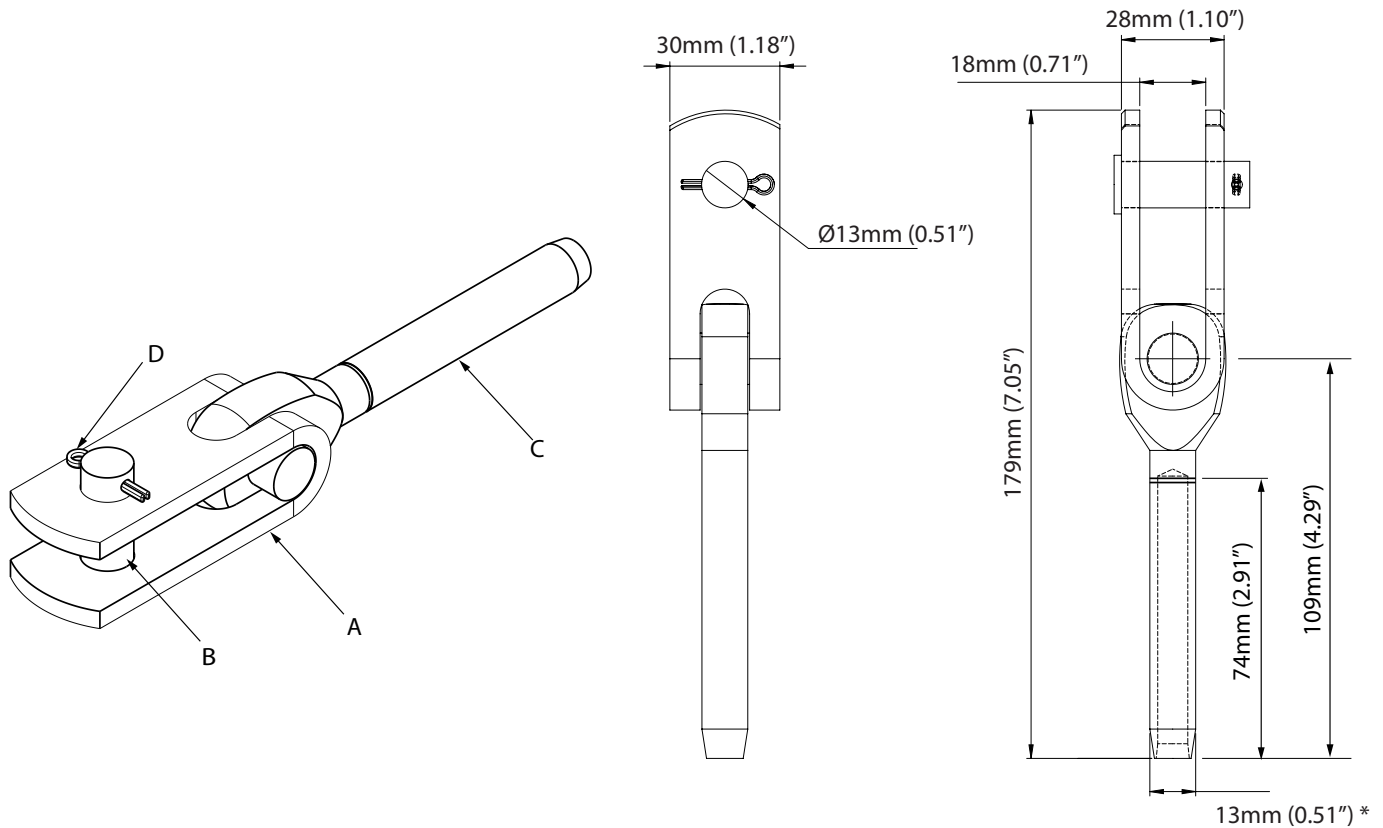

PART SPECIFICATION:

Net Weight kg (lb)	Minimum Breaking Strength kN (lb)
0.33 (0.7)	38 (8540)

COMPONENT SPECIFICATION:

	Qty.	Component	Material	Finish
A	1	Shackle	316 Stainless Steel	Electropolished
B	1	Clevis	316 Stainless Steel	Electropolished
C	1	Swage Terminal	316 Stainless Steel	Electropolished
D	1	Split Pin	316 Stainless Steel	Electropolished
*		Before Swaging		

TECHNICAL DATA SHEET: 7234246

Hex Swage Toggle, Ball Stop Shoulder

Part No: 7234246



Fall Protection

APPLICATION:

This swage toggle is designed to interface with the end stop ball component and provides a machined shoulder to hold the ball in place at the end of the system.

For use with 8mm 7x7 or 1x19 cable only.

Refer to installation instructions for information on assembly and installation.

Operating Temperature Range: 120°C (248°F) to -50°C (-58°F)

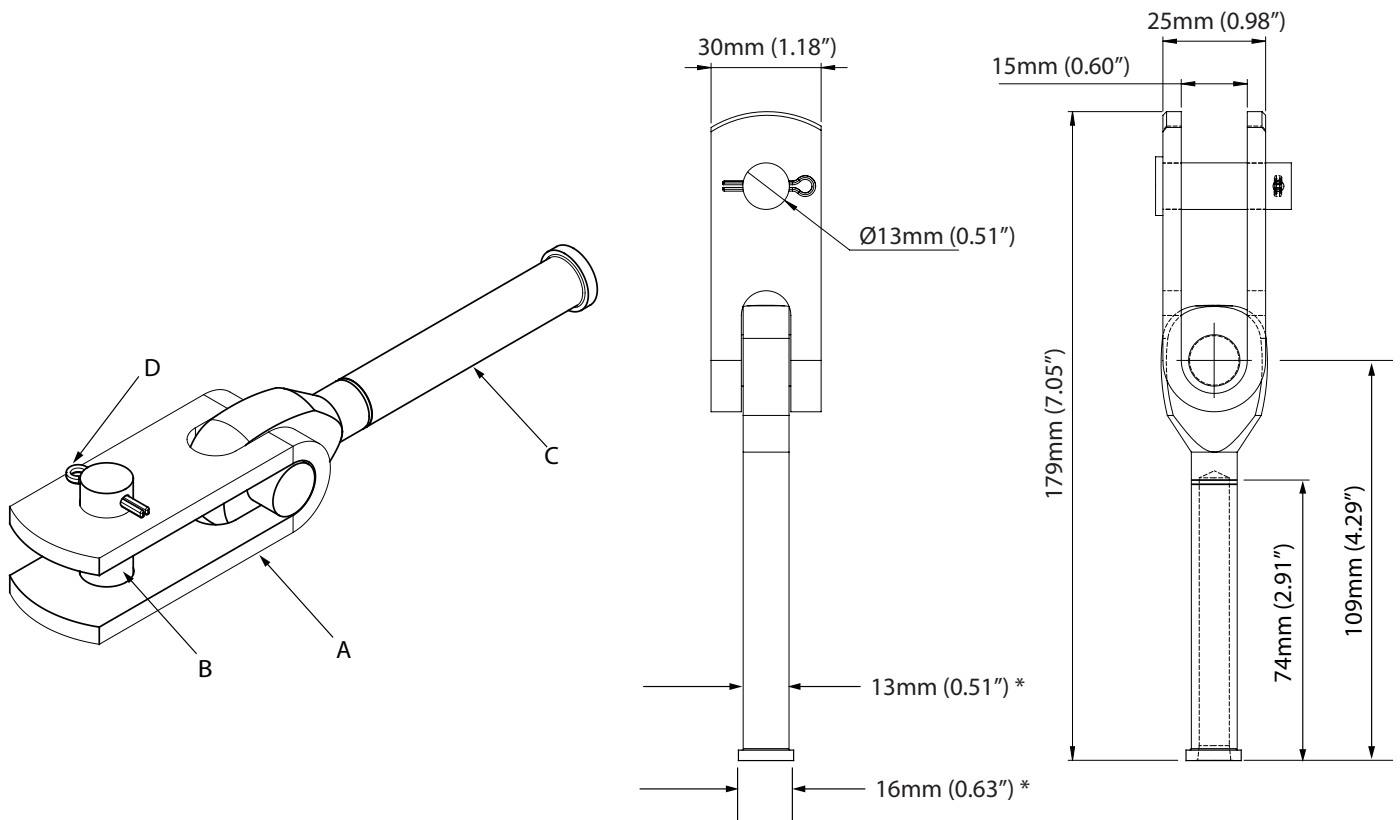

PART SPECIFICATION:

Net Weight kg (lb)	Minimum Breaking Strength kN (lb)
0.33 (0.7)	38 (8540)

COMPONENT SPECIFICATION:

	Qty.	Component	Material	Finish
A	1	Shackle	316 Stainless Steel	Electropolished
B	1	Clevis	316 Stainless Steel	Electropolished
C	1	Swage Terminal	316 Stainless Steel	Electropolished
D	1	Split Pin	316 Stainless Steel	Electropolished
*		Before Swaging		

TECHNICAL DATA SHEET: 7234012

Hex Joiner

Part No 7234012

3M

**DBI
SALA**

Fall Protection

APPLICATION:

Used to join to sections of cable together. For use with 8mm 7x7 or 1x19 cable only.

Refer to installation instructions for information on assembly and installation.

Operating Temperature Range: 120°C (248°F) to -50°C (-58°F)

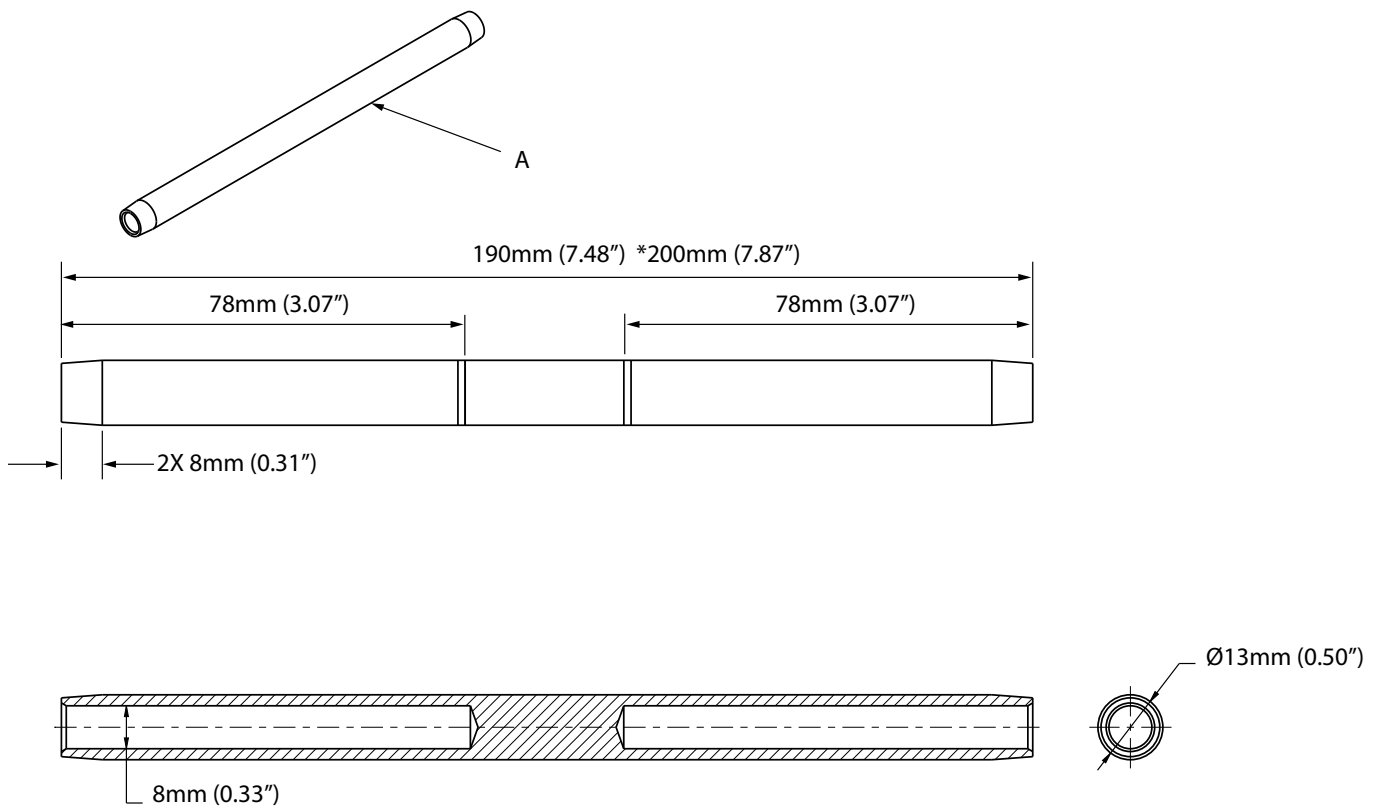

PART SPECIFICATION:

Net Weight kg (lb)	Minimum Breaking Strength kN (lb)
0.12 (0.3)	38 (8540)

COMPONENT SPECIFICATION:

	Qty.	Component	Material	Finish
A	1	Hex Swage Joiner	316 Stainless Steel	Natural
*		After Swaging		

TECHNICAL DATA SHEET: 7241430

Hex Swage Stud, Pass Through

Part No: 7241430



APPLICATION:

Used to terminate cable at one end of system and allows cable to pass through for tensioning prior to swaging.

For use with 8mm 7x7 or 1x19 cable only. Refer to installation instructions for information on assembly and installation.

Operating Temperature Range: 120°C (248°F) to -50°C (-58°F)

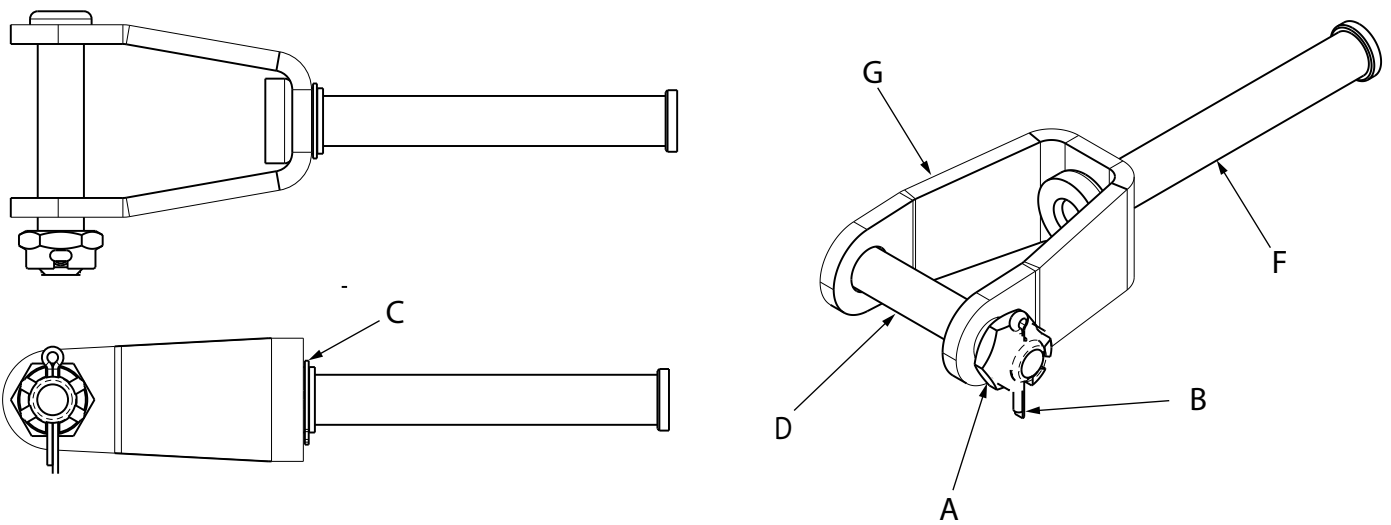

PART SPECIFICATION:

Net Weight kg (lb)	Minimum Breaking Strength kN (lb)
0.34 (0.7)	38 (8540)

COMPONENT SPECIFICATION:

	Qty.	Component	Material	Finish
A	1	M12 Castle Nut	316 Stainless Steel	Natural
B	1	Split Pin	316 Stainless Steel	Natural
C	1	Retaining Ring	316 Stainless Steel	Natural
D	1	Pin	316 Stainless Steel	Natural
E	1	Clevis	316 Stainless Steel	Electropolished
F	1	Swage Terminal	316 Stainless Steel	Natural

TECHNICAL DATA SHEET: 7241432

End Stopper

Part No: 7241432



Fall Protection

APPLICATION:

For use with the hex swage components.

Attach over cable and/or swage end to prevent traveler from hitting the swage end and being damaged when coming to an abrupt stop at the end of the system.

Operating Temperature Range: 120°C (248°F) to -50°C (-58°F)

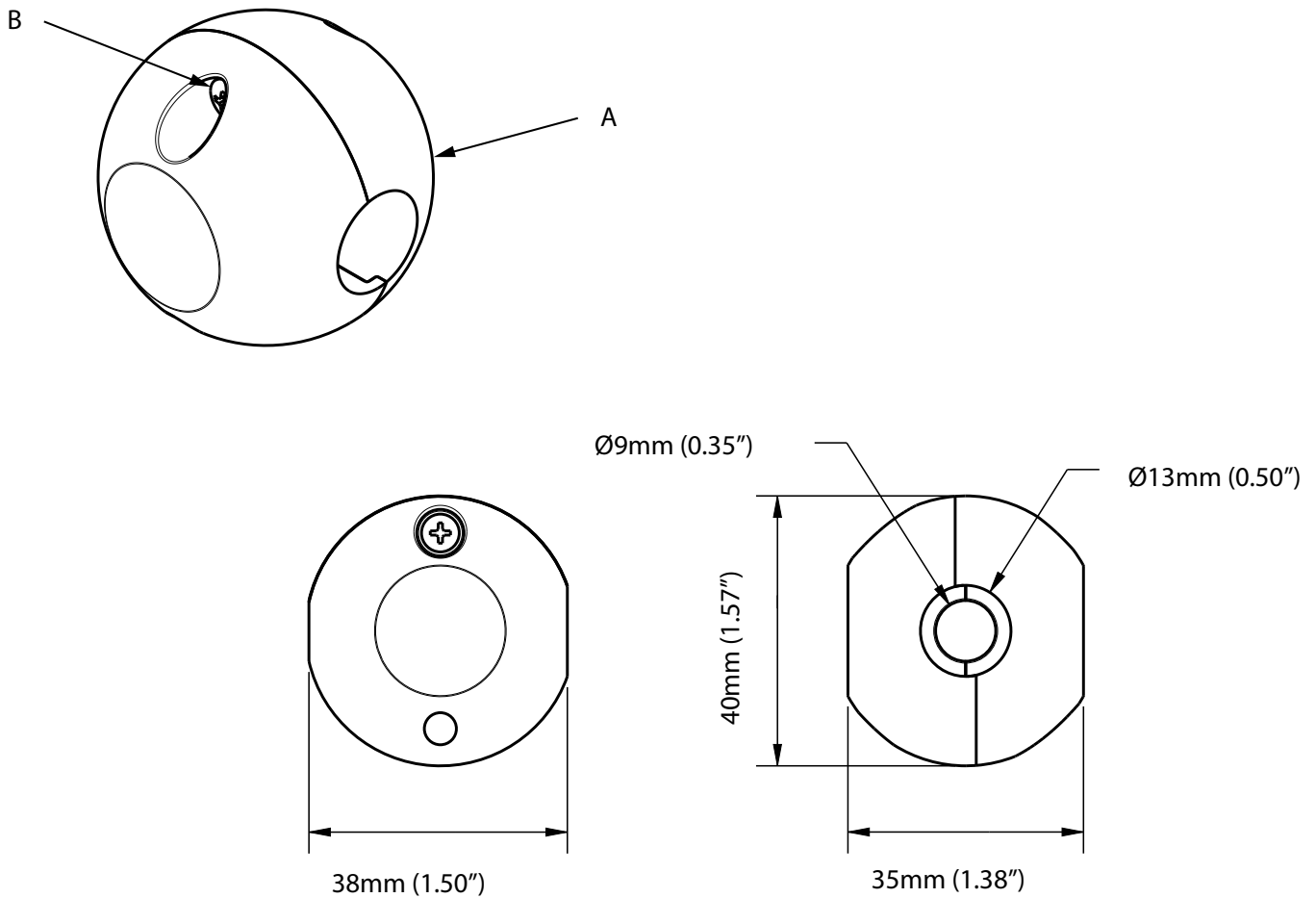

PART SPECIFICATION:

Net Weight kg (lb)
0.4 (0.9)

COMPONENT SPECIFICATION:

	Qty.	Component	Material	Finish
A	1	End Stop Ball	Black Urethane	Natural
B	1	Screw	300 Series Stainless Steel	Natural

TECHNICAL DATA SHEET: 7241435

System Tag Kit, 8mm Horizontal Lifeline

Part No: 7241435



Fall Protection

APPLICATION:

For use on the 8mm Permanent Horizontal Lifeline Installation.

Must be attached in a visible location near the start of the system.

It is completed by the installer with essential information for the user.

Languages: English, Dutch, Spanish, German, French, Portuguese, Italian, Swedish

Operating Temperature Range: 120°C (248°F) to -50°C (-58°F)

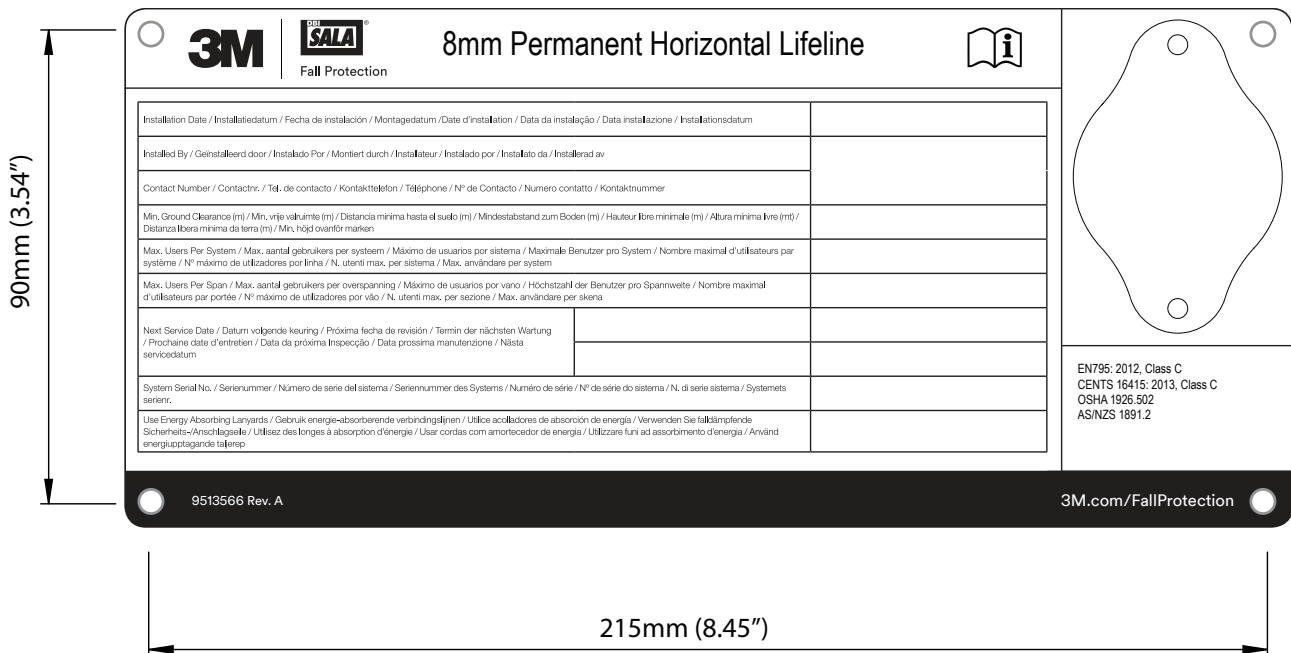

PART SPECIFICATION:

Net Weight kg (lb)
0.009 (0.02)

COMPONENT SPECIFICATION:

	Qty.	Component	Material	Finish
A	1	System Tag Kit	Aluminum 5005	Anodized. Screen printed at low temperature baked.

TECHNICAL DATA SHEET: 7241434

System Tag Kit, 8mm Horizontal Lifeline

Part No: 7241434

3M

**DBI
SALA**

Fall Protection

APPLICATION:

For use on the 8mm Permanent Horizontal Lifeline Installation.

Must be attached in a visible location near the start of the system.

It is completed by the installer with essential information for the user.

Languages: English, Polish, Romanian, Russian, Czech, Slovak, Turkish

Operating Temperature Range: 120°C (248°F) to -50°C (-58°F)

90mm (3.54")

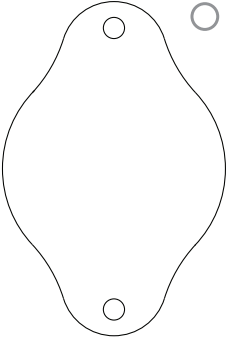
3M	DBI SALA Fall Protection	Горизонтальная анкерная линия товарных знаков 3M, DBI-SALA, модель 8mm жесткая горизонтальная анкерная линия		
Installation Date / Data instalacji / Data instalării / Дата установки / Datum instalace / Dátum inštalácie / Montaj Tarihi				
Installed By / Zainstalowane przez / Instalat de / Установщик / Osoba provádějící instalaci / Inštaloval / Montaj Yapan Firma				
Contact Number / Numer kontaktowy / Telefon / Контактный телефон / Telefon / Telefon / İletişim Bilgisi				
Min Ground Clearance (m) / Minimalny prześwit do ziemi (m) / Distanța minimă de cadere / Минимальное расстояние под рабочей площадкой (м) / Minimální světla výška / min. vzdialenosť od zeme / Yerden Minimum Yükseklik				
Max Users Per Span / Maksymalna liczba użytkowników w sekcji / Maxim de utilizatori pe Span / Максимальное число пользователей на пролет / Maximální počet uživatelů na úsek / max. Počet pouzivateľov na sekcju / Halattaki Maksimum Kullanici Sayisi				
Max Users Per System / Maksymalna liczba użytkowników systemu / Maxim de utilizatori pe Sistem / Максимальное число пользователей системы / Maximální počet uživatelů systému / max. Počet pouzivateľov na systém / Sistemdeki Maksimum Kullanici Sayisi				
Next Service Date / Data następnego przeglądu / Data următoare inspecții / Следующая дата осмотра / Datum příští kontroly / Datum nasledujúcej kontroly / Bir Sonraki Servis Tarihi				
System Serial No. / Numer seryjny systemu / Numar serie sistem / Серийный номер системы / Sériové číslo / Sériové číslo systému / Sistem Seri No				
Use Energy Absorbing Lanyards / Uzywaj amortyzatora / Fotostli franghia cu absorbtor de energie / Используйте соединительный элемент с амортизатором / Použite tlumič / Používajte tlmiče pádu / Şok Emisli Lanyard Kullanımı				
Страна-изготовитель: Словакия Наименование и юридический адрес изготовителя: Капитал Сайфти Груп – Банска Быстрица, с.р.о. Девгоровова 35, 97401 Банска Быстрица Словакия				

9513595 Rev. A

215mm (8.45")

3M.com/FallProtection

PART SPECIFICATION:

Net Weight kg (lb)
0.009 (0.02)

COMPONENT SPECIFICATION:

	Qty.	Component	Material	Finish
A	1	System Tag EMEA Kit	Aluminum 5005	Anodized. Screen printed at low temperature baked.



Fall Protection

USA

3833 SALA Way
Red Wing, MN 55066-5005
Toll Free: 800.328.6146
Phone: 651.388.8282
Fax: 651.388.5065
3Mfallprotection@mmm.com

Brazil

Rua Anne Frank, 2621
Boqueirão Curitiba PR
81650-020
Brazil
Phone: 0800-942-2300
falecoma3m@mmm.com

Mexico

Calle Norte 35, 895-E
Col. Industrial Vallejo
C.P. 02300 Azcapotzalco
Mexico D.F.
Phone: (55) 57194820
3msaludocupacional@mmm.com

Colombia

Compañía Latinoamericana de Seguridad S.A.S.
Carrera 106 #15-25 Interior 105 Manzana 15
Zona Franca - Bogotá, Colombia
Phone: 57 1 6014777
fallprotection-co@mmm.com

Canada

260 Export Boulevard
Mississauga, ON L5S 1Y9
Phone: 905.795.9333
Toll-Free: 800.387.7484
Fax: 888.387.7484
3Mfallprotection-ca@mmm.com

EMEA (Europe, Middle East, Africa)

EMEA Headquarters:
5a Merse Road
North Moons Moat
Redditch, Worcestershire
B98 9HL UK
Phone: + 44 (0)1527 548 000
Fax: + 44 (0)1527 591 000
informationfallprotection@mmm.com

France:

Le Broc Center
Z.I. 1re Avenue - BP15
06511 Carros Le Broc Cedex
France
Phone: + 33 04 97 10 00 10
Fax: + 33 04 93 08 79 70
informationfallprotection@mmm.com

Australia & New Zealand

95 Derby Street
Silverwater
Sydney NSW 2128
Australia
Phone: +(61) 2 8753 7600
Toll-Free : 1800 245 002 (AUS)
Toll-Free : 0800 212 505 (NZ)
Fax: +(61) 2 8753 7603
anzfallprotectionsales@mmm.com

Asia

Singapore:
1 Yishun Avenue 7
Singapore 768923
Phone: +65-6450 8888
Fax: +65-6552 2113
TotalFallProtection@mmm.com

Shanghai:

19/F, L'Avenue, No.99 Xian Xia Rd
Shanghai 200051, P R China
Phone: +86 21 62539050
Fax: +86 21 62539060
3MFallProtecton-CN@mmm.com

Korea:

3M Koread Ltd
20F, 82, Uisadang-daero,
Yeongdeungpo-gu, Seoul
Phone: +82-80-033-4114
Fax: +82-2-3771-4271
TotalFallProtection@mmm.com

Japan:

3M Japan Ltd
6-7-29, Kitashinagawa, Shinagawa-ku, Tokyo
Phone: +81-570-011-321
Fax: +81-3-6409-5818
psd.jp@mmm.com

3M.com/FallProtection

