



LOT 1 THE CRESTVIEW B

ROUEN COVE

**PURCHASE THIS
MOVE-IN READY HOME
JULY 21- AUG 19
& RECEIVE
TOTAL SAVINGS
OF
\$13,000***

LOT 1 THE CRESTVIEW B

1,904 sq. ft.

3 bedrooms, 2 bathrooms, study

\$259,900

COMMUNITY HIGHLIGHTS:

- "A" rated elementary school in walking distance
- Close to Sheffield Park & Pumpkin Hill Creek Preserve State Park
- Convenient shopping at River City Marketplace Mall
- No CDD fees



Model: 904-365-4860

Russ Lousignont

cell (904) 887-7877

rlousignont@sedanewhomes.com

Lauren Becerra

cell (904) 624-6369

lbecerra@sedanewhomes.com



*Buyer may choose a screen enclosure & window blinds package valued at \$5,000 or refrigerator and washer/dryer package valued at \$5,000.. In Rouen Cove SEDA pays up to \$8,000 toward total Closing Costs with SEDA approved lender.



HIDEAWAY

PURCHASE ONE OF
THESE MOVE-IN
READY HOMES
JULY 21-AUG 19
& RECEIVE
TOTAL SAVINGS
OF
\$13,000*



lot 1B-7- Greenwood C 2,150 sq. ft
4 bedroom, 2 bath
\$289,900



lot 1B-70- Wyndham B 2,067 sq. ft
3 bedroom, 2 bath, study
\$282,500

Model: 904-225-2734

Lauren Becerra

cell (904) 624-6369

lbecerra@sedanewhomes.com

Russ Lousignont

cell (904) 887-7877

rlousignont@sedanewhomes.com

*Buyer can choose the screen enclosure & window blinds package valued at \$5,000 or the refrigerator and washer/dryer package valued at \$5,000. If there is a refrigerator and washer/dryer in the home, that is the special chosen and buyer can not choose any other special. In Hideaway SEDA pays up to \$8,000 toward total Closing Costs with SEDA approved lender.





BUCKHEAD

PURCHASE THIS
MOVE-IN
READY HOME
JULY 21-AUG 19
& RECEIVE
TOTAL SAVINGS
OF
\$13,000*

LOT 2-68 THE RANCHHOUSE

1,567 sq. ft.
3 bedrooms
2 bathrooms
\$239,900



COMMUNITY HIGHLIGHTS:

- 1/2 acre homesites
- Boat/RV parking allowed behind a fence
- Serene community close to 13,385-acre Cary State Forest
- No CDD fees



Larry Lanier

904-573-6026

lanier@sedanewhomes.com

*Buyer can choose the screen enclosure & window blinds package valued at \$5,000 or the refrigerator and washer/dryer package valued at \$5,000. If there is a refrigerator and washer/dryer in the home, that is the special chosen and buyer can not choose any other special. In Buckhead SEDA pays up to \$8,000 toward total Closing Costs with SEDA approved lender.



FLORA PARKE

PURCHASE ONE OF
THESE MOVE-IN
READY HOMES
JULY 21-AUG 19
& RECEIVE
TOTAL SAVINGS
OF
\$13,000*

Contact: 904-491-1955

Lorie Bukovsky

cell (904) 556-6032

lbukovsky@sedanewhomes.com

Sherry Stoutamire

cell (904) 671-2159

sstoutamire@sedanewhomes.com



lot 6B-191 Chesterwood D 2,459 sq. ft
4 bedroom, 2.5 bath, study, lakeview
\$339,900



lot 7B-294 Chesterwood D 2,459 sq. ft
4 bedroom, 2.5 bath, study
\$354,900



lot 7B-295 Carrollview C 2,497 sq. ft
4 bedroom, 3 bath
\$355,900



lot 7B-312 Cherryfield C 2,636 sq. ft
4 bedroom, 3 bath
\$366,900

*This home receives the refrigerator and washer/dryer special valued at \$5,000. Buyer can not choose any other special. Homes without an asterisk can choose the refrigerator and washer/dryer special or the screen enclosure and window blinds special valued at \$5,000. If there is a refrigerator and washer/dryer in the home, that is the special chosen and buyer can not choose any other special. In Flora Parke SEDA pays up to \$8,000 toward total Closing Costs with SEDA approved lender. This rendering is a conceptual drawing only and not meant to represent the actual exterior colors. Builder reserves the right to modify.

JULY 21 - AUG 19



LOT 53
THE OKLAWAHA B

FLORIDIAN ENCLAVE

**PURCHASE THIS
MOVE-IN READY HOME
JULY 21- AUG 19
& RECEIVE A FREE
REFRIGERATOR,
WASHER & DRYER
PLUS CLOSING COSTS PAID***

**FOR TOTAL SAVINGS
OF
\$13,000***

LOT 53 THE OKLAWAHA B

2,457 sq. ft.

3 bedrooms, 2.5 bathrooms, study

\$349,900

COMMUNITY HIGHLIGHTS:

- Close to Fernandina Beach & Amelia Island
- Private, gated community
- Lawn care provided by the HOA
- Luxurious features
- No CDD fees

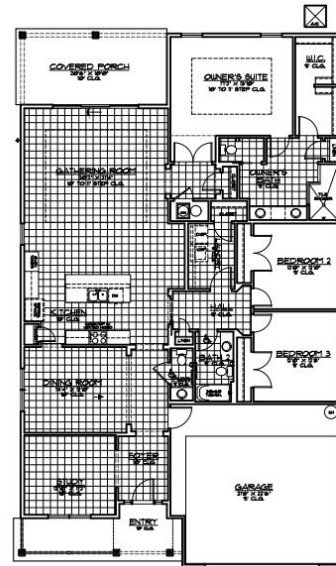

Mechelle Kirkwood

904-696-3483

cell (904) 753-7996

mkirkwood@sedanewhomes.com



*This home receives the refrigerator and washer/dryer special package valued at \$5,000. Buyer can not choose any other special. In Floridian Enclave SEDA pays up to \$8,000 toward total Closing Costs with SEDA approved lender.

JULY 21 - AUG 19



LINDA LAKES

PURCHASE ONE OF
THESE MOVE-IN
READY HOMES
JULY 21-AUG 19
& RECEIVE
TOTAL SAVINGS
OF
\$13,000*



lot 2-43**- Crestview B 1,904 sq. ft
3 bedroom, 2 bath, study
FREE REFRIGERATOR, WASHER & DRYER
\$279,900



lot 2-97*- Greenwood C 2,149 sq. ft
4 bedroom, 2 bath
FREE SCREEN ENCLOSURE & WINDOW BLINDS
\$299,900



lot 2-46**- Copperline D 1,994 sq. ft
3 bedroom, 2 bath, study
FREE REFRIGERATOR, WASHER & DRYER
\$299,900



lot 1-104* Waterbury B 2,025 sq. ft
3 bedroom, 2 bath, study
FREE SCREEN ENCLOSURE & WINDOW BLINDS
\$311,900



lot 2-39- Hillcrest Bonus B 2,007 sq. ft
3 bedroom, 2 bath, bonus room
\$303,900



lot 2-54- Weatherby C 2,025 sq. ft
3 bedroom, 2 bath, study
\$297,900

Larry Lanier

904-573-6026

lanier@sedanewhomes.com

*Buyer receives a screen enclosure & window blinds package valued at \$5,000 on homes with an asterisk, no other special can be chosen.

**Buyer receives a refrigerator and washer/dryer package valued at \$5,000 on homes with a double asterisk, no other special can be chosen. For homes without an asterisk, buyer can choose the screen enclosure & window blinds package or the refrigerator and washer/dryer package. If there is a refrigerator and washer/dryer in the home, that is the special chosen and buyer can not choose any other special. In Linda Lakes SEDA pays up to \$8,000 toward total Closing Costs with SEDA approved lender.

JULY 21 - AUG 19



SANDY CREEK

PURCHASE ONE OF THESE
MOVE-IN READY HOMES
JULY 21- AUG 19
& RECEIVE A FREE
**REFRIGERATOR,
WASHER & DRYER**
PLUS CLOSING COSTS PAID*

FOR TOTAL SAVINGS
OF
\$13,000*



lot 2A-26- Waterbury A 2,025 sq. ft
3 bedroom, 2 bath, study
\$314,900



lot 2C-36- Waterbury C 2,025 sq. ft
3 bedroom, 2 bath, study
\$320,500



lot 2C-16- Albaterra B 2,478 sq. ft
3 bedroom, 2.5 bath, study
\$351,500



lot 2C-38- Almeria C 2,257 sq. ft
3 bedroom, 2 bath, study, rec room
\$384,900

Contact: Matt Lowry
cell (904) 347-1201
mlowry@sedanewhomes.com

*These homes receive the refrigerator and washer/dryer special package valued at \$7,000. Buyer can not choose any other special. In Sandy Creek SEDA pays up to \$8,000 toward total Closing Costs with SEDA approved lender.

JULY 21 - AUG 19



SANDY POINTE PRESERVE

PURCHASE ONE OF THESE
MOVE-IN READY HOMES

JULY 21- AUG 19

& RECEIVE A FREE

**REFRIGERATOR,
WASHER & DRYER**

PLUS CLOSING COSTS PAID*

FOR TOTAL SAVINGS
OF

\$12,000*



lot 114- Paddington C 2,203 sq. ft
3 bedroom, 2 bath, 3rd car

\$358,500



lot 6- Paddington B 2,203 sq. ft
3 bedroom, 2 bath, 3rd car

\$356,900



lot 5- Ashby C 2,228 sq. ft
3 bedroom, 2 bath, study, 3rd car

\$357,900

Contact: 904-829-5041

Dawn Cronin

cell (904) 333-0934

dcronin@sedanewhomes.com

*These homes receive the refrigerator and washer/dryer special package valued at \$7,000. Buyer can not choose any other special. In Sandy Pointe Preserve SEDA pays up to \$5,000 toward total Closing Costs with SEDA approved lender.