



Easy Drain®  
by ess

## Xs Z-3

Easy Drain Xs, the world's smallest design linear shower drain, is equipped with the patented TAF-system and Water Protections System, so we can guarantee a 100% water proof finish. The award winning Xs design set Z-1 is installed with a subtle small frame on all sides and offers very high water capacity.

## FEATURES

- Available lengths - 500 - 2000 mm
- Water Protection System - 10-year warranty
- Tile Adjustable Frame - Height adjustable 5 - 25 mm
- Certified - EN 1253
- Siphon - Easy to clean
- Supplied as - Complete set



### Manufacturer

Easy Sanitary Solutions  
Nijverheidsstraat 60 | 7575 BK Oldenzaal | The Netherlands  
T. +31 (0)541 200 800 | F. +31 (0)541 200 899  
info@esspost.com | www.easydrain.com

### Contact

Easy Sanitary Solutions  
Nijverheidsstraat 60 | 7575 BK Oldenzaal | The Netherlands  
T. +31 (0)541 200 800 | F. +31 (0)541 200 899  
sales@esspost.com | www.easydrain.com

Page 1 / 3

## GENERAL

|               |                              |
|---------------|------------------------------|
| Serie         | Xs Z-3                       |
| Name          | Xs Z-3                       |
| Model         | Linear shower drain          |
| Length (mm)   | 800, 900, 1000, 1100, 1200   |
| Product type  | Complete                     |
| Application   | New construction, Renovation |
| Certification | EN 1253, ETAG-022, DIN 18534 |

## INSTALLATION

|   |   |
|---|---|
| Substrate                                   | Concrete / Sand Cement, Wooden floors, Lewis sheets     |
| Floor finish                                | Natural stone, Tiles / Mosaic, Glass Mosaic, Thin tiles |
| Height adjustable feet                      | Included  |
| Installation option                         | Floor, Wall   |
| Outlet                                      | Horizontal (Vertical outlet optional)                   |
| Connection (mm)                             | 50 (Global) / 56 (UK)                                   |
| Min. installation depth (mm) (built-in set) | 90  |
| Min. installation depth (mm) (incl. grate)  | 95  |

## DRAINAGE

|   |    |
|---|----|
| Max. drainage capacity entrance (l/min) | 33 |
| Max. drainage capacity wall (l/min)     | 41 |
| Max. drainage capacity (l/min)          | 41 |

## BUILT-IN SET

|                                |  |
|--------------------------------|--|
| Pre-assembled sealing membrane | Included   |
| Siphon features                | Cleanable, Pivotal & adjustable, Height adjustable |
| Water seal height (mm)         | 50   |
| Outlet                         | Horizontal (Vertical outlet optional)              |
| Material siphon                | Polypropylene (PP)                                 |

## DESIGN

|                         |                               |
|-------------------------|-------------------------------|
| Grate finish            | Chrome-plated stainless steel |
| Grate pattern           | Zero / Closed                 |
| Grate width (mm)        | 20                            |
| Grate tile insert (mm)  | N.A.                          |
| Adjustable grate        | No                            |
| Frame type              | TAF (Tile Adjustable Frame)   |
| TAF Frame material      | Stainless steel (304)         |
| Design frame finish     | N.A.                          |
| Frame width (mm)        | 53                            |
| Wheelchair accessible   | Yes                           |
| Extension set available | No                            |



### Manufacturer

Easy Sanitary Solutions  
 Nijverheidsstraat 60 | 7575 BK Oldenzaal | The Netherlands  
 T. +31 (0)541 200 800 | F. +31 (0)541 200 899  
 info@esspost.com | www.easydrain.com

### Contact

Easy Sanitary Solutions  
 Nijverheidsstraat 60 | 7575 BK Oldenzaal | The Netherlands  
 T. +31 (0)541 200 800 | F. +31 (0)541 200 899  
 sales@esspost.com | www.easydrain.com

## ARTICLE CODE

|         |                             |  |  |
|---------|-----------------------------|--|--|
| 800 mm  | XS-Z3M-P-800 / XS-ROH-800   |  |  |
| 900 mm  | XS-Z3M-P-900 / XS-ROH-900   |  |  |
| 1000 mm | XS-Z3M-P-1000 / XS-ROH-1000 |  |  |
| 1100 mm | XS-Z3M-P-1100 / XS-ROH-1100 |  |  |
| 1200 mm | XS-Z3M-P-1200 / XS-ROH-1200 |  |  |
|         |                             |  |  |

## TECHNICAL DRAWINGS

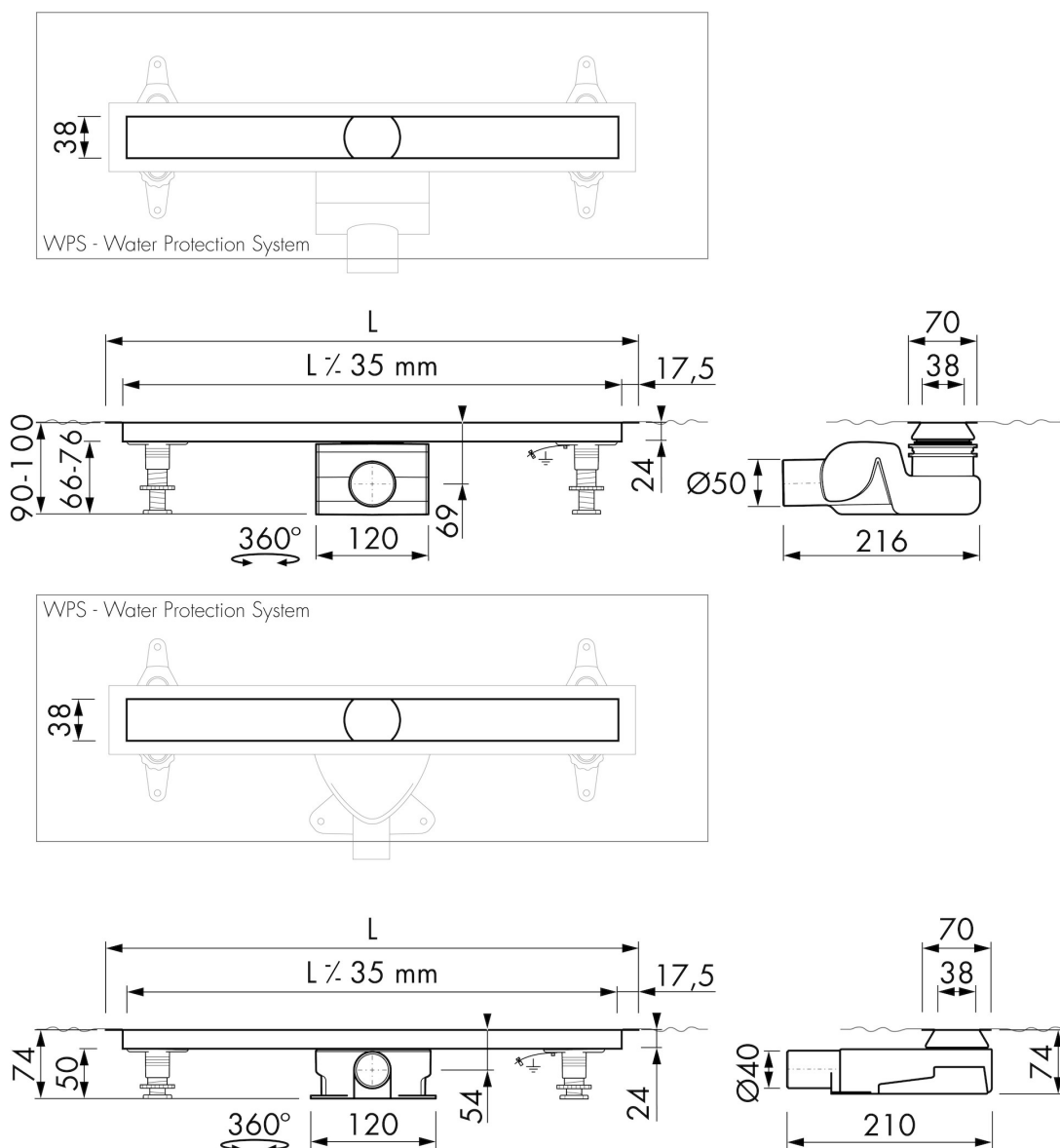

### Manufacturer

Easy Sanitary Solutions  
 Nijverheidsstraat 60 | 7575 BK Oldenzaal | The Netherlands  
 T. +31 (0)541 200 800 | F. +31 (0)541 200 899  
 info@esspost.com | www.easydrain.com

### Contact

Easy Sanitary Solutions  
 Nijverheidsstraat 60 | 7575 BK Oldenzaal | The Netherlands  
 T. +31 (0)541 200 800 | F. +31 (0)541 200 899  
 sales@esspost.com | www.easydrain.com