

Health & Wellness Re-entry Signage System



We Are Creative Fabricators



ROOTED IN OVER 35 YEARS

VGS is an employee-owned, fully-integrated leader in design and fabrication, spanning over 35 years, 12 markets and thousands of projects. From value-driven visual communication systems (signage, fixtures, graphics) and interior / exterior signage, to donor recognition solutions, drive-thru solutions, menu boards, stock display fixtures and so much more, we are a true powerhouse of creativity and craftsmanship.

We have the advantage of combining our unique design proficiency and strong project management skills, with solid fabrication expertise, to create an unparalleled customer experience with their customers and guests.



330 Washington Avenue
Carlstadt, NJ 07072

800-203-0301 | 201-528-2700
www.vgsstudiod.com

We Are Here to Help.

At Visual Graphic Systems Inc. (VGS) we are industry pioneers. Whether we're helping you with an office, fitness center or restaurant, etc. — we are here to help set up your environment for success and guide you along the path to re-opening.

As the current COVID-19 situation brings on new needs on a daily basis, VGS has done its best to help clients both communicate and facilitate health & safety measures.

We are repurposing many of our **stock offerings** and **inventing new ones** to fulfill these unprecedented needs. Included within this document are a few key areas we are thinking about and are able to provide quickly given we have the product available.

All of which can be customized to either be customer facing or for internal use and communication:

- Flexible, changeable health & safety messaging and signage solutions
- Freestanding protective health barriers (customer/staff)
- Branded/custom hand sanitation & communication stations

We provide a wide range of verticals — from retail and foodservice to office and fitness centers, etc. — informational and safety display fixtures and signage solutions that provide people with the information they need when and where they need it.

CONTENTS

Entrance & Reception Area Signage	5
Entrance & Reception Area Fixtures	4
Sanitizing Station.....	7
Elevator & Lobby Signage	8
General Shared Spaces.....	9
Notification Signage	11
Restroom Signage	12
Kitchen Signage.....	13
Paper Signage Inserts	14
MagaFrame™	15
Blade Signage.....	16
Door Pull.....	17

Standard or Fully Customizable

We have a variety of solutions available to fit your needs. Choose from one of our standard print-ready designs or engage us to fully customize with your brand standards to apply to the entire signage system.

Our goal is to provide your company with the necessary fixtures and messaging — making your team and guests feel comfortable and safe while also complimenting your environment.

ORDER FROM OUR STANDARD DESIGNS OR

1. Choose your typography
2. Choose your color scheme
3. Choose from a wide range of materials available to work within your environment
4. Reach out to our sales team to discuss more about customizing your signage

CUSTOMIZE ALL SIGNS & INSERTS



TYPOGRAPHY & COPY CAN BE CUSTOMIZED



COLOR CAN BE CUSTOMIZED

CUSTOMIZE ALL BLADE SIGNS

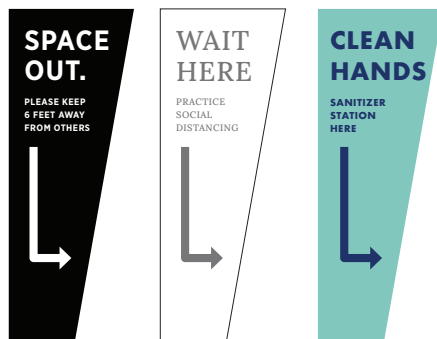

CUSTOMIZE ALL MAGAFRAMES™



CUSTOMIZE ALL FLOOR GRAPHICS



CUSTOMIZE ALL FIXTURES

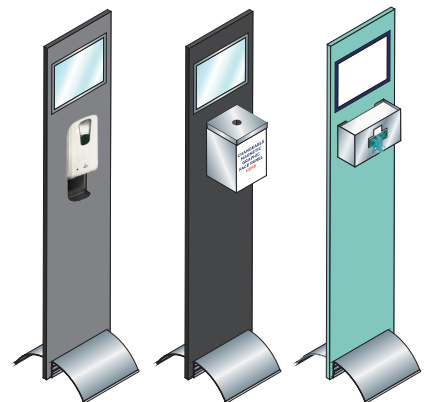

Entrance & Reception Area Signage

WALL-MOUNTED NOTIFICATION SIGNS

- Option 1: Subsurface printed .020 material with repositionable adhesive. Signs are scratch-resistant material with subsurface copy that are impervious to 99% of all cleaners
- Option 2: MagaFrame™ with paper insert
- Self-installed

*Note: Standard colors shown.
Can be customized to your brand standards.*



FLOOR GRAPHICS

- Fantastic for all smooth indoor surfaces like metal, plastic laminates, wood, linoleum, tile & carpeting
- Choice of permanent or semi-permanent adhesive
- Self-installed

*Note: Standard colors shown.
Can be customized to your brand standards.*



Entrance & Reception Area Fixtures

FREESTANDING FLOOR SIGNS

- Choice of Concurva® or Linea® display stand.
- 8.5" x 11" paper insert

STANDARD FINISH OPTIONS



Black Silver

*Note: Standard colors shown.
Please inquire about different colors or copy.*



With MagaFrame™

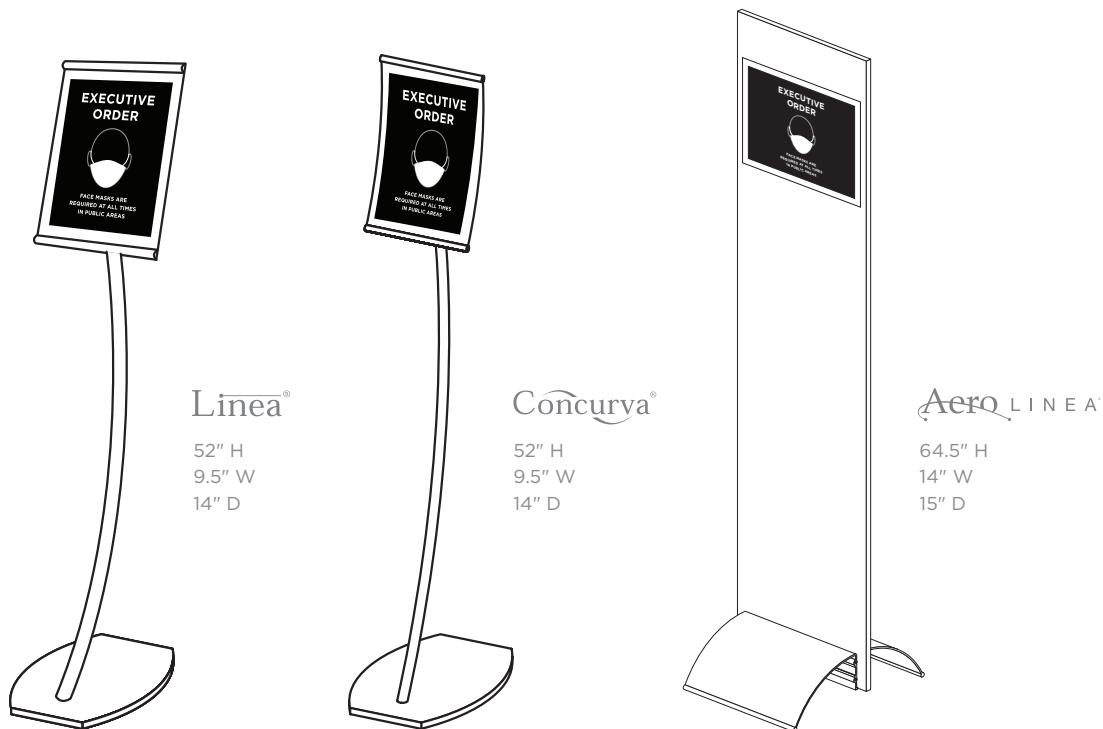

COUNTERTOPPERS

- Choice of Aerolinea®, Concurva® or Linea® display stand.

STANDARD FINISH OPTIONS



Black Silver

*Note: Standard colors shown.
Please inquire about different colors or copy.*



Sanitizing Station

OPTION 1: SANITIZER DISPENSER

- 64.5" overall height
- Touchless battery operated 1100 ml liquid sanitizer dispenser included
- Gray, Black, or Maple background
- Black or silver MagaFrame™
- Choose one of four paper inserts
- Custom branded backgrounds and other finishes available
- **Note: Sanitizing Liquid Not Included**

OPTION 2: SANITARY WIPES DISPENSER

- 64.5" overall height.
- Silver powder coated steel w/ hinged lid for sanitary wipes cannister
- Gray, Black or Maple background
- Black or silver MagaFrame™
- Optional changeable magnetic message face panel.
- Custom branded backgrounds and other finishes available.
- **Note: Sanitizer Wipes Not Included**

OPTION 3: SANITARY GLOVE DISPENSER

- 64.5" overall height
- Silver powder coated steel glove box holder
- Gray, Black, or Maple background
- Black or silver MagaFrame™
- Custom branded backgrounds and other finishes available
- **Note: Gloves not included**

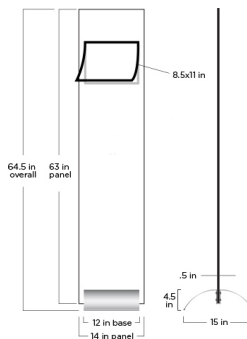
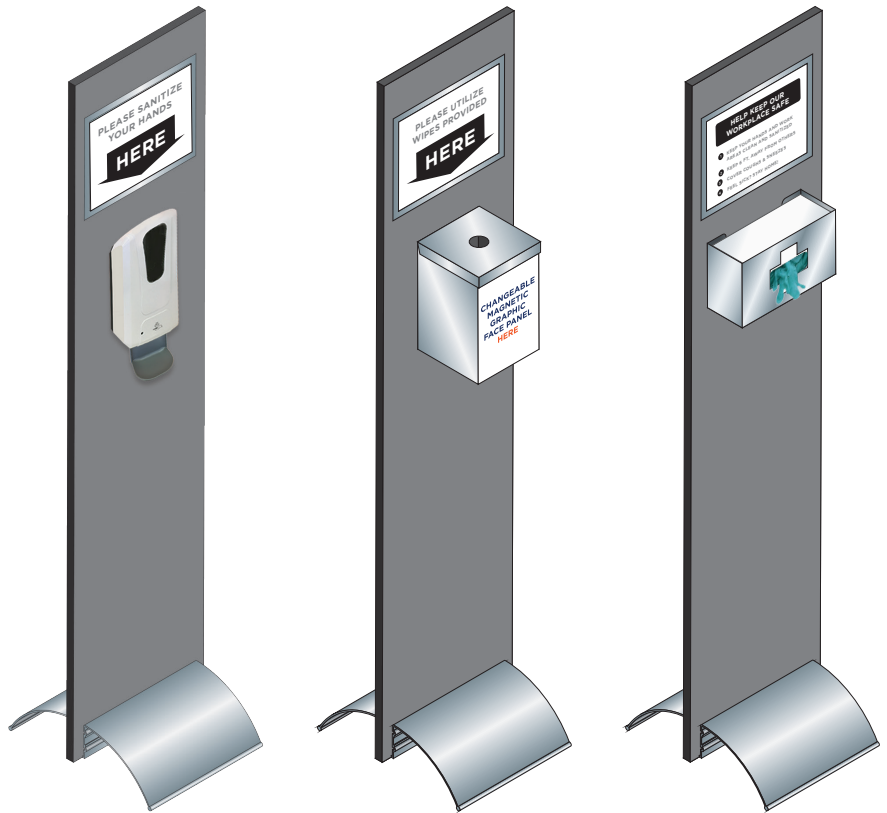

STANDARD FIXTURE FINISH OPTIONS

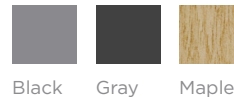

STANDARD MAGAFRAME™ OPTIONS

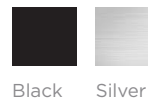

Custom branded or colored backgrounds available, please inquire

LOBBY STAND INSERTS

- 8.5" H x 11" W
- Choose from four different designs OR
- Print your own insert or send us your custom message requirements



Custom branded and message inserts available, please inquire.

Elevator & Lobby Signage

WALL-MOUNTED NOTIFICATION SIGNS

- Option 1: Subsurface printed .020 material with repositionable adhesive. Signs are scratch-resistant material with subsurface copy that are impervious to 99% of all cleaners.
- Option 2: MagaFrame™ with paper insert
- Self-installed

*Note: Standard colors shown.
Can be customized to your brand standards.*

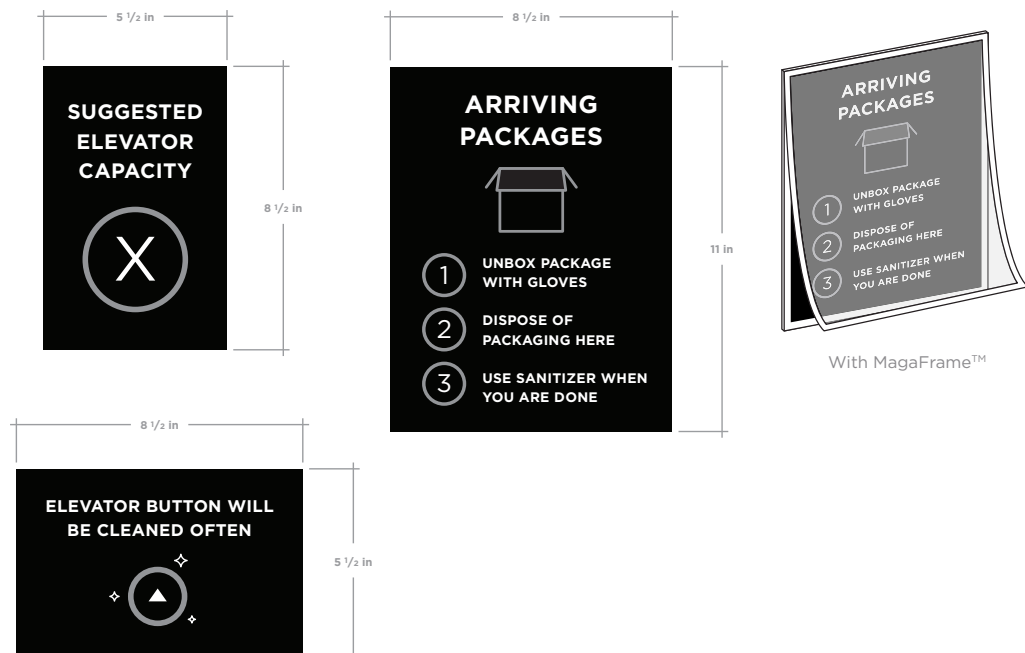

FLOOR GRAPHICS

- Fantastic for all smooth indoor surfaces like metal, plastic laminates, wood, linoleum, tile & carpeting
- Choice of permanent or semi-permanent adhesive
- Self-installed

*Note: Standard colors shown.
Can be customized to your brand standards.*

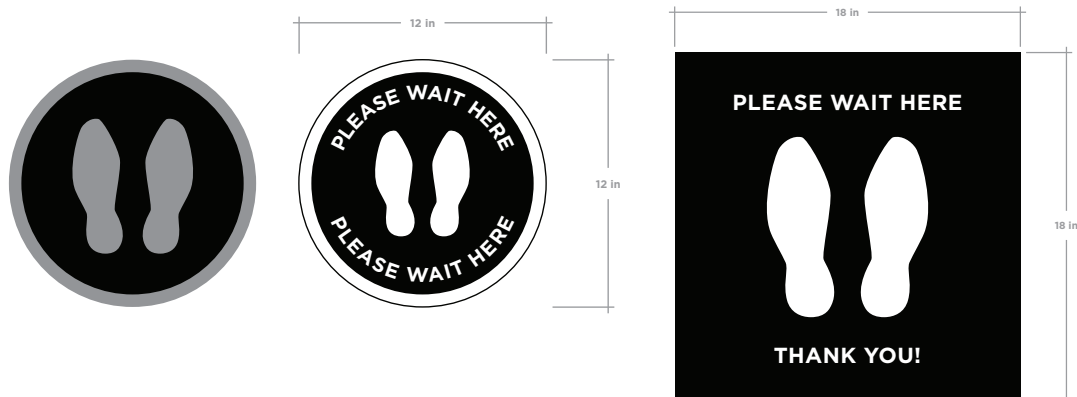

General Shared Spaces

WALL-MOUNTED NOTIFICATION SIGNS

- Option 1: Subsurface printed .020 material with repositionable adhesive. Signs are scratch-resistant material with subsurface copy that are impervious to 99% of all cleaners
- Option 2: MagaFrame™ with paper insert
- Self-installed

*Note: Standard colors shown.
Can be customized to your brand standards.*

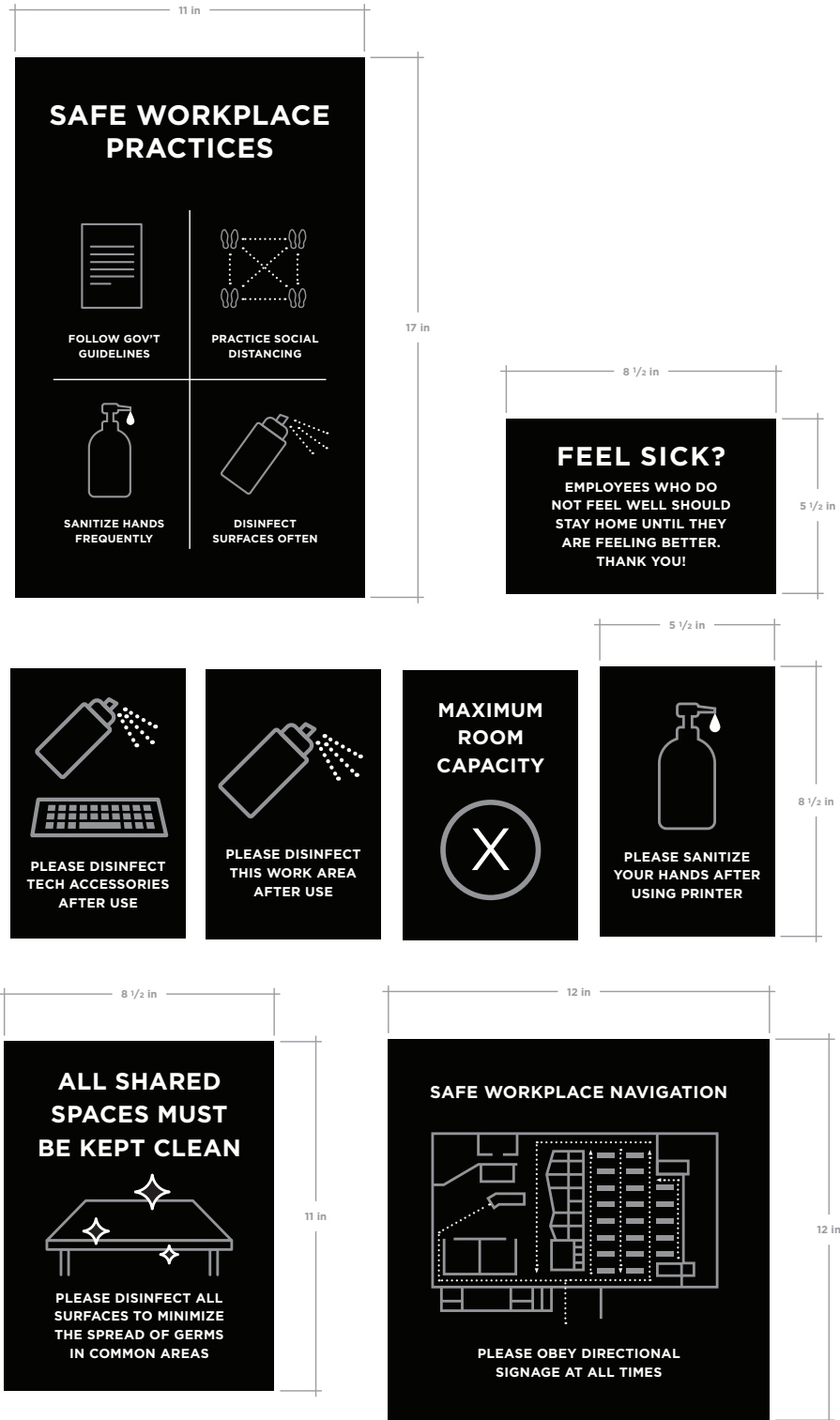

General Shared Spaces

FLOOR GRAPHICS

- Fantastic for all smooth indoor surfaces like metal, plastic laminates, wood, linoleum, tile & carpeting
- Choice of permanent or semi-permanent adhesive
- Self-installed

*Note: Standard colors shown.
Can be customized to your brand standards.*

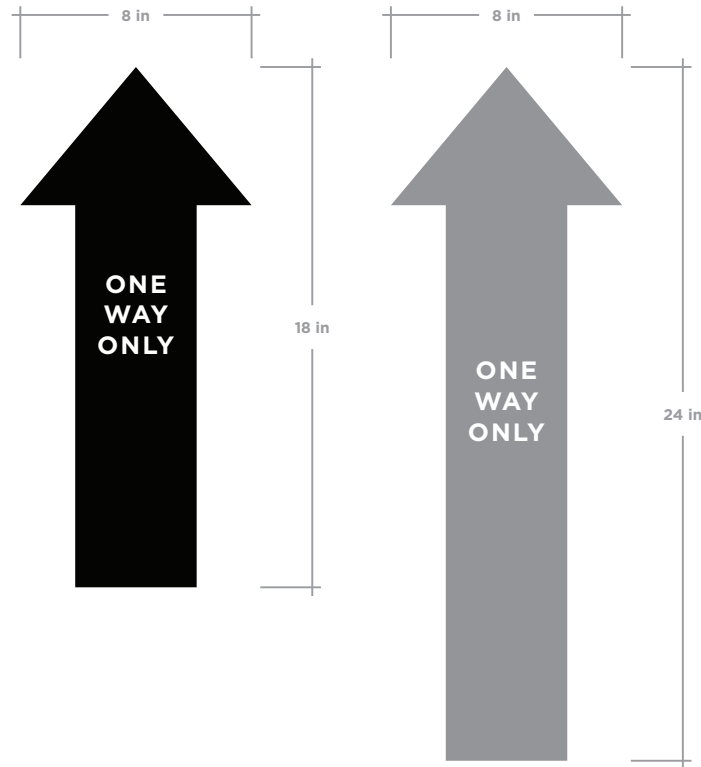

COUNTERTOPPERS

- Choice of Aerolinea®, Concurva® or Linea® display stand.

STANDARD FINISH OPTIONS



Black Silver

*Note: Standard colors shown.
Please inquire about different colors or copy.*

Linea®



8.5" x 11" insert



5.5" x 8.5" insert

Concurva®



8.5" x 11" insert



5.5" x 8.5" insert

Aero LINEA®



8.5" x 11" insert



5.5" x 8.5" insert (H)



5.5" x 8.5" insert (V)

Notification Signage

WALL-MOUNTED NOTIFICATION SIGNS

- Subsurface printed .020 material with repositionable adhesive. Signs are scratch-resistant material with subsurface copy that are impervious to 99% of all cleaners
- Self-installed

*Note: Standard colors shown.
Can be customized to your brand standards.*



Restroom Signage

WALL-MOUNTED NOTIFICATION SIGNS

- Option 1: Subsurface printed .020 material with repositionable adhesive. Signs are scratch-resistant material with subsurface copy that are impervious to 99% of all cleaners
- Option 2: MagaFrame™ with paper insert
- Self-installed

*Note: Standard colors shown.
Can be customized to your
brand standards.*

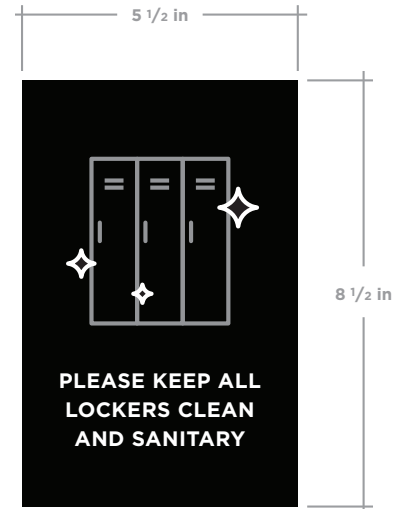
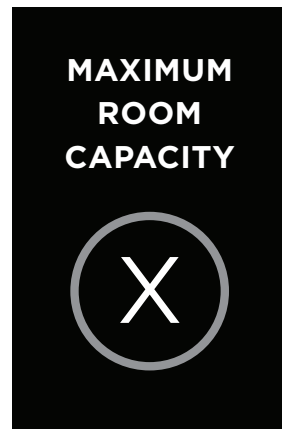

Kitchen Signage

WALL-MOUNTED NOTIFICATION SIGNS

- Option 1: Subsurface printed .020 material with repositionable adhesive. Signs are scratch-resistant material with subsurface copy that are impervious to 99% of all cleaners
- Option 2: MagaFrame™ with paper insert
- Self-installed

*Note: Standard colors shown.
Can be customized to your brand standards.*



COUNTERTOPPERS

- Choice of Aerolinea®, Concurva®, or Linea® display stand.

STANDARD FINISH OPTIONS



Black Silver



Aerolinea
5.5" x 8.5" insert



Linea®
8.5" x 11" insert



Concurva®
8.5" x 11" insert

*Note: Standard colors shown.
Please inquire about different colors or copy.*

Paper Signage Inserts

ALL INSERT ARTWORK AVAILABLE IN:

- 5.5" x 8.5"
- 8.5" x 11"
- 11" x 17"
- 22" x 28"
- Horizontal or Vertical

INSERTS CAN BE DISPLAYED IN:

- MagaFrame™
- Countertoppers
- Freestanding Displays
- Wall-Mounted Applications

*Note: Standard colors shown.
Can be customized to your
brand standards.*

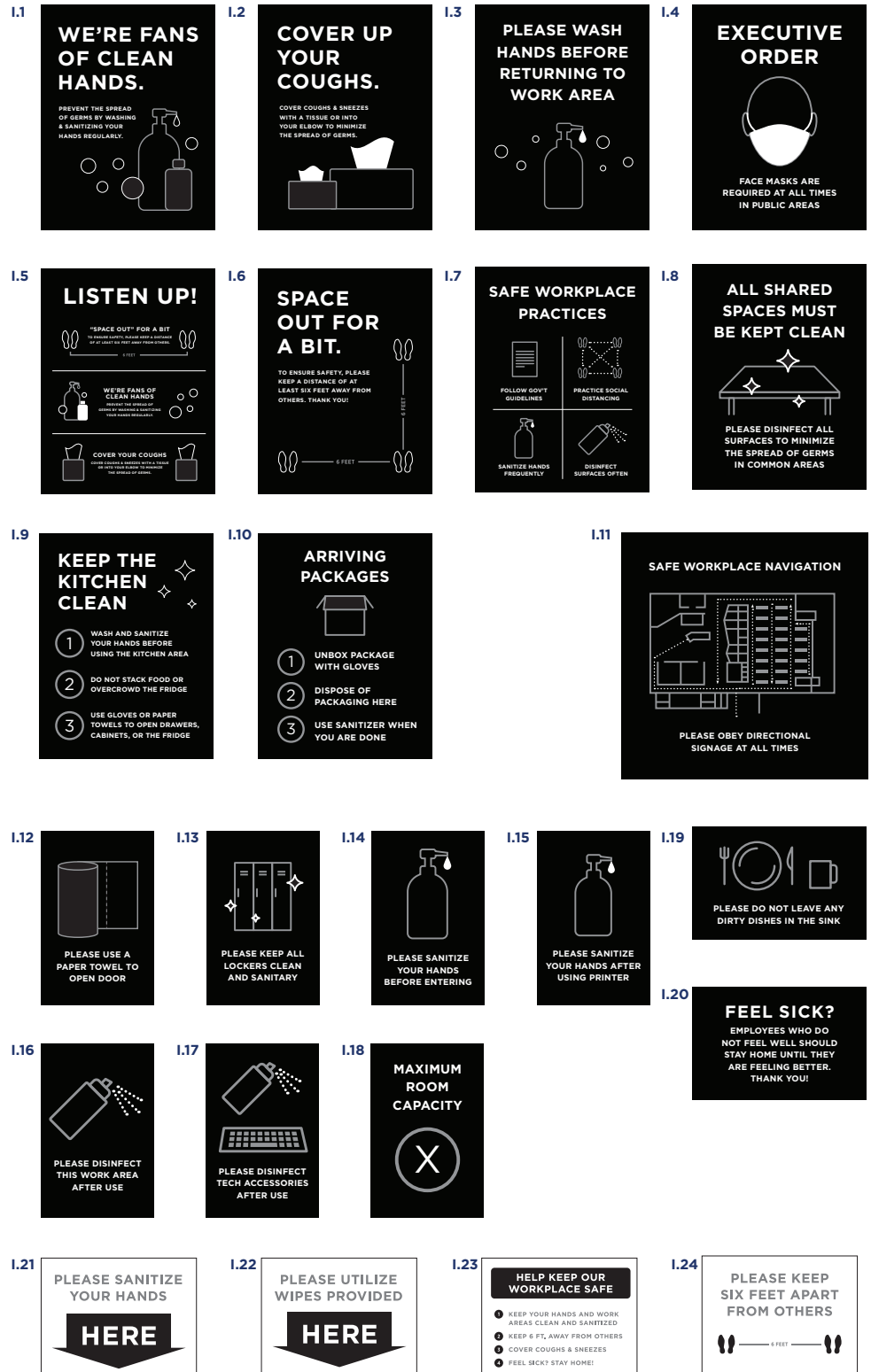

MagaFrame™



Make the most of your doors, windows, and wall space as selling and promotional venues with our MagaFrame™ lens system.

Now you can place your promotional messaging anywhere and everywhere you'd like. The MagaFrame™ self-adhesive lens system makes it easy to change out

inserts and can be applied to any flat surface. For glass doors and windows, two inserts can be placed back-to-back for double the communications and selling impact.

Available in a wide range of sizes, MagaFrame™ can also be customized to incorporate your brand logo, or to work with any decor scheme.

VERTICAL FORMAT

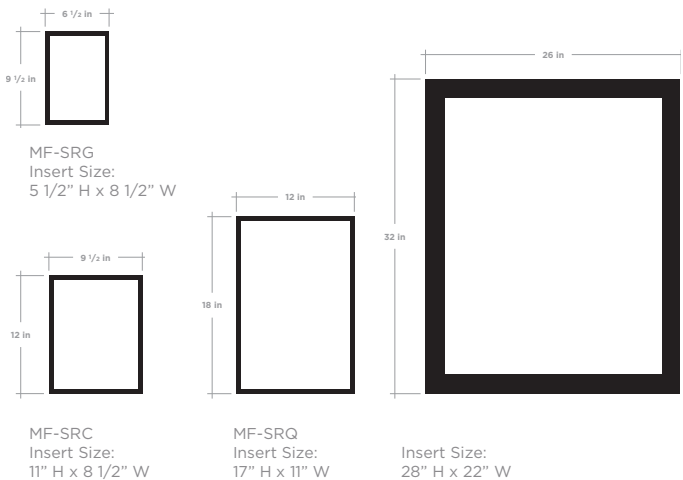

Custom sizes and designs are available.

HORIZONTAL FORMAT

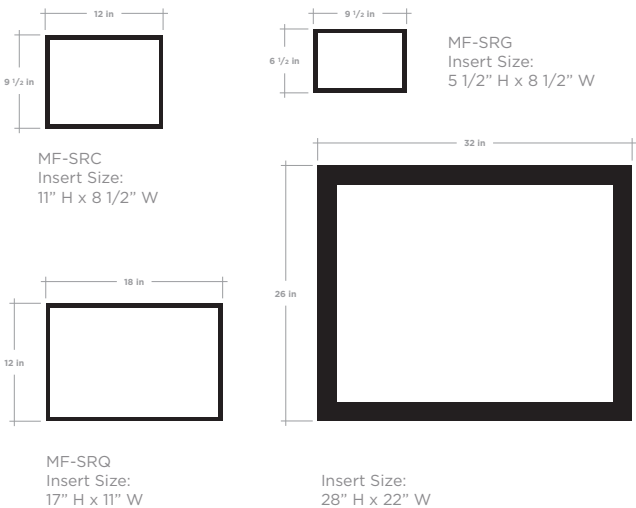

Custom sizes and designs are available.

Easy To Use

STEP 1

Peel and remove adhesive protector from rear of magnet.

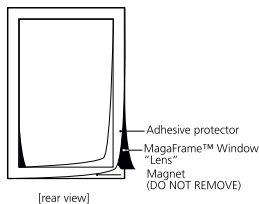

STEP 2

Align MagaFrame™ and apply by pressing firmly on lens from top to bottom. (MagaLens® opens from the bottom).

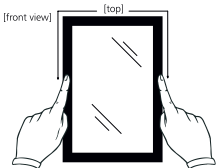

STEP 3

Lift lens from bottom edge and insert your printed graphic.



Blade Signs

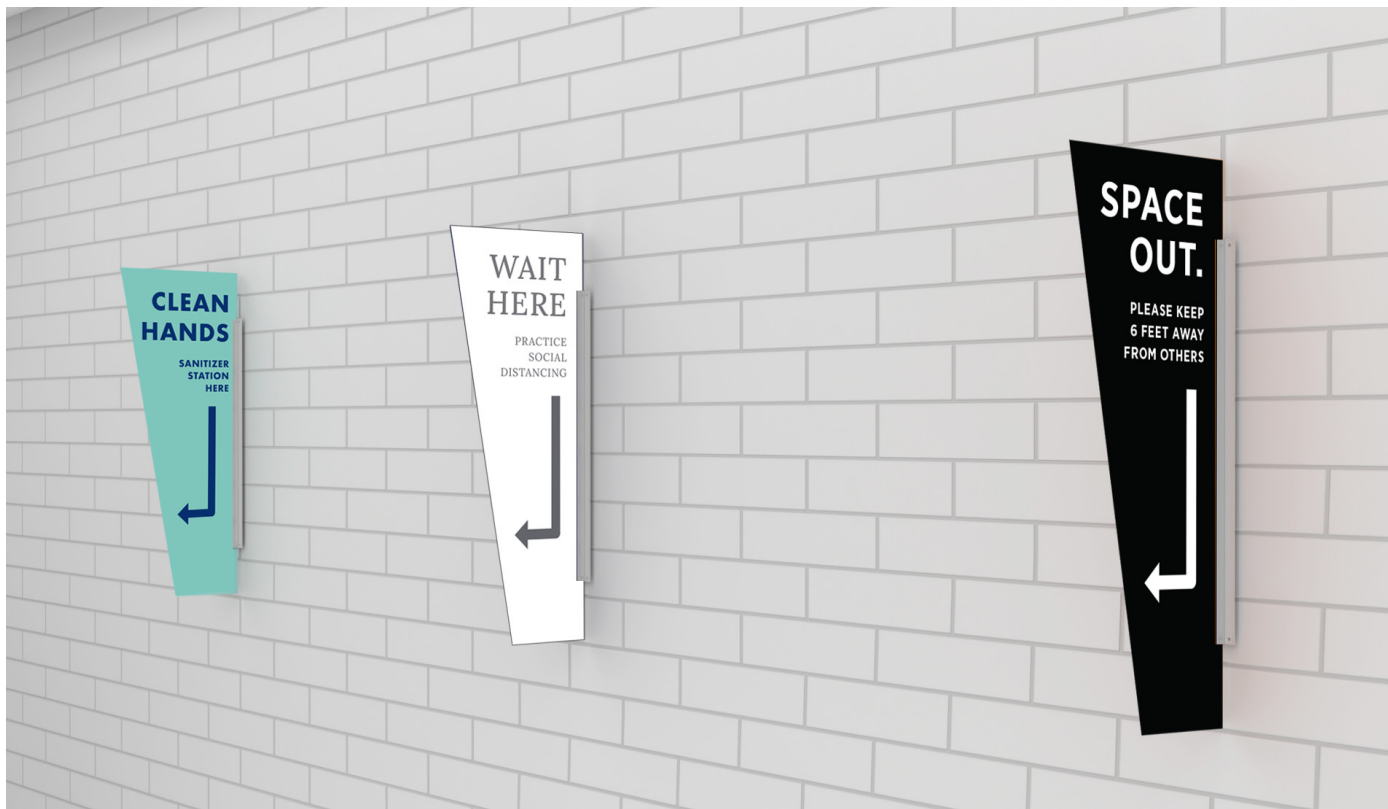

DESCRIPTION

- 24" H x 9" W
- Three color options
- 1/8" thick Double faced sintra with plastic T wall mount

*Note: Standard colors shown.
Can be customized to your
brand standards.*



Door Pull



DESCRIPTION

- 2" H x 5" W x 3" D
- 14 gauge steel with texture outdoor powder finish

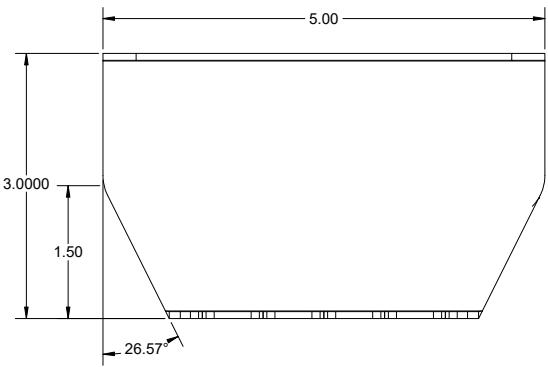

TOP VIEW



SIDE VIEW

VGS/Studio D

Online

go.vgsonline.com/wellness
info@vgs-inc.com

Offline

330 Washington Avenue
Carlstadt, NJ 07072

Phone

800-203-0301
201-528-2700

The following are trademarks of Visual Graphic Systems Inc. VGS Eyecon Logo®, AeroLinea®, AeroLinea®TearDrop, Concurva®, Linea®, GripFlex®, MagaFrame™, MagaLens®, Ovations®, Xpressions™. Products incorporating VGS' MagaLens® technology are subject to one or more of the following patents: U.S. 6,308,446, U.S. 6,298,591, CAN. 2243256, EP 0875056 and MEX 213529. VGS display fixtures and menu board designs are further subject to design copyrights and trademark protection as well as other worldwide pending patents. Copyright © 2020 VGS Inc. All rights reserved.



330 Washington Avenue
Carlstadt, NJ 07072

800-203-0301 | 201-528-2700
www.vgsstudiod.com