

coviu.com

Practical Guide to Telehealth Assessments

COVIU  Pearson

Speakers



Peter Simpson-Young
Coviu



Angela Kinsella
Pearson Clinical



Dr Melissa Stephens
Pearson Clinical



Dr Kristina Haebich
Murdoch Children's
Research Institute

F2F Requirements

- Stimulus Book(s)
- Record forms
- Manuals
- Manipulatives



Telehealth Requirements

- ~~Stimulus Book(s)~~
- Record forms
- Manuals
- Manipulatives
- Coviu + Pearson Add-ons





Available Stimulus Books

Psychology Tools	WISC-V A&NZ
	WAIS-IV A&NZ
	RBANS Forms A, B, C & D
	KBIT-2
Speech-Language Tools	CELF-5 A&NZ
	GFTA-3
	PPVT-5 Forms A&B
	EVT-3 Forms A&B
	CELF-Preschool 3 A&NZ
Academic Achievement	WIAT-III A&NZ

Validation

WISC-V + CoviU:

Hodge, M. A., Sutherland, R., Jeng, K., Bale, G., Batta, P., Cambridge, A., ... & Ganesalingam, K. (2019). *Agreement between telehealth and face-to-face assessment of intellectual ability in children with specific learning disorder*. Journal of Telemedicine and Telecare, 25(7), 431-437. <https://pubmed.ncbi.nlm.nih.gov/29874968/>

WAIS-IV + CoviU:

Mahon, S., Webb, J., Snell, D., & Theadom, A. (2021). Feasibility of administering the WAIS-IV using a home-based telehealth videoconferencing model. The Clinical Neuropsychologist, 1-13. <https://www.tandfonline.com/doi/abs/10.1080/13854046.2021.1985172>

CELF-5 + CoviU:

Sutherland, R., Trembath, D., Hodge, A., Drevensek, S., Lee, S., Silove, N., & Roberts, J. (2017). *Telehealth language assessments using consumer grade equipment in rural and urban settings: Feasible, reliable and well tolerated*. Journal of Telemedicine and Telecare, 23(1), 106-115. <https://pubmed.ncbi.nlm.nih.gov/26768598/>

CELF Preschool-3 + CoviU:

Cruickshank Campbell, Button, & Joshua (2021). *Feasibility of the CELF-P3A&NZ via Telehealth* (SPA poster)

See Webinar “[ACCURACY & RELIABILITY OF TELEHEALTH ASSESSMENTS](#)” for more details.

pearsonclinical.com.au



Australia & New Zealand

Pearson | Clinical Assessment

Search WISC, WAIS, etc

Search

Products How to order PD & Insights Contact us Resources Digital support **Telehealth** Login or Register

Welcome to Pearson Clinical

The global leader in clinical assessment, developing & distributing assessments for professionals since 1921.



pearsonclinical.com.au/telehealth

 **Pearson** | Clinical Assessment

Search WISC, WAIS, etc

Search

[Products](#) [How to order](#) [PD & Insights](#) [Contact us](#) [Resources](#) [Digital support](#) [Telehealth](#) [Login or Register](#)

Telehealth Guidelines by Product

To help you administer our top assessments via Telehealth, we've created best practice guidelines.

[Please click here](#) to find the specific guidelines developed for the product you are considering administering via Telehealth.

Note: for WISC-V ^{A&NZ} users, [please click here](#) to access the Nonmotor Full Scale Score (NMFSS)

Disinfecting test materials

When face to face assessments are necessary, it's vital that you disinfect your test materials.

[Click here to learn more](#)

Using Personal Protective Equipment (PPE)

[Click here for a guide of using PPE in assessment.](#)



2021

Your Guide to Pearson
Telehealth Resources





Download
Telehealth Booklet

Conducting Telehealth Assessments

1. Telepractice Environment & Equipment



2. Assessment Procedures & Materials



3. Examinee Considerations



4. Examiner Considerations



5. Other Considerations



Specific Telehealth Considerations by Subtest

Subtest(s)	Considerations
 Visual Puzzles Matrix Reasoning Figure Weights Picture Completion	<ul style="list-style-type: none">• Requires high quality video for examinee and examiner• Examiner points to stimuli on screen using mouse cursor• Peripheral camera/device should be placed in a stable position that shows examinee's screen and provides a view of choices made nonverbally (e.g., pointing)• <i>Visual Puzzles</i>: It is not recommended to allow examinee to use mouse or touchpad to point at choices, as the intended response cannot be clearly determined• <i>Matrix Reasoning, Figure Weights</i>: Examinee can use mouse or touchpad to point at choices if teleconference platform allows examiner to pass control of the mouse• <i>Visual Puzzles, Figure Weights, Picture Completion</i>: Examiner uses stopwatch; examiner must ensure the examinee stops at the item time limit• <i>Picture Completion</i>: Some verbal responses must be clarified with a correct pointing response

What About Block Design?

- No trained professional facilitator = **no** BD for telehealth
- It is **not recommended** to allow a parent/guardian/caregiver to present blocks nor for the examinee to scramble or present their own blocks
- No BD and no response booklets = **no** FSIQ or PSI

WISC-V Non-Motor Full Scale Score (NMFSS)

- Optional when blocks and response booklets cannot be used
- US FSIQ and NMFSS correlate overall at **.96** (ranges .94-.97)
- NMFSS correlates **more highly** with US FSIQ than 'FSIQ retest', which was .92

Best practice telehealth assessments

Dr Kristina Haebich
Murdoch Children's Research Institute

28.10.2021



“Tele-Assess: Telehealth-delivered neurodevelopmental Assessments in children and adolescents”

- Home-based telehealth assessment of:
 - Cognitive abilities
 - Speech, language and oromotor skills
 - Symptoms of autism spectrum disorder
- Determine equivalence
- Examine feasibility



Features of *Tele-Assess*:

- Home-based telehealth assessment
- Secure distribution of stimuli, manipulatives and booklets
- Use of CoviU WISC-V add-on
- Assistance from trained parent facilitators
- Using technology to enhance the assessment experience



Promising results to date!

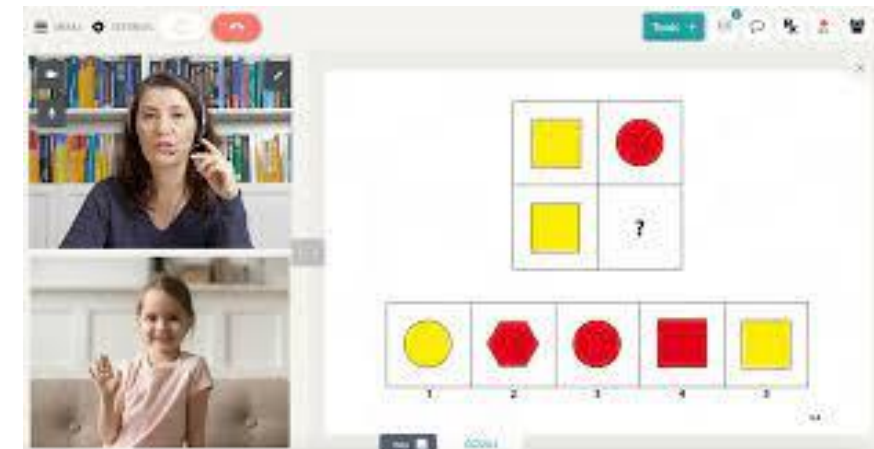

Practical pointers

- Triaging
- Internet
- Devices
- Assessment environment
- Expectations

Triaging

- Referral question
- Client factors
 - Sensory/language
 - Cognition
 - Behaviour
 - Psychiatric status
 - Engagement
 - Diagnosis
 - Known to service



Internet

- Have an initial meeting over telehealth
- Check upload/download speed
- Discuss ways to improve internet connection
- Discuss alternatives to home Wifi
- Discuss a back-up plan!



- Primary device (audio/visual)
 - <https://www.pearsonclinical.com.au/telehealth>
 - Teleneuropsychology guidelines (Stolwyk, Kelso, Hodge, Mullaly, Philpott & Wong)
- Secondary device “modified document camera”
- Third device
 - Third device set-up: “Deep Dive: 3rd Camera Hack Ideas YouTube”

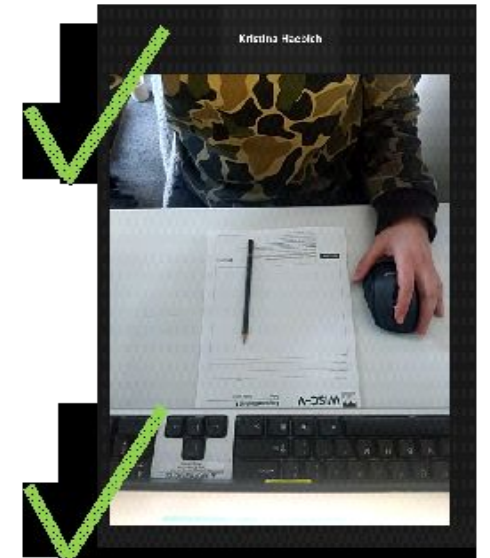

<https://www.pearsonassessments.com/professional-assessments/digital-solutions/telepractice/resources.html>

Remote Assessment Setups (Examiner)

This schematic offers general examples of managing remote assessment technology setups. As always, local/state/federal laws and professional guidelines apply as well as ethical and clinical considerations for each situation. Pearson Field Research requirements or individual test restrictions may differ.



1

Screen 1

Purpose:

Face-to-face communication; display of testing materials to the examinee as needed.

Best Practices:

Monitor with external/internal webcam and speakers

2

Screen 2

Purpose:

Placed beside Screen 1 to view additional administration materials (examiner views only).

Best Practices:

A cell phone or tablet might be used instead of a full second monitor, but a second full monitor for an examiner is highly recommended.

Pay special attention to orientation and lighting needs in examiner and examinee setup. In examiner setup, create a distraction-free background against a wall, not a window or door.

Note: The lower two views on this page offer alternative set-ups for the examiner.

Visit [pearsonassessments.com/telepractice](https://www.pearsonassessments.com/telepractice) for video examples and additional ideas, especially the "Third Camera Hacks" video.

© 2020 Pearson Education, Inc. or its affiliates. All rights reserved. Pearson is a trademark, in the U.S. and/or other countries, of Pearson plc. CLINA24464A MJL 8/20



<https://www.pearsonassessments.com/professional-assessments/digital-solutions/telepractice/resources.html>

Remote Assessment Setup (Examinee)

This schematic offers general examples of managing different remote assessment technology setups. As always, local/state/federal laws and guidelines apply as well as ethical and clinical considerations for each situation. Pearson Field Research requirements or individual test restrictions may differ.



1

Computer/Laptop Screen

Purpose:
Face-to-face communication; display of testing materials as needed

Best Practices:
Screen size minimum 9.7" diagonal with external/internal webcam and speakers

2

Device/Camera to View Monitor

Purpose:
Placed on one side of the examinee, pointed to middle of screen to capture entire screen.

Best Practices:
Point camera at the computer monitor and add this device to the telepractice session. Ideally, the camera is raised to the centerpoint of Screen 1.

3

Device/Camera to View Desktop

Purpose:
Placed on one side of Screen 1, pointed to area where Examiner can see Examinee write on 8.5x11 test materials.

Best Practices:
Position camera 14-16 inches above table pointing it down to the test material. Add this device to the telepractice session. For mounting options, view "Third Camera Hacks" video on our Telepractice webpage.

Notes: For a low-tech alternative, try a mirror behind the examinee in a similar location/set-up. Also consider right-handed versus left-handed side placement—especially with desktop view and writing tasks.

Home Setup: Consider alternative options as required. Views 2 & 3 can be achieved with a single device, if needed, with facilitator training and pre-assessment practice, for some assessments.

Visit [pearsonassessments.com/telepractice](https://www.pearsonassessments.com/telepractice) for video examples and additional ideas, especially the "Third Camera Hacks".

© 2020 Pearson Education, Inc. or its affiliates. All rights reserved. Pearson is a trademark, in the U.S. and/or other countries, of Pearson plc. CLINA24464B MJL 8/20



Assessment environment

- Discuss need to replicate standardised test setting
- Ask about the room testing will take place in
- Discuss “internal” and “external” factors



Expectations

- Client
- Effort
- Copyright



Acknowledgements

- A/Prof Rene Stolwyk and Dr Wendy Kelso

- *Tele-Assess* research team:

Study team

- Co-CI A/Prof Jonathan Payne
- Dr Hayley Darke
- Ms Alice Maier
- Dr Francesca Lami
- Dr Veronica Frewer
- Dr Alex Ure
- Mr Stephen Hearps
- Ms Jacquie Wrennall
- Prof Vicki Anderson
- A/Prof Daryl Efron
- Prof Angela Morgan
- Dr Gabriel Dabscheck
- Prof Katrina Williams
- Prof Kathryn North

Additional thanks

- Melissa Stephens (Pearson)
- Pete Simpson-Young (Coviu)
- Nicki Joshua (Pearson)
- Hannah Cruickshank Campbell (Pearson)

Telehealth Assessments in Coviu

Self-Report Questionnaires

DASS-21	Depression Anxiety Stress Scales
K10	Kessler Psychological Distress Scale
GAD-7	General Anxiety Disorder-7
PHQ-9	Patient Health Questionnaire-9

Pearson Clinical Questionnaires	
BDI	Beck Depression Inventory-II
BAI	Beck Anxiety Inventory
BHS	Beck Hopelessness Scale
BSS	Beck Scale for Suicide Ideation
BYI	Beck Youth Inventories

Self-Report Questionnaires in CoviU

- Real-time scoring
- PDF reports
- Cloud-storage of reports

Demo

1. How to **use** self-reporting **questionnaires** in CoviU
2. How to **use** psychometric **assessments**
3. How to **install** psychometric **assessments**

Pricing

Psychometric Assessments	
WISC-V A&NZ	\$20
WAIS-IV A&NZ	\$20
RBANS Forms A, B, C & D	\$15 per stimulus book
KBIT-2	\$15
CELF-5 A&NZ	\$15
GFTA-3	\$15 per stimulus book
PPVT-5 Forms A&B	\$15 per stimulus book
EVT-3 Forms A&B	\$15 per stimulus book
CELF-Preschool 3 A&NZ	\$15
WIAT-III A&NZ	\$20

Self-Report Questionnaires	
DASS-21	Free
K10	\$2.50 p/month
GAD-7	\$2.50 p/month
PHQ-9	\$2.50 p/month

Pearson Clinical Questionnaires	
BDI	\$10 p/month
BAI	\$10 p/month
BHS	\$10 p/month
BSS	\$10 p/month
BYI	\$35 p/month (or \$10 per inventory)

Pricing

- Monthly subscription (e.g. \$15 or \$20 per stimulus book, per account, per month)
- Pricing includes:
 - Unlimited number of users
 - Unlimited number of administrations
- Stimulus books are sold separately
 - Including assessments with multiple stimulus books
- Still require scoring record forms (or Q-Global)
- CoviU plan is priced separately

Upcoming CoviU Webinars

Marketing Your Telehealth Practice

Monday, November 8th
12:30pm - 1:30pm AEDT

In partnership with



6 Evidence-Based Strategies to Enhance Video Telehealth

Thursday, November 18th
12:30pm - 1:30pm AEDT

Presented by Peter Simpson-Young



Register here:

www.coviu.com/webinars

coviu.com

Thank you -

Peter Simpson-Young

Telehealth Evangelist

Email: peter@coviu.com

