

PUMPER BODY
Medium Aluminum 2nd Gen Pumper

CHASSIS
Enforcer Chassis

CHASSIS AXLE, FRONT, CUSTOM
19,500 Lb TAK-4 Axle

AXLE, REAR
27,000 Lb Dana Axle

ENGINE
505 HP DD13 Engine

TRANSMISSION
Allison 5th Gen, 4000 EVS PR

BUMPER
22" Extended Painted Steel

CAB
6010 Enforcer Cab

BODY WATER TANK
750 Gallon Poly Water Tank

COMPT, PUMPER, REAR
44.50" FF RollUp Rear Compt

COMPT, PUMPER, DRIVER SIDE
152" RollUp Full Height Front & Rear FDLR

COMPT, PUMPER PASS. SIDE
152" RollUp Full Height Front & Rear FDLR

FIRE SUPPRESSION PUMPHOUSE
45" Control Zone Top Mount

PUMP
1500 GPM Waterous CSU

CROSSLAYS, 1.50"
1.50" Crosslays Not Required

CROSSLAYS, 2.50"
(1) 2.50" Standard Capacity

SPEEDLAYS
(2) 1.50" W/Troy Std. Capacity

GENERATOR
Generator Not Required

Foam System
Husky 3 Single Agent Foam System

Foam Cell
30 Gallon Foam Cell, Not Reduced Water

Side Roll and Frontal Impact Protection

NOTE
DIMENSIONS SHOWN ARE APPROXIMATE AND ARE SUBJECT TO MINOR DEVIATIONS AS MAY OCCUR OR BE NECESSARY IN CONSTRUCTION. MINOR DETAILS NOT SHOWN.

1. AUTOMATIC TIRE CHAINS
2. ONE 1.50" OUTLET WITH 2.00" PIPING AND SWIVEL LOCATED IN CENTER BUMPER TRAY
3. SHORELINE RECEPTACLE WITH KUSSMAUL SUPER AUTO-EJECT LOCATED ON DRIVER SIDE OF THE CAB
4. AIR INLET/OUTLET WITH DISCONNECT COUPLING ON THE DRIVER SIDE PUMP PANEL
5. BATTERY CHARGER LOCATED BEHIND DRIVERS SEAT
6. BATTERY CHARGE INDICATOR LOCATED ON THE DRIVER SIDE SEAT RISER
7. ELEVEN ADJUSTABLE SHELVES LOCATED PER SHOP ORDER
8. THREE FLOOR MOUNTED SLIDE-OUT TRAYS LOCATED PER SHOP ORDER
9. ONE SWING-OUT TOOLBOARD LOCATED PER SHOP ORDER

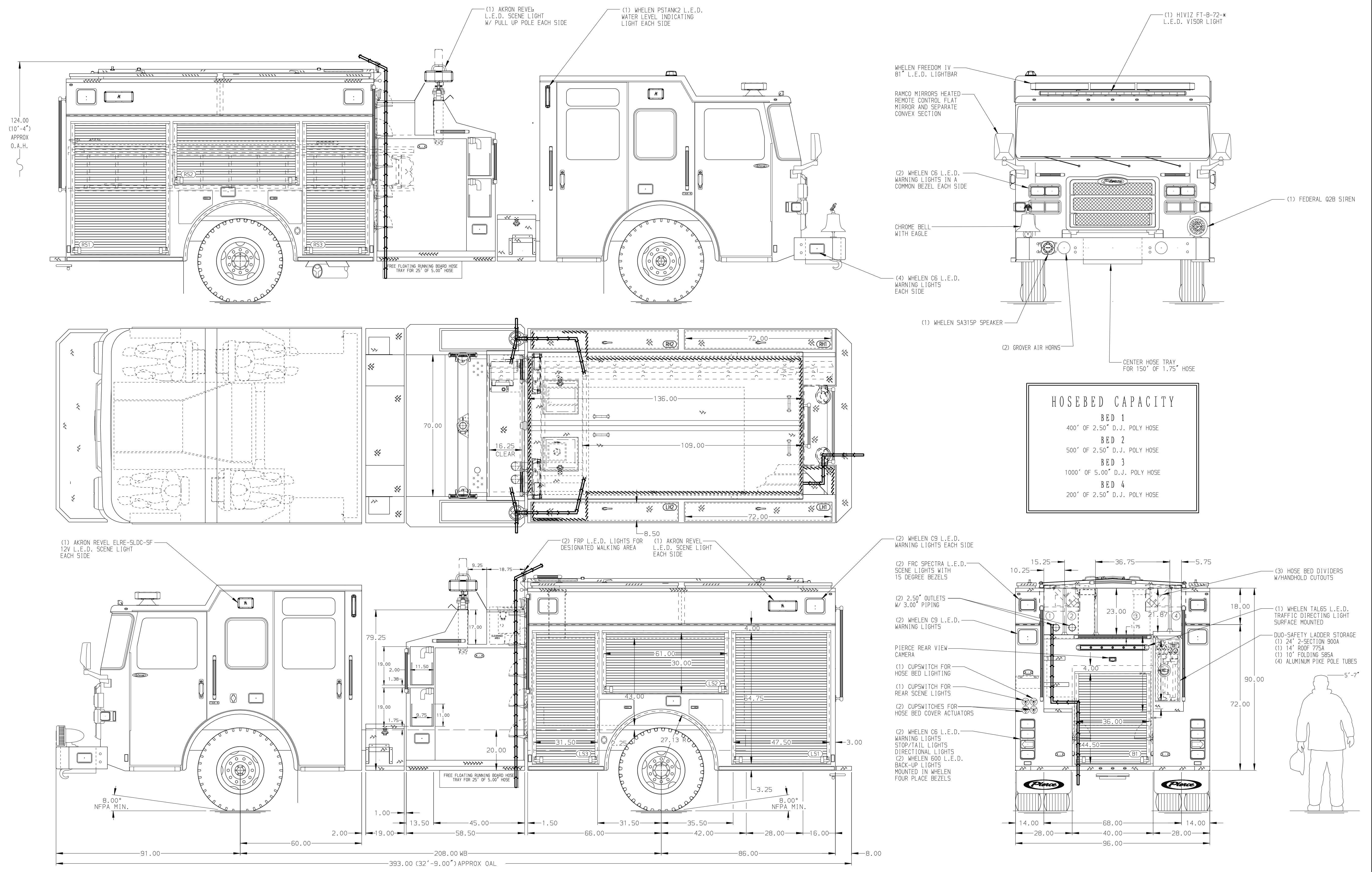

HOSEBED CAPACITY

BED 1	400' OF 2.50" D.J. POLY HOSE
BED 2	500' OF 2.50" D.J. POLY HOSE
BED 3	1000' OF 5.00" D.J. POLY HOSE
BED 4	200' OF 2.50" D.J. POLY HOSE

Pierce MANUFACTURING INC.		JOB NO.	36434
		SCALE	DATE
		1:24	
TITLE		Pierce Pumper Approval Drawing	
FOR		Trussville Fire and Rescue	
DRAWN BY		MMF	
CHECKED BY		COL	
SHEET SIZE		SHEET NO.	
D		1 OF 1	
REV	DATE	BY	CH
25AUG21		MMF	CSH
07MAY21		MMF	CSH
20APR21		MMF	COL
15MAR21		MMF	CSH
ENFORCER			