

PUMPER BODY

Long Aluminum 2nd Gen Pumper

CHASSIS

Enforcer Chassis

CHASSIS AXLE, FRONT, CUSTOM

22,800 Lb TAK-4 Axle

AXLE, REAR

31,000 Lb Dana Axle

ENGINE

450 HP Cummins L9 Engine

TRANSMISSION

Allison 5th Gen, 3000 EVS P

BUMPER

19" Extended Painted Steel

CAB

7010 Enforcer Cab

BODY WATER TANK

1000 Gallon Poly Water Tank

COMPT, PUMPER, REAR

37.75" FF RollUp Rear Compt

COMPT, PUMPER, LEFT SIDE

171" RollUp Full Height Front & Rear FDLER

COMPT, PUMPER, RIGHT SIDE

171" RollUp Full Height & Depth Front, FH Rear, FDLER

FIRE SUPPRESSION PUMPHOUSE

48" Control Zone Side Mount

PUMP

2000 GPM Waterous CSU

CROSSLAYS, 1.50"

(1) 1.50" Standard Capacity

CROSSLAYS, 2.50"

(1) 2.50" Standard Capacity

SPEEDLAYS

SpeedLays Not Required

GENERATOR

10kw MCR Generator

Foam System

Husky 3 Single Agent Foam System

Foam Cell

25 Gallon Foam Cell, Reduced Water

Side Roll and Frontal Impact Protection

NOTE

DIMENSIONS SHOWN ARE APPROXIMATE AND ARE SUBJECT TO MINOR DEVIATIONS AS MAY OCCUR OR BE NECESSARY IN CONSTRUCTION. MINOR DETAILS NOT SHOWN.

- ONE 1.50" OUTLET WITH 2.00" PIPING AND SWIVEL LOCATED ON TOP BUMPER LEFT SIDE
- SHORELINE RECEPTACLE WITH KUSSMAUL SUPER AUTO-EJECT LOCATED ON DRIVER SIDE OF THE CAB
- AIR INLET WITH DISCONNECT COUPLING IN THE DRIVER SIDE STEPWELL
- BATTERY CHARGER LOCATED IN COMPARTMENT PER SHOP ORDER
- BATTERY CHARGE INDICATOR LOCATED ON THE DRIVER SIDE SEAT RISER
- FOUR ADJUSTABLE SHELVES IN COMPARTMENTS PER SHOP ORDER
- ONE FLOOR MOUNTED SLIDE-OUT TRAY IN COMPARTMENT PER SHOP ORDER

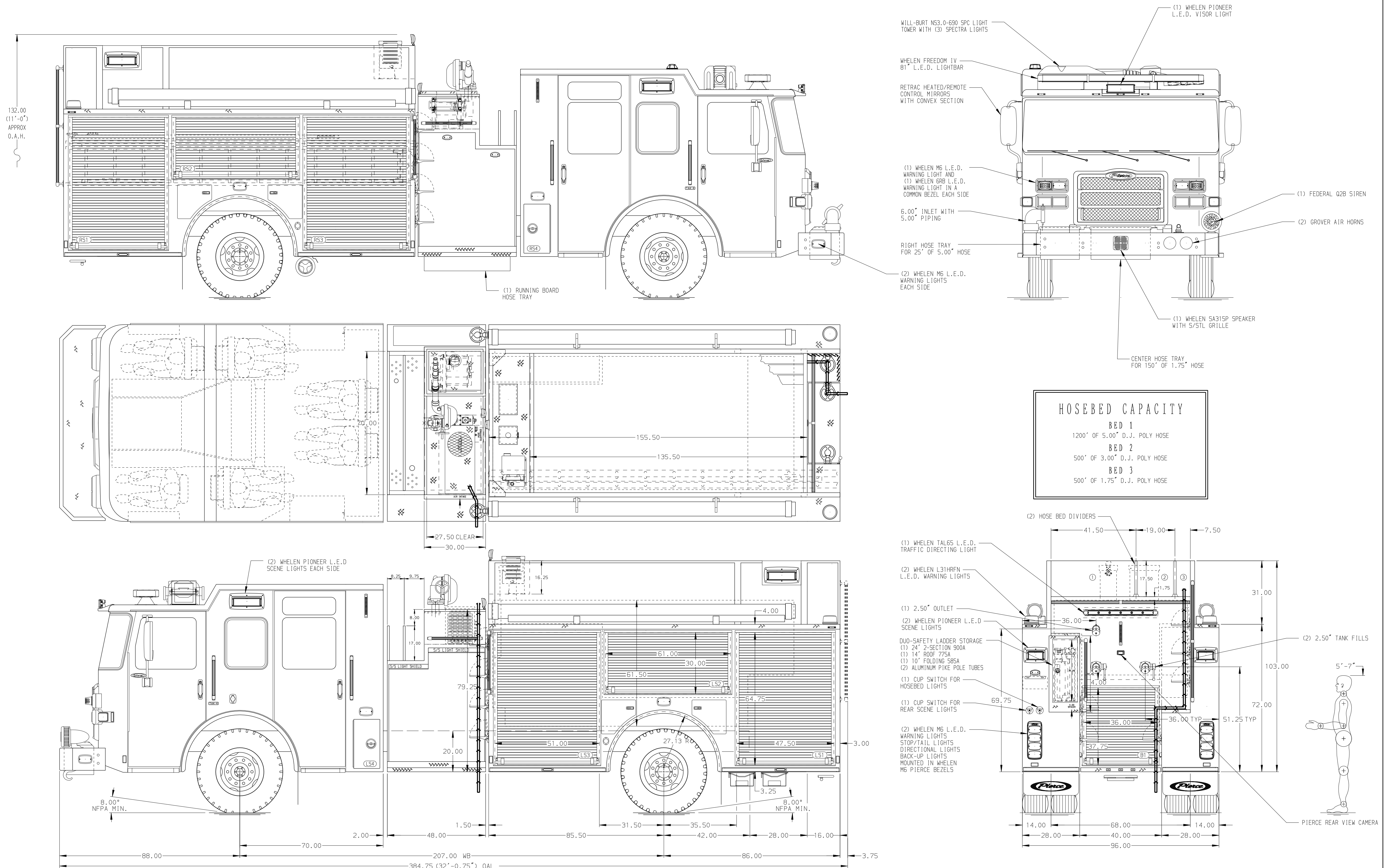

HOSEBED CAPACITY	
BED 1	1200' OF 5.00" D.J. POLY HOSE
BED 2	500' OF 3.00" D.J. POLY HOSE
BED 3	500' OF 1.75" D.J. POLY HOSE

		JOB NO.	36185
		SCALE	DATE
TITLE Pierce Pumper Approval Drawing		DRAWN BY	08MAR21
		CHECKED BY	9MAR21
FOR Ellenville		SHEET SIZE	SHEET NO.
		D	1 OF 1
DWG NO. 36185AD			

REV	DATE	BY	CH	ENFORCER
18OCT21	MMF	CSH		CHASSIS DATA
07SEP21	MMF	CSH		PIERCE
16JUL21	MMF	THS		MODEL
24MAY21	COL	THS		
10MAR21	MMF	COL		