

- HOSEBED CAPACITIES**
- ① 1000' OF 5.00\"/>

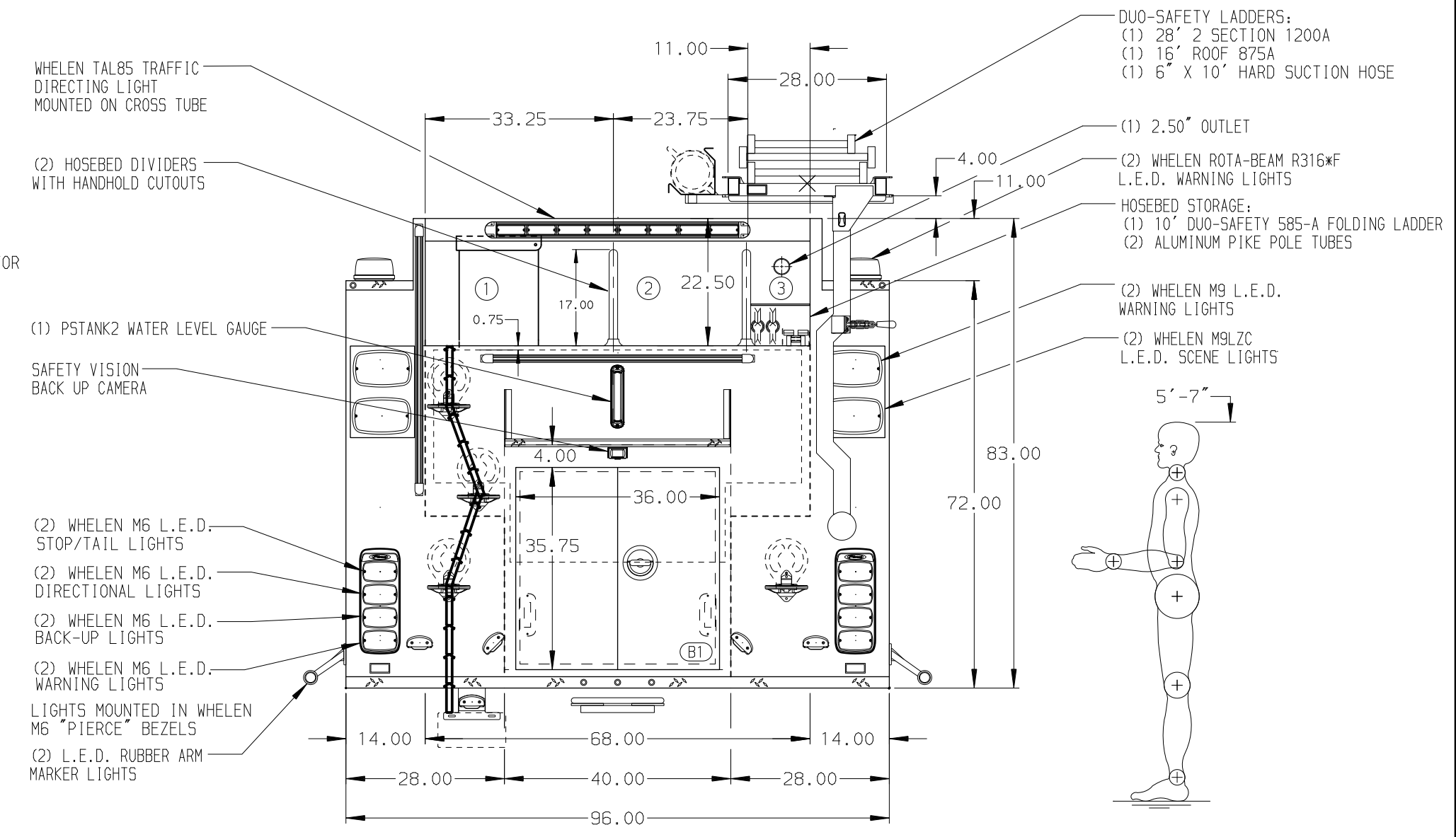
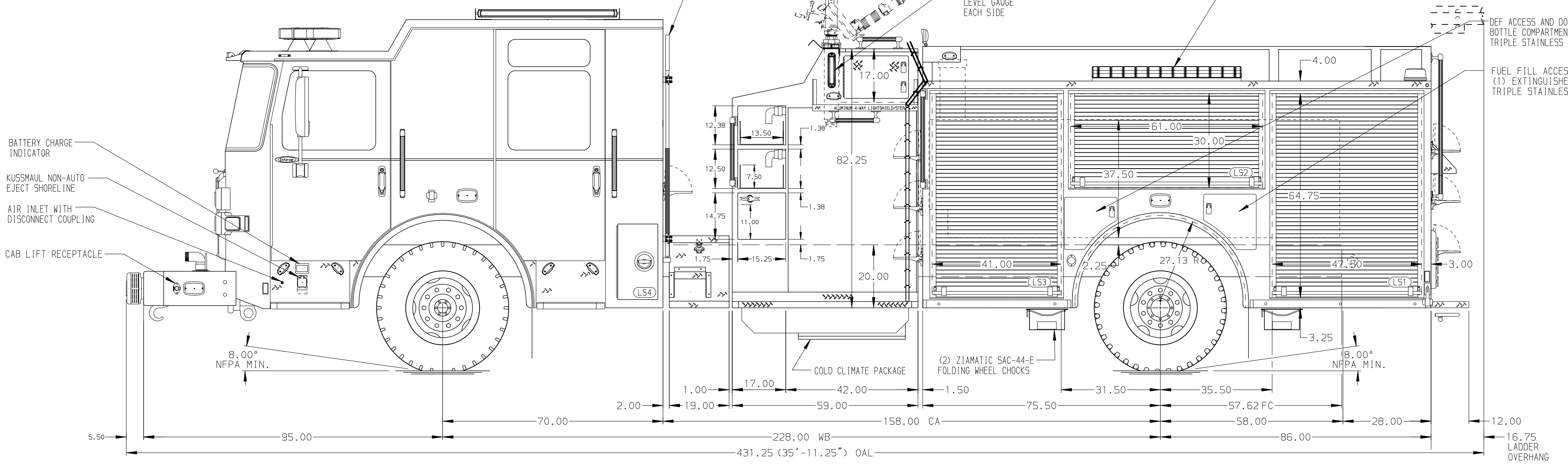

ALUMINUM BODY

NOTE
DIMENSIONS SHOWN ARE APPROXIMATE AND ARE SUBJECT TO MINOR DEVIATIONS AS MAY OCCUR OR BE NECESSARY IN CONSTRUCTION. MINOR DETAILS NOT SHOWN.

- 1. KUSSMAUL BATTERY CHARGER LOCATED IN EMS COMPARTMENT
- 2. BRUSHED STAINLESS STEEL SCUFFPLATE INSIDE BODY COMPARTMENT DOORS OF B1
- 3. DRIP PAN GUARD FOR ROLL-UP DOOR LOCATED L51, L52, L53, R51, R52, R53
- 4. ONE FULL WIDTH/DEPTH ADJUSTABLE SHELF IN COMPARTMENTS L51, L52, R51, R52, R53; TWO IN L53
- 5. ONE FULL WIDTH/DEPTH ADJUSTABLE SHELF WITH 2\"/>

REV	DATE	BY	CH	ENFORCER
26AUG21	LME	EGO		CHASSIS DATA
25AUG21	LME	EGO		MAKE
24AUG21	LME	EGO		PIERCE
23AUG21	LME	GKH		MODEL
09AUG21	LME	DTS		

		JOB NO.	36140
		SCALE	DATE
TITLE	FOR	DWG NO.	
1500-D-1000P, 161\"/>		DRAWN BY	23MAR21
WILMINGTON FIRE PROTECTION DISTRICT WILMINGTON, ILLINOIS		CHECKED BY	23MAR21
36140AD		SHEET SIZE	SHEET NO.
		D	1 OF 1