

Pumper, PUC

BODY

Pumper, PUC, Aluminum

CHASSIS

Velocity Chassis, PUC (Medium Block)

CHASSIS AXLE, FRONT, CUSTOM

19,500 Lb TAK-4 Axle

AXLE, REAR

24,000 Lb Meritor Axle

ENGINE

450 HP Cummins L9 Engine

TRANSMISSION

Allison 5th Gen, 3000 EVS P

BUMPER

19" Extended Painted Steel

CAB

7010 Velocity FR Cab, PUC

BODY

WATER TANK

500 Gallon Poly Water Tank

COMPT, PUMPER, REAR

33.50" FF RollUp Rear Compt w/Tailboard, PUC

COMPT, PUMPER, LEFT SIDE

177" RollUp Full Height & Depth Front & Rear, PUC

COMPT, PUMPER, RIGHT SIDE

177" RollUp Full Height & Depth Front & Rear, PUC

FIRE SUPPRESSION PUMPHOUSE

Control Zone, PUC

PUMP

1500 GPM Pierce PUC

CROSSLAYS, 1.50"

(2) 1.50", Poly Trays, 200'

CROSSLAYS, 2.50"

(1) 2.50", Poly Tray, 200'

GENERATOR

Generator Not Required

Foam System

Foam System Not Required

Foam Cell

Foam Cell Not Required

Frontal Impact Protection

NOTE

DIMENSIONS SHOWN ARE APPROXIMATE AND ARE SUBJECT TO MINOR DEVIATIONS AS MAY OCCUR OR BE NECESSARY IN CONSTRUCTION. MINOR DETAILS NOT SHOWN.

- ONE 1.50" OUTLET WITH 2.00" PIPING AND SWIVEL LOCATED ON TOP BUMPER LEFT SIDE
- 120W SHORELINE RECEPTACLE LOCATED IN DRIVER'S STEP WELL
- AIR INLET/OUTLET WITH DISCONNECT COUPLING ON THE DRIVER SIDE PUMP PANEL
- BATTERY CHARGER LOCATED IN COMPARTMENT PER SHOP ORDER
- BATTERY CHARGE INDICATOR LOCATED NEAR DRIVER SEAT RISER WITH BRACKET
- SEVEN ADJUSTABLE SHELVES IN COMPARTMENTS PER SHOP ORDER
- THREE FLOOR MOUNTED SLIDE-OUT TRAY IN COMPARTMENT PER SHOP ORDER
- ONE SLIDE-OUT TRAYS WITH 2" SIDES LOCATED IN COMPARTMENT PER SHOP ORDER
- ONE SWING-OUT TOOLBOARDS LOCATED IN COMPARTMENTS PER SHOP ORDER
- ONE TOOLBOARD ADDED TO SLIDE-OUT TRAY LOCATED IN COMPARTMENT PER SHOP ORDER

- SCBA BRACKETS LOCATED IN COMPARTMENTS PER SHOP ORDER
- TWO PARTITIONS LOCATED IN COMPARTMENTS PER SHOP ORDER

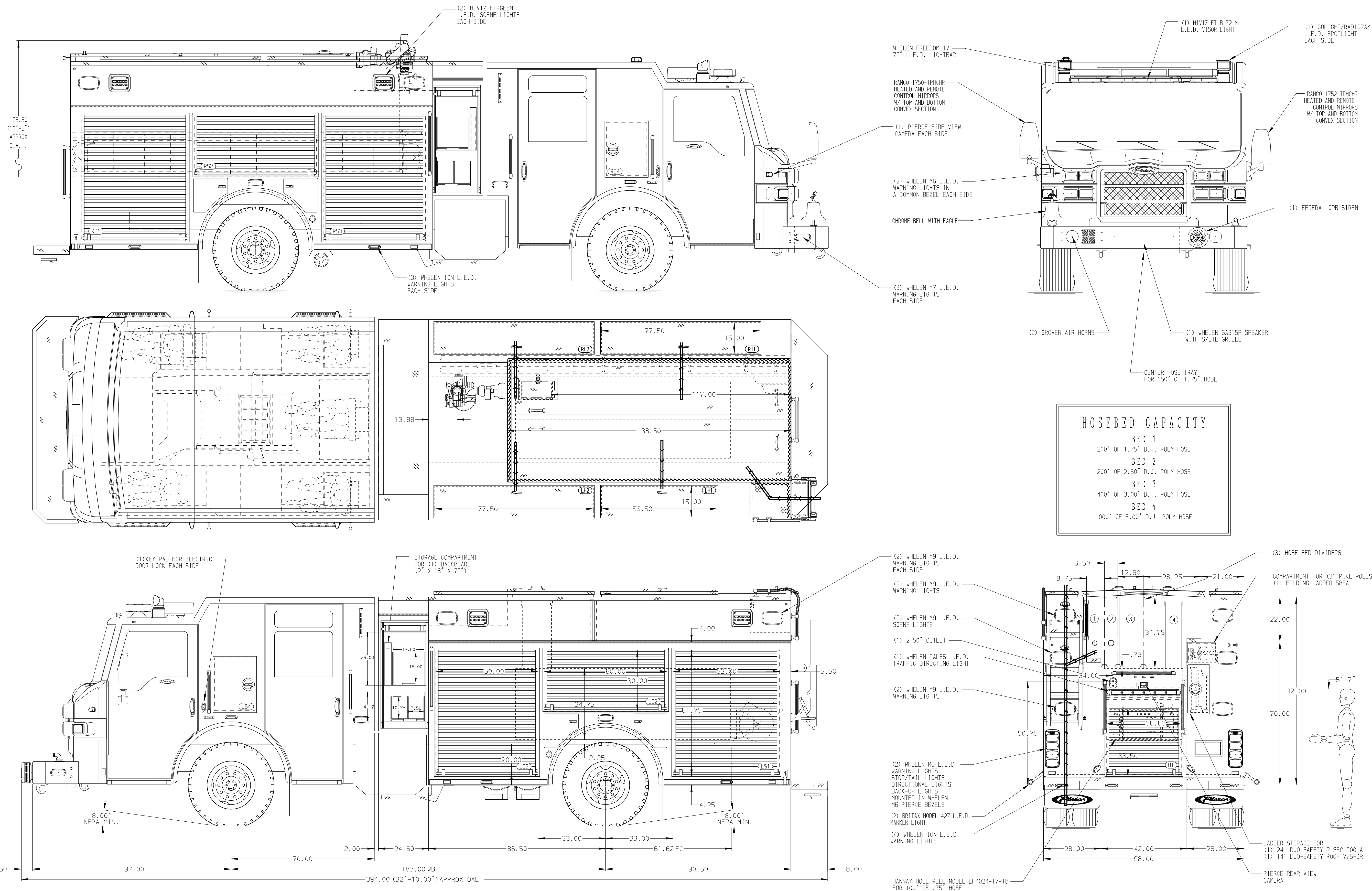

HOSEBED CAPACITY	
BED 1	200' OF 1.75" D.J. POLY HOSE
BED 2	200' OF 2.50" D.J. POLY HOSE
BED 3	400' OF 3.00" D.J. POLY HOSE
BED 4	1000' OF 5.00" D.J. POLY HOSE

		JOB NO.	35956
		SCALE	DATE
Pierce MANUFACTURING INC.		TITLE	Pierce PUC Pumper Approval Drawing
		FOR	South Jordan City Fire Department
		CHECKED BY	COL
		SHEET SIZE	SHEET NO.
		DWG NO.	35956AD
		REV	1 OF 1

REV	DATE	BY	CH	VELOCITY FR	MODEL	PIERCE	CHASSIS DATA	MAKE
30APR21		MMF	CHR					
01MAR21		MMF	CHR					
29MAR21		MMF	CHR					
29MAR21		MMF	CHR					
25MAR21		MMF	CHR					