

- HOSEBED CAPACITIES (KEY HOSE)**
- ① 300' OF 2.50" BIG 10 HOSE - 2 STACKS
 - ② 300' OF 1.75" TRUE 10 HOSE - 2 STACKS (TRAY DIMENSIONS: INSIDE = 6.50" WIDE X 17.50" HIGH X 80.00" LONG)
 - ③ 600' OF 3.00" ECO-10 HOSE - 3 STACKS
 - ④ 1000' OF 5.00" PRO-FLO HOSE - 3 STACKS
 - ⑤ 300' OF 2.50" BIG 10 HOSE - 2 STACKS
 - ⑥ 300' OF 1.75" TRUE 10 HOSE - 2 STACKS (TRAY DIMENSIONS: INSIDE = 6.50" WIDE X 17.50" HIGH X 80.00" LONG)

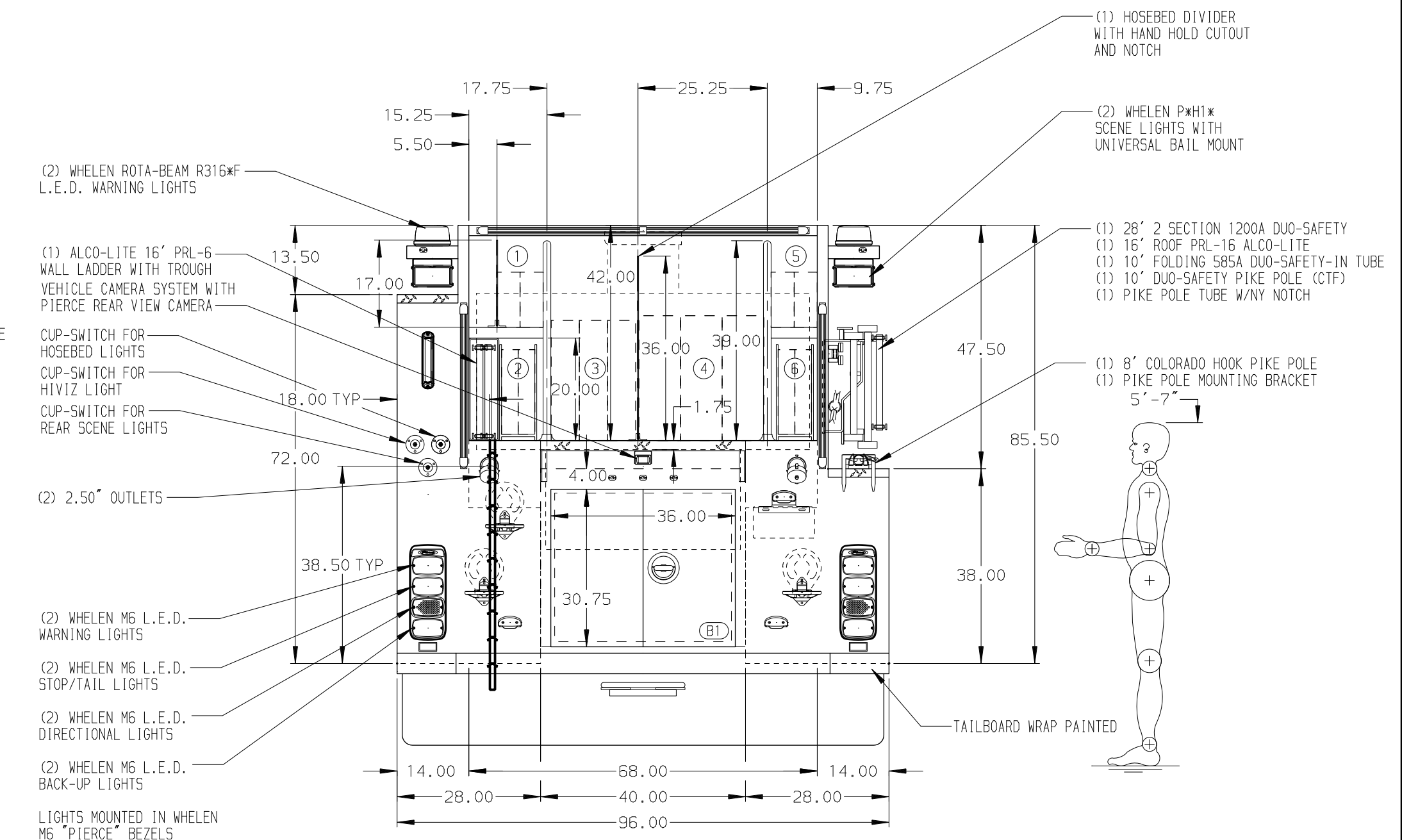

ALUMINUM BODY

NOTE
DIMENSIONS SHOWN ARE APPROXIMATE AND ARE SUBJECT TO MINOR DEVIATIONS AS MAY OCCUR OR BE NECESSARY IN CONSTRUCTION. MINOR DETAILS NOT SHOWN.

- 1. BATTERY CHARGER LOCATED BEHIND DRIVER'S SEAT
- 2. DUAL L.E.D. LIGHT STRIPS LOCATED IN HOSE BED
- 3. DUAL L.E.D. LIGHT STRIPS LOCATED ON THE FRONT OF THE HOSEBED

		JOB NO.	35717-01-02																				
		SCALE	1:24																				
Pierce MANUFACTURING INC.		TITLE	2000-D-750P, 750G WATER TANK, 145" PUMPER BODY DELUGE, BOOSTER REEL																				
		FOR	MONTGOMERY COUNTY ESD #7 NEW CANEY, TEXAS																				
<table border="1"> <tr> <td>13APR21</td> <td>SAM</td> <td>CHR</td> <td>CHASSIS DATA</td> </tr> <tr> <td>06APR21</td> <td>SAM</td> <td>WKL</td> <td>MAKE</td> </tr> <tr> <td>15MAR21</td> <td>SAM</td> <td>WKL</td> <td>PIERCE</td> </tr> <tr> <td>12MAR21</td> <td>SAM</td> <td>CHR</td> <td>MODEL</td> </tr> <tr> <td>REV</td> <td>DATE</td> <td>BY</td> <td>CH</td> </tr> </table>		13APR21	SAM	CHR	CHASSIS DATA	06APR21	SAM	WKL	MAKE	15MAR21	SAM	WKL	PIERCE	12MAR21	SAM	CHR	MODEL	REV	DATE	BY	CH	DWG NO.	35717AD-SH1
		13APR21	SAM	CHR	CHASSIS DATA																		
06APR21	SAM	WKL	MAKE																				
15MAR21	SAM	WKL	PIERCE																				
12MAR21	SAM	CHR	MODEL																				
REV	DATE	BY	CH																				
		SHEET SIZE	D																				
		SHEET NO.	1 OF 2																				