

**PUMPER BODY**  
Medium Aluminum 2nd Gen Pumper

**CHASSIS**  
Arrow XT Chassis

**CHASSIS AXLE, FRONT, CUSTOM**  
22,800 Lb TAK-4 Axle

**AXLE, REAR**  
24,000 Lb Meritor Axle

**ENGINE**  
450 HP Cummins L9 Engine

**TRANSMISSION**  
Allison 5th Gen, 3000 EVS P

**BUMPER**  
22" Extended Painted Steel

**CAB**  
6710 Arrow XT Cab

**BODY WATER TANK**  
500 Gallon New York Style Water Tank

**COMPT, PUMPER, REAR**  
30.75" FF Lap Rear Compt

**COMPT, PUMPER, LEFT SIDE**  
152" Lap Full Height & Depth Front & Rear

**COMPT, PUMPER, RIGHT SIDE**  
152" Lap Low FOLER

**FIRE SUPPRESSION PUMPHOUSE**  
52" Control Zone Side Mount

**PUMP**  
1500 GPM Waterous CSU

**CROSSLAYS, 1.50"**  
(2) 1.50" Standard Capacity

**CROSSLAYS, 2.50"**  
2.50" Crosslay Not Required

**SPEEDLAYS**  
Speedlays Not Required

**GENERATOR**  
Generator Not Required

**Foam System**  
Husky 3 Single Agent Foam System

**Foam Cell**  
25 Gallon Foam Cell, Not Reduced Water

**NOTE**  
DIMENSIONS SHOWN ARE APPROXIMATE AND ARE SUBJECT TO MINOR DEVIATIONS AS MAY OCCUR OR BE NECESSARY IN CONSTRUCTION. MINOR DETAILS NOT SHOWN.

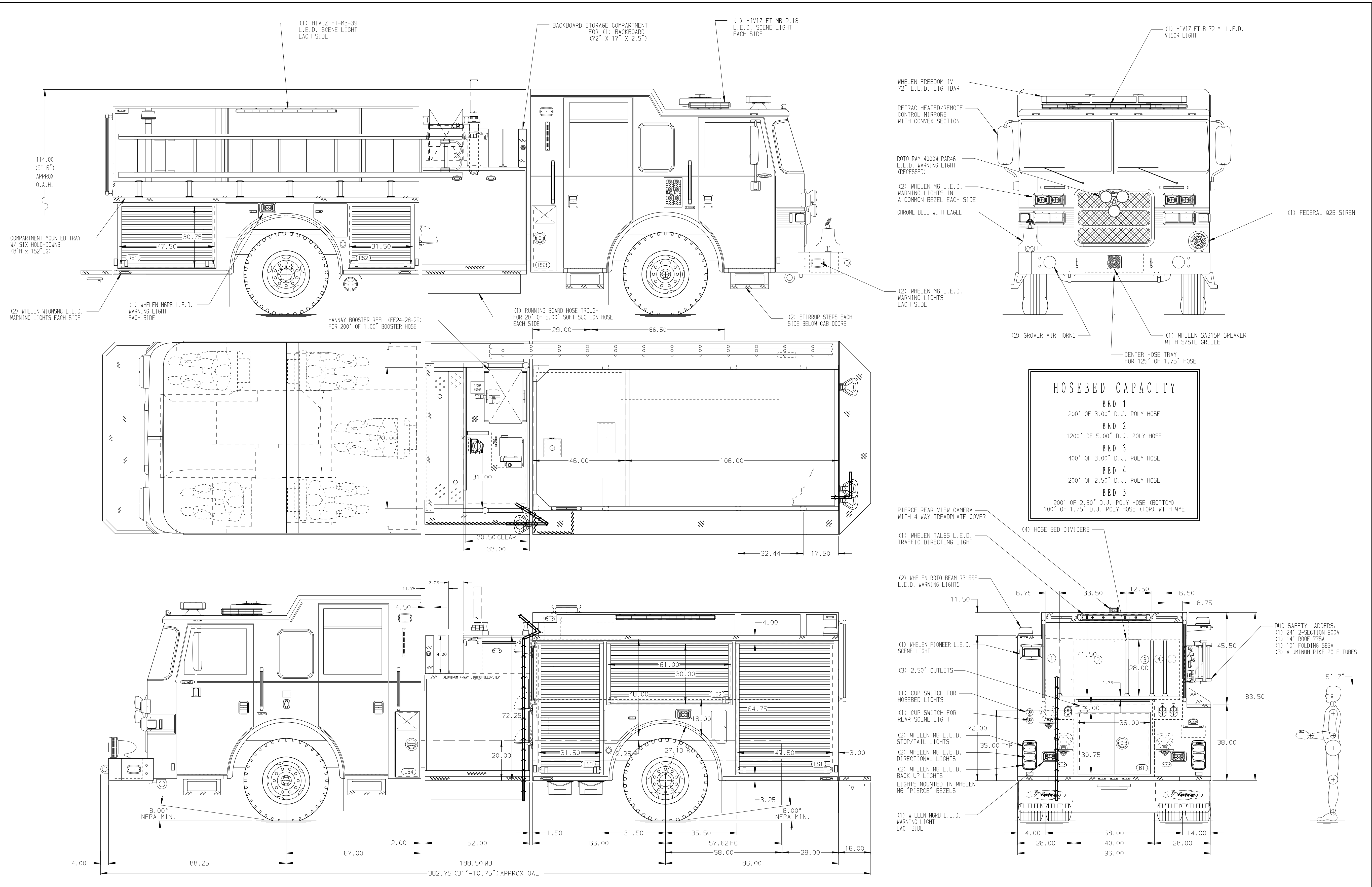

<b>Pierce MANUFACTURING INC.</b>		JOB NO.	35660
		SCALE	1:24
		DATE	
Pierce Pumper Approval Drawing		DRAWN BY	MMF
Gainesville Fire Department		CHECKED BY	COL
DWG NO.		SHEET SIZE	D
35660AD		SHEET NO.	1 OF 1

REV	DATE	BY	CH	ARROW XT	CHASSIS DATA	TITLE	FOR	DWG NO.
09MAR21	MMF	PPE			CHASSIS DATA	Pierce Pumper Approval Drawing	-	
25FEB21	MMF	PPE			MAKE	-	-	
18DEC20	MMF	PPE			PIERCE	Gainesville Fire Department	-	
13NOV20	MMF	SMA			MODEL	-	-	
					ARROW XT			

- ONE 1.50 OUTLET WITH 2.00 PIPING AND SWIVEL LOCATED IN CENTER BUMPER TRAY
- SHORELINE RECEPTACLE WITH KUSSMALL SUPER AUTO-EJECT LOCATED ON DRIVER SIDE OF THE CAB
- AIR INLET/OUTLET FEMALE FITTING "M" WITH RECESSED BOX IN THE DRIVER SIDE STEPWELL
- BATTERY CHARGER LOCATED IN COMPARTMENT PER SHOP ORDER
- BATTERY CHARGE INDICATOR LOCATED DRIVER SIDE ABOVE FRONT WHEEL
- SEVEN ADJUSTABLE SHELVES IN COMPARTMENTS PER SHOP ORDER
- THREE FLOOR MOUNTED SLIDE-OUT TRAY IN COMPARTMENT PER SHOP ORDER
- ONE SWING-OUT TOOLBOARD LOCATED IN COMPARTMENT PER SHOP ORDER
- ONE CTECH FOUR DRAWER ASSEMBLY LOCATED IN COMPARTMENT PER SHOP ORDER