

- HOSEBED CAPACITIES
- ① 1000' OF 5.00" D.J. POLY HOSE
  - ② 400' OF 2.50" D.J. POLY HOSE
  - ③ 400' OF 2.50" D.J. POLY HOSE

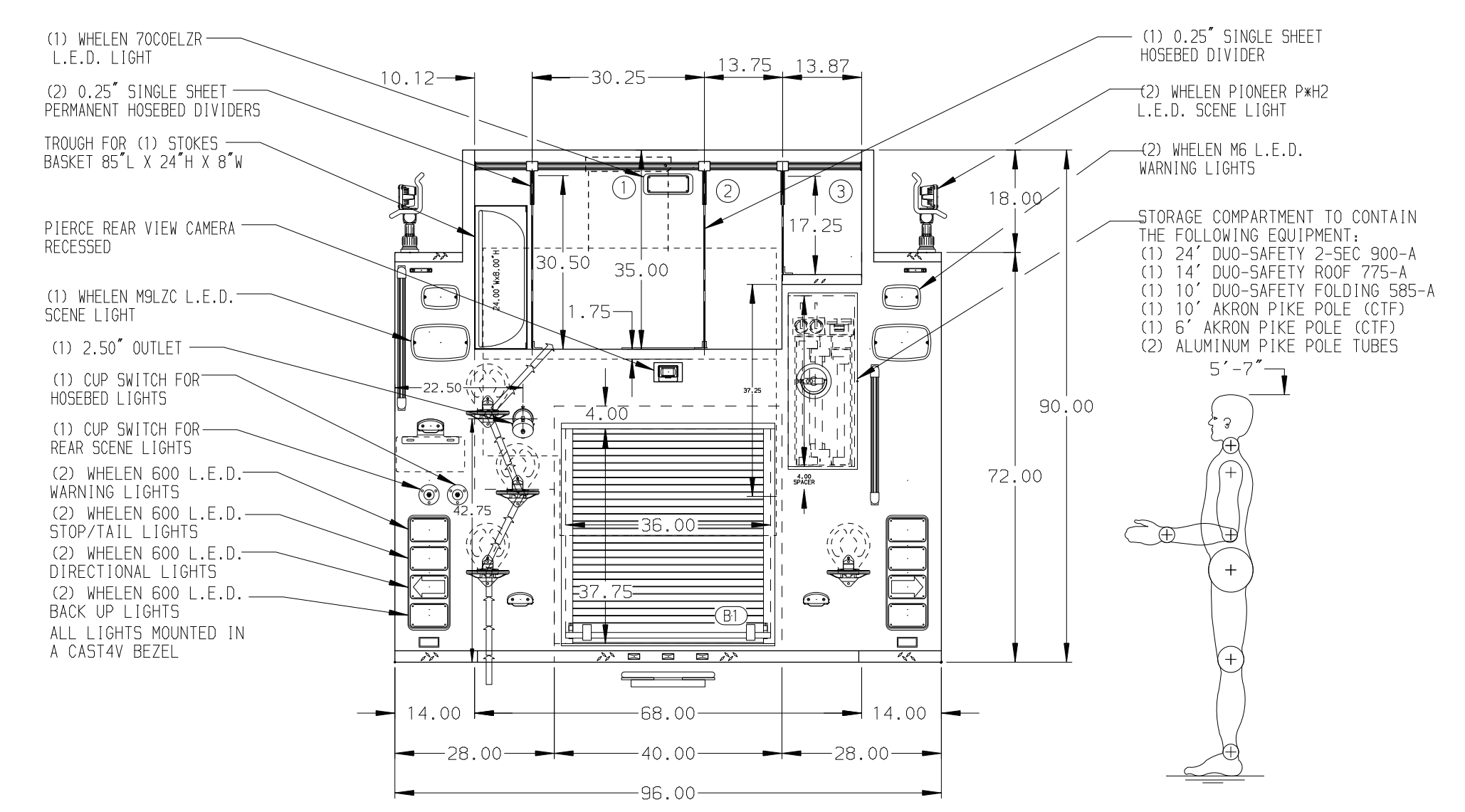
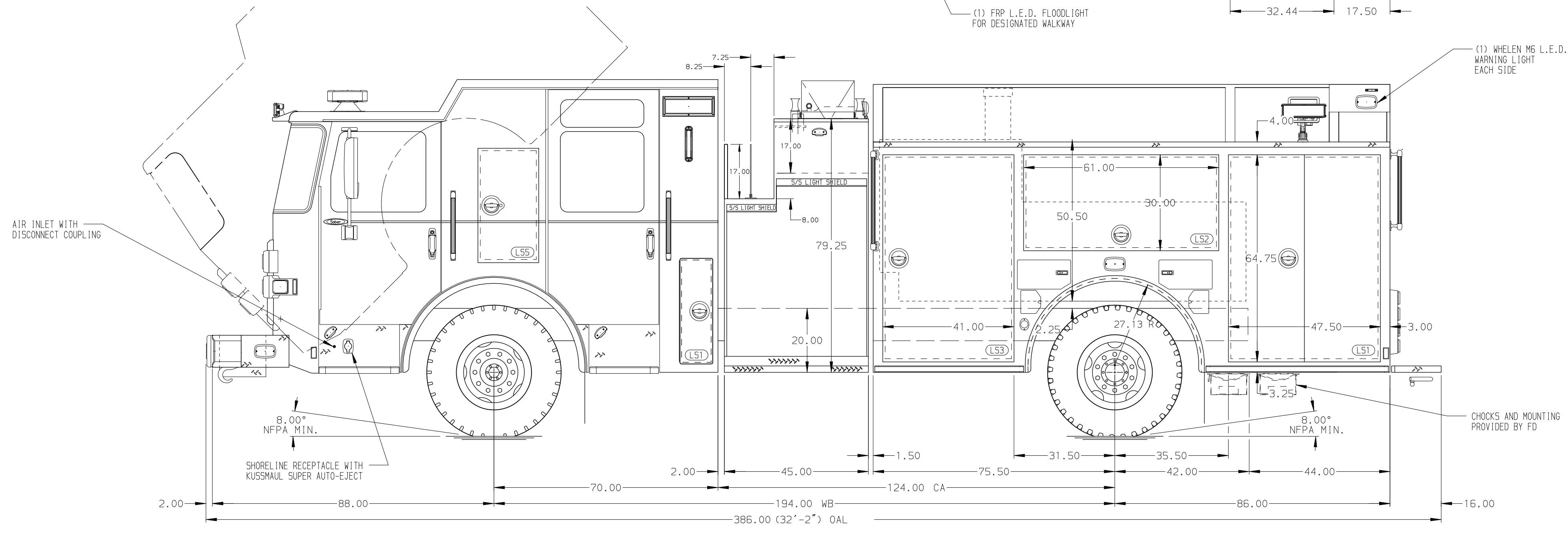

ALUMINUM BODY

NOTE  
DIMENSIONS SHOWN ARE APPROXIMATE AND ARE SUBJECT TO MINOR DEVIATIONS AS MAY OCCUR OR BE NECESSARY IN CONSTRUCTION. MINOR DETAILS NOT SHOWN.

REV	DATE	BY	CH	SABER FR
12DEC20	RHU	NAS		CHASSIS DATA
18NOV20	JLA	NAS		MAKE
26AUG20	LME	KOU		PIERCE
				MODEL

	JOB NO.	35584
	SCALE	DATE
TITLE	1500-D-750P 161" BODY, FH FRONT & REAR, FDLR (2) CROSSLAYS, BOOSTER REEL, LADDER BTWN TANK & SS	DRAWN BY
FOR	MARKHAM FIRE DEPARTMENT MARKHAM, ILLINOIS	LME
DWG NO.	35584AD	CHECKED BY
		KOU
		SHEET SIZE
		D
		SHEET NO.
		1 OF 1