

PASSENGER'S SIDE COMPARTMENTS CONTAIN THE FOLLOWING:

COMPARTMENT P1 CONTAINS:

- (1) ELECTRIC CABLE REEL W/ 150' OF 10/3 YELLOW CABLE
- (4) 6000 UN STORAGE CYLINDERS
- (1) SPACE SAVER AIR CONTROL PANEL
- (1) 2-BOTTLE FILL ENCLOSURE
- (1) BREATHING AIR REEL W/200' OF HOSE
- (1) COMPRESSOR CONTROL PANELS
- BREATHING AIR H2O AND CO MONITOR

COMPARTMENT P2 CONTAINS:

- (1) 22" DP ADJ SLIDE OUT/TILT DOWN TRAY

COMPARTMENT P3 CONTAINS:

- (1) LOW PRESSURE AIR REEL W/ 150' OF BLUE HOSE
- (1) 8-SLOT AIR BAG RACK

COMPARTMENT P4 CONTAINS:

- (2) ADJUSTABLE SHELVES
- (1) 15/20A, 120V DUPLEX RECEPTACLE

COMPARTMENT P5 CONTAINS:

- (2) ADJUSTABLE SHELVES
- (1) TNT QUAD HYDRAULIC POKER UNIT

COMPARTMENT P6 CONTAINS:

- (1) ADJUSTABLE SHELF
- (1) DUAL HYDRAULIC HOSE REEL
- (1) VERTICAL ROLLER ON FORWARD PARTITION
- (1) SPECIAL DEPTH ADJ SHELF
- (1) KUSSMAL 1200 CHARGER

COMPARTMENT P7 CONTAINS:

-

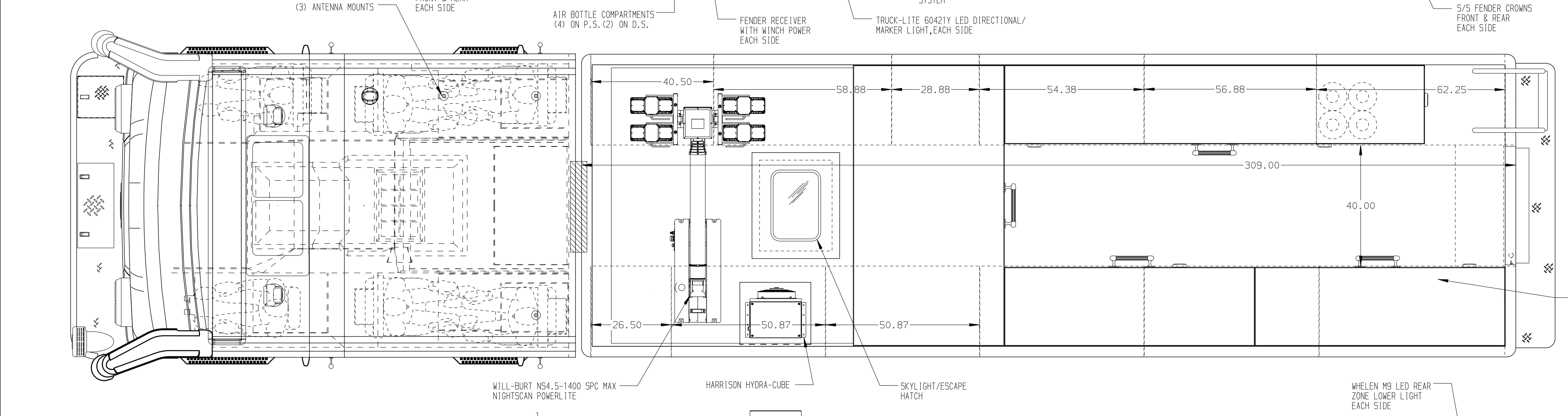
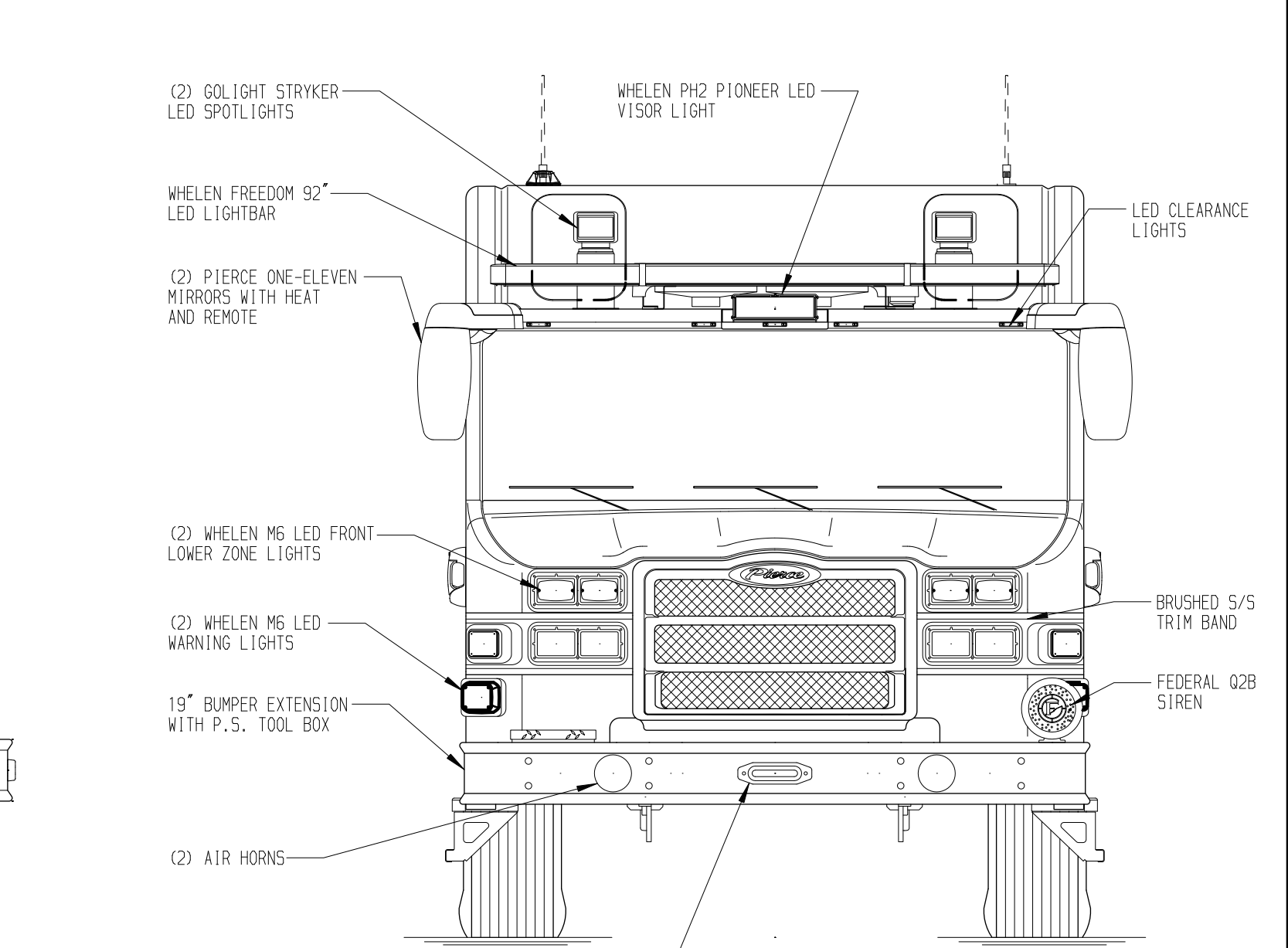
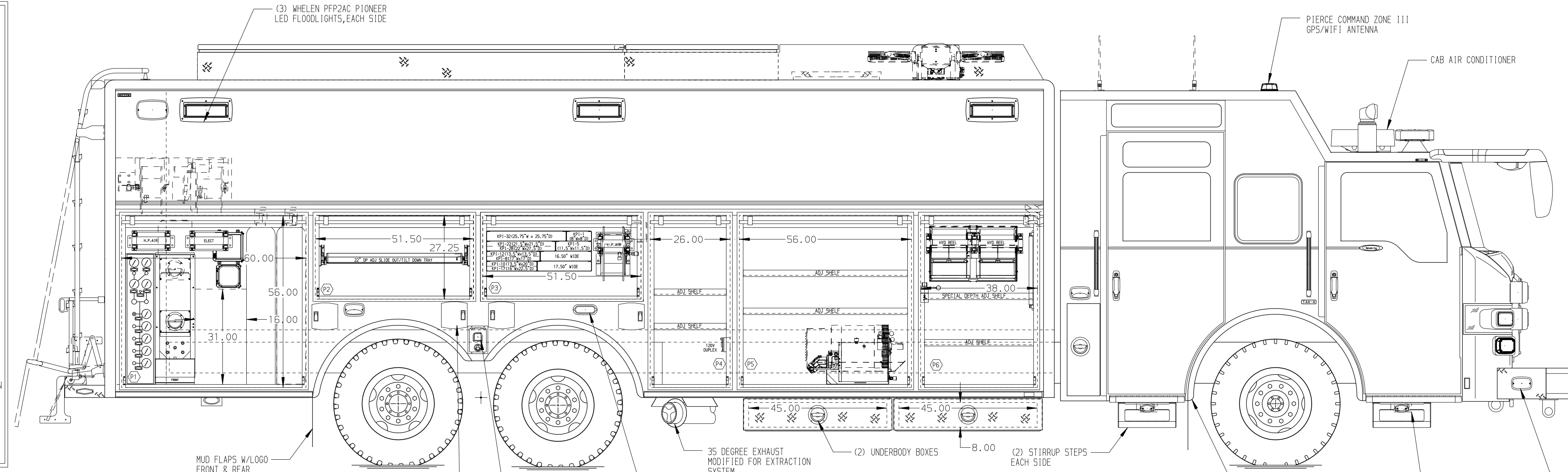

DRIVER'S SIDE COMPARTMENTS CONTAIN THE FOLLOWING:

COMPARTMENT D1 CONTAINS:

- (1) ADJUSTABLE SHELF
- (1) ELECTRIC CABLE REEL W/ 150' OF 10/3 YELLOW CABLE
- (1) NUVAIR 10HP BREATHING AIR COMPRESSOR
- (1) LOW PRESSURE AIR REEL W/150' OF HOSE
- (1) STANDARD DEPTH SLIDEOUT TRAY WITH SLIDEMASTER TRAY
- (1) VERTICAL COMPARTMENT DIVIDER

COMPARTMENT D2 CONTAINS:

- (1) 22" DP ADJ SLIDE OUT/TILT DOWN TRAY

COMPARTMENT D3 CONTAINS:

- (1) 22" DP ADJ SLIDE OUT/TILT DOWN TRAY

COMPARTMENT D4 CONTAINS:

- (1) ADJUSTABLE SHELF
- (1) SPECIAL DEPTH ADJ SHELF
- (1) 15/20A, 120V DUPLEX RECEPTACLE
- (1) STD DEPTH ADJ SLIDE OUT TRAY

COMPARTMENT D5 CONTAINS:

- (2) ADJUSTABLE SHELVES
- (1) DUAL HYDRAULIC HOSE REEL
- (1) VERTICAL ROLLER ON REARWARD PARTITION
- (1) VOGEL LUBE SYSTEM

COMPARTMENT D6 CONTAINS:

- (1) AIR OUTLET WITH SHUT-OFF VALVE
- (1) CIRCUIT BREAKER PANEL
- (1) GENERATOR CONTROL PANEL
- (1) NIGHT SCAN CONTROLLER
- (1) VERTICAL COMPARTMENT DIVIDER
- (1) STD DEPTH SHELF

COMPARTMENT D7 CONTAINS:

-

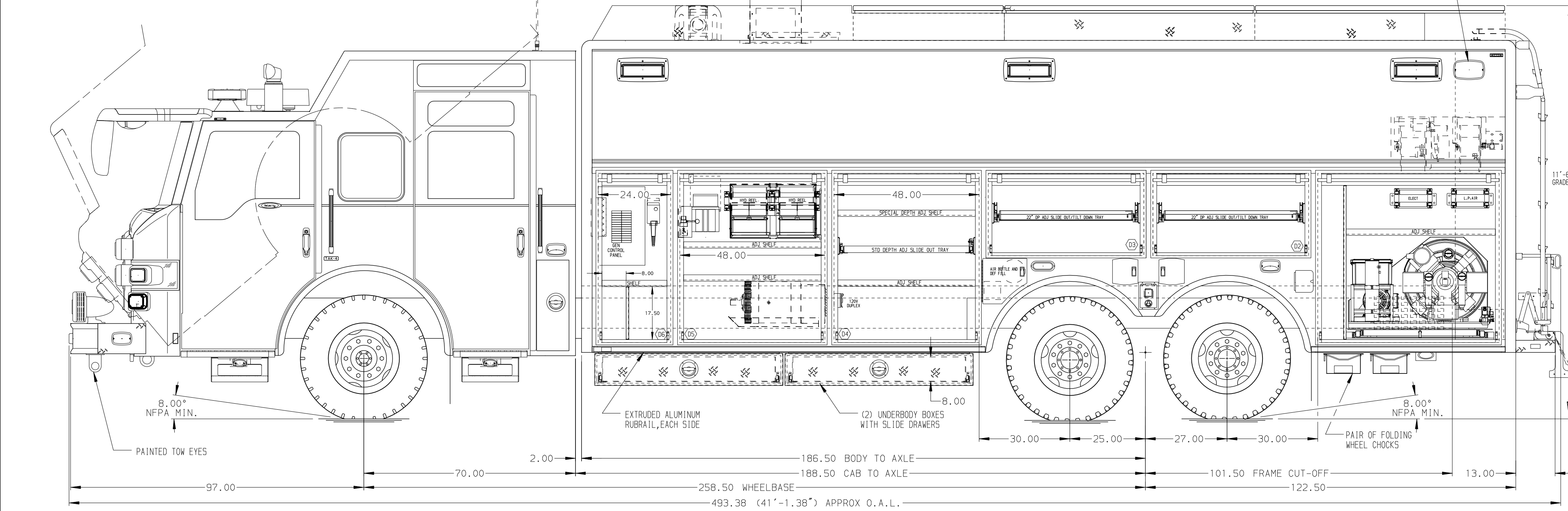
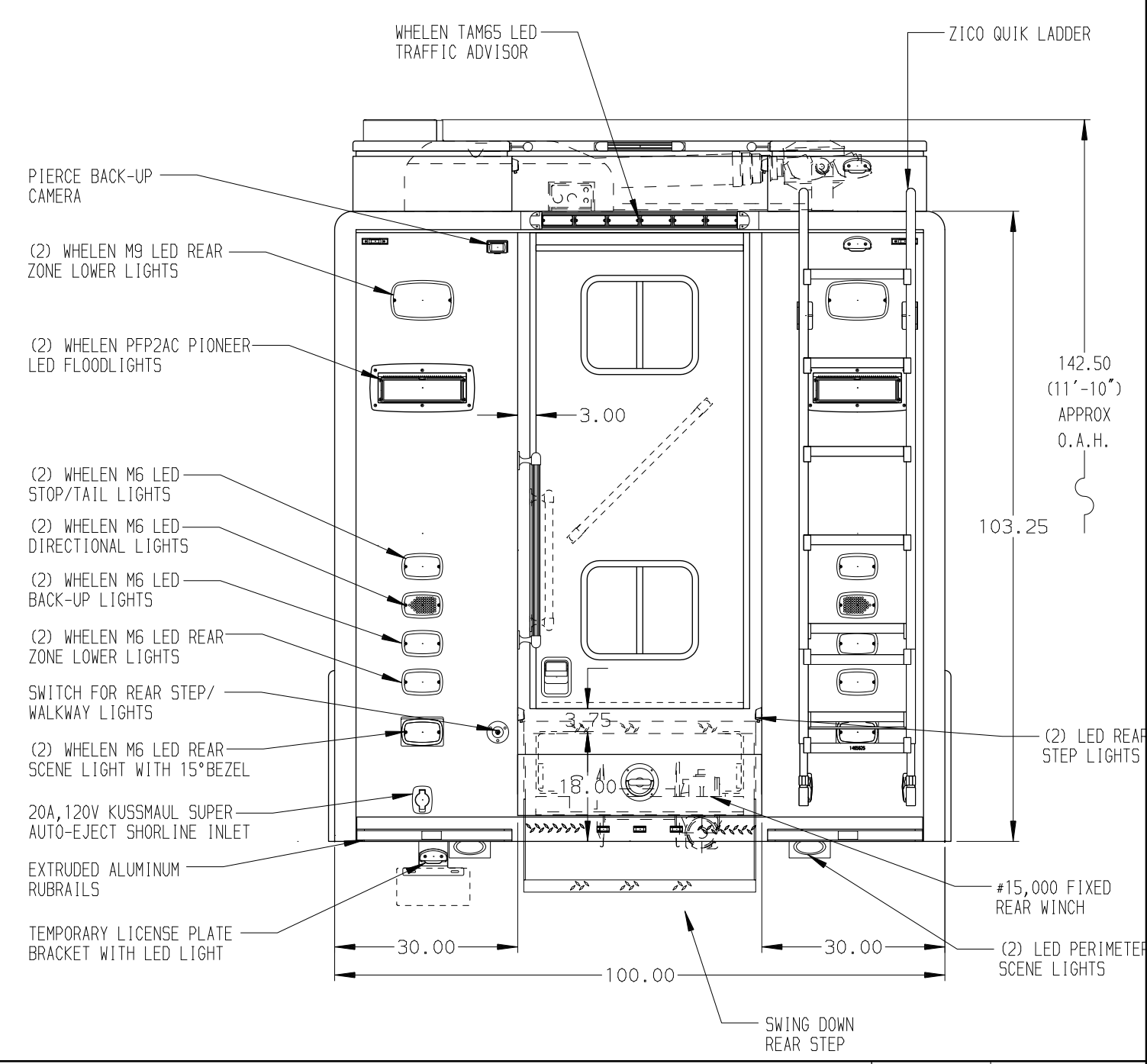

NOTE:
DIMENSIONS SHOWN ARE APPROXIMATE AND ARE SUBJECT TO MINOR DEVIATIONS AS MAY OCCUR OR BE NECESSARY IN CONSTRUCTION. MINOR DETAILS NOT SHOWN.

- NOTES:**
- ONAN 40KW PTO DRIVEN GENERATOR WITH SPLASH GUARD LOCATED BETWEEN FRAME RAILS
 - AIR INLET WITH DISCONNECT COUPLING LOCATED IN DRIVER'S LOWER CAB STEP WELL
 - FLOOR IN CAB AND CREW CAB TO BE PADDED RUBBER
 - BATTERY CHARGE INDICATOR LOCATED ON DRIVER'S SEAT WITH BRACKET
 - ON SCENE LED LIGHT STRIPS IN ALL BODY AND HATCH COMPARTMENTS
 - POLISHED 5/5 SCUFFPLATES ON CAB AND CREW CAB DOORS
 - HANDHELD SPOTLIGHT LOCATED WITHIN REACH OF THE OFFICER'S SEAT

MAXIMUM O.A.H. 11'-10"
SIDE ROLL & FRONTAL IMPACT PROTECTION

CLEAR DOOR WIDTH KEY		CHASSIS DATA		MAKE	
AMDR ROLL UP DOORS:	-2 1/4"	15FEB21	DHE	CDK	PIERCE
CORTITE ROLL UP DOORS:	-2 1/2"	16DEC20	DHE	CDK	PIERCE
PIERCE DOUBLE LAP DOORS:	-4 1/4"	23OCT20	DHE	CDK	MODEL
PIERCE LIFT-UP LAP DOORS:	-1 1/2"				VXFR7020
(EX: 60" F-F - 2 1/4" = 57 3/4" CLEAR)		REV	DATE	BY	CH

		JOB NO.	35302
		SCALE	DATE
TITLE	HEAVY DUTY RESCUE WALKIN	DRAWN BY	DHE
FOR	DENVER COUNTY FIRE DEPARTMENT DENVER, CO	CHECKED BY	CDK
DWG NO.	35302AD-SH1	DRAWN BY	DHE
		CHECKED BY	CDK
		DWG NO.	35302AD-SH1
		SHEET NO.	1 OF 2