

Pumper, PUC

BODY

Pumper, PUC, Aluminum

CHASSIS

Velocity Chassis, PUC (Big Block)

CHASSIS AXLE, FRONT, CUSTOM

22,800 Lb TAK-4 Axle

AXLE, REAR

27,000 Lb Meritor Axle

ENGINE

505 HP DD13 Engine

TRANSMISSION

Allison 5th Gen, 4000 EVS P

BUMPER

22" Extended Stainless Steel

CAB

7010 Velocity FR Cab, PUC

BODY

WATER TANK

500 Gallon Poly Water Tank

COMPT, PUMPER, REAR

33.50" FF RollUp Rear Compt w/Tailboard, PUC

COMPT, PUMPER, LEFT SIDE

189" RollUp Full Height & Depth Front & Rear, PUC

COMPT, PUMPER, RIGHT SIDE

189" RollUp Full Height & Depth Front & Rear, PUC

FIRE SUPPRESSION PUMPHOUSE

Control Zone, PUC

PUMP

1500 GPM Pierce PUC

CROSSLAYS, 1.50"

(2) 1.50", Poly Trays, 200"

CROSSLAYS, 2.50"

(1) Deadlay, Poly Tray, 200"

GENERATOR

Generator Not Required

Foam System

Husky 12 Single Agent Foam System

Foam Cell

30 Gallon Foam Cell, Not Reduced Water, PUC

Side Roll and Frontal Impact Protection

NOTE

DIMENSIONS SHOWN ARE APPROXIMATE AND ARE SUBJECT TO MINOR DEVIATIONS AS MAY OCCUR OR BE NECESSARY IN CONSTRUCTION. MINOR DETAILS NOT SHOWN.

- ONE 1.50 OUTLET WITH 2.00 PIPING AND SWIVEL LOCATED IN CENTER BUMPER TRAY
- BATTERY CHARGER LOCATED IN COMPARTMENT PER SHOP ORDER
- BATTERY CHARGE INDICATOR LOCATED NEAR DRIVER SEAT RISER WITH BRACKET
- TWO ADJUSTABLE SHELVES IN COMPARTMENTS PER SHOP ORDER
- TWO FLOOR MOUNTED SLIDE-OUT TRAY IN COMPARTMENT PER SHOP ORDER
- TWO 250LB TILT/SLIDE-OUT TRAY IN COMPARTMENTS PER SHOP ORDER
- ONE 215LB TILT/SLIDE-OUT TRAY IN COMPARTMENTS PER SHOP ORDER
- ONE SWING OUT TOOLBOARD IN COMPARTMENT PER SHOP ORDER

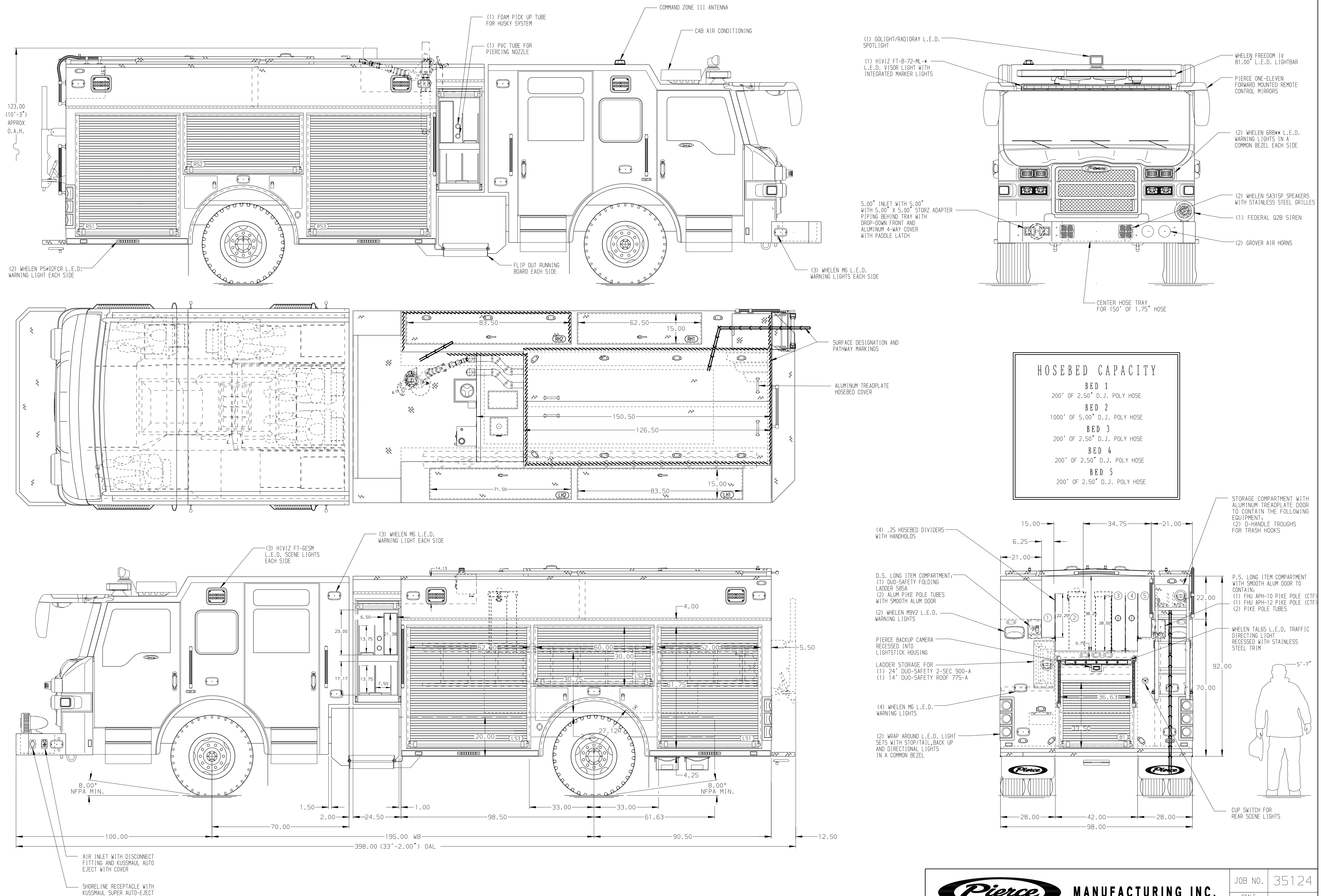

Pierce MANUFACTURING INC.		JOB NO.	35124
		SCALE	1:24
		DATE	
TITLE	Pierce PUC Pumper Approval Drawing	DRAWN BY	MMF
FOR	Queen Creek Fire Department	CHECKED BY	NPE
DWG NO.	35124AD	SHEET SIZE	D
VELOCITY		SHEET NO.	1 OF 1

REV	DATE	BY	CH	VELOCITY
04DEC20	MMF	GKH	MAKE	
06AUG20	MMF	GKH	PIERCE	
25JUN20	MMF	GKH	MODEL	