

# PUMPER BODY

Long Aluminum 2nd Gen Pumper

## CHASSIS

Enforcer Chassis

## CHASSIS AXLE, FRONT, CUSTOM

20,000 Lb Dana Axle

## AXLE, REAR

24,000 Lb Dana Axle

## ENGINE

400 HP Cummins L9 Engine

## TRANSMISSION

Allison 5th Gen, 3000 EVS P

## BUMPER

26" Extended Under Slung

## CAB

8410 Enforcer Cab

## BODY WATER TANK

750 Gallon New York Style Water Tank

## COMPT, PUMPER, REAR

26.75" FF RollUp Rear Compt

## COMPT, PUMPER, LEFT SIDE

171" RollUp Full Height Front & Rear FDLR

## COMPT, PUMPER, RIGHT SIDE

171" RollUp Full Height Front & Rear FDLR

## FIRE SUPPRESSION PUMPHOUSE

45" Control Zone Side Mount

## PUMP

1500 GPM Hale QMAX

## CROSSLAYS, 1.50"

(2) 1.50" Standard Capacity

## CROSSLAYS, 2.50"

2.50" Crosslay Not Required

## SPEEDLAYS

Speedlays Not Required

## GENERATOR

Generator Not Required

## Foam System

Foam System Not Required

## Foam Cell

Foam Cell Not Required

Side Roll and Frontal Impact Protection

**NOTE**  
DIMENSIONS SHOWN ARE APPROXIMATE AND ARE SUBJECT TO MINOR DEVIATIONS AS MAY OCCUR OR BE NECESSARY IN CONSTRUCTION. MINOR DETAILS NOT SHOWN.

- ONE 1.50" OUTLET WITH 2.00" PIPING AND SWIVEL LOCATED IN BUMPER TRAY
- SHORELINE RECEPTACLE WITH KUSSMAUL SUPER AUTO-EJECT LOCATED ON DRIVER SIDE OF THE CAB
- AIR INLET WITH DISCONNECT COUPLING IN THE DRIVER SIDE STEPWELL
- BATTERY CHARGER LOCATED IN COMPARTMENT PER SHOP ORDER
- BATTERY CHARGE INDICATOR LOCATED ON THE DRIVER SIDE SEAT RISER
- SIX ADJUSTABLE SHELVES IN COMPARTMENTS PER SHOP ORDER
- TWO FLOOR MOUNTED SLIDE-OUT TRAYS IN COMPARTMENTS PER SHOP ORDER
- TWO SLIDE-OUT TRAYS LOCATED IN COMPARTMENTS PER SHOP ORDER
- PLYWOOD ON BACK WALL OF COMPARTMENTS PER SHOP ORDER

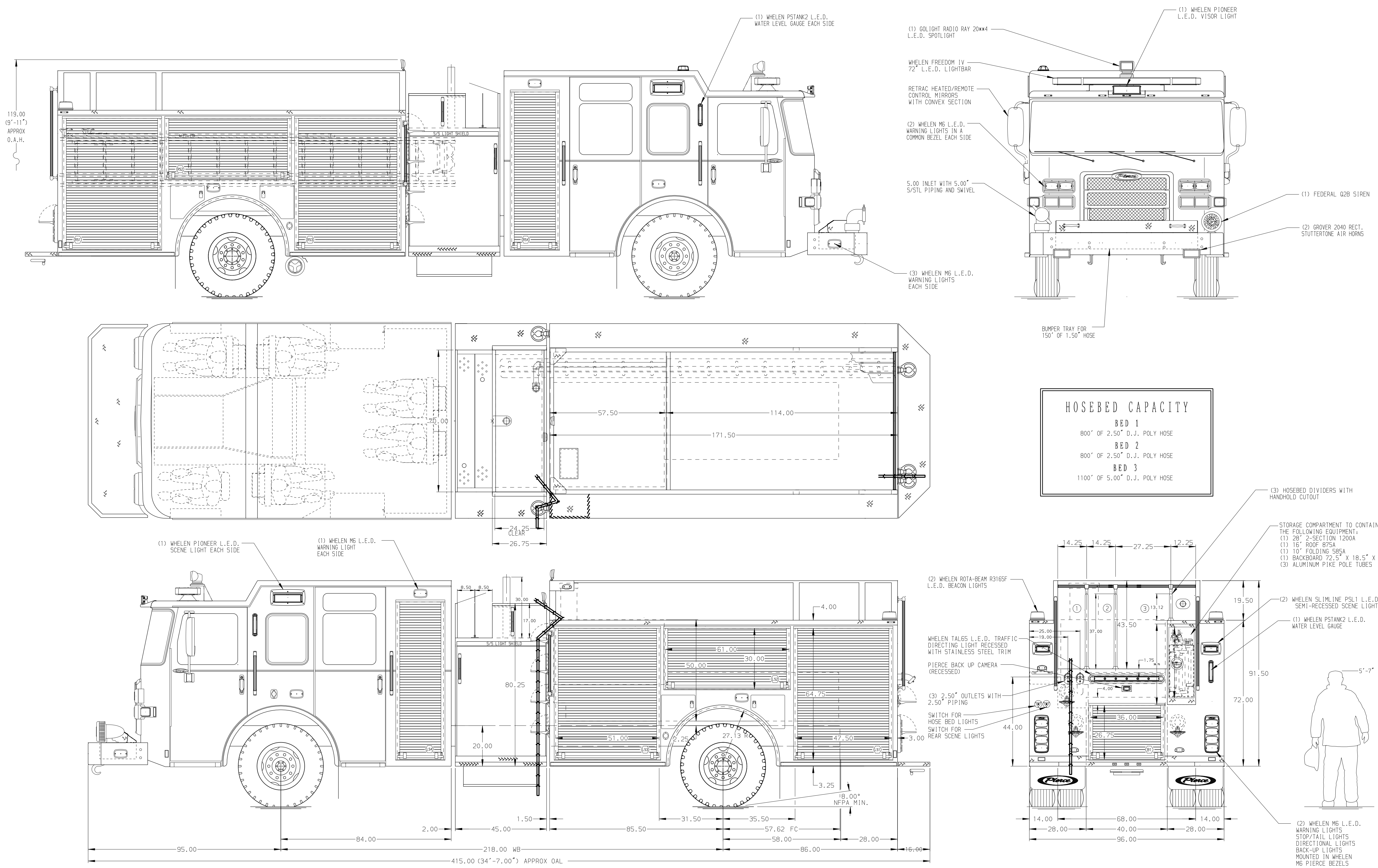

REV	DATE	BY	CH	ENFORCER
1	21JUL20	MMF	LPA	PIERCE
2	18JUN20	MMF	LPA	MODEL

<b>Pierce MANUFACTURING INC.</b>		JOB NO.	35073
TITLE	Pierce Pumper Approval Drawing	SCALE	1:24 DATE
FOR	Liste Woodridge Fire District	DRAWN BY	MMF 30MAR20
DWG NO.	35073AD	CHECKED BY	NPE 31MAR20
		SHEET SIZE	SHEET NO. 1 OF 1