

- HOSEBED CAPACITIES
- ① 300' OF 1.75" D.J. POLY HOSE
 - ② 300' OF 2.50" D.J. POLY HOSE
 - ③ 1000' OF 5.00" D.J. POLY HOSE
 - ④ 300' OF 2.50" D.J. POLY HOSE

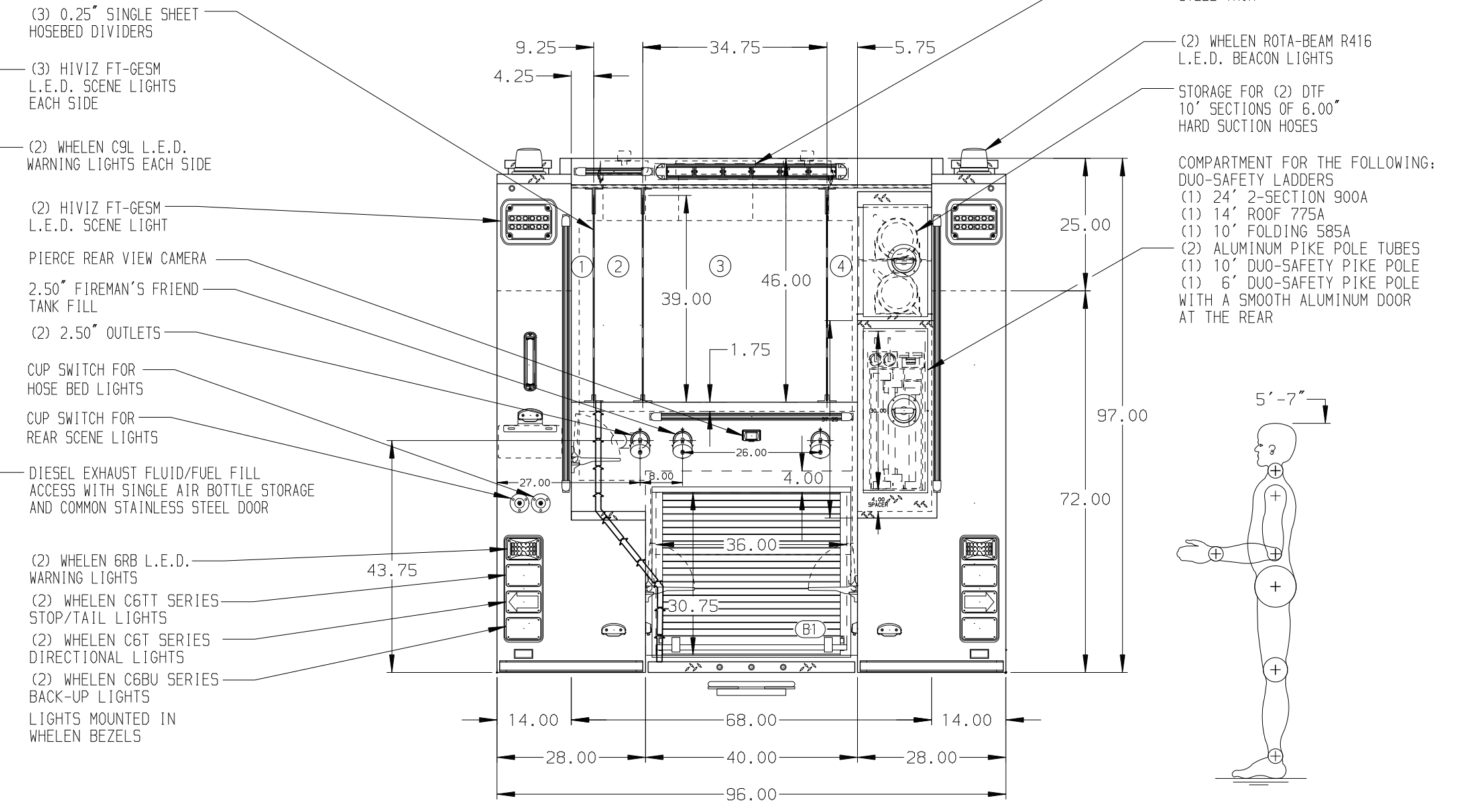
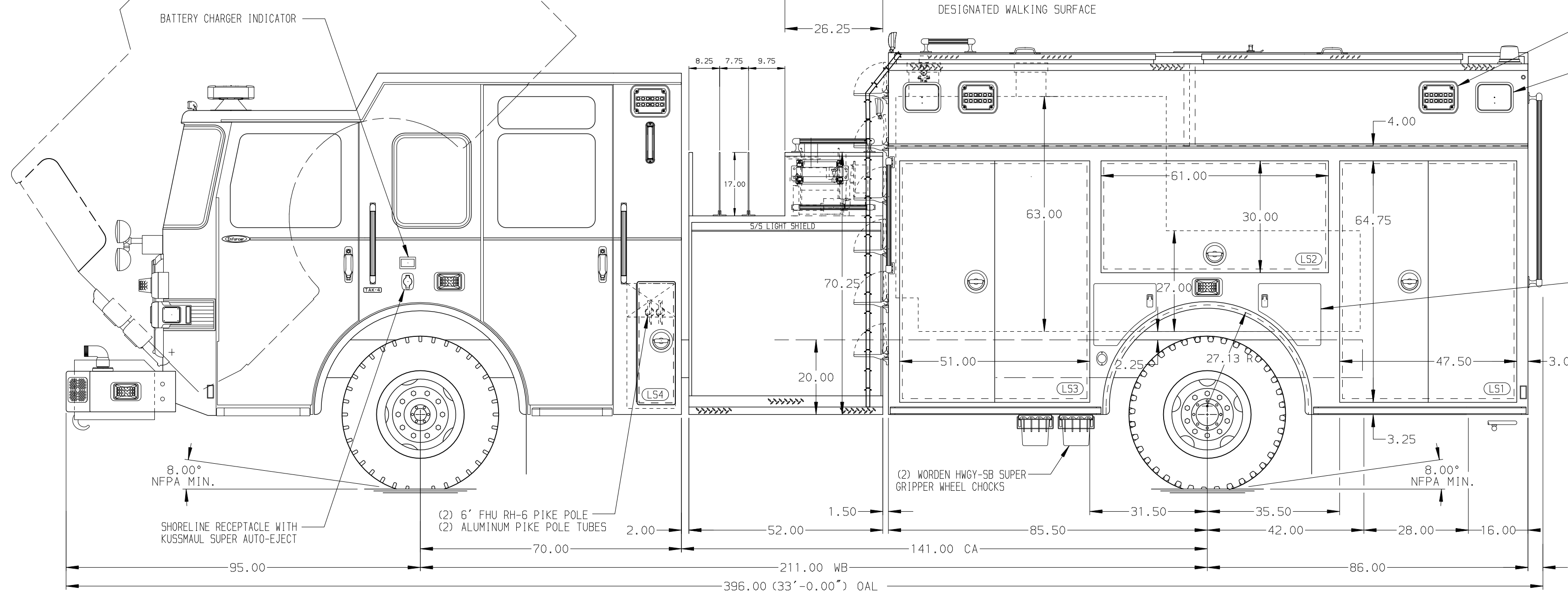

ALUMINUM BODY

SIDE ROLL AND FRONTAL IMPACT PROTECTION

NOTE
DIMENSIONS SHOWN ARE APPROXIMATE AND ARE SUBJECT TO MINOR DEVIATIONS AS MAY OCCUR OR BE NECESSARY IN CONSTRUCTION.
MINOR DETAILS NOT SHOWN.

- 1. ONSPOT AUTOMATIC TIRE CHAINS TO BE PROVIDED AT REAR
- 2. DUAL L.E.D. LIGHT STRIPS LOCATED IN HOSE BED
- 3. DRIP PAN GUARD FOR ROLL-UP DOOR LOCATED IN COMPARTMENT B1
- 4. ONE FULL WIDTH/DEPTH ADJUSTABLE SHELF IN COMPARTMENTS LS1,RS1,RS2,RS3
- 5. ONE FLOOR MOUNTED SLIDE-OUT TRAY IN COMPARTMENT RS1,LS1,B1
- 6. SWING-OUT TOOL BOARD WITH PEGBOARD PATTERN IN COMPARTMENTS LS2
- 7. ONE SLIDE-OUT TOOL BOARD WITH PEGBOARD PATTERN IN COMPARTMENTS LS3
- 8. ALUMINUM PEGBOARD LOCATED ON THE BACK WALL OF COMPARTMENTS LS3,RS3
- 9. CIRCUIT BREAKER PANEL IN COMPARTMENT LS3
- 8. AIR INLET WITH DISCONNECT COUPLING IN DRIVER'S SIDE STEP WELL

REV	DATE	BY	CH	ENFORCER
03JUN20	SHD	-	-	CHASSIS DATA
22MAY20	JWO	JGO		MAKE
29APR20	JWO	CDK		PIERCE
27FEB20	JWO	KOU		MODEL

		JOB NO.	34747
		SCALE	DATE
TITLE	2000-D-1000P W/306-306 FOAM,171,FULL HEIGHT,FOLDR (3) X-LAY,DELUGE,GENERATOR,CABLE REEL	DRAWN BY	JWO
FOR	BOGER CITY FIRE DEPARTMENT LINCOLNLTON, NORTH CAROLINA	CHECKED BY	NPE
DWG NO.	34747AD	SHEET SIZE	SHEET NO.
		D	1 OF 1