

HOSEBED CAPACITIES

- ① 150' OF 1.75" D.J. POLY HOSE
- ② 150' OF 1.75" D.J. POLY HOSE
- ③ 200' OF 2.50" D.J. POLY HOSE
- ④ 1000' OF 5.00" D.J. RUBBER HOSE
- ⑤ 600' OF 2.50" D.J. POLY HOSE

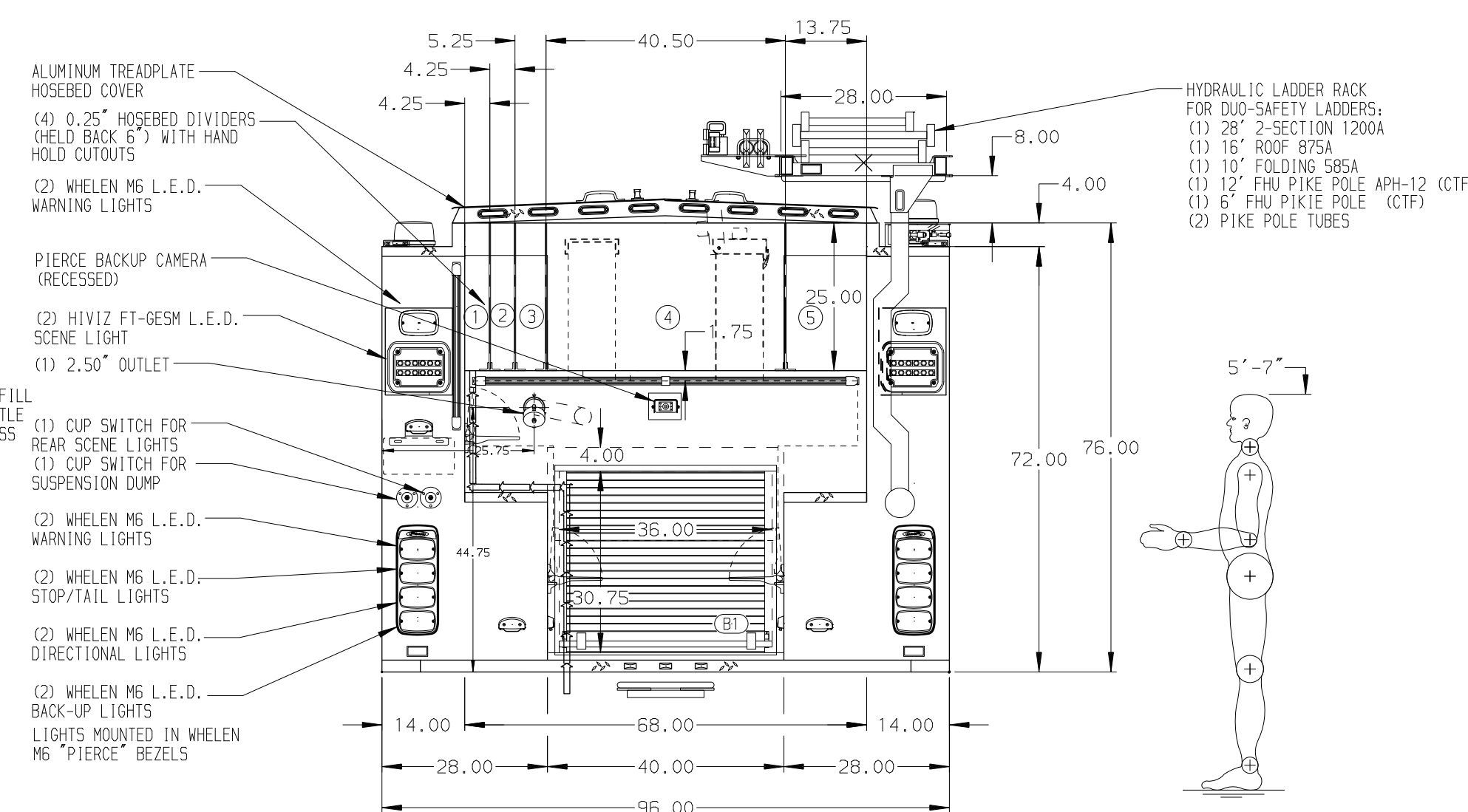

ALUMINUM BODY    MAXIMUM O.A.L. 386.00"    MAXIMUM O.A.H. 118.00"    SIDE ROLL AND FRONTAL IMPACT PROTECTION

**NOTE**  
DIMENSIONS SHOWN ARE APPROXIMATE AND ARE SUBJECT TO MINOR DEVIATIONS AS MAY OCCUR OR BE NECESSARY IN CONSTRUCTION. MINOR DETAILS NOT SHOWN.

1. ONSPOT AUTOMATIC TIRE CHAINS TO BE PROVIDED AT REAR
2. BATTERY CHARGER LOCATED IN COMPARTMENT LS3
3. BATTERY CHARGE INDICATOR LOCATED ON DS PUMP PANEL
4. DUAL L.E.D. LIGHT STRIPS LOCATED IN HOSE BED
5. DRIP PAN GUARD FOR ROLL-UP DOOR LOCATED LS1, LS2, LS3, RS1, RS2, RS3, B1
6. ONE FULL WIDTH/DEPTH ADJUSTABLE SHELVES IN COMPARTMENTS LS2, B1, TWO IN LS3, LS4, RS3, RS4, THREE IN RS1, FIVE IN LS1
7. ONE ADJUSTABLE SLIDE-OUT TRAY IN COMPARTMENT RS3
8. ONE FLOOR MOUNTED SLIDE-OUT TRAY IN COMPARTMENTS LS1, LS3, RS1, B1
9. ONE SWING-OUT TOOLBOARD WITH PAC TRAC IN COMPARTMENT RS2
10. EQUIPMENT MOUNTING TRACKS LOCATED IN COMPARTMENTS RS3, LS5, RS5

11. PARTITION BETWEEN COMPARTMENTS LS1/B1 AND RS1/B1
12. ONE ZIAMATIC SCBA HOLDER BRACKET LOCATED IN COMPARTMENTS LS5, RS5, TWO IN RS3
13. COMPARTMENT VENTILATION SYSTEM WITH TIMER
14. 5/8\"/>

REV	DATE	BY	CH	ENFORCER
01APR20	SAM	LPA		MAKE
28FEB20	LME	LPA		PIERCE
13DEC19	LME	WKL		MODEL

		JOB NO.	34562
		SCALE	1:24
TITLE	1500-D-520P, 500G WATER W/20G FOAM, 152\"/>		
FOR	EAST PIERCE FIRE & RESCUE BONNEY LAKE, WASHINGTON	DRAWN BY	LME
DWG NO.	34562AD	CHECKED BY	WKL
		SHEET SIZE	D
		SHEET NO.	1 OF 1