

- HOSEBED CAPACITIES
- ① 500' OF 2.50" D.J. POLY HOSE
 - ② 200' OF 1.75" D.J. POLY HOSE
 - ③ 200' OF 1.75" D.J. POLY HOSE
 - ④ 1200' OF 5.00" LDH HOSE
 - ⑤ 200' OF 2.50" D.J. POLY HOSE
 - ⑥ OPEN

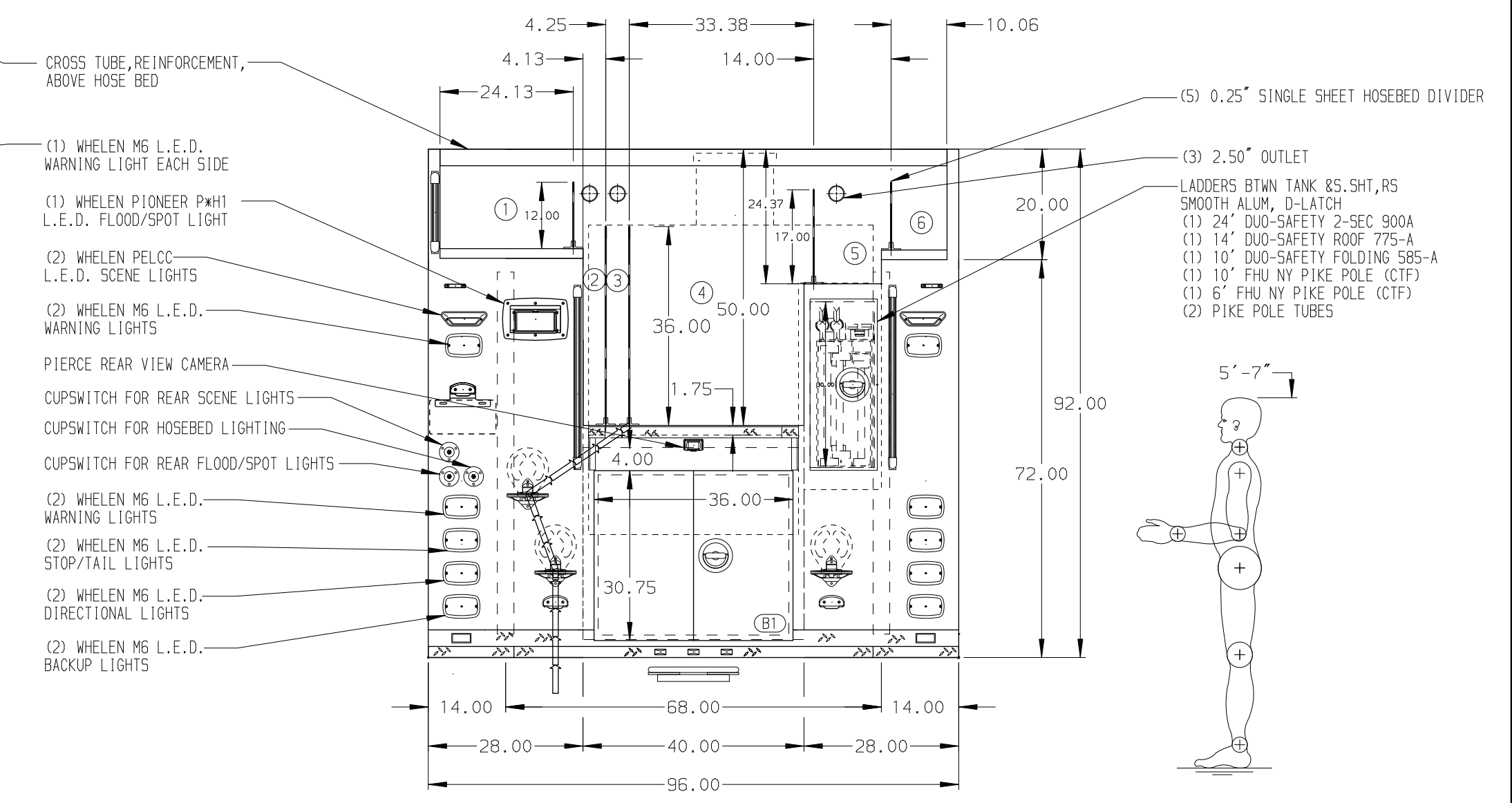
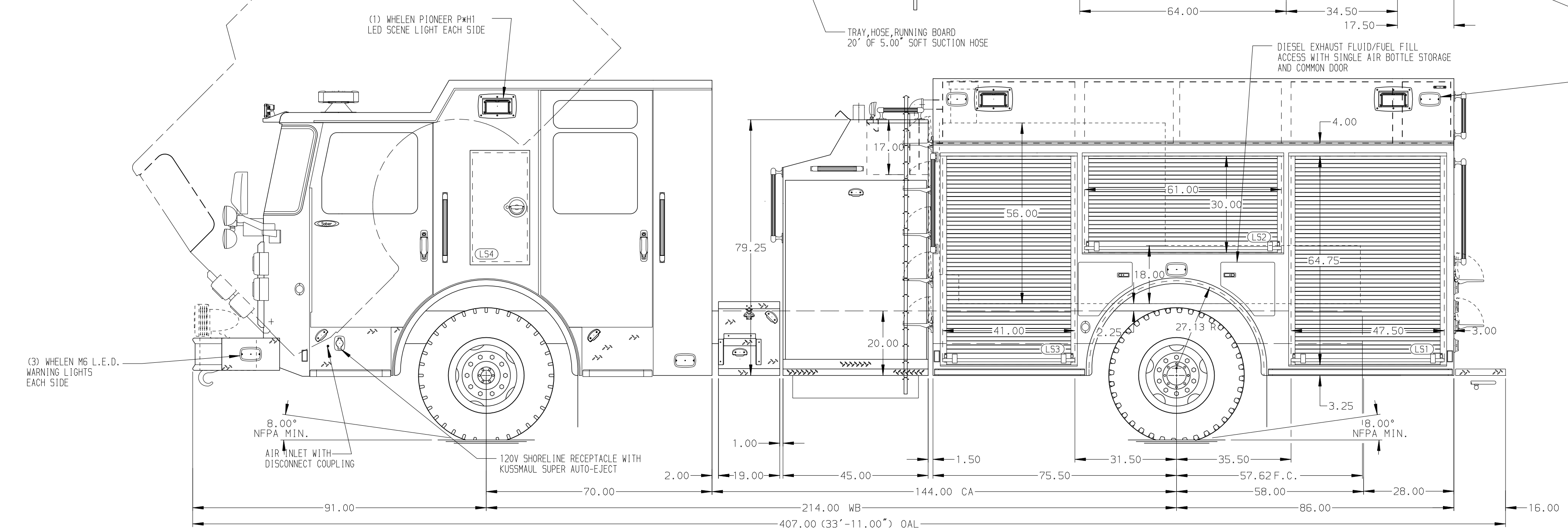

ALUMINUM BODY

MAXIMUM O.A.H. 9'10" or 118"

NOTE
DIMENSIONS SHOWN ARE APPROXIMATE AND ARE SUBJECT TO MINOR DEVIATIONS AS MAY OCCUR OR BE NECESSARY IN CONSTRUCTION. MINOR DETAILS NOT SHOWN.

REV	DATE	BY	CH	SABER FR
21	JAN20	CRH	GSC	MAKE
10	DEC19	RHU	GSC	PIERCE
01	NOV19	AMI	NPE	MODEL

		JOB NO.	34492
		SCALE	DATE
TITLE	2000-D-750 GAL POLY, 161" BODY LADDERS BETWEEN TANK AND SIDE SHEET, DELUGE	DRAWN BY	AMI
FOR	LEESBURG FIRE DEPARTMENT LEESBURG, FLORIDA	CHECKED BY	NPE
DWG NO.	34492AD	SHEET SIZE	SHEET NO.
		D	1 OF 1