

- HOSEBED CAPACITIES
- ① 350' OF 1.75" HOSE
 - ② 400' OF 2.50" HOSE
 - ③ 800' OF 5.00" HOSE
 - ④ 500' OF 2.50" HOSE

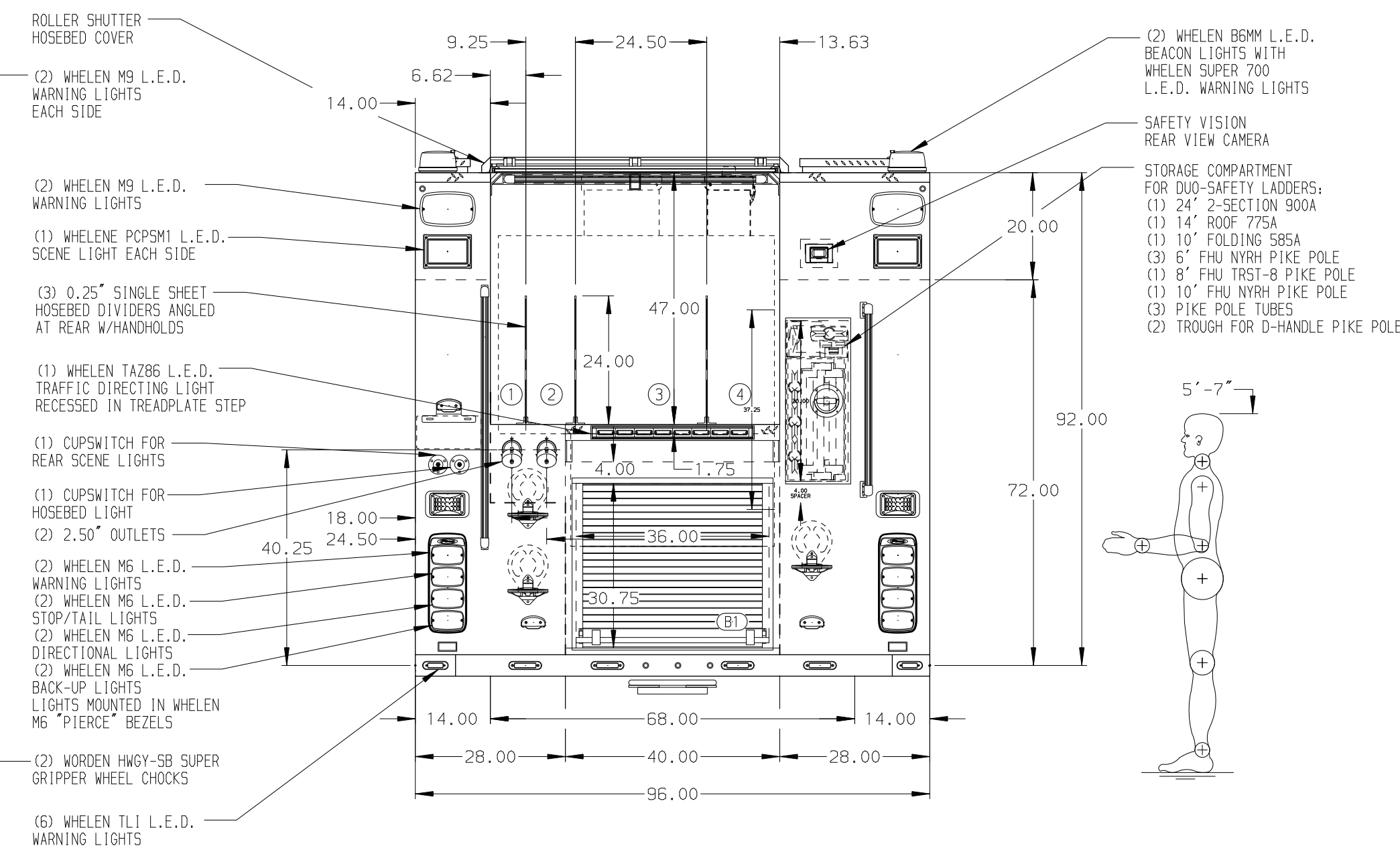
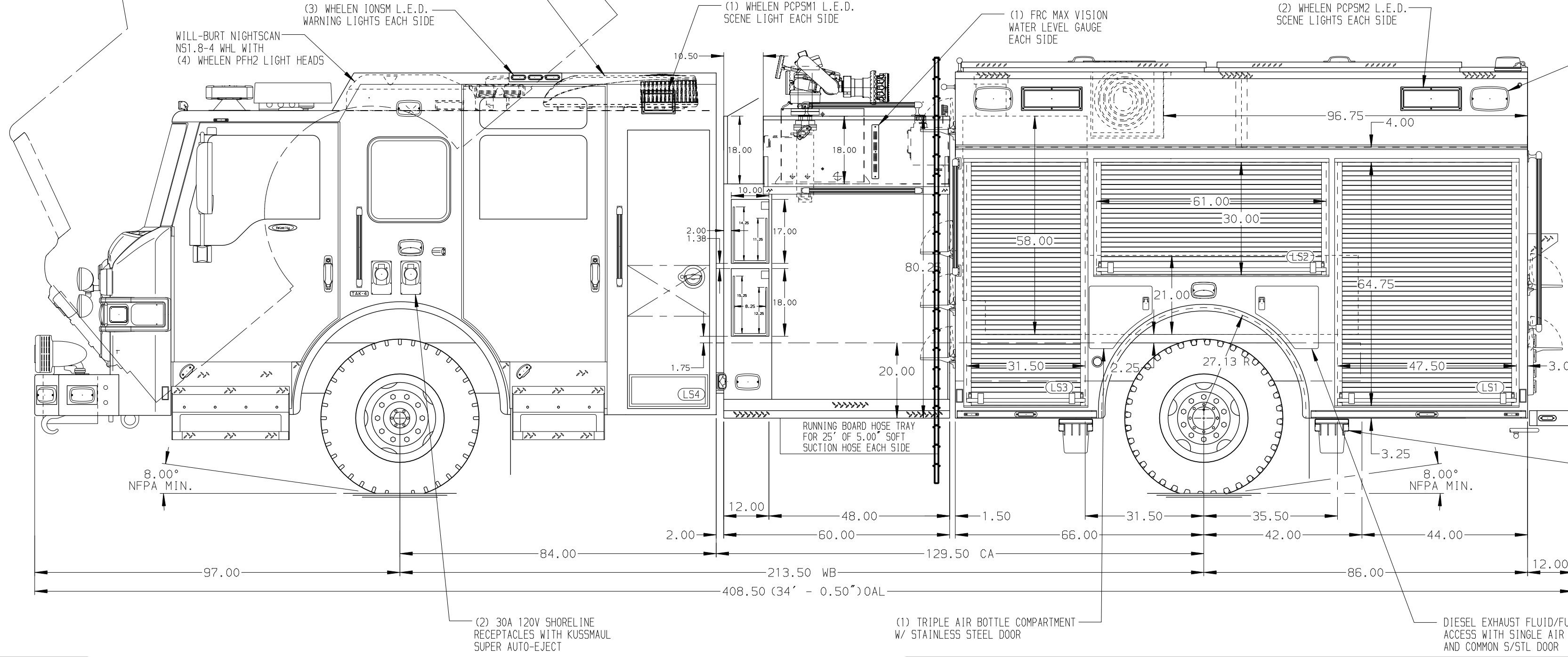

ALUMINUM BODY

SIDE ROLL AND FRONTAL IMPACT PROTECTION

NOTE
 DIMENSIONS SHOWN ARE APPROXIMATE AND ARE SUBJECT TO MINOR DEVIATIONS AS MAY OCCUR OR BE NECESSARY IN CONSTRUCTION.
 MINOR DETAILS NOT SHOWN.

1. AIR INLET WITH DISCONNECT COUPLING LOCATED IN DRIVER'S SIDE PUMP PANEL
2. MERITOR WABCO ONGUARD VEHICLE MITIGATION SYSTEM
3. BATTERY CHARGER LOCATED BEHIND DRIVER'S SEAT
4. BATTERY CHARGER INDICATOR LOCATED ON DRIVER'S SEAT RISER
5. WHELEN 700CELZR L.E.D. LIGHT LOCATED AT THE FRONT OF THE HOSE BED
6. DRIP PAN GUARD FOR ROLL-UP DOOR LOCATED ON COMPARTMENT LS1, LS2, LS3, RS1, RS2, RS3 & B1
7. ONE ADJUSTABLE FULL WIDTH/DEPTH SHELF IN COMPARTMENT RS1, RS2 & RS3, TWO IN LS3
8. ONE ADJUSTABLE LOW/SPECIAL SIDE HEIGHT SHELF IN COMPARTMENT B1
9. ONE FIXED FULL WIDTH/DEPTH SHELF IN COMPARTMENT LS3
10. ONE ADJUSTABLE FULL WIDTH SLIDE-OUT TRAY IN COMPARTMENT RS1 & RS3
11. ONE FULL WIDTH/DEPTH FLOOR MOUNTED SLIDE-OUT TRAY IN COMPARTMENT LS1, RS3 & B1
12. CIECH DRAWER ASSEMBLY IN COMPARTMENT LS3
13. LITTLE GIANT LADDER STORAGE ON FLOOR IN COMPARTMENT RS1
14. ALUMINUM REARBARD ON THE BACK WALL OF COMPARTMENT LS1, LS2, LS3, RS1, RS2 & RS3
15. ZICO KD-UH-6-5F SCBA BRACKET LOCATED IN COMPARTMENT LS2

		JOB NO.	34351
		SCALE	DATE
		TITLE	2000-D-525P, 500 GAL OF WATER W/ 25 GAL FOAM CELL 152" FH FDLER, LDRS. BTWN. TANK & S. SHEET
		FOR	FRISCO FIRE DEPARTMENT FRISCO, TEXAS
		DWG NO.	34351AD
		CHECKED BY	040CT19
		SHEET SIZE	SHEET NO.
		D	1 OF 1

REV	DATE	BY	CH	VELOCITY
1	18FEB20	AMI	CHR	CHASSIS DATA
2	13JAN20	AMI	CHR	MAKE
3	18DEC19	AMI	CHR	PIERCE
4	10OCT19	AMI	AZA	MODEL