

- HOSEBED CAPACITIES
- ① 300' OF 1.75" D.J. POLY HOSE
 - ② 200' OF 1.75" D.J. POLY HOSE
 - ③ 1000' OF 4.00" D.J. POLY HOSE
 - ④ 200' OF 2.50" D.J. POLY HOSE

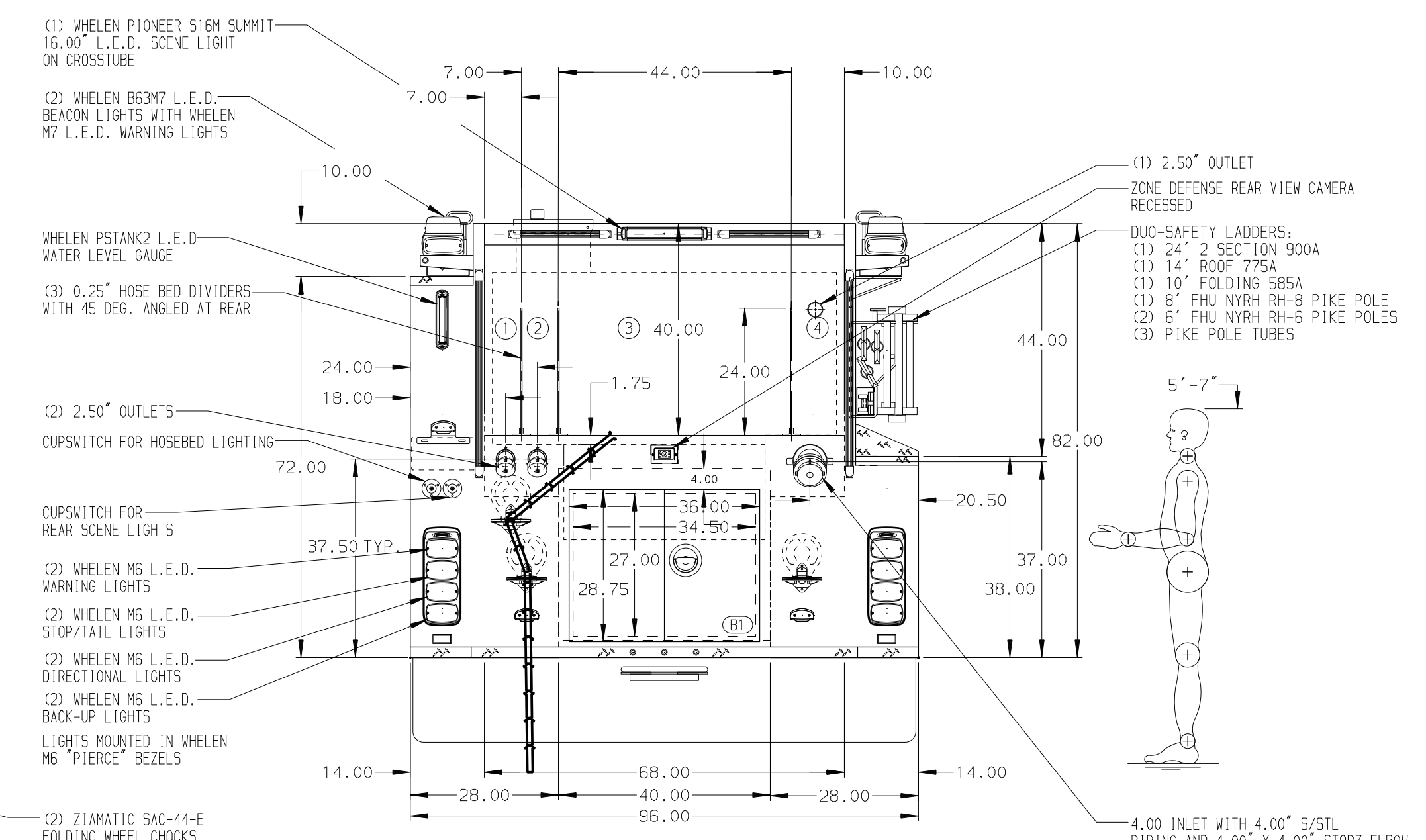
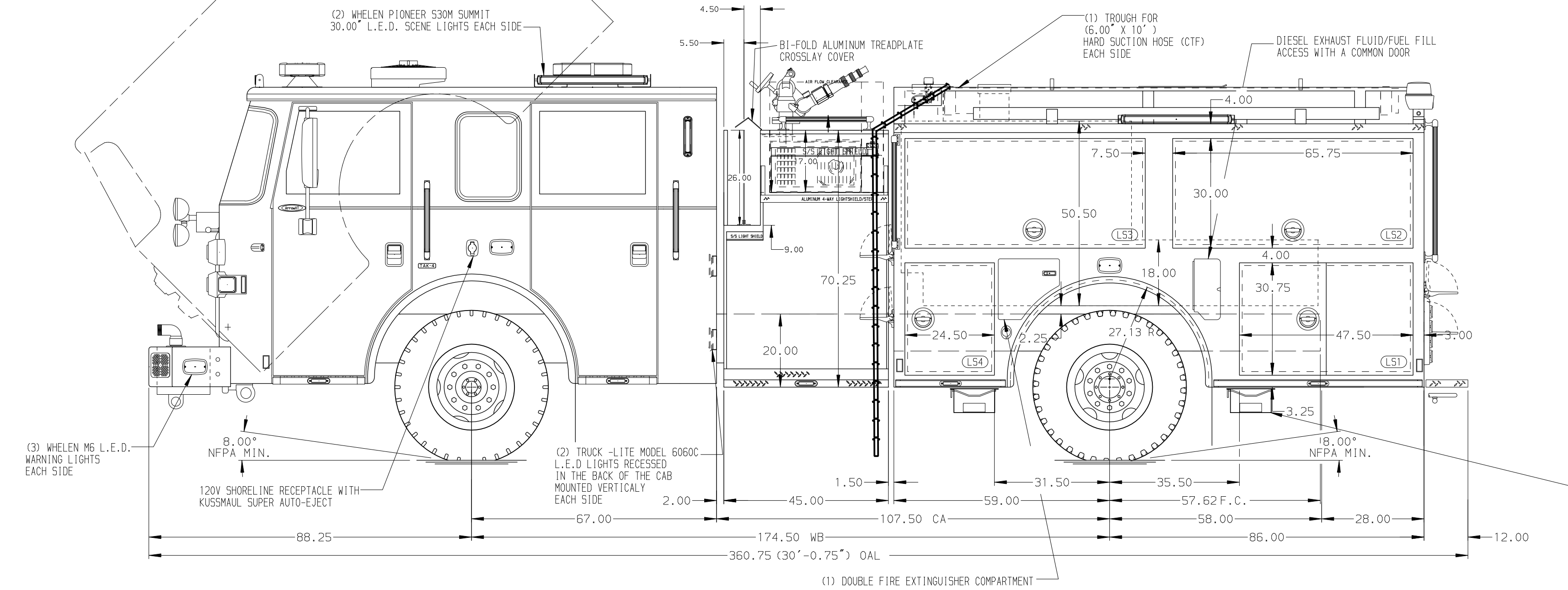

ALUMINUM BODY

SIDE ROLL AND FRONTAL IMPACT PROTECTION

NOTE
DIMENSIONS SHOWN ARE APPROXIMATE AND ARE SUBJECT TO MINOR DEVIATIONS AS MAY OCCUR OR BE NECESSARY IN CONSTRUCTION. MINOR DETAILS NOT SHOWN.

1. ONSPOT AUTOMATIC TIRE CHAINS TO BE PROVIDED AT THE REAR
2. AIR INLET/OUTLET WITH DISCONNECT FITTING ON D.S. PUMP PANEL
3. BATTERY CHARGER IN CAB BEHIND DRIVER'S SEAT
4. BATTERY CHARGER INDICATOR LOCATED NEAR DRIVER'S SEAT RISER WITH BRACKET
5. DUAL L.E.D. LIGHT STRIPS LOCATED IN HOSE BED
6. PULL STRAPS FOR DOORS IN L52 AND L53
7. REVERSED HINGED DOOR ON L54
8. FULL WIDTH/DEPTH ADJUSTABLE SHELVES TWO IN RS1 AND ONE IN L51, L54, B1, AND RS2
9. PAC TRAC ON THE REAR WALLS, SIDE WALLS, AND FLOORS OF L52 AND L53
10. PARTITION BETWEEN COMPARTMENTS L51/B1 AND RS1/B1

11. CIRCUIT BREAKER PANEL IN L53
12. ONE HANNAY ELECTRIC REWIND CORD REEL MODEL 1618-17-18 WITH 200' OF 10/3 CABLE IN RIGHT SIDE OF PUMP HOUSE WITH CAPTIVE ROLLER ASSEMBLY
13. ONE FLOOR MOUNTED TRAY IN B1
14. ALUMINUM TREADPLATE ON THE FLOOR OF L51, L54, RS1, AND RS2
15. SPECIAL HEIGHT VERTICAL PARTITION IN RS1
16. HORIZONTAL EQUIPMENT MOUNTING TRACKS IN L54
17. STORAGE RACK FOR FIRE EXTINGUISHERS IN RS1
18. ONE 120V 6-PLACE RECEPTACLE STRIP IN THE PASSENGER'S SIDE CREW CAB, L51, AND B1

REV	DATE	BY	CH	ARROW	XT
29JUL20	LST	CSH	CHASSIS DATA		
03JUN20	LST	CSH	MAKE		
15APR20	JAJ	CSH	PIERCE		
13MAR20	LST	CSH	MODEL		
04OCT19	LST	CKN			

		JOB NO.	34330
		SCALE	DATE
TITLE	1500-D-750P W/30G FOAM, 145", DOUBLE DS, LOW PS, FDLR (2) X-LAYS, DELUGE	DRAWN BY	LST
FOR	BARBOURSVILLE VOLUNTEER FIRE DEPARTMENT BARBOURSVILLE, VIRGINIA	CHECKED BY	CKN
DWG NO.	34330AD	SHEET SIZE	SHEET NO.
		D	1 OF 1