

**PUMPER BODY**

Medium Aluminum 2nd Gen Pumper

**CHASSIS**

Velocity Chassis (Big Block)

**CHASSIS AXLE, FRONT, CUSTOM**  
22,800 Lb TAK-4 Axle

**AXLE, REAR**  
24,000 Lb Meritor Axle

**ENGINE**  
505 HP Cummins X15 Engine

**TRANSMISSION**  
Allison 5th Gen, 4000 EVS P

**BUMPER**  
19" Extended Stainless Steel

**CAB**

7010 Velocity FR Cab

**BODY**

**WATER TANK**

750 Gallon New York Style Water Tank

**COMPT, PUMPER, REAR**  
30.75" FF RollUp Rear Compt

**COMPT, PUMPER, LEFT SIDE**  
152" RollUp Full Height Front & Rear FDLR

**COMPT, PUMPER, RIGHT SIDE**  
152" RollUp Full Height Front & Rear FDLR

**FIRE SUPPRESSION PUMPHOUSE**

52" Control Zone Side Mount

**PUMP**

2000 GPM Waterous CSU

**CROSSLAYS, 1.50"**  
(2) 1.50" Standard Capacity

**CROSSLAYS, 2.50"**  
(1) 2.50" Standard Capacity

**SPEEDLAYS**

Speedlays Not Required

**GENERATOR**

Generator Not Required

**Foam System**

Husky 3 Single Agent Foam System

**Foam Cell**

20 Gallon Foam Cell, Reduced Water

Side Roll and Frontal Impact Protection

**NOTE**  
DIMENSIONS SHOWN ARE APPROXIMATE AND ARE SUBJECT TO MINOR DEVIATIONS AS MAY OCCUR OR BE NECESSARY IN CONSTRUCTION. MINOR DETAILS NOT SHOWN.

- ONE 1.50" OUTLET WITH 2.00" PIPING AND SWIVEL LOCATED IN CENTER BUMPER TRAY OF THE CAB
- SHOULDER RECEPTACLE WITH KUSSMALL SUPER-AUTO-EJECT LOCATED ON DRIVER SIDE OF THE CAB
- AIR INLET WITH DISCONNECT COUPLING IN THE DRIVER SIDE STEPWELL
- BATTERY CHARGER LOCATED IN COMPARTMENT PER SHOP ORDER
- BATTERY CHARGE INDICATOR LOCATED ON DRIVERS SIDE OF CAB
- SEVEN ADJUSTABLE SHELVES IN COMPARTMENTS PER SHOP ORDER
- MOUNTING PROVISIONS FOR WILL BURT POWERLITE HS 3.0 10" ON CAB ROOF

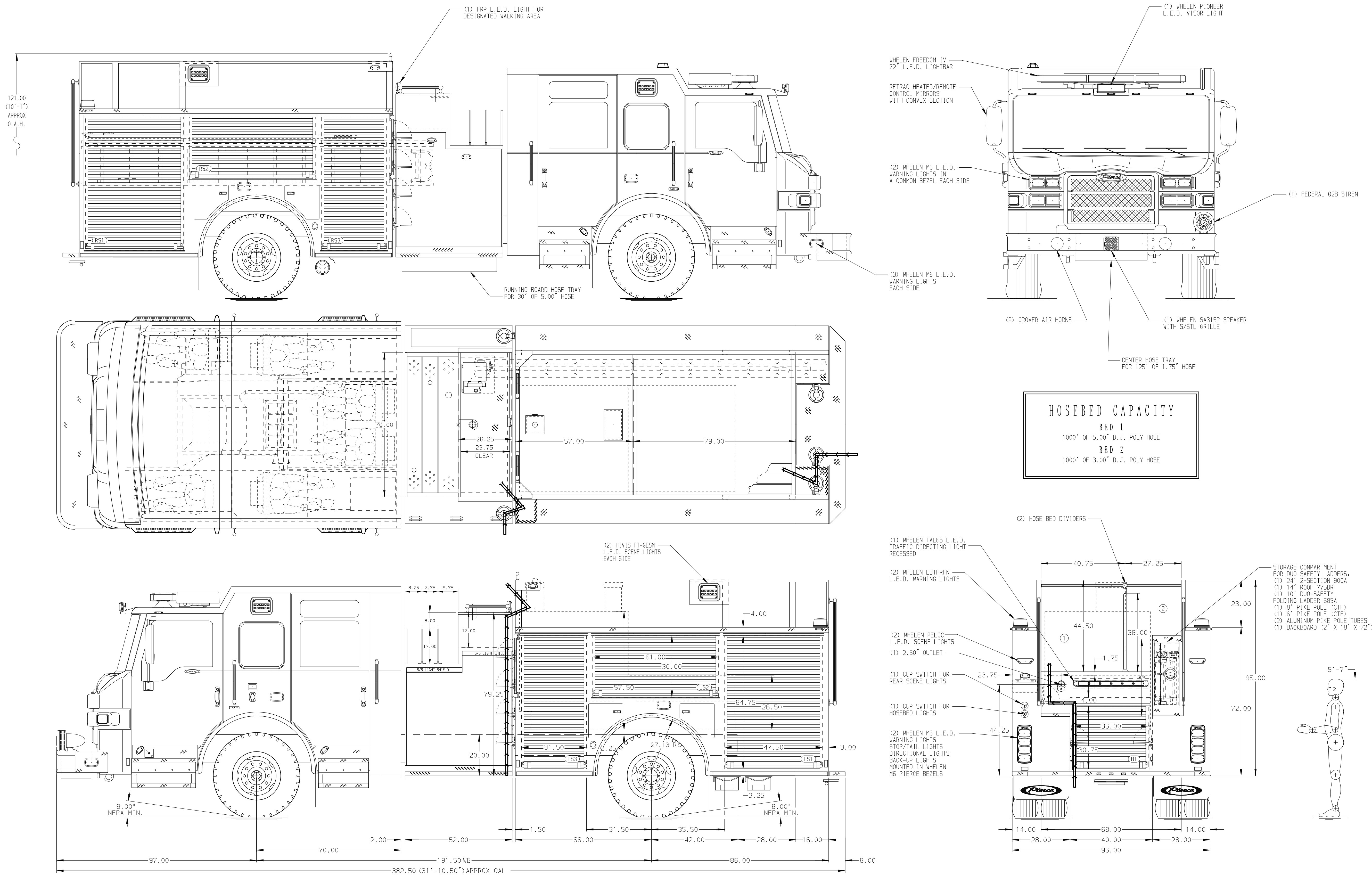

**CUSTOMER APPROVAL**

APPROVED BY: \_\_\_\_\_  
DATE: \_\_\_\_\_



JOB NO. 33789

SCALE 1:24 DATE

DRAWN BY MMF 23JUN20

CHECKED BY NPE 26JUN20

SHEET SIZE D SHEET NO. 1 OF 1

230CT20	MMF	THS	PIERCE	TITLE	Pierce Pumper Approval Drawing
08JUL20	COL	NPE	PIERCE	MAKE	-
REV	DATE	BY	CH	FOR	Pierce Stock Unit
				DWG NO.	33789AD

33789AD